

## 3D PDF DATASHEET



eCATALOGsolutions



BIM catalogs.net



PARTsolutions



Create Your Individual 3D PDF Datasheet



Learn How to Create Your Mechanical Product Catalog



Learn How to Create Your BIM Product Catalog



Reduce Your Costs in Engineering and Purchasing



### 2703250800CP/0-0--

Rodless cylinders

## 3D View

To activate the interactive 3D view, you must trust this document (see hint on the top) in Adobe Acrobat and click on the question mark.

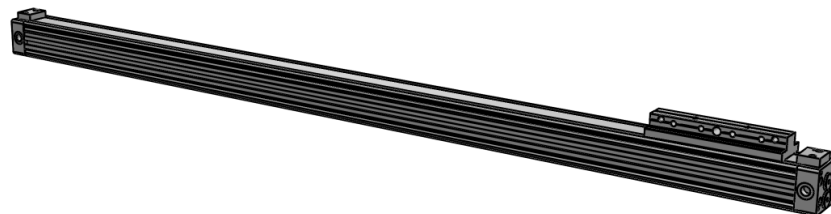

### Zoom

Moves you toward or away from objects in the scene when you drag vertically. You can also zoom with the hand tool by holding down Shift as you drag.



### Pan

Moves the model vertically and horizontally only. You can also pan with the hand tool: Ctrl-drag.



### Rotate

Turns 3D objects around relative to the screen. How the objects move depends on the starting view, where you start dragging and the direction in which you drag.

# 3D PDF DATASHEET



 eCATALOG solutions



 BIM catalogs.net





 PART solutions



Create Your Individual 3D PDF Datasheet 

Learn How to Create Your Mechanical Product Catalog 

Learn How to Create Your BIM Product Catalog 

Reduce Your Costs in Engineering and Purchasing 



## 2703250800CP/0-0--

Rodless cylinders

2D derivation

ISO View



3D PDF DATASHEET



eCATALOGsolutions



BIM catalogs.net



PARTsolutions



Create Your Individual 3D PDF Datasheet



Learn How to Create Your Mechanical Product Catalog



Learn How to Create Your BIM Product Catalog



Reduce Your Costs in Engineering and Purchasing



2703250800CP/0-0--  
Rodless cylinders

## Technical drawings

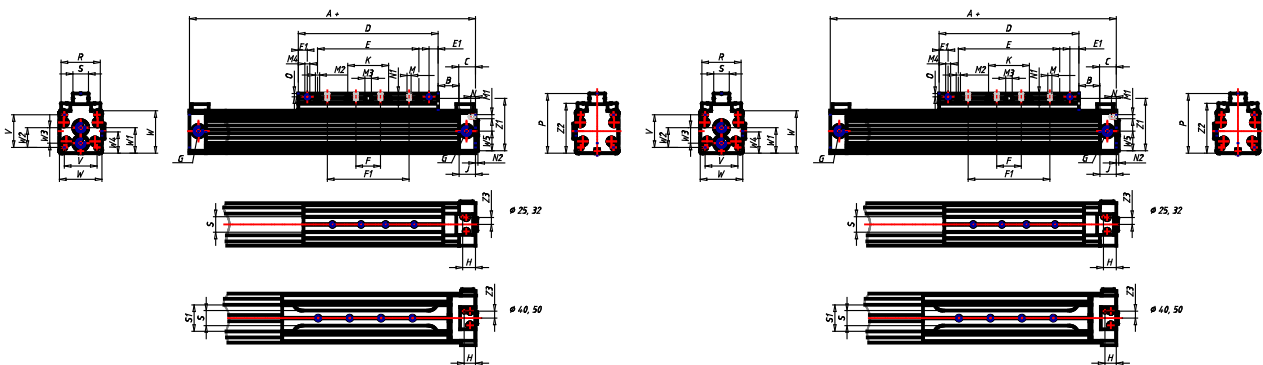

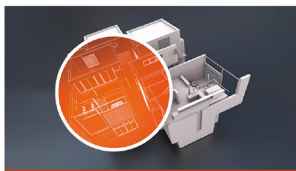

2703250800CP/0-0--

Rodless cylinders

## Technical Data

CODE (Code)	2703250800CP
DI (Ø Diameter)	25
TYPE (Type)	Rodless
VERSION (Version)	Double-acting, magnetic, cushioned
EX (Execution)	Magnetic
HUB (Stroke / mm)	800
HUBST (Rod position / mm)	0
MAT (Material)	C45 chromed rod (or rodless)
SE (Seal)	Polyurethane gaskets
AC1 (Intermediate accessories)	
AC2 (Left sensors)	
AC3 (Right sensors)	
INFO (Catalogue)	Catalogue
A (/ mm)	200
B (/ mm)	14,5
B1 (ØB)	-
C (/ mm)	20
D (/ mm)	131
D1 ( )	-
D2 (/ mm)	-
E (/ mm)	84
E1 (/ mm)	11
F (/ mm)	50
F1 (/ mm)	-
G ( )	G1/8
H (/ mm)	15,7
J (/ mm)	11
K (/ mm)	30
M (Thread)	M5
M1 (Thread)	M4
M2 (/ mm)	5,2
M3 (/ mm)	8
M4 (Thread)	M6
N (/ mm)	13
N1 (/ mm)	7,5

# 3D PDF DATASHEET



 eCATALOG solutions

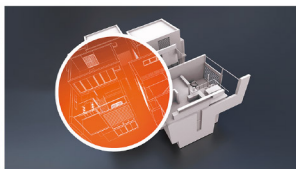

 BIM catalogs.net



 PART solutions



Create Your Individual 3D PDF Datasheet ▶

Learn How to Create Your Mechanical Product Catalog ▶

Learn How to Create Your BIM Product Catalog ▶

Reduce Your Costs in Engineering and Purchasing ▶



## 2703250800CP/0-0--

Rodless cylinders

### Technical Data

N2 (/ mm)	2.1
O (/ mm)	4
P (/ mm)	63
R (/ mm)	40
S (/ mm)	19
S1 (/ mm)	-
V (/ mm)	32.5
W (/ mm)	42
W1 (/ mm)	26.5
W2 (/ mm)	20.3
W3 (/ mm)	16.5
W4 (/ mm)	25.5
W5 (/ mm)	21.2
W6 (/ mm)	-
W7 (/ mm)	2.5
Z1 (/ mm)	57
Z2 (/ mm)	51.2
Z3 (/ mm)	93
AA1 ()	-
BB1 ()	-
CC1 ()	-
DD1 ()	-
EE1 ()	-
FF ()	-
FF1 ()	-
HH1 ()	-
L ()	-
BMAX (B Max)	-
DD2 ()	-
EE2 ()	-
GG1 ()	-
WW7 ()	-
W8 ()	-
WS4 ()	-
Z4 ()	-
Z5 ()	-

# 3D PDF DATASHEET



 eCATALOG solutions



 BIM catalogs.net





 PART solutions



Create Your Individual 3D PDF Datasheet 

Learn How to Create Your Mechanical Product Catalog 

Learn How to Create Your BIM Product Catalog 

Reduce Your Costs in Engineering and Purchasing 



## 2703250800CP/0-0--

Rodless cylinders

### Bill of Materials

N°	Description	Amount
1	2703250800CP	1