

# KEL 10

## Cable Entry Frames



Click to shop online @ [www.trimantec.com](http://www.trimantec.com) or call 336-767-1379



Split grommets



KEL 10 also available with V2A screws.



KEL 10 on request also available with threaded bushings.



## Product Description

The split cable entry frame KEL 10 matches exactly the cut-out dimensions of 10-pole standard industrial connectors.

The split grommet matching the cable diameter is placed around the cable and inserted into the cable entry frame.

Either a cut-out of 36 mm or 46 mm in height can be chosen depending on the cables being routed. This flexibility is perfect for pre-terminated cables.

## Advantages

- Warranty on pre-terminated cables remains
- Retrofitting and maintenance can be carried out easily and quickly
- High packing density, wide variety of frames and grommets
- Strain relief according to EN 50262 / 62444
- Vibration proof

## Specifications

Material	Polyamide (PA)
Flame class	UL94-Vo, self-extinguishing
Protection class	IP54, with gasket and correct selection of cable grommets (certified according to DIN EN 60529:2000-09)
Temperature	- 40°C to + 140°C (static)
Properties	Halogen free, silicone free
Cut-out dimensions	36/46 × 65 mm / Page 176 - 177
Height KEL	17 mm

## Accessories

KT Cable grommets	38 - 42
KEL-SNAP Mounting frames	28 - 29
KEL-EMC Cable collectors	119 - 120

### Description

### Type

### Order No.

### Grommets small | large

### PU

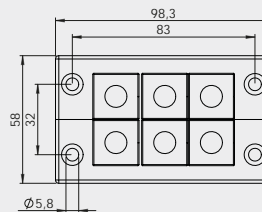

KEL 10|6

42216

6|-

10

KEL 10|6  
with V2A screws

42216.200

6|-

10

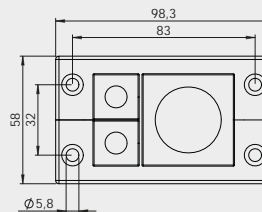

KEL 10|3

42212

2|1

10

KEL 10|3  
with V2A screws

42212.200

2|1

10