

Accessories—One-Touch Fittings

NPC, NPOC series



Ordering code

NPC 1/4 - 1/8

① ② ③

① Model

NPC: Male connector



NPOC: Male connector

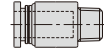

② Port size

1/8: Φ 1/8"
 5/32: Φ 5/32"
 1/4: Φ 1/4"
 5/16: Φ 5/16"
 3/8: Φ 3/8"
 1/2: Φ 1/2"

③ Thread connection

Thread connection	Adaptable port size
U10: #10-32UNF	Φ 1/8", Φ 5/32", Φ 1/4"
1/8: NPT1/8	Φ 5/32", Φ 1/4"
1/4: NPT1/4	Φ 5/16", Φ 3/8"
3/8: NPT3/8	Φ 1/2"
1/2: NPT1/2	

Table for interface port and tube O.D.

Product series	Thread type	Port size					
		Φ 1/8"	Φ 5/32"	Φ 1/4"	Φ 5/16"	Φ 3/8"	Φ 1/2"
NPC	#10-32UNF	●	●	●			
	NPT1/8		●	●	●	●	
	NPT1/4			●	●	●	●
	NPT3/8			●	●	●	●
	NPT1/2					●	●
NPOC	#10-32UNF		●	●			
	NPT1/8		●	●	●	●	
	NPT1/4			●	●	●	●
	NPT3/8				●	●	●
	NPT1/2					●	●

Specification

Operating pressure range	0~145psi(0~1.0MPa)
Negative pressure	10Torr(-750mmHg)
Proof pressure	215psi(1.5MPa)
Ambient and fluid temperature	-5~160°F (-20~70°C)
Applicable tubing	Soft nylon or polyurethane

Product feature

1. The compact appearance space saving.
2. The threaded portion is covered with sealant and the #10-32UNF thread is attached with a sealing gasket to prevent air leakage over the connection thread portion.

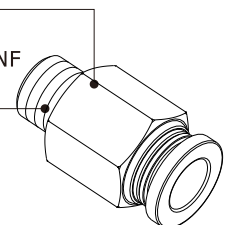

Accessories—One-Touch Fittings

NPC, NPOC series

Dimensions

NPC Series

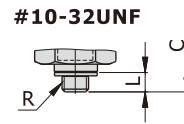
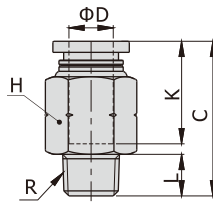

[Unit: inch]

Model\Item	ΦD	R	L	C	K	H(Across flat)
NPC1/8-U10	1/8	#10-32UNF	0.14	0.63	0.45	9/32
NPC5/32-U10	5/32	#10-32UNF	0.14	0.67	0.49	5/16
NPC5/32-1/8		NPT1/8	0.30	0.69	0.53	7/16
NPC1/4-U10	1/4	#10-32UNF	0.14	0.89	0.65	1/2
NPC1/4-1/8		NPT1/8	0.30	0.87	0.65	1/2
NPC1/4-1/4		NPT1/4	0.39	0.96	0.73	9/16
NPC1/4-3/8		NPT3/8	0.43	0.89	0.73	11/16
NPC5/16-1/8	5/16	NPT1/8	0.30	1.10	0.73	9/16
NPC5/16-1/4		NPT1/4	0.39	1.06	0.79	9/16
NPC5/16-3/8		NPT3/8	0.43	0.93	0.79	11/16
NPC3/8-1/8	3/8	NPT1/8	0.30	1.18	0.83	11/16
NPC3/8-1/4		NPT1/4	0.39	1.28	0.83	11/16
NPC3/8-3/8		NPT3/8	0.43	1.10	0.83	11/16
NPC3/8-1/2		NPT1/2	0.55	1.04	0.83	7/8
NPC1/2-1/4	1/2	NPT1/4	0.39	1.38	0.91	7/8
NPC1/2-3/8		NPT3/8	0.43	1.34	0.91	7/8
NPC1/2-1/2		NPT1/2	0.55	1.28	0.91	7/8

NPOC Series

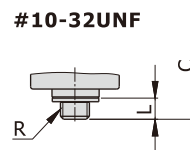
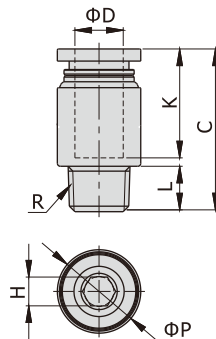

[Unit: inch]

Model\Item	ΦD	R	ΦP	L	C	K	H(Across flat)
NPOC5/32-U10	5/32	#10-32UNF	0.35	0.14	0.67	0.49	3/32
NPOC5/32-1/8		NPT1/8	0.42	0.30	0.67	0.51	7/64
NPOC1/4-U10	1/4	#10-32UNF	0.46	0.14	0.89	0.65	3/32
NPOC1/4-1/8		NPT1/8	0.46	0.30	0.87	0.73	5/32
NPOC1/4-1/4		NPT1/4	0.55	0.39	0.89	0.73	5/32
NPOC5/16-1/8	5/16	NPT1/8	0.54	0.30	1.04	0.71	3/16
NPOC5/16-1/4		NPT1/4	0.55	0.39	0.98	0.75	7/32
NPOC5/16-3/8		NPT3/8	0.70	0.43	0.93	0.75	7/32
NPOC3/8-1/8	3/8	NPT1/8	0.65	0.30	1.18	0.83	7/32
NPOC3/8-1/4		NPT1/4	0.65	0.39	1.14	0.83	1/4
NPOC3/8-3/8		NPT3/8	0.70	0.43	1.10	0.83	1/4
NPOC3/8-1/2		NPT1/2	0.86	0.55	1.04	0.83	1/4
NPOC1/2-1/4	1/2	NPT1/4	0.82	0.39	1.36	0.91	1/4
NPOC1/2-3/8		NPT3/8	0.82	0.43	1.34	0.91	5/16
NPOC1/2-1/2		NPT1/2	0.86	0.55	1.26	0.91	5/16