

# User Guide



## Ford DashCam

### App



Ford Dashcam is an onboard camera that records video clips at user request or automatically, in case of emergency. The video files are stored on SD card. The Ford Dashcam App provides a solution to control the device and download files wirelessly.

#### 1. About & Language

- ▶ Press  in **Dashcam screen** and  in **About screen** to change the language

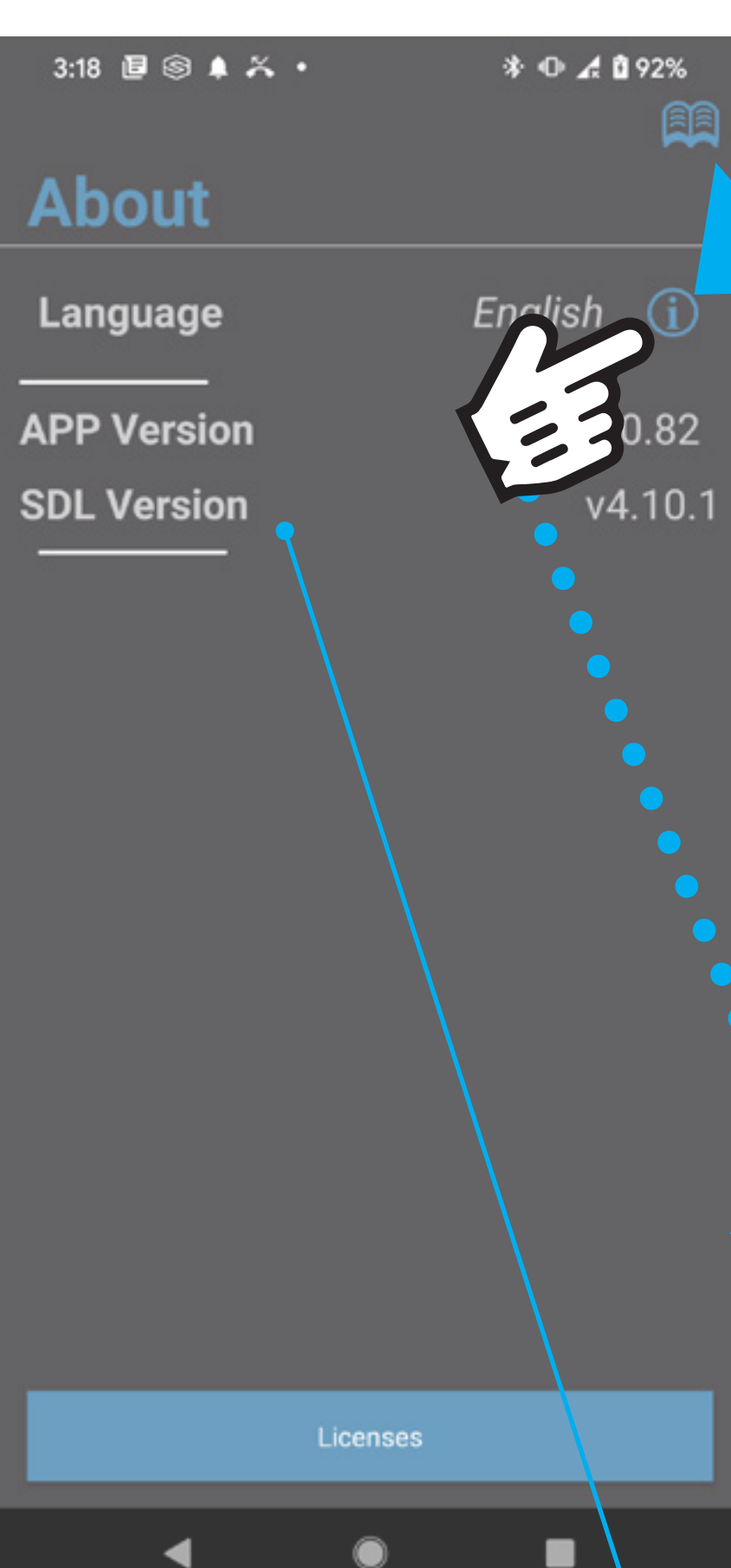

APP and SDL Version

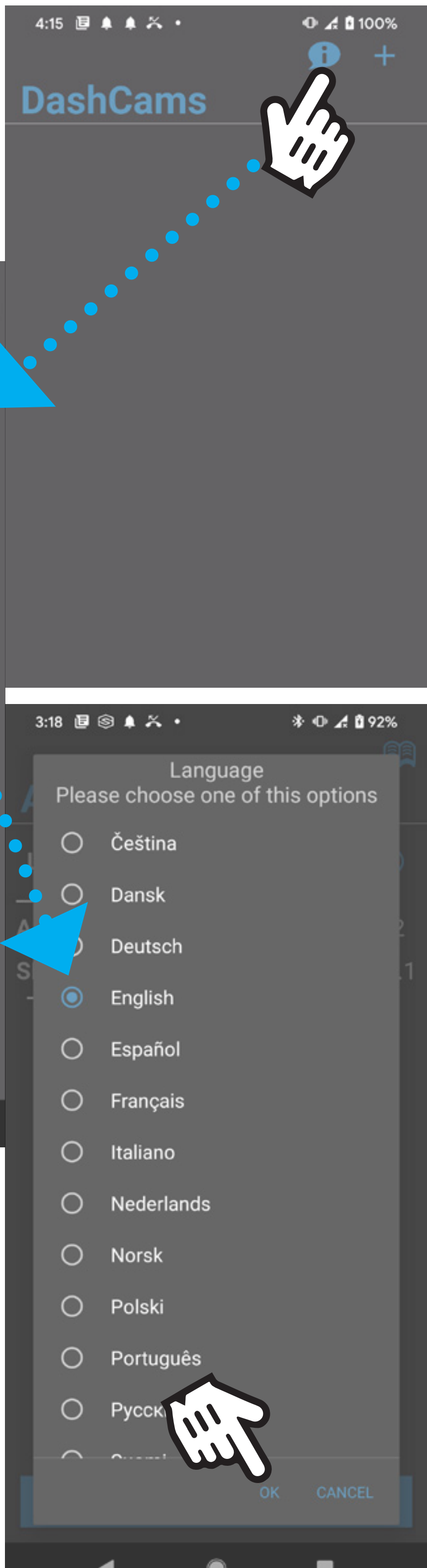

- ▶ On mobile device, make sure Bluetooth is ON

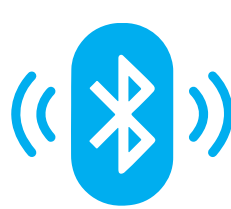

Bluetooth is used to setup features and control the Dashcam with mobile device

## 2. Starting UP

### 2.1 Connect mobile device

- ▶ Turn the ignition ON
- ▶ Wait until the LED turns Green for 3 seconds
- ▶ Press the pairing button and keep it pressed until LED flashes Green



- ▶ On mobile device click on + symbol

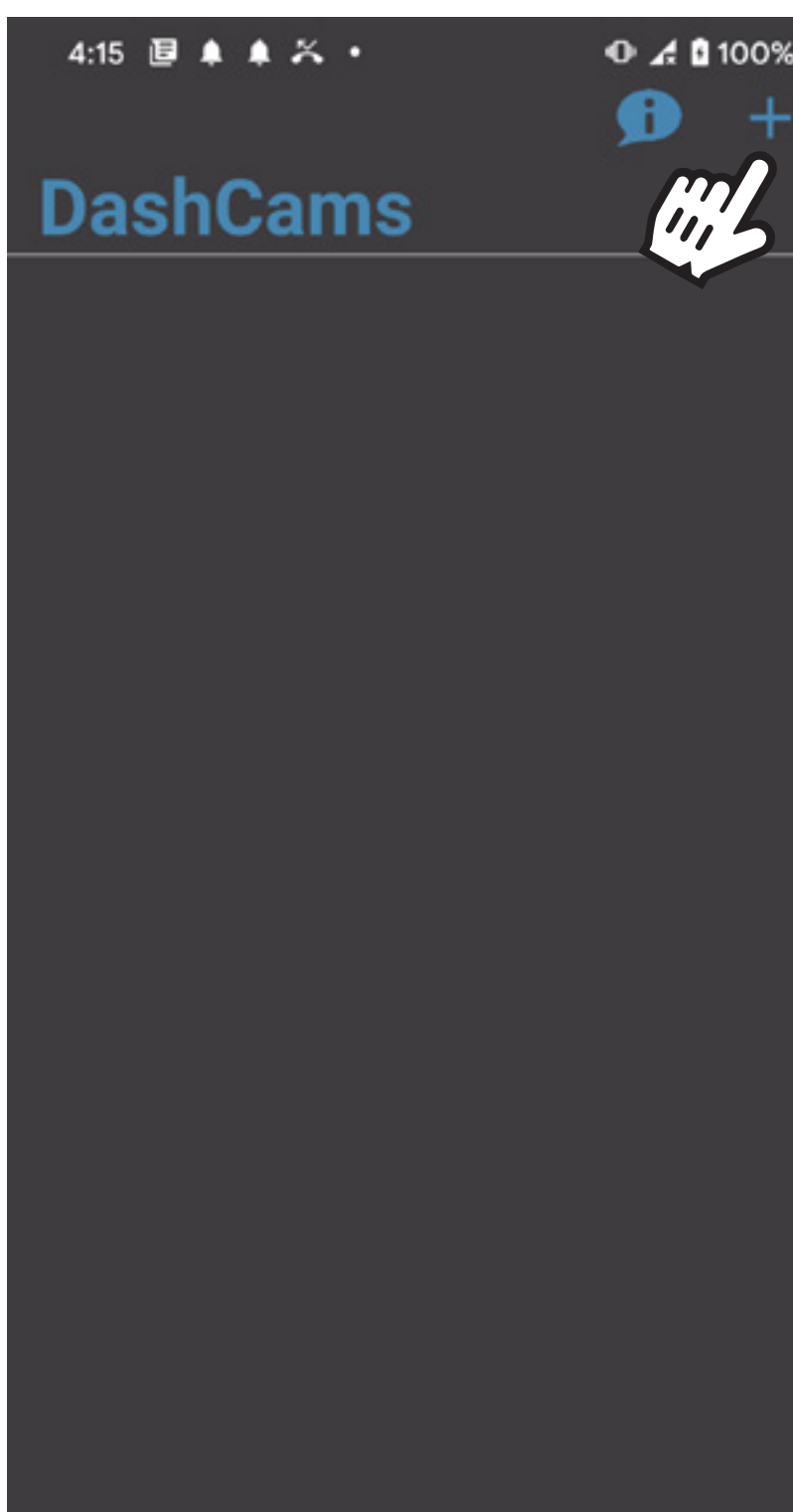

- ▶ Click on blue button "I'm ready"



We're almost done



Please confirm the color of the LED to complete the pairing process

Yes , this is my LED color

No, this is not my LED color

- ▶ ...and wait

- ▶ Dashcam LED will turn solid a particular color
- ▶ Confirm corresponding color on Ford Dashcam App when asked

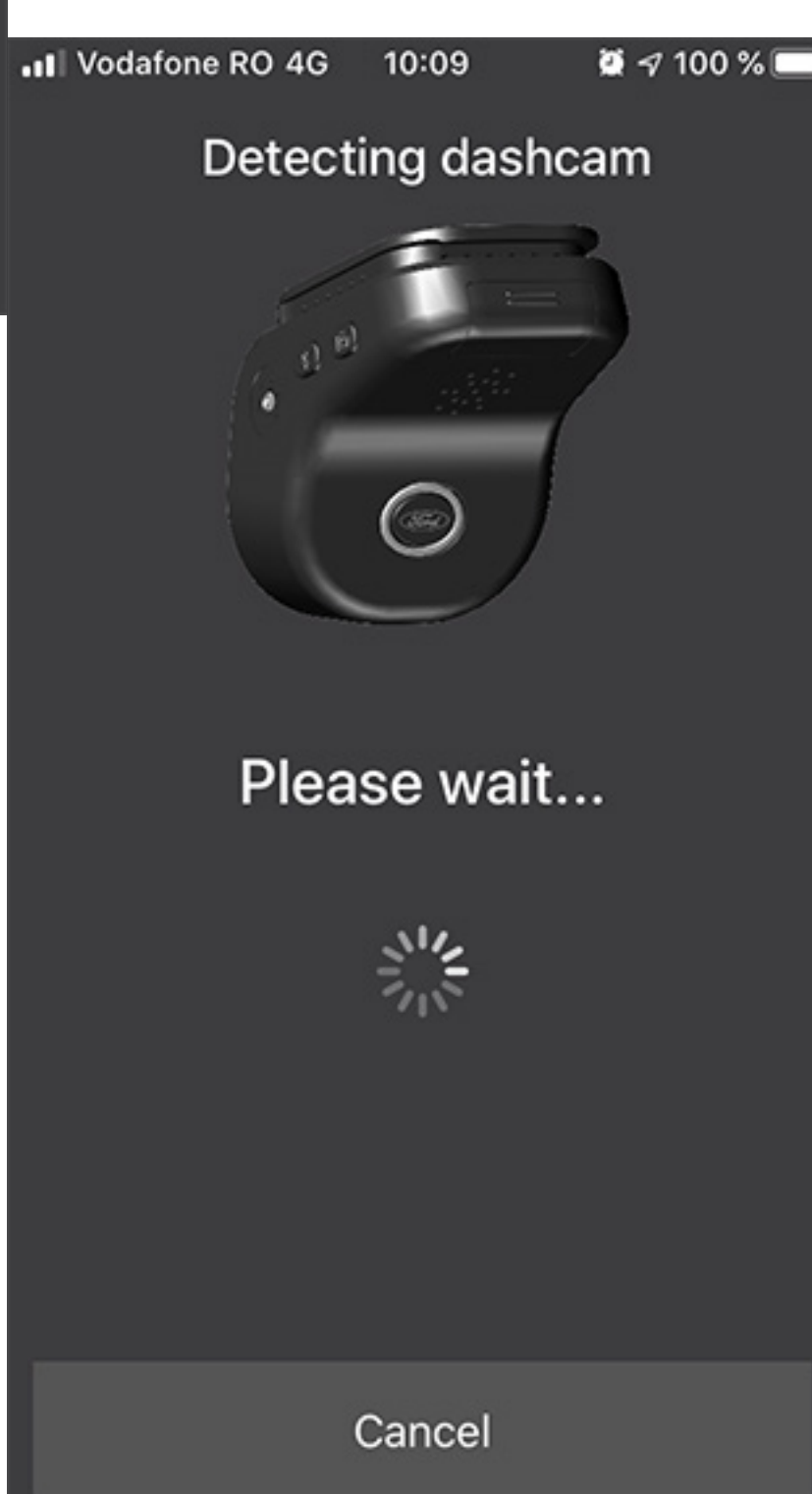

- ▶ Click "OK" when notification "DashCam paired" appears

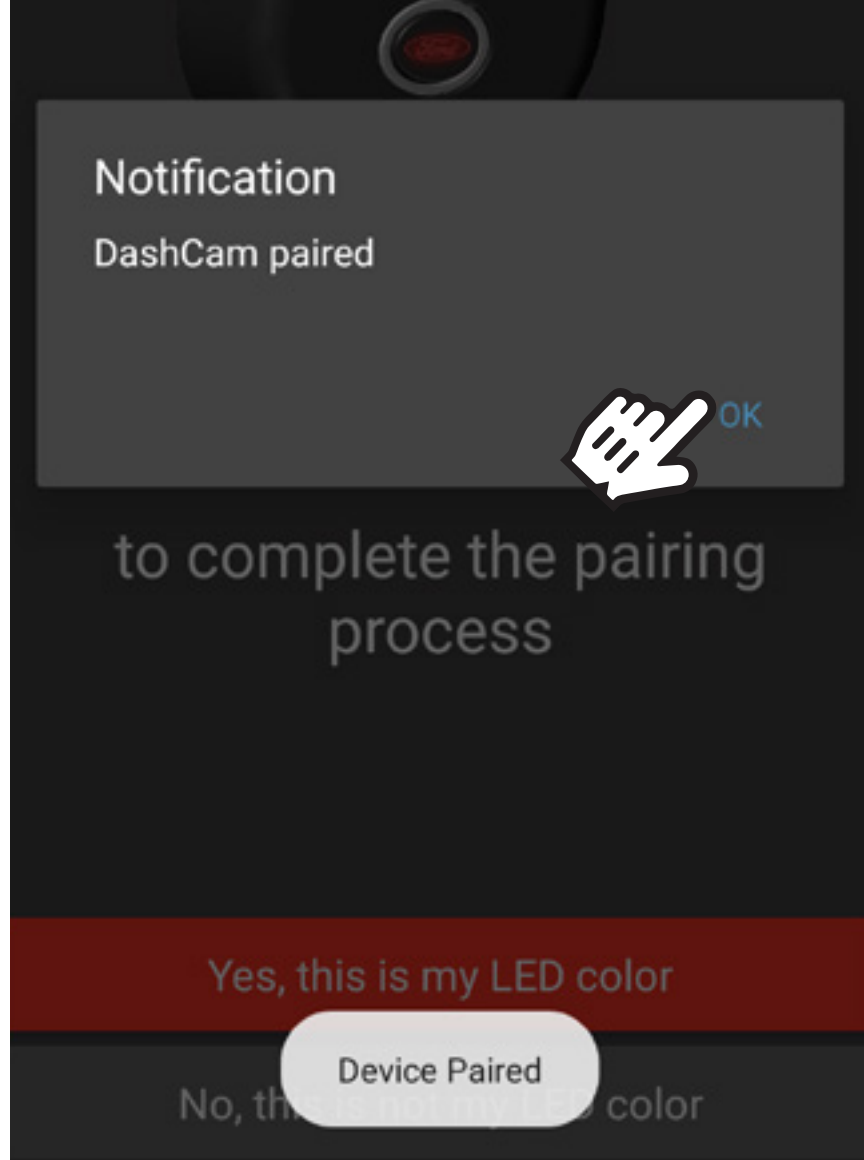

## 2.2 Unpair DashCam

- ▶ To unpair a Ford DashCam, long press on it and press "Delete"

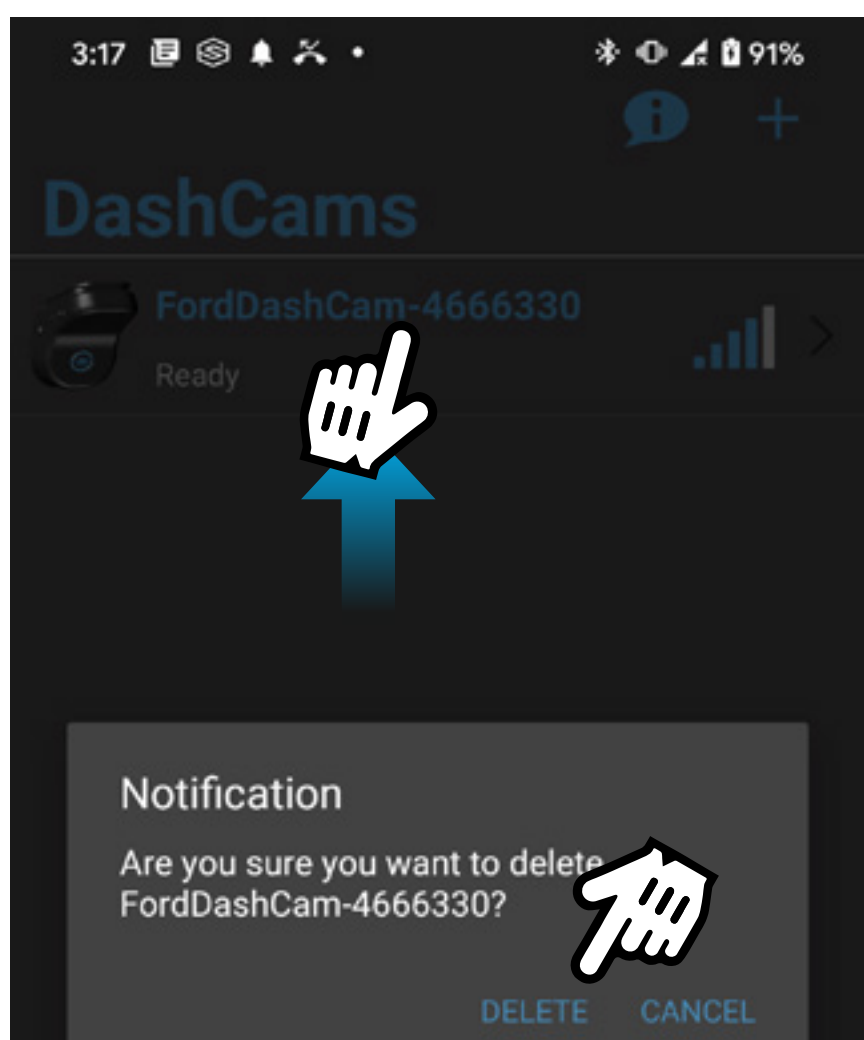

- ▶ Also, on some mobile phones, the device must be erased from the phone menu:

- ▶ Settings menu
- ▶ Bluetooth devices
- ▶ Select Ford Dashcam-xxxx
- ▶ Forget Device

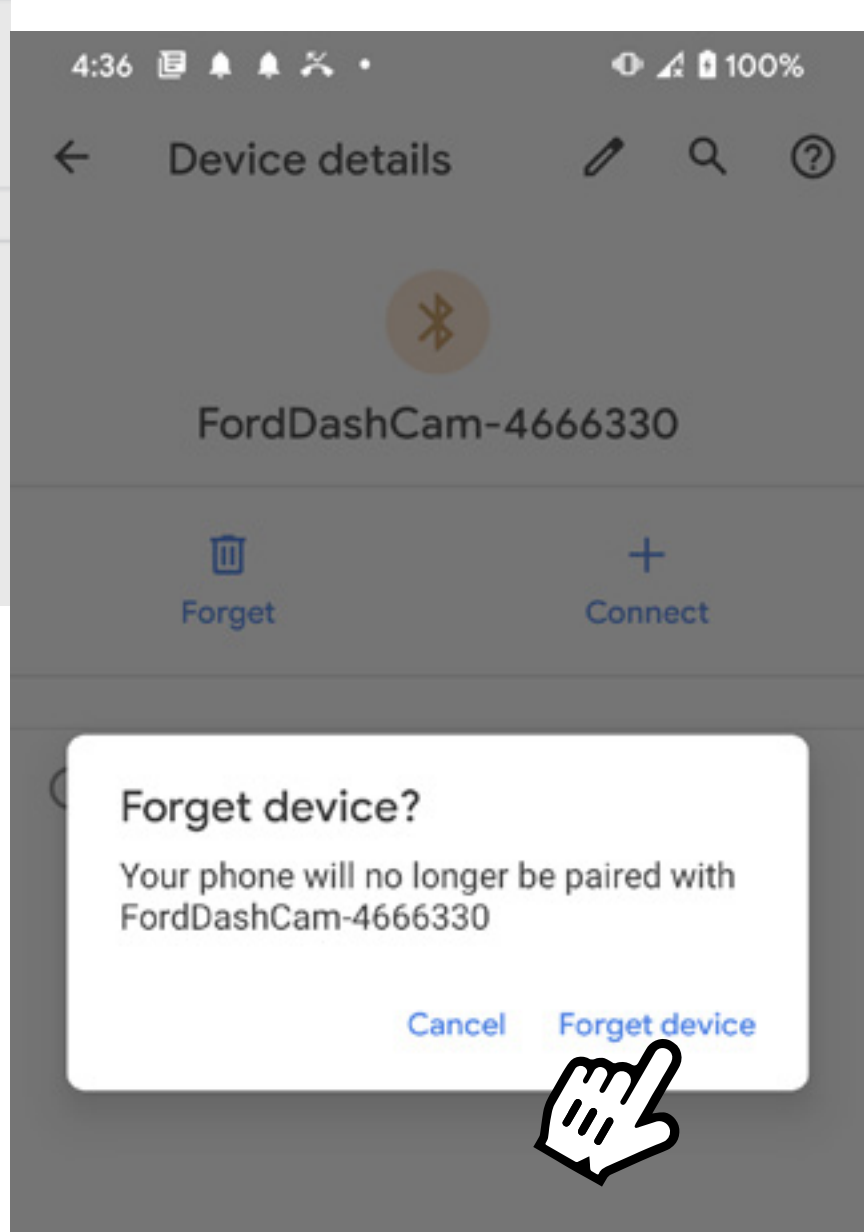
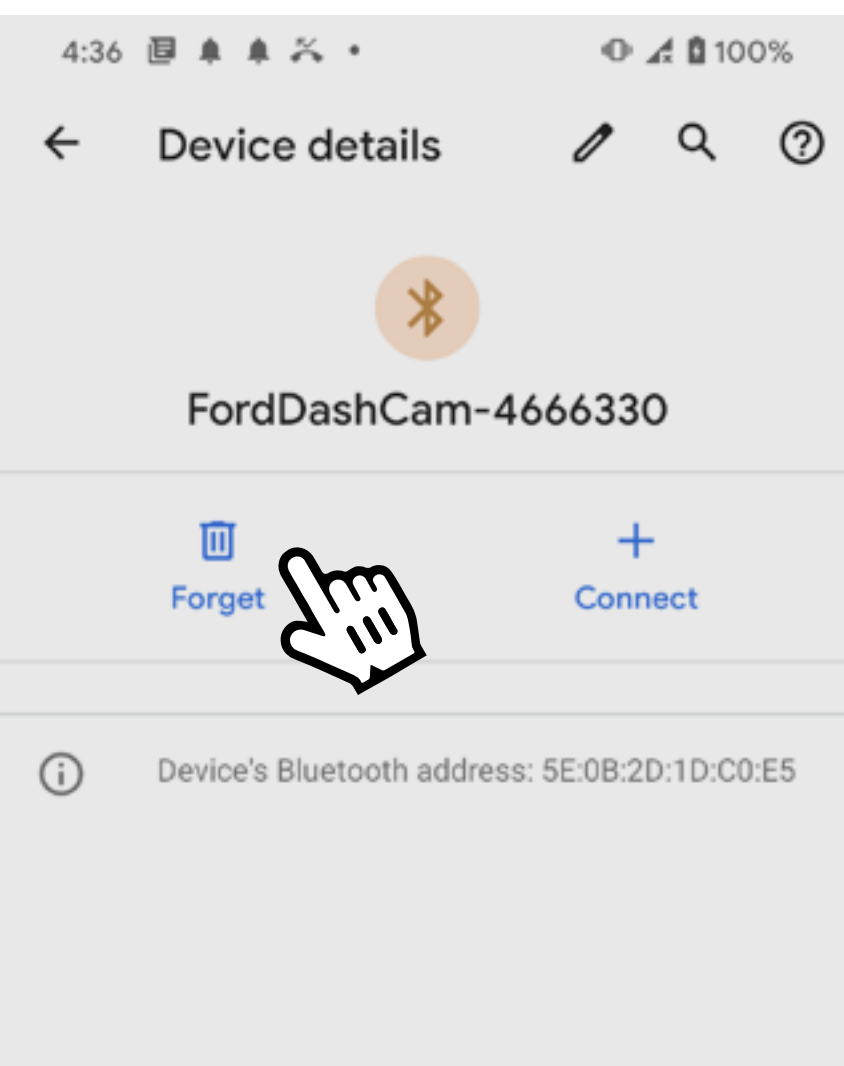
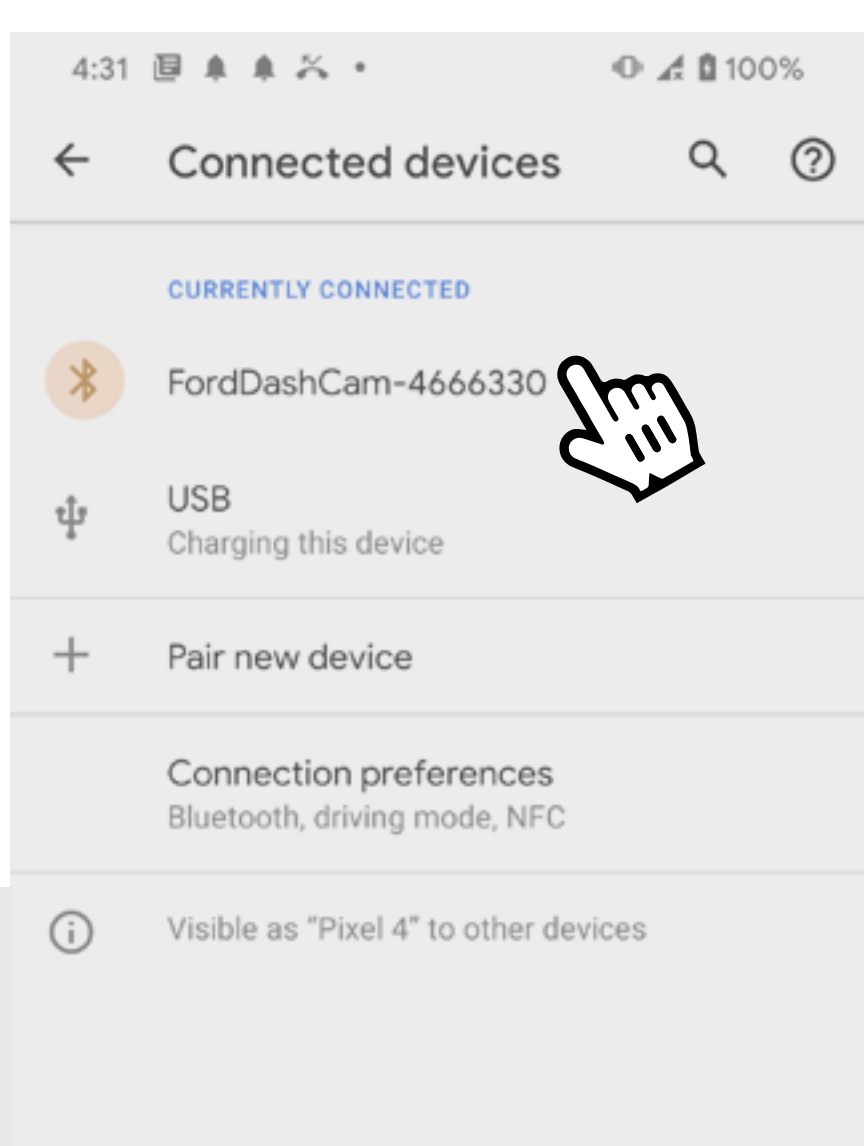

## 3. Main menu

### 3.1 Main window

#### Live streaming

- ▶ See SD Card usage
- ▶ Tap play button
- ▶ See image with infobar

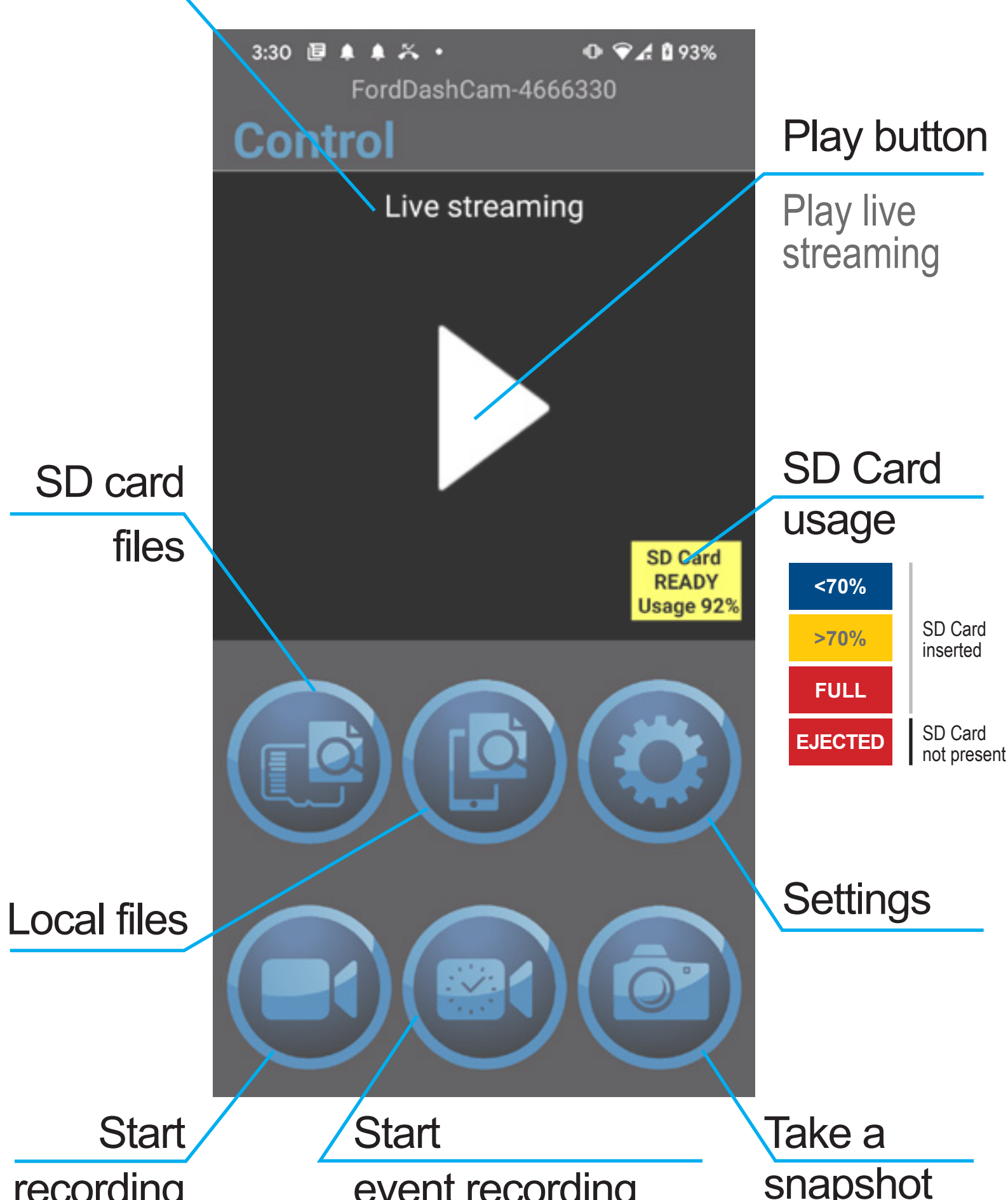

## 3.2 Infobar

See time, date, GPS coordinates and speed on camera view - after connecting WiFi



- ▶ Enable or disable infobar items from [Settings](#)
  - ▶ Stamp Time info  /
  - ▶ Stamp GPS info  /
  - ▶ Stamp Speed info  /

## 3.3 WiFi

To access the **Live streaming** view, or to view the **SD Card** files, the mobile device must be connected with the **Ford Dashcam** via **WiFi**.

- ▶ Press „Continue”

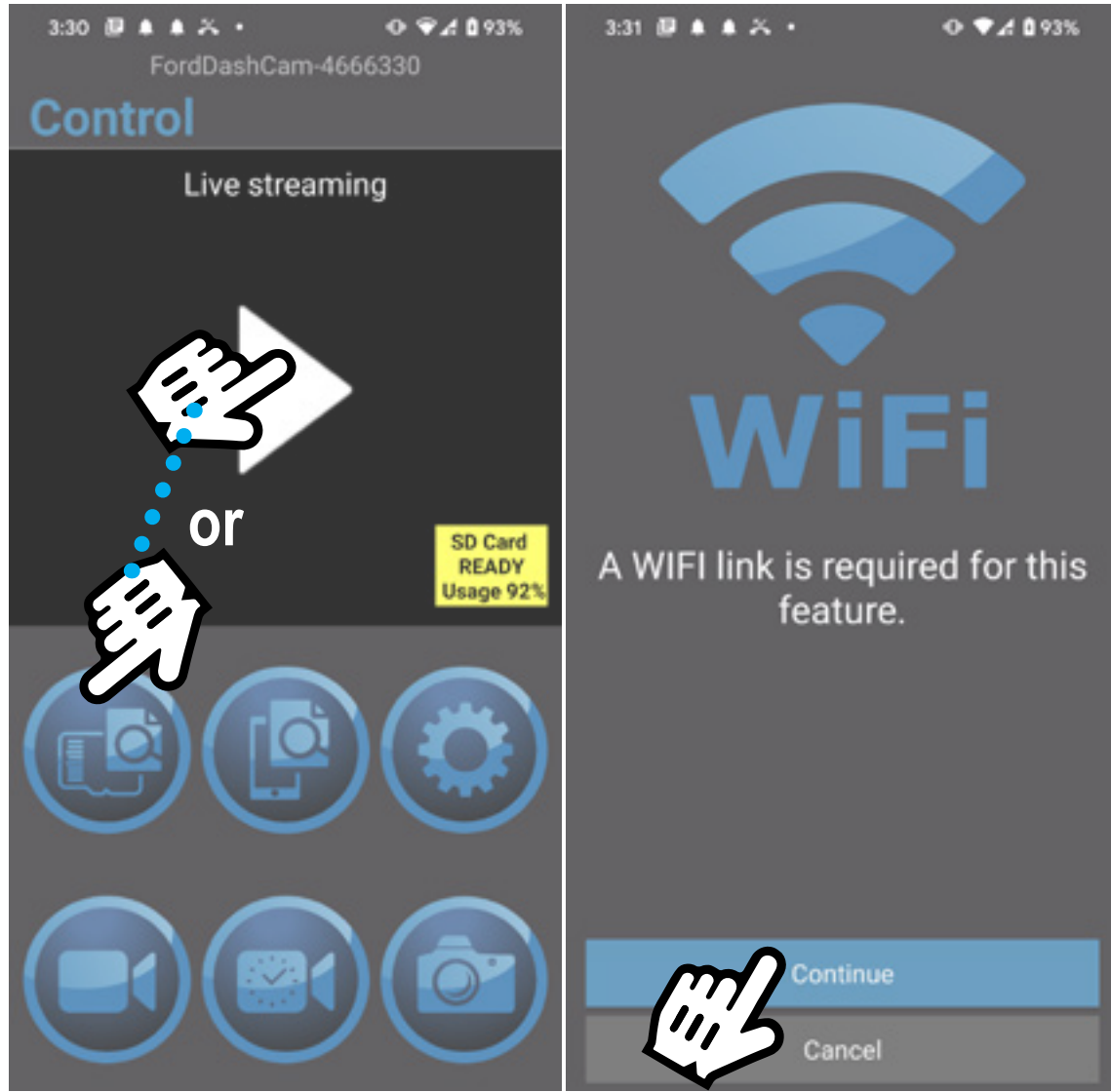

### 1. For Android 10:

- ▶ Press “Connect”

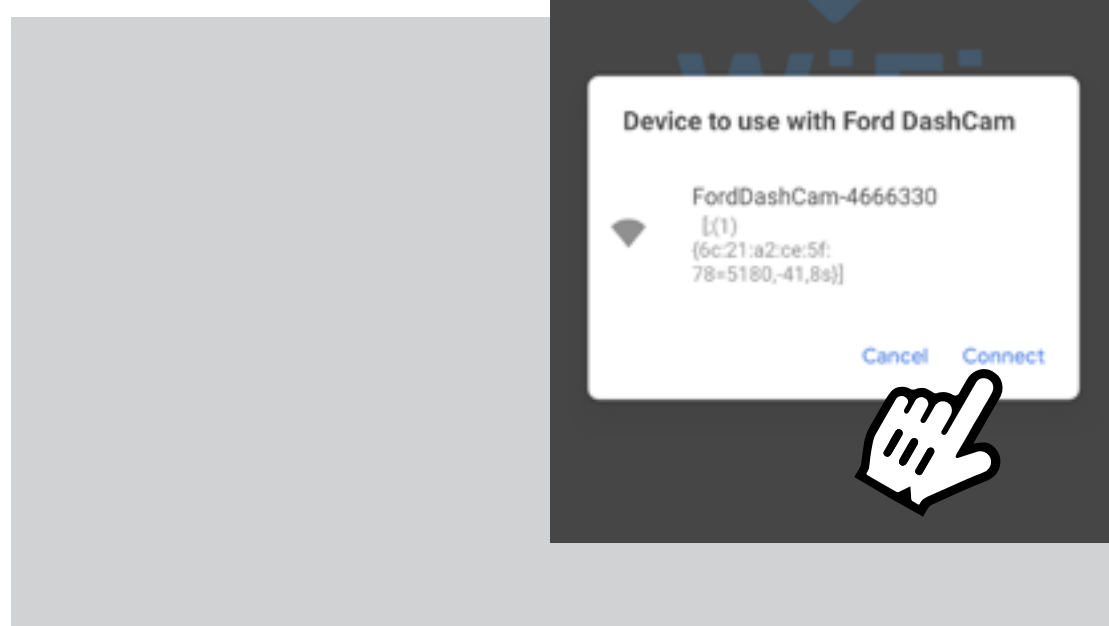

### 2. Until Android 10:

- ▶ Press on Ford DashCam-xxxxx
- ▶ Long press on Password area then press Paste
- ▶ Press “Connect”
- ▶ Click on phone “Back” button

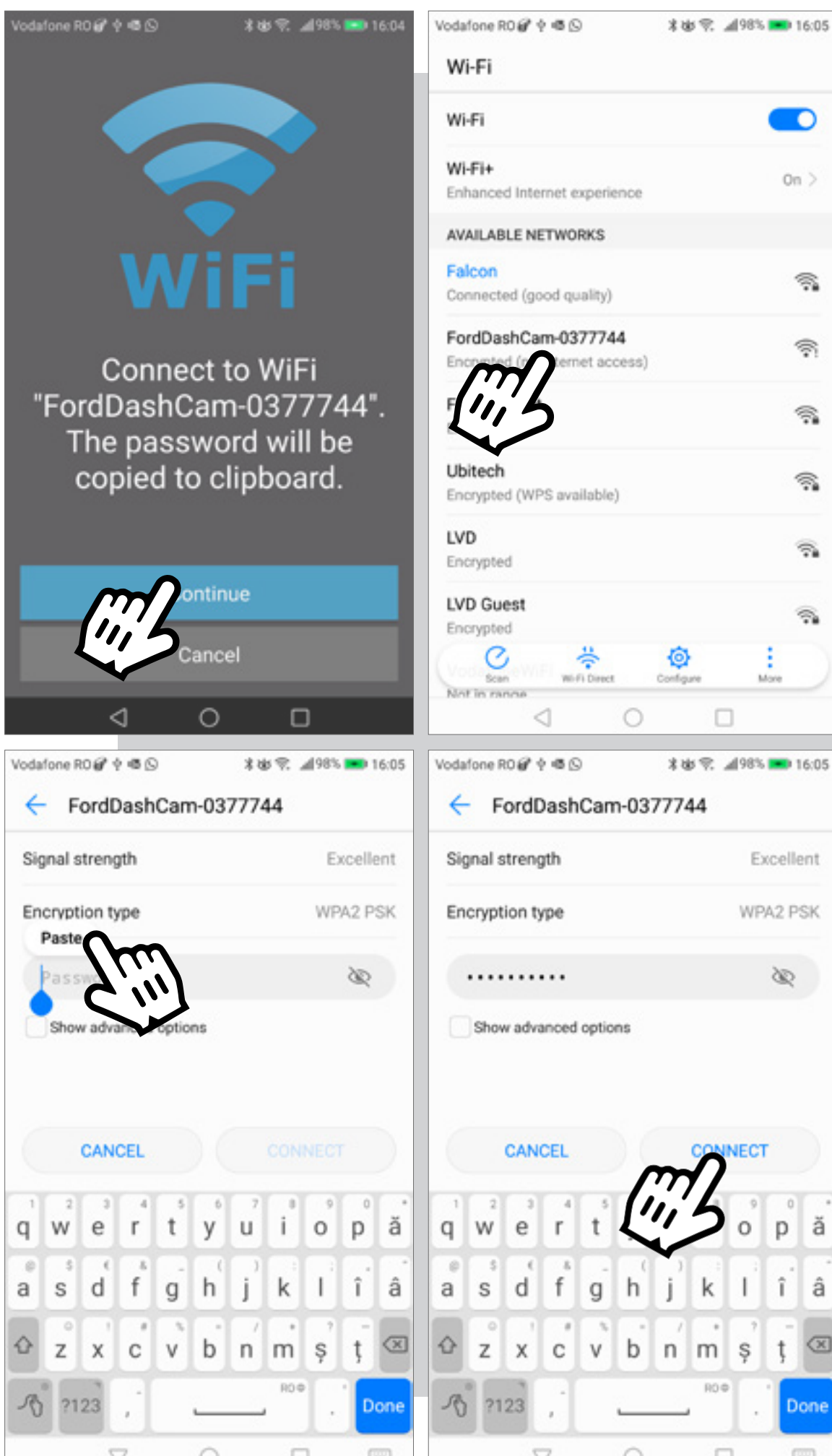



To view files from SD Card or Local Files navigation and options are almost the same.



The only way to play or view a file, is for the file to be locally downloaded on the phone.

When deleting files from SD Card section or Local Files section, please check if you are in the **DESIRED LOCATION**



▶ **View mode**

When tapping the SD Card files or Local files the view will be **All files**

There are 2 ways to display the files: **table view** or **contents view**

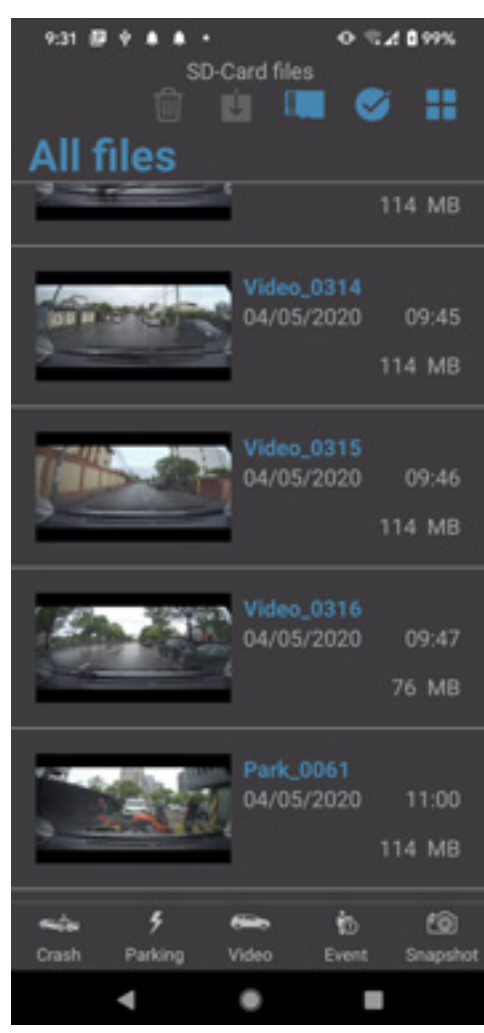

On the bottom of the screen there are multiple view options that you may choose:

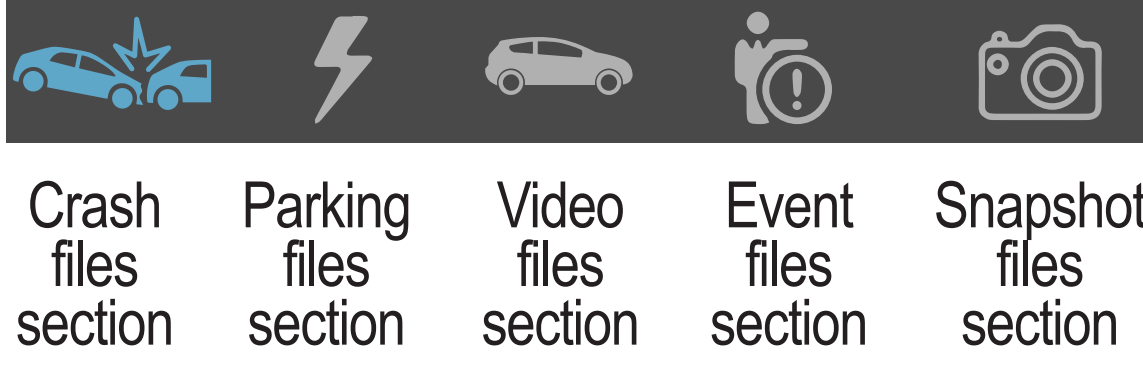

▶ **Enter select files mode**



▶ **Exit select files mode**

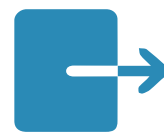

▶ **Download selected files**



▶ **Format SD Card**



▶ **Delete selected files**

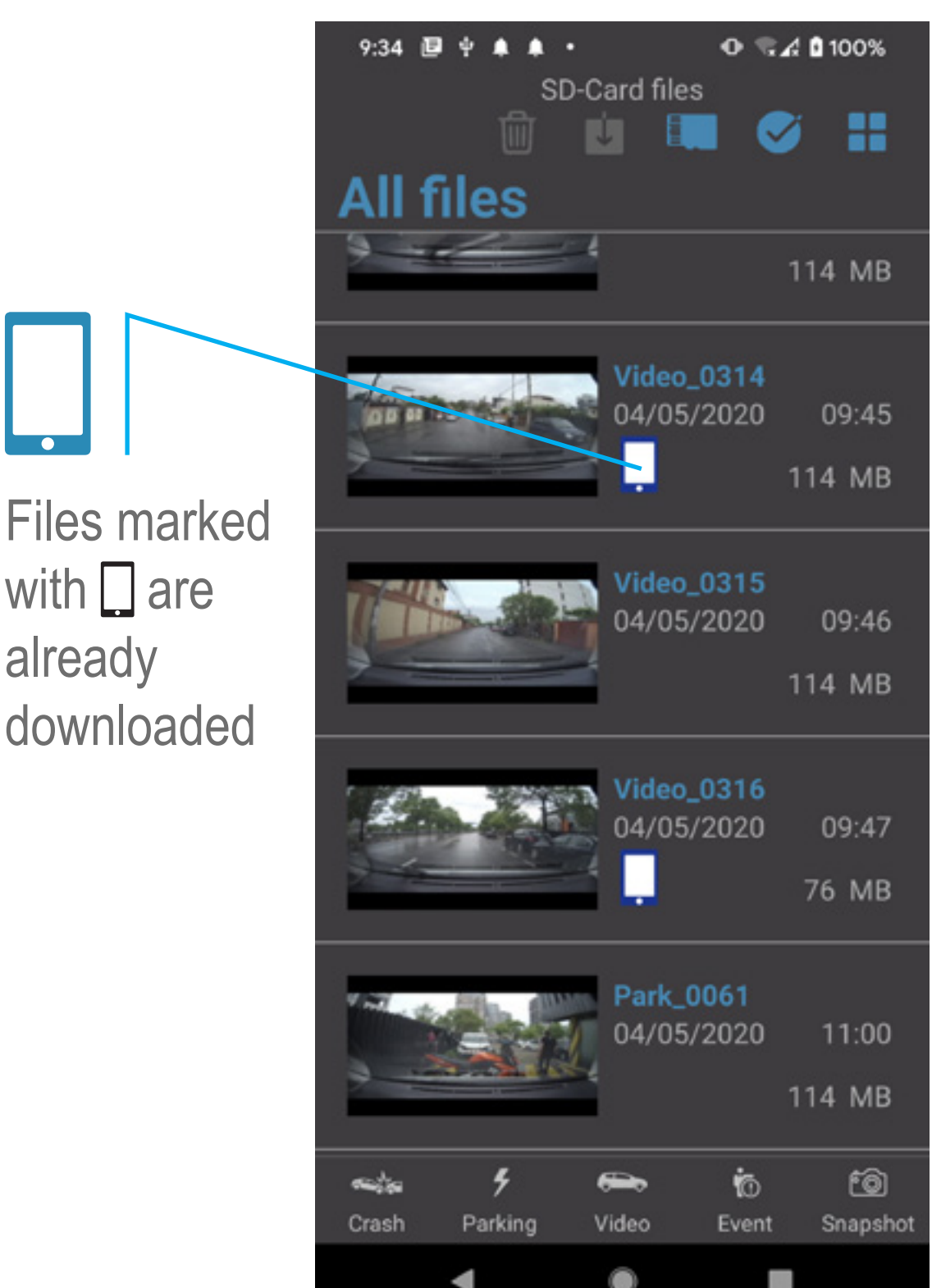

Files marked with  are already downloaded



In **Local Files** ▶ select file to Play



In **SD Card Files**

▶ Select the file to:



▶ play after download



▶ download



▶ delete from SD Card

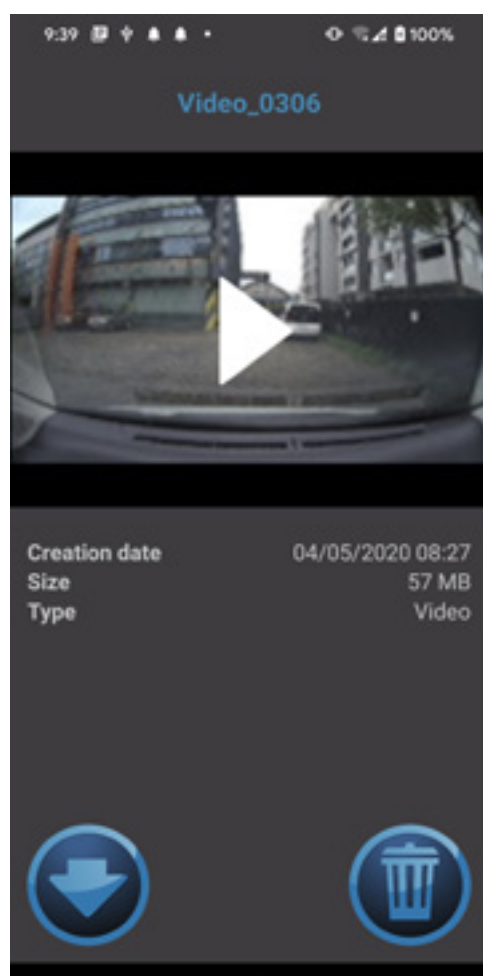

## 3.6

## Multiple file operations

Click on  or long press on any file to enter in the "select files mode".

Click on files you want to select then click  for downloading files, or  to delete the selected files.

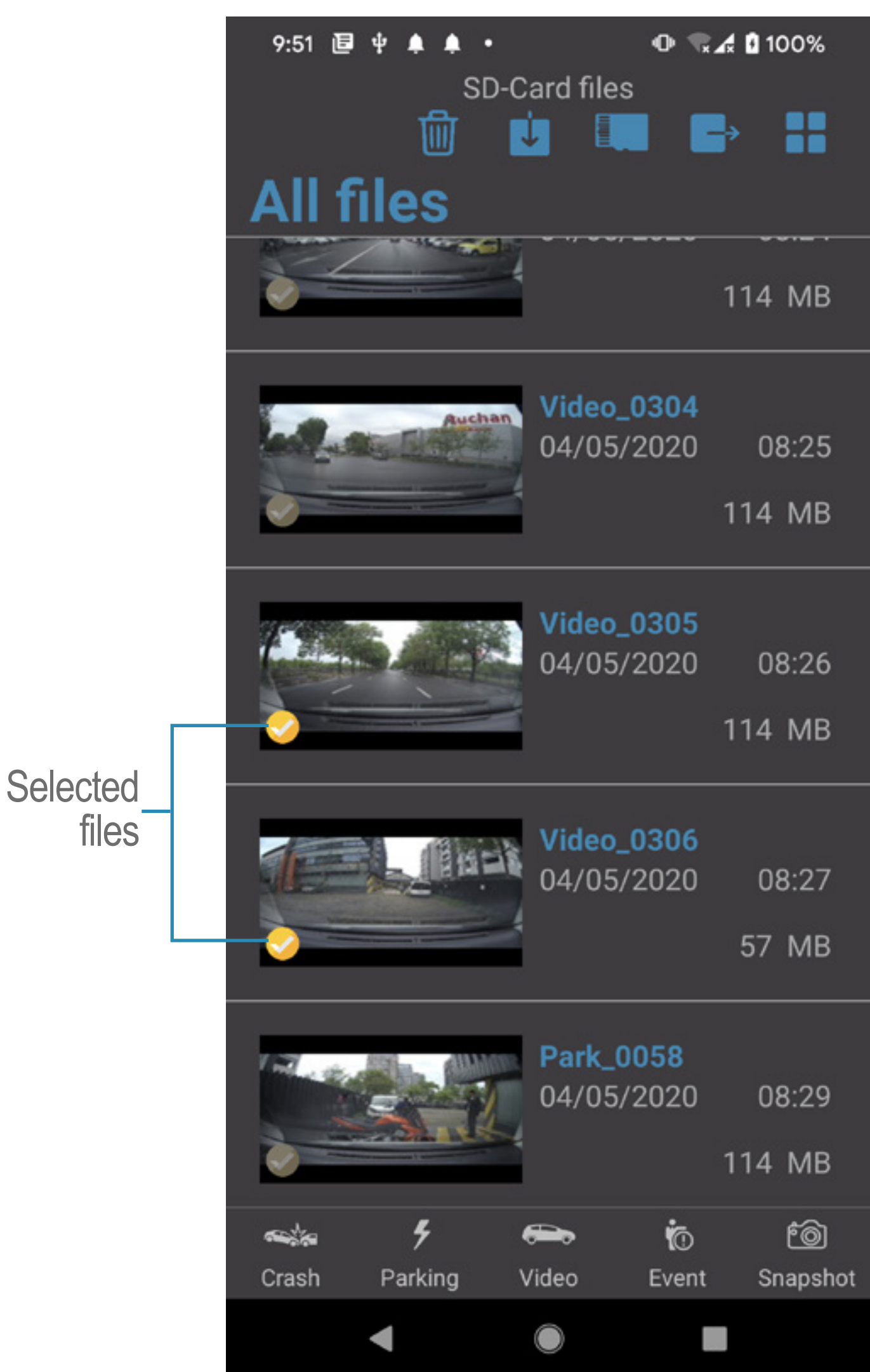

Click on  to exit the "Select files mode"

## 4.

## Settings



App control panel that allows the user to configure the appearance or actions

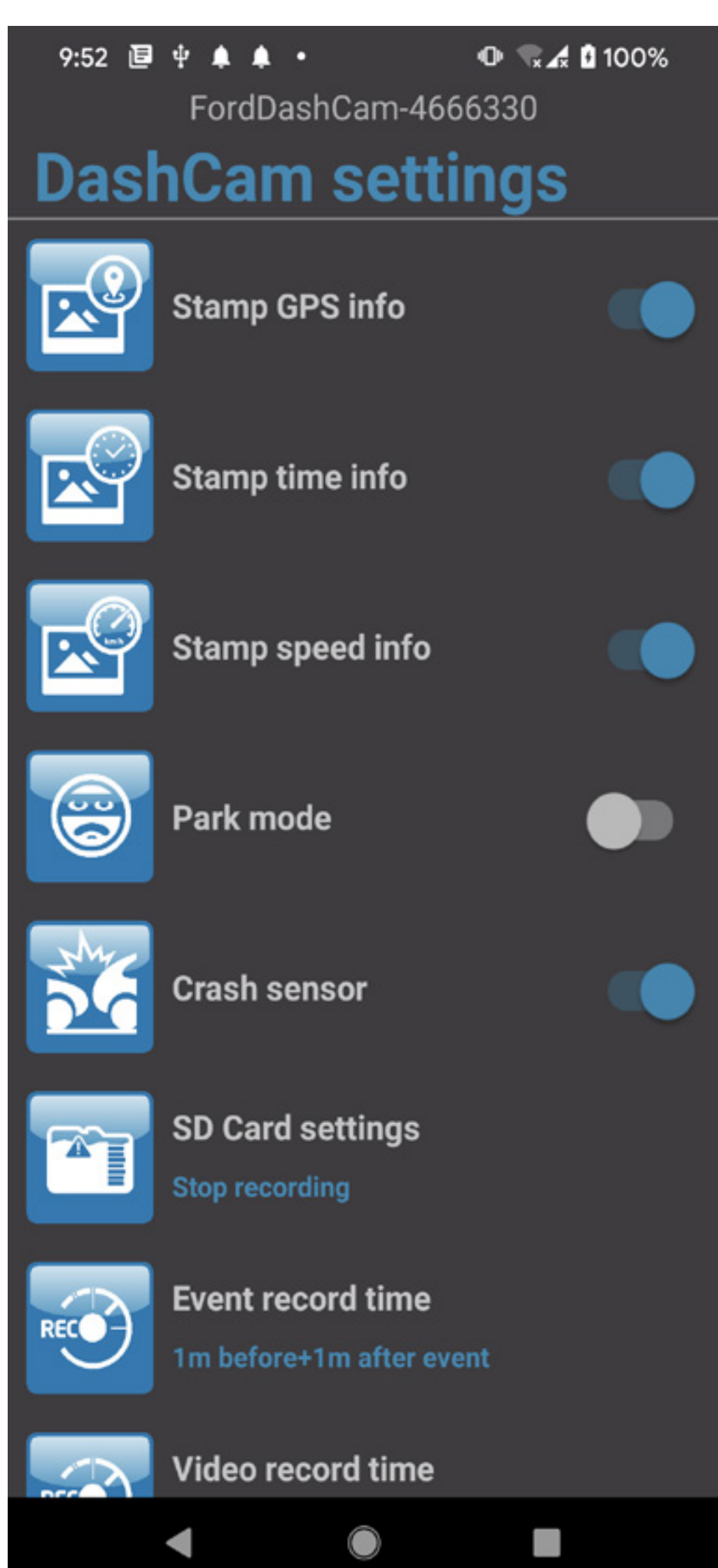

## 4.1

## Settings menu options



- ▶ **Stamp GPS Info** (default ON)  
Turn on/off to show/hide on video GPS coordinates



- ▶ **Stamp Time Info** (default ON)  
Turn on/off to show/hide on video Time and Date



- ▶ **Stamp Speed Info** (default ON)  
Turn on/off to show/hide on video the Speed of the vehicle

- 
- 
- 



- ▶ **Park mode** (default OFF)  
When activated, it records a 1 minute video protected file if the vehicle is parked and a shock is detected. The files can be found in the Park section of the SD Card files.



- ▶ **Crash sensor** (default ON)  
When activated, it records a 2 minutes video protected file (one minute before + one minute after) when a certain G level is exceeded during driving the vehicle.



- ▶ **SD Card settings**  
**Options:**
  - ▶ **Stop recording** (default)  
Using this setting, when the SD Card is full, the Dashcam will not record "Normal Video" files.
  - ▶ **Overwrite oldest files when card is full**  
With this setting, Dashcam automatically removes the oldest files from the "Normal video" section to make room for the new ones. This does not delete any crash, event, parking or snapshot file.  
The recording file priority is: Crash, Event, Park, Snapshot, Video.



- ▶ **Event recording time**  
**Options:**
  - ▶ 1 min before +1 min after event (default)
  - ▶ 1 min after event
  - ▶ 1 min before + 3 min after event
  - ▶ 3 min after event
  - ▶ 1 min before + 5 min after event
  - ▶ 5 min after event

The Dashcam has a **one minute buffer** that can be added to a 1, 3, or 5 minutes Event video.



- ▶ **Video recording time**  
**Options:**
  - ▶ 1 minute (default)
  - ▶ 3 minutes
  - ▶ 5 minutes

This setting defines the time frame for video recording.



- ▶ **Video configuration**  
These settings define the quality for video recording:
  - ▶ No HDR, 30FPS  
No High Dynamic Range, 30 Frames per second
  - ▶ No HDR, 60FPS (default)  
No High Dynamic Range, 60 Frames per second
  - ▶ HDR, 30FPS  
High Dynamic Range, 30 Frames per second



- ▶ **WiFi Channel**  
**Change/choose WiFi channel:**
  - ▶ Automatic – 2.4GHz
  - ▶ Channel 1 to 13 – 2.4GHz
  - ▶ Channel 36 – 5 GHz (default)



- ▶ **Format SD Card**  
Be aware to save the important files on mobile device before format the SD Card.
  - ▶ Press „**Format**” to erase all files from the SD Card



- ▶ **Firmware upgrade**  
Upgrade the Ford Dashcam firmware with the latest version





- ▶ **About**  
This menu is the same as the **1. About & Language**

## 4.2

## Start recording



- ▶ Press to start a Normal Video recording using the settings described earlier

When recording, the button  changes to  and on Live Streaming screen will appear **REC** .

### Live Streaming activated/deactivated

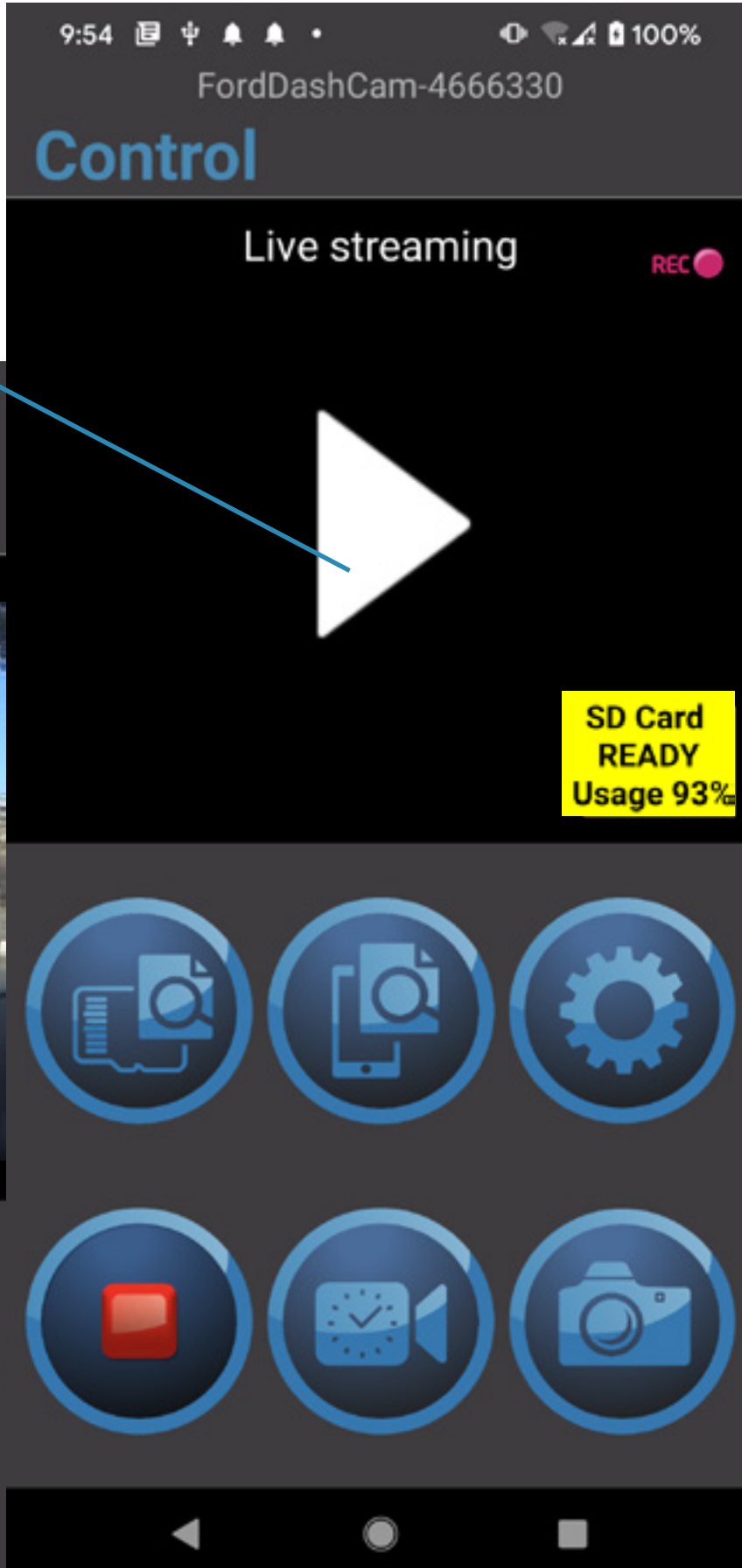

On the **Live Streaming screen**, you will see no image if you don't press **Play** button

## 4.3

## Start event recording



- ▶ Press  to start event recording using the settings described earlier.

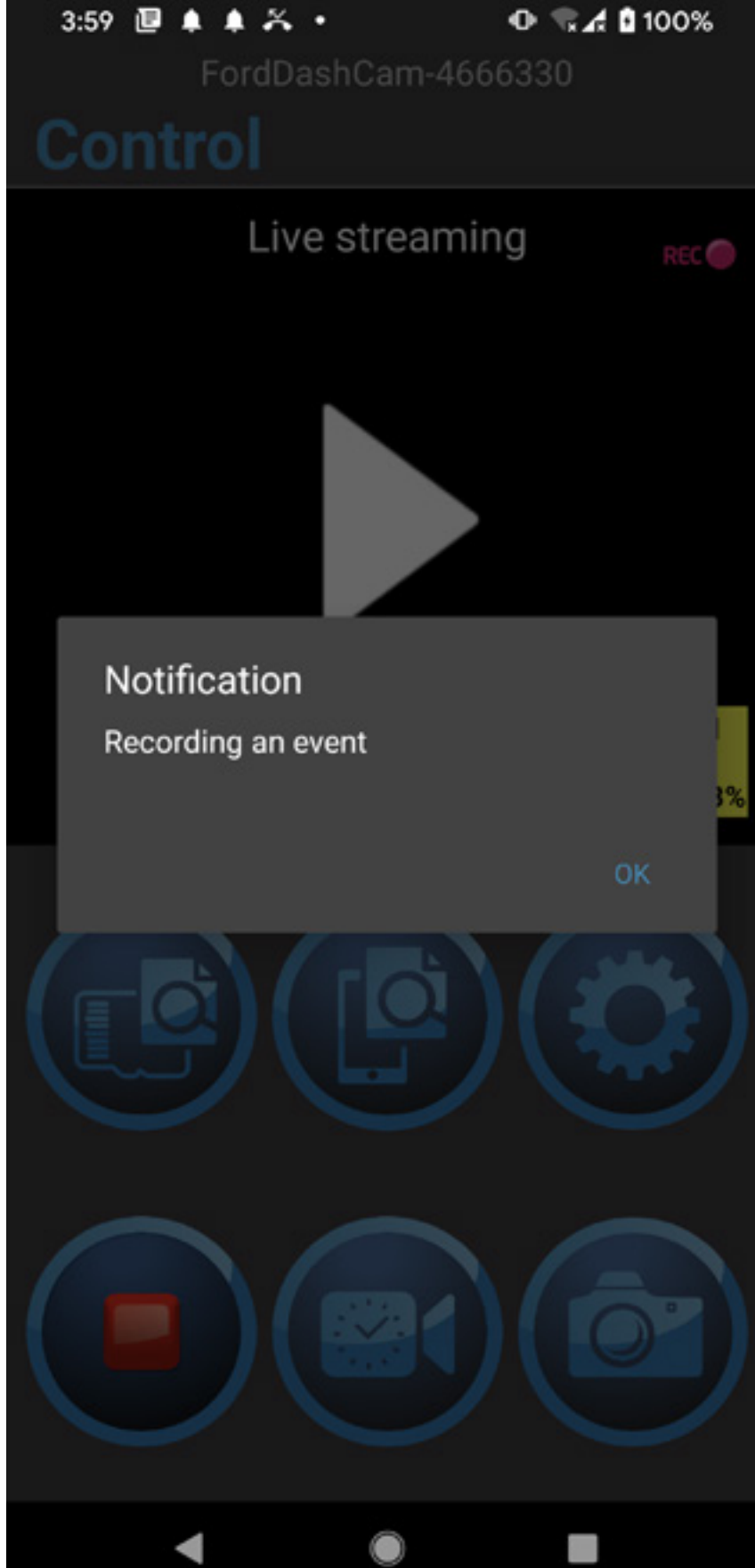

## 4.4

## Snapshot



- ▶ Press  to save a photo. The files can be found in the Snapshot section of the SD Card files.

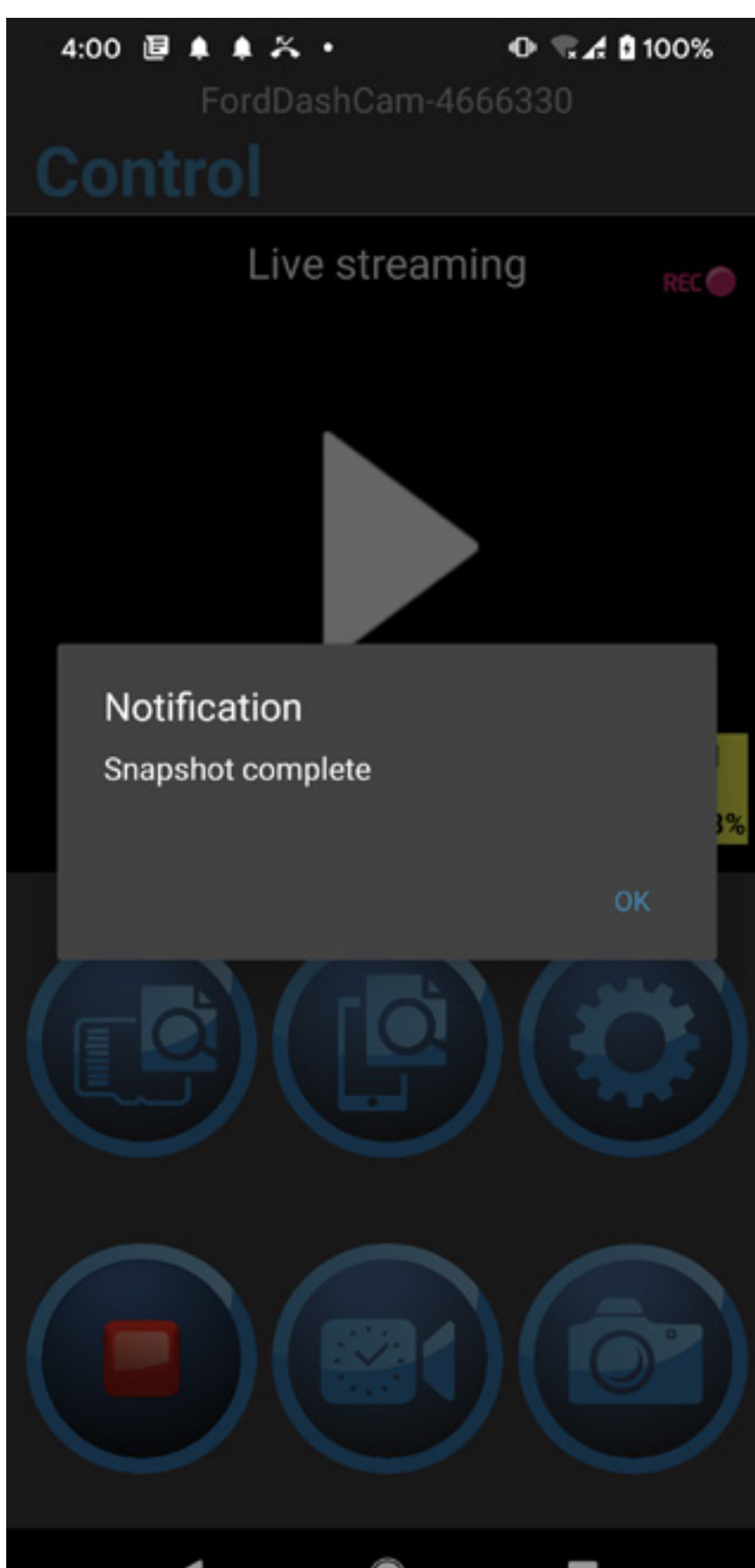

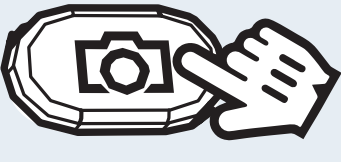
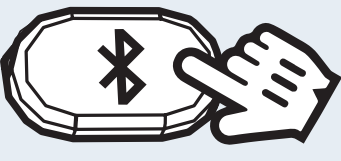

## 5. BUTTONS FUNCTIONS

| BUTTONS  | FUNCTION                     | ACTION  |
|--|------------------------------|---|
|    | Power ON / Power OFF         | Long press – 3 seconds  |
|  | Start Event recording        | Short press   |
|    | Snapshot                     | Short press   |
|  | Start Bluetooth (BT) pairing | Long press – 3 seconds (device status ON)   |
|  | Reset to defaults            | Long press (device status OFF / Ignition OFF) <ul style="list-style-type: none"> <li>▶ Press and keep button pressed</li> <li>▶ Turn the ignition ON</li> <li>▶ Wait until LED is White for 3s</li> <li>▶ Release button</li> <li>▶ LED will turn Green for 3s</li> </ul> |



**LED COLOR**

## 6. DEVICE STATUS – LED COLOR

| DEVICE STATUS                                   | LED COLOR                | ACTION                                    |
|---|--------------------------|---|
| Power ON / Valid SD Card inserted               | GREEN - 3 sec            |   |
| Power OFF                                       | GREEN - 3 flashes        |   |
| Power ON using Main Button                      | GREEN - 3 sec            |   |
| Reset to defaults                               | WHITE - 3 sec            |   |
| SD Card Full                                    | WHITE - Flashing quickly | Free some space on SD Card                |
| Enter Bluetooth (BT) pairing mode               | GREEN - Flashing         | see 2.1 Bluetooth (BT) pairing            |
| Start Video Recording                           | BLUE - 3 sec             |   |
| Stop recording                                  | BLUE - 3 flash           |   |
| Date / Time not set. NO file will be recorded.  | VIOLET - 10 Sec flash    | Connect Ford Dashcam App to mobile device |
| Park sensor triggered                           | BLUE - 10 Sec flash      | Check park video recording on SD Card     |
| The Dashcam is overheating                      | RED - 30 Sec             | Remove heat source                        |
| SD Card not present, not formatted or defective | RED - 2 flashes          | Insert, Format or Replace SD Card         |