



ELECTRIC BIKE CO.

EST. 2014



QUICK START GUIDE

www.electricbikecompany.com

For EBC How-to videos, tips & tricks of the trade,
please view our YouTube Channel:
youtube.com/c/ElectricBikeCompany

After you have unpacked your bike, please follow these steps to start using your Electric Bike Company Bicycle.

Reminder: Before riding your bike, please read entire user manual.

1

Locate the stem of the bike as shown in **figure 1**, which is near the handlebars and take off the stem bolt cap. After taking the cap off, use the 6 mm Allen key that came with your bike and loosen the stem bolt by rotating it counterclockwise. While keeping the wheels straight, move the handlebars to align with the front wheel of the bike. Once it is straight, tighten the stem bolt using your **6 mm Allen key** by rotating it clockwise to **22 Nm**. Make sure the stem bolt is tightly fastened.

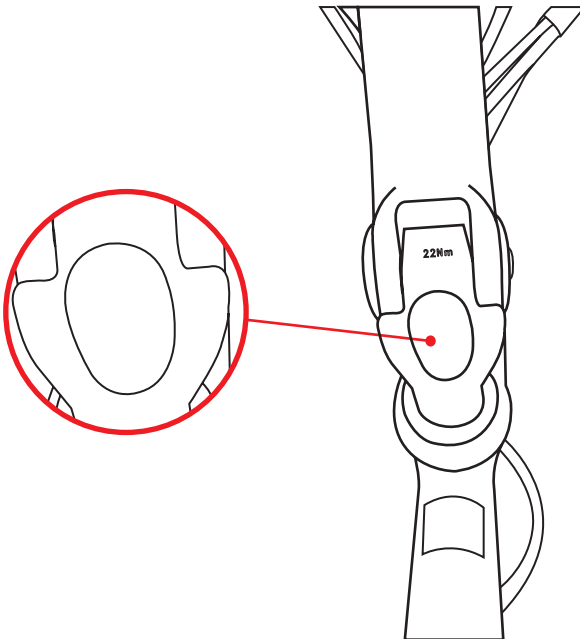
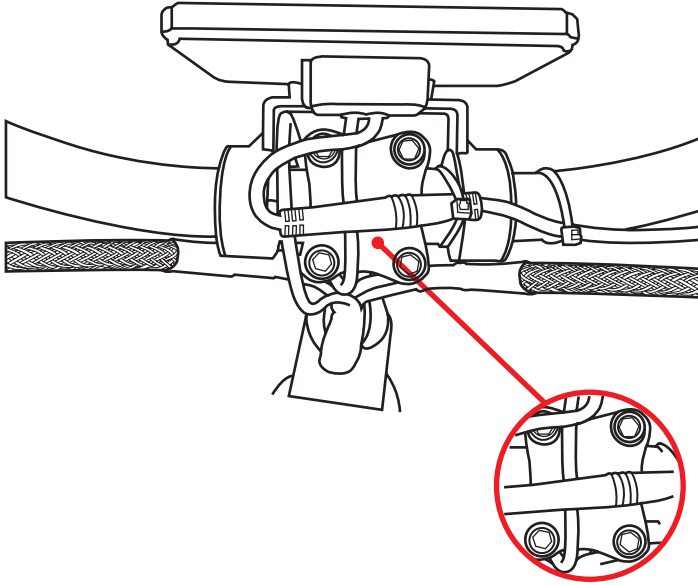

Figure 1

2

Locate the back of the handlebar clamp and loosen the 4 bolts as shown in **figure 2**. Use the **5 mm Allen key** that came with your bike to loosen the bolts. Once the bolts are loosened, you will be able to set your handlebars to your desired position. Once the handlebars are set to your desired position, tighten the 4 bolts located near the back of the LCD Screen. Make sure the 4 bolts are fastened to **14 Nm**.

Figure 2





**ELECTRIC
BIKE CO.**

EST. 2014



(Optional). If you wish to adjust the stem angle setting, locate the stem angle bolt as shown in **figure 3**.

Use the **5 mm Allen key** that came with your bike to loosen the bolt. Once loosened, you will be able to adjust the angle to your preference. Once set, fasten the stem angle bolt to **13 Nm**.

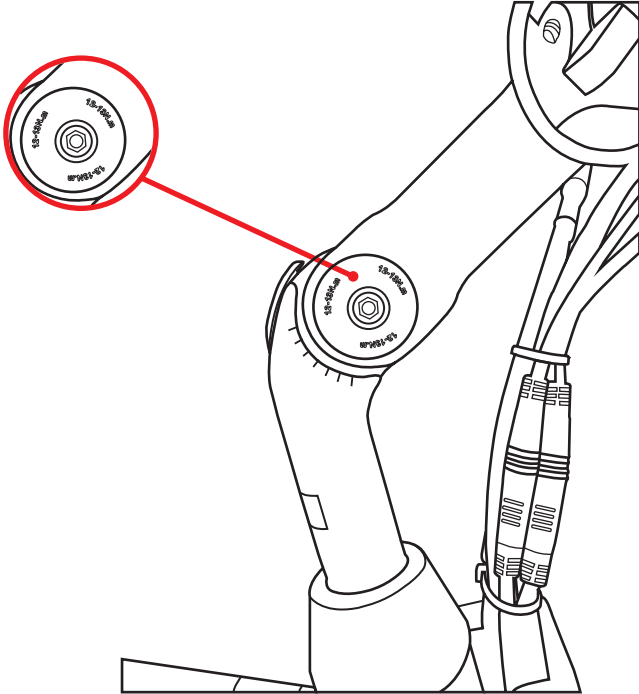

Figure 3

Bring the LCD display screen forward as shown in **Figure 4** to an approximate 45° angle or any other angle that you prefer.

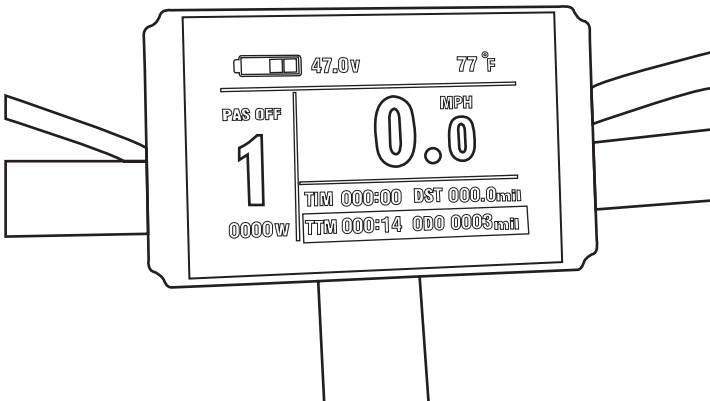

Figure 4

Turn the master switch on as shown in **figures 5 - 7**.

5

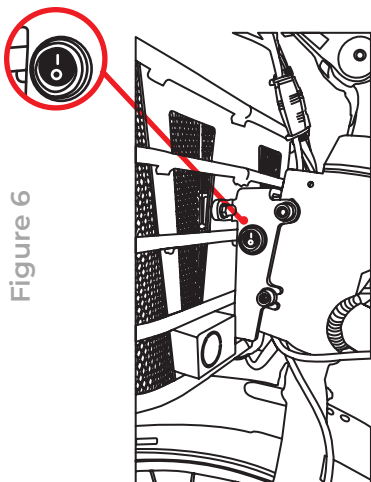

Figure 6

Model Y & M

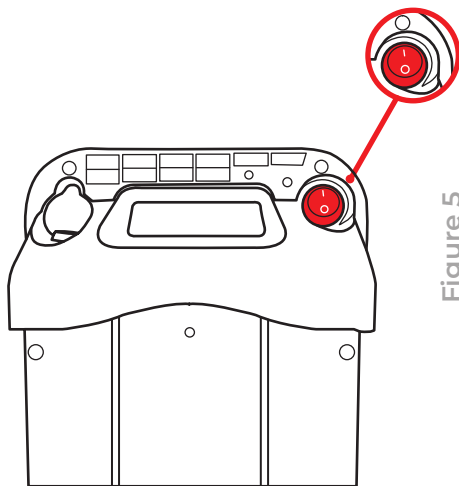

Figure 5

Model C & S

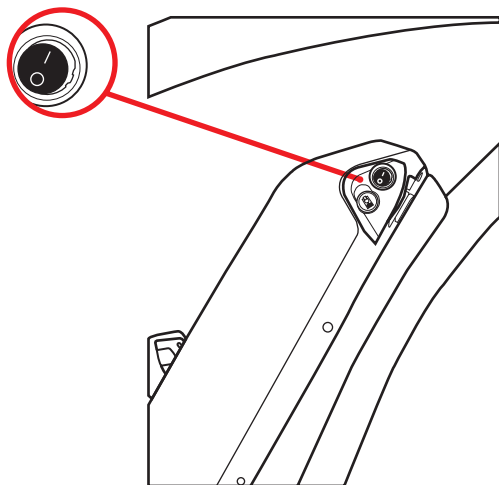

Figure 7

Model X

6

Hold down the power button as shown in **figure 8** for approximately 3 seconds to turn on the LCD screen controller. The power button is located on the left side of the handlebars.

Note: Remember the throttle is now live!

Troubleshooting: Sleep Mode

If battery has been left for a while it will automatically go into "sleep mode". You will need to turn master power switch "on" and "off", then "on" again to wake up the battery. Next turn on power switch at handle bars. If battery is charged, Bike is ready to ride.

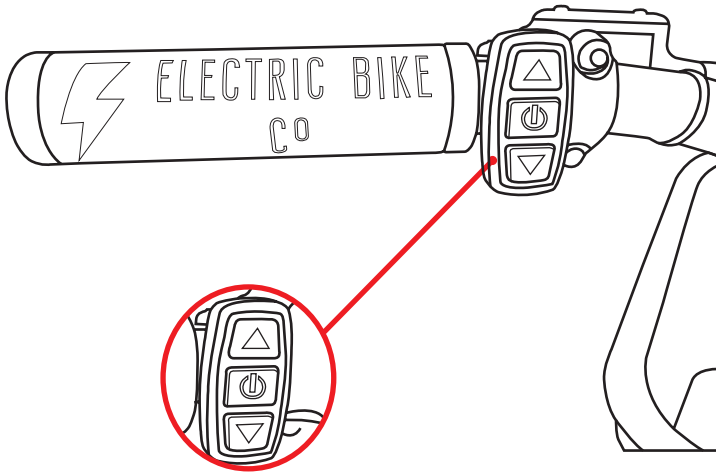

Figure 8



7

With the LCD display screen on, you are ready to ride in throttle mode. Hold down the throttle as shown in **figure 9** to move the bike forward. The throttle is set at the first level. To turn on pedal Assist mode, press and hold the down arrow as shown in **figure 8** for approximately 3 seconds. The word “PAS off” will disappear on the display screen.

Reminder: throttle is always live when turning on your bike.

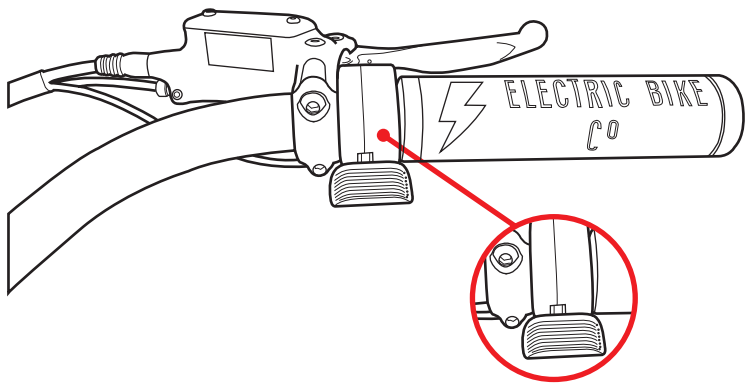

Figure 9

8

Your bike comes with a charger inside the white box marked “charger” for the X, Y, M, & R Models. Connect the power cord to the charger. Plug the power cord into a 3-prong outlet and the charging port of your charger to the charging port of your bike, as shown in **figure 10** for the Y & M Models, **figure 11** for the Model X, and **figure 12** for the Model R. The LED lights will turn red while charging and green once charging is complete.

Note: You can remove the battery from the bike frame of the X & R models to charge it.

Figure 10

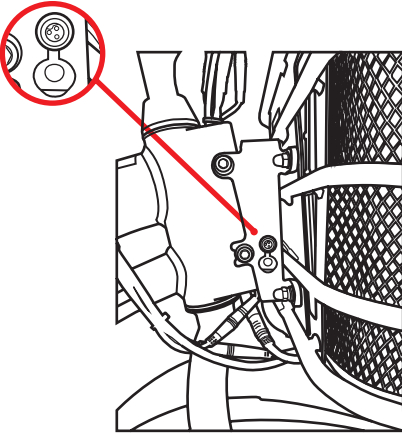

Model Y & M

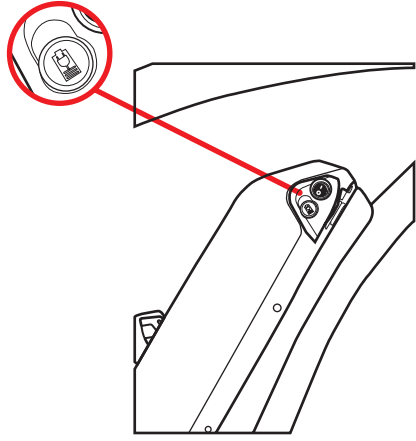

Model X

Figure 11

Figure 12

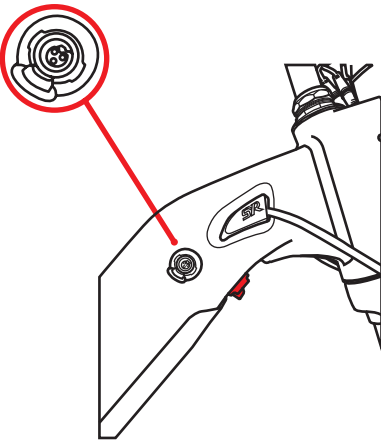

Model R

Method 1 to charge C & S models

Locate the power cord on the left side of the rear rack battery case and extend it to plug into a 3-prong power outlet.

Method 2 to charge C & S models

Purchase the 3.5 amp supercharger to charge your bike. Connect the power cord to the charger. Plug the power cord into a 3-prong outlet and the charging port of your charger to the charging port of your bike, as shown in **figure 13**. The LED lights will turn red while charging and green once charging is complete.

Note: You can remove the battery from the rear rack case to charge it.

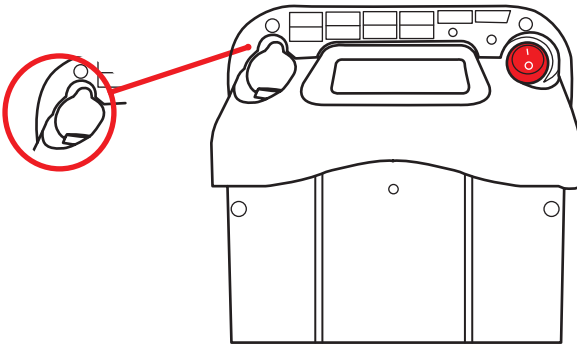

Model C & S

Figure 13

Using Pedal Assist:

Using the Up and Down arrows, you can set Pedal Assist from 0 to 5 speed modes. 1 is the slowest and 5 is the fastest. With Pedal Assist Mode On, the motor will now turn on when you begin pedaling, and you will not need to use the throttle. You do have the ability, however, to increase your speed with throttle application while using Pedal Assist Mode.

Note: It takes about **1 pedal rotations** before Pedal Assist kicks in and turns on the motor.

Important note: In the beginning, when you are getting used to the bike, it is always best to start out in Mode 1 and move up to the faster modes as you are riding. The motor increases in power as you move up the modes and will go fast in you are not expecting it. In zero mode, the Pedal Assist and the throttle are not active.

Activating Head and Tail Lights:

To turn On and Off the head and tail lights, simply press and hold the Up arrow as shown in figure 8 for approximately 3 seconds until you see the display light up.

Note: Nm stands for “Newton Metre”. Please use a torque wrench to fasten the bolts to the recommended Nm adjustment.

Battery Warranty

We warranty manufacture defect, but if its because the battery was not charged and went dead - it will not be able to recharge. You will need a new battery. The cost to perform a battery warranty exchange is \$289.00 including shipping. This fee is collected prior to us processing the warranty exchange. Upon receipt of payment we will send you a new battery with a return label provided. Upon return of the battery, if we find a manufacturing defect, we will fix it and refund you \$100 under our warranty program. If we find that it is not a manufacturer defect; for example, not charging your battery every 2-3 months during non-use, no refund will be offered.

10

Reminder

Before you begin your ride, please check to see if your disc brae on your front wheel matches the one that is on the back of your bike.

Please contact our Customer Support team to setup a battery exchange.

Remember to always charge your battery every 2-3 months when not in use.





ELECTRIC BIKE CO.

EST. 2014

Thank You For Your Purchase

Leave us a review at

<https://g.page/electricbikecompany/review?gm>

and earn a \$25 gift certificate by sending a link to your review at info@electricbikecompany.com

Send us your personalized referral code at info@electricbikecompany.com and earn a \$50 check every time a person uses your referral code

Quick Start Guide

<https://youtu.be/V6GH7EFrXwQ>

Watch the video above to get a brief overview of how to set up your bike after you take it out of the box