

Anleitung / Manual

PELLE OAK

DE + US

P-01-039

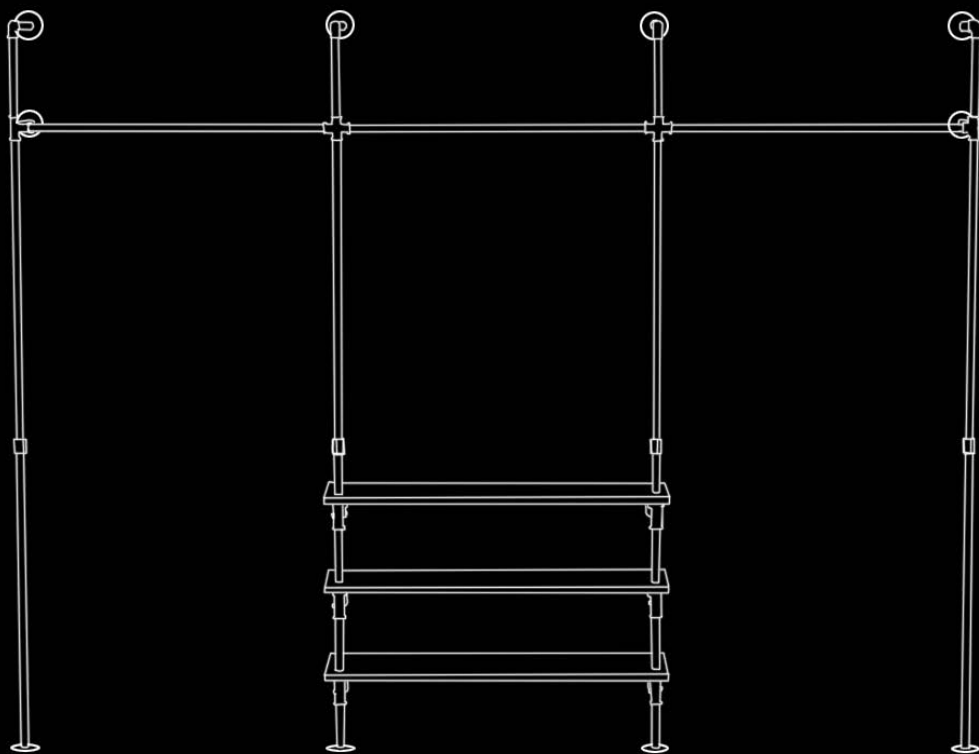

HOW-TO
VIDEO

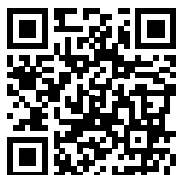

pamo.



! Warnhinweise beachten!
Observe warnings!



2 Personen /
2 persons

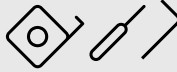

Werkzeug /
Tools



Unterlage verwenden /
Use Underlay

Lieferumfang / Scope of delivery



A × 10



F × 4



J × 24



I × 24



4mm



G × 6



B × 4



R × 3



O × 6



E × 10



C × 2



x20 × 6



x25 × 10



x93 × 11

**Bitte prüfen Sie alle Teile auf Transportschäden oder Macken.
Sollten Sie Transportschäden entdecken ersetzen wir sofort die entsprechende Teile.**

Please check the parts for transport damage or scratches.
If you find any damage, contact us and we will replace the defective parts.

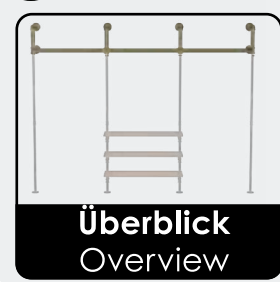
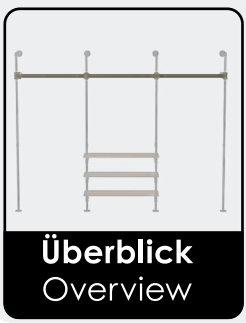
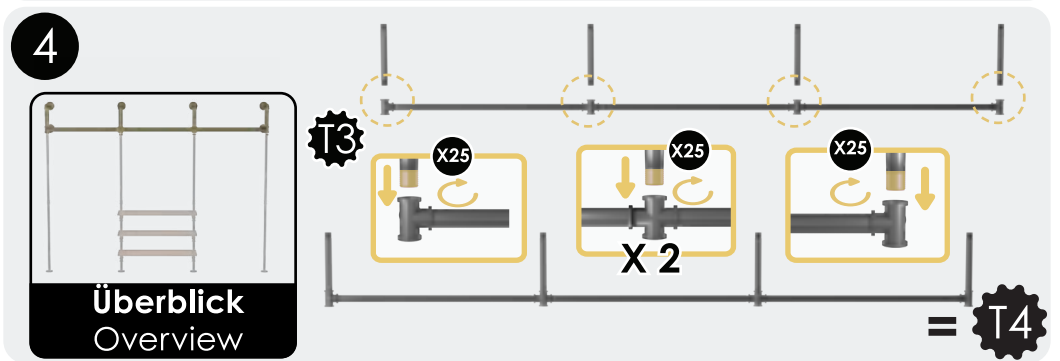
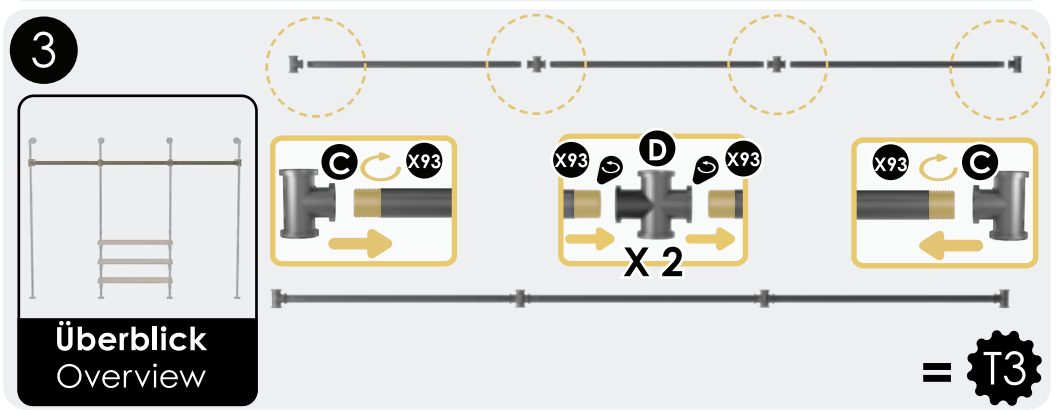
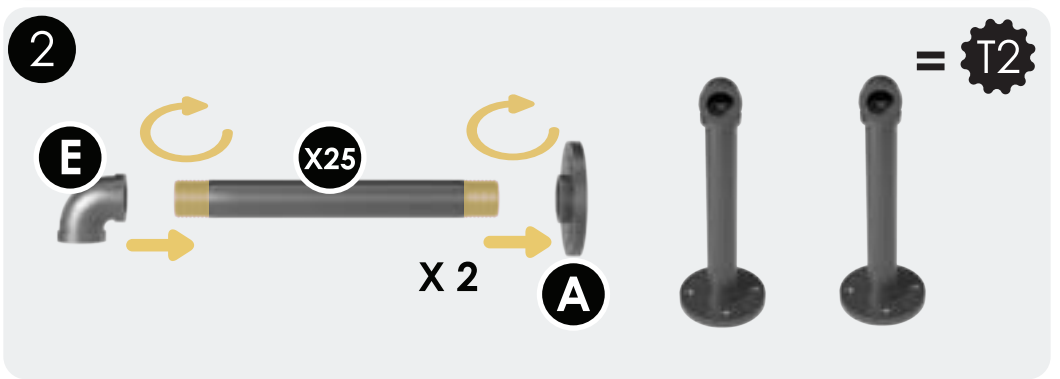
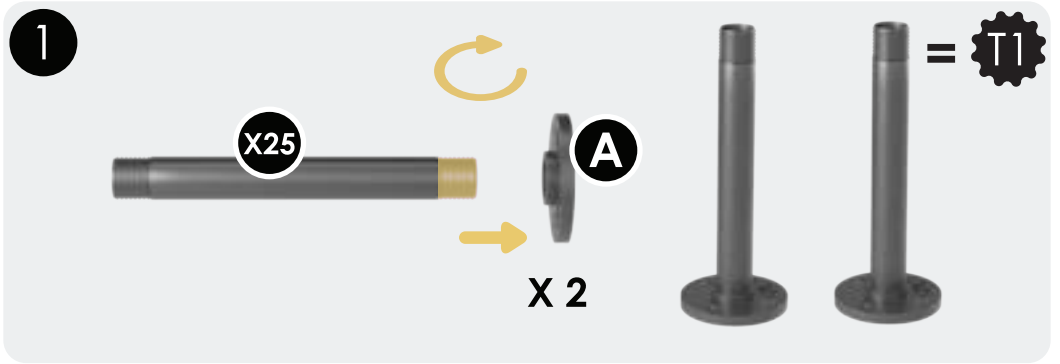

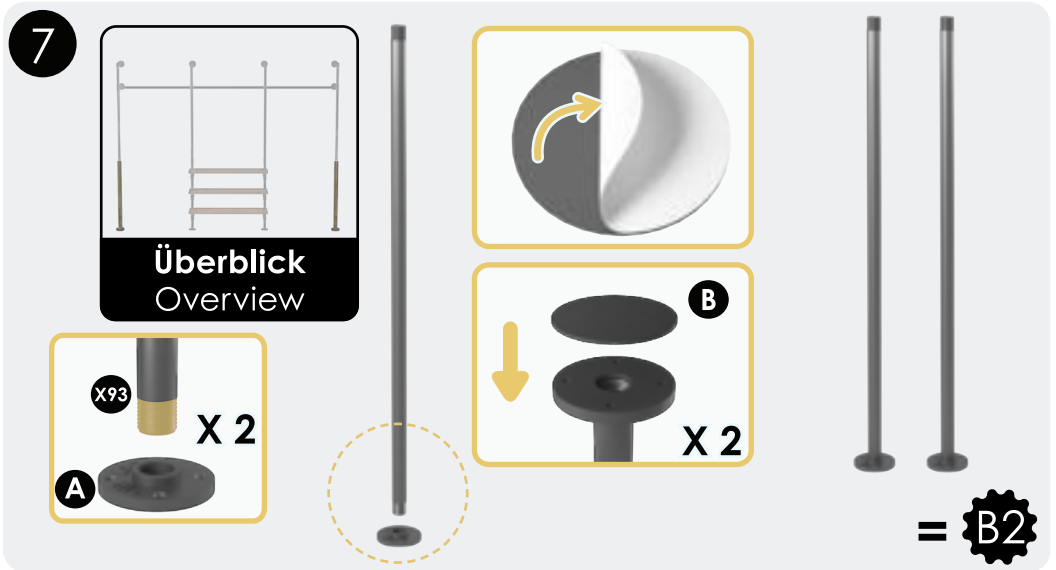
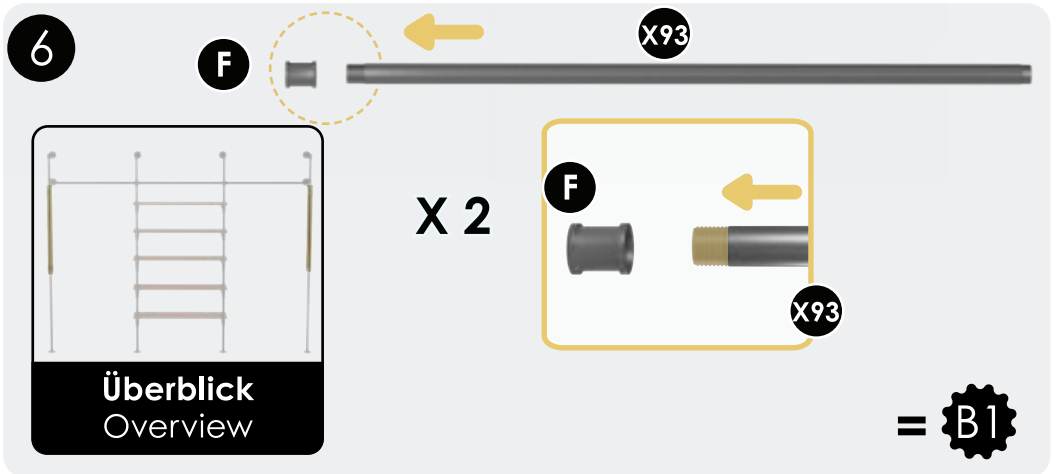
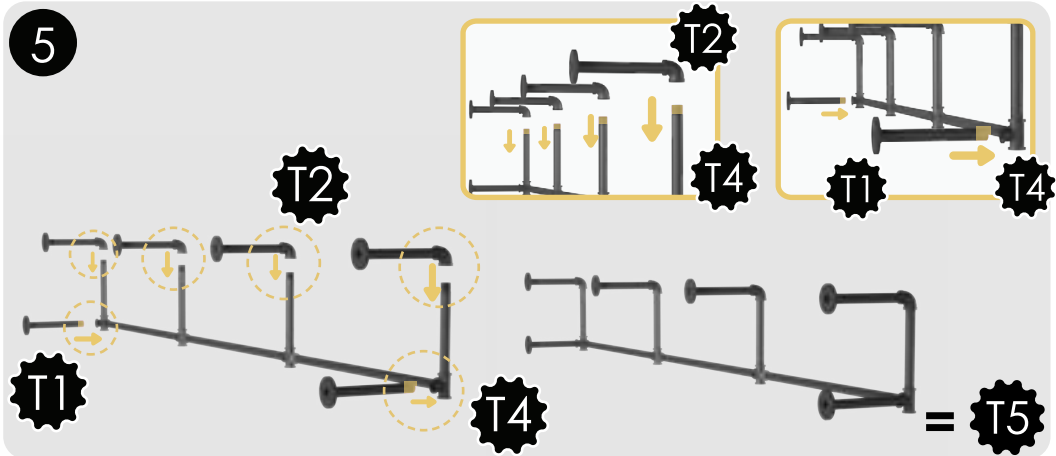

8

B1



B2

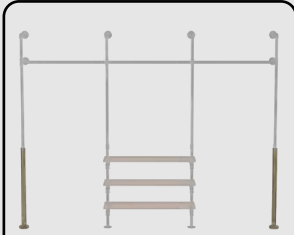

Überblick
Overview

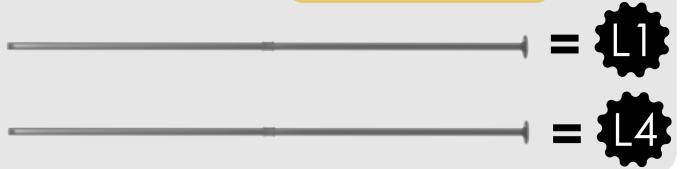
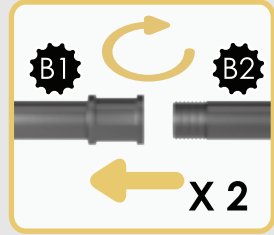

9



Überblick
Overview

E



G



X 6

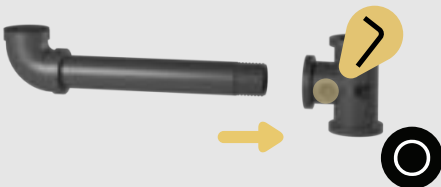
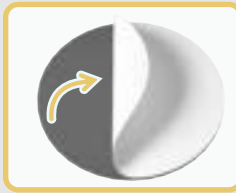

= WS

10

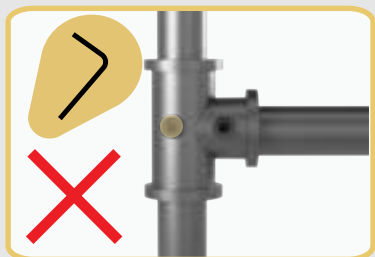
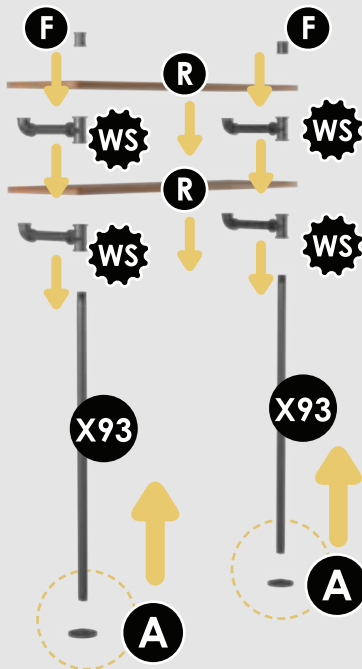
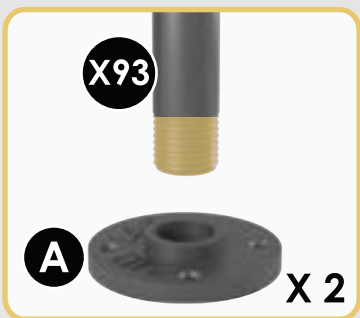
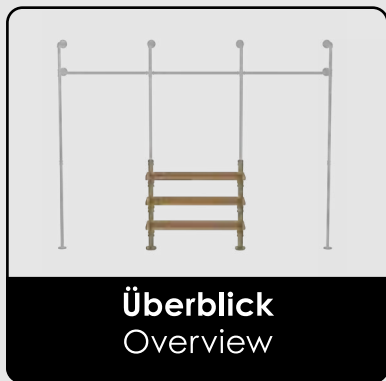

Stellen Sie sicher, die Schraube an der O-Rohrverschraubung **NICHT** festzuziehen, um Schritt 12 ausführen zu können.

Make sure "NOT" to tighten the screw on the O fitting to be able to execute step 12



11

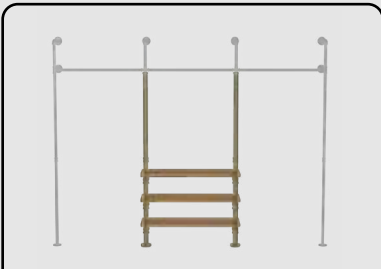

Überblick
Overview



12

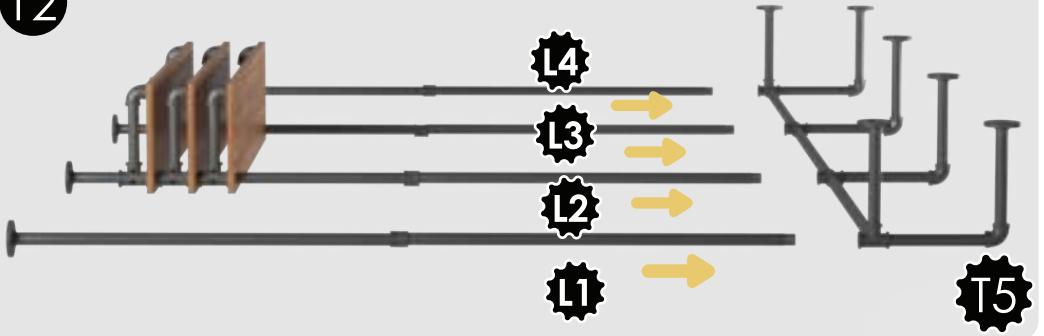

13

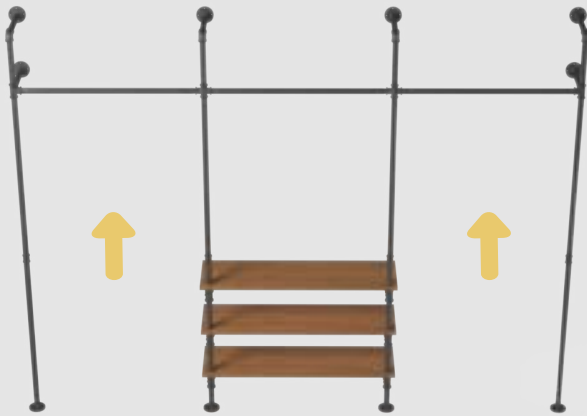

14

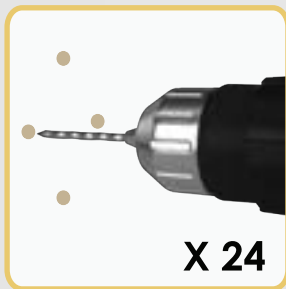
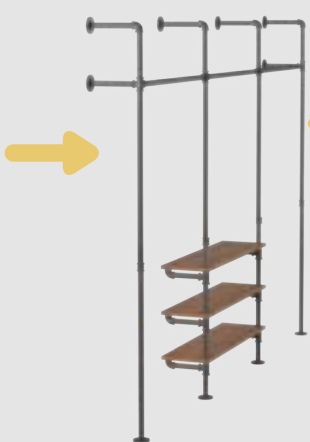

15

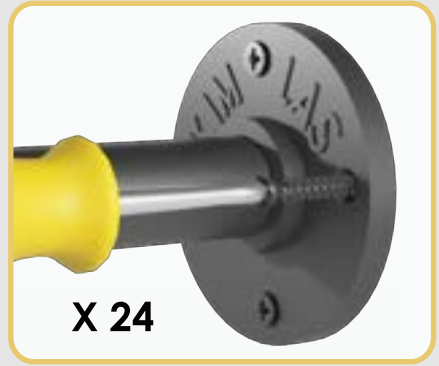
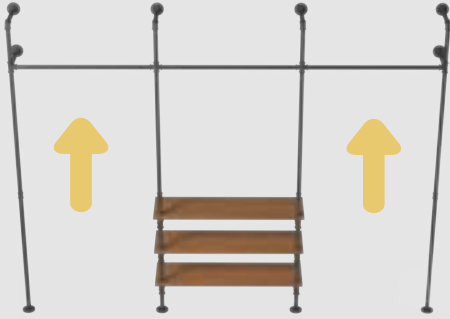

X 24

16

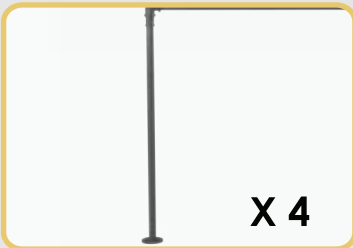
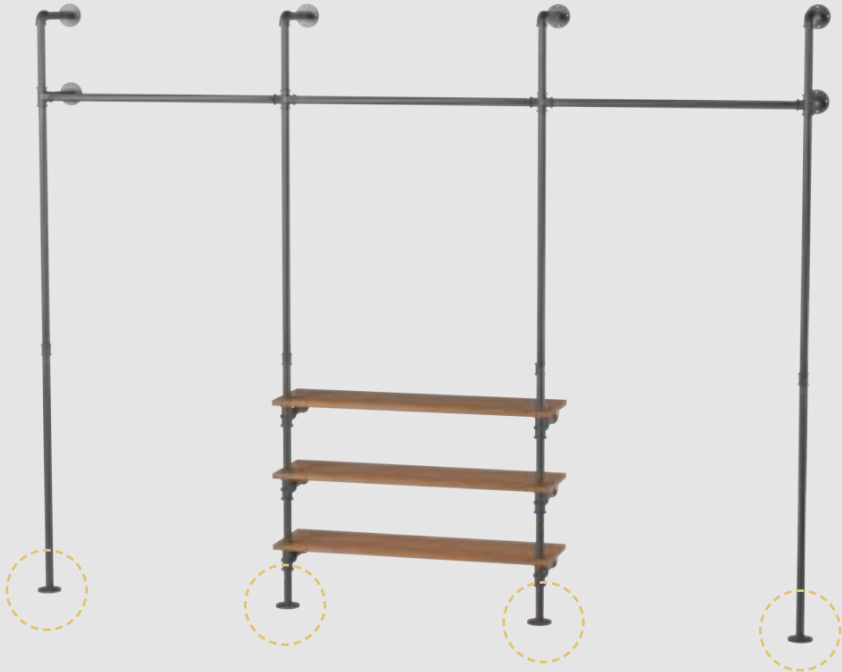

X 4

Zum Schluss Stange "A fitting" ein wenig herausdrehen und gegen den Boden zu verspannen. Damit erhält man eine zusätzliche Stabilität und gleicht Unebenheiten im Boden aus./

Finally, unscrew rod "A fitting" a little and brace it against the floor. This provides additional stability and compensates for unevenness in the floor.

17

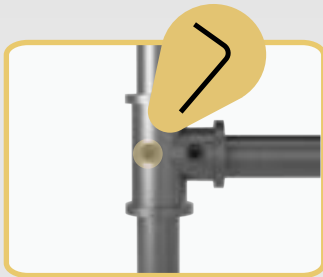
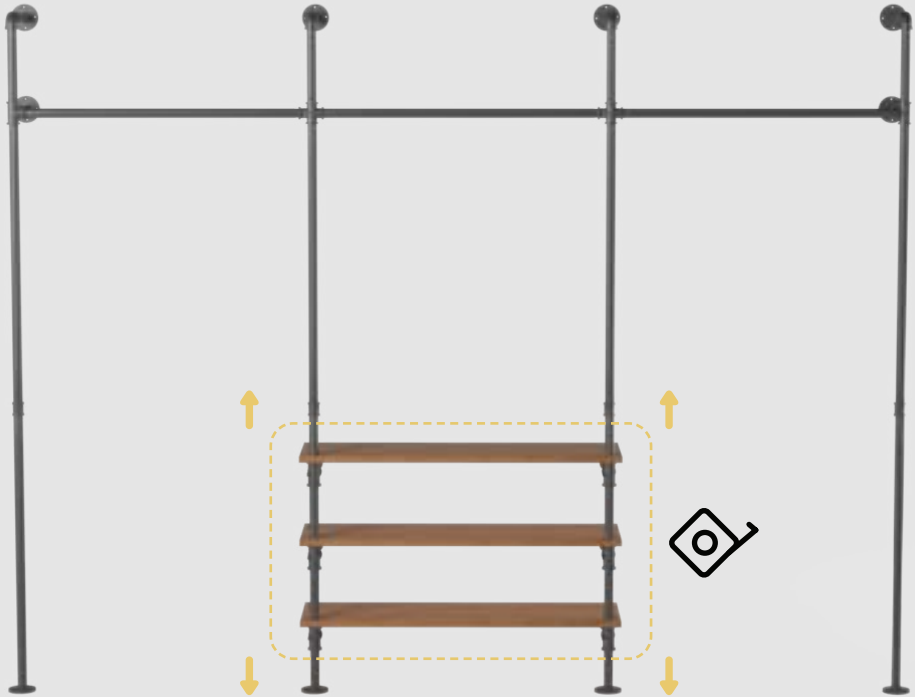

X 3

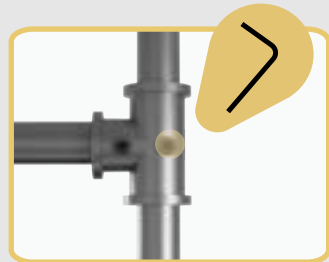

An die gewünschte Höhe anpassen

Adjust to preferred elevation

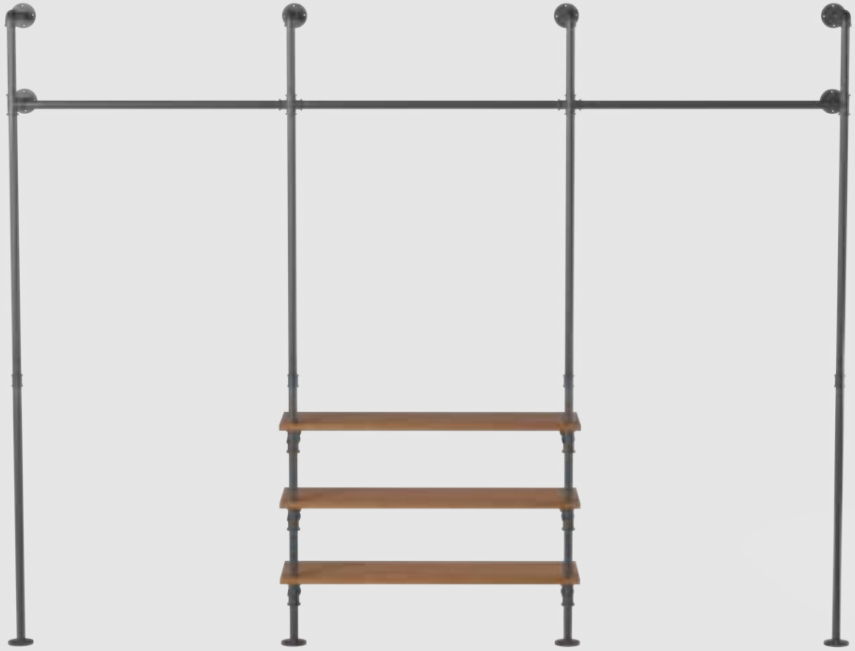

Wichtige Hinweise

Important notes

Nur zur Nutzung als Kleiderstange gedacht.

Intended only for use as a clothes rail.

**max. Belastung pro Boden 20 kg, max. Belastung pro Querstange 30kg.
Nur an tragfähigen Wänden montieren ggf. prüfen.**

*max. load per shelf 20 kg, max. load per horizontal pipe 30 kg.
Only mount on load-bearing walls, check if necessary*

**Bei unsachgemäßer Nutzung übernimmt SaleLab GmbH keine Haftung
oder sonstige Verantwortung für Sach- oder Personenschäden entstehen.**

*SaleLab GmbH assumes no liability or other responsibility for property
damage or personal injury resulting from improper use.*

**Viel Spaß mit deinem
pamo.-Produkt!
Enjoy your pamo.-product!**

Kontakt / contact

Wir helfen Dir gerne:

We are happy to help you:

EU

 support@pamo-design.de

 www.pamo-design.de

US

 support@pamo-design.com

 www.pamo-design.com

pamo.

Europe

SaleLab GmbH | Haydnstraße 28
88284 Wolpertswende | DE

USA

SaleLab Inc | 444 Brickell Avenue
Suite 700 | Miami, FL 33131 | USA