



BIONIK^{ZEPP} Instruments for the modified Tunneling Technique

46.040.00

Set for tunneling technique, consisting of
1/3 washtray, tunneling instruments
1 upper jaw, # 2 lower jaw,
3 upper /lower jaw
combination



reddot design award
winner 2010



Tunneling Instrument, # 1, for upper jaw, double-ended, exchangeable inserts, 18 cm

46.040.01



Tunneling Instrument, # 2, for lower jaw, double-ended, exchangeable inserts, 18 cm

46.040.02



Tunneling Instrument combination, # 3 upper /lower jaw, straight 1.8 mm, angled 1.7 mm, double-ended, exchangeable inserts, 18 cm

46.035.20

In microsurgery, **HELMUT ZEPF** tunneling instruments find their application in the preparation of flaps or subsequent reconstructions of the alveolar ridge or for root coverings with a connective tissue graft.

The instruments allow a minimally invasive tunneling preparation to avoid large openings.

Due to the fine shaped raspatories tunneling incisions in the tissue are possible.



Double-Action Instruments



22.830.17 Double-Action Micro Forceps, transmitted, **ZEPF-Line**, 17.5 cm, 1 x 2 teeth, thread plate 10 mm, jaw width 0.6 mm, SpinLock



41.017.17 Double-Action Micro Needle Holder, transmitted, **ZEPF-Line**, 17.5 cm, tungsten carbide, serrated, jaw width 0.6 mm, SpinLock



What is the ZEPF SpinLock?

The parallel lock known from standard needle holders has been replaced with the new SpinLock technology. This avoids that the suture material gets caught up on the needle holder.

conventional lock



SpinLock



The **HELMUT ZEPF** Double-Action Instruments are consisting of a Micro Needle Holder and a pair of Micro Forceps.

The instruments were technically modified in the region of the instrument lock. The usual parallel screw lock has been replaced by a new axially turned lock to reliably prevent the suture material from sticking to the needle holder during knotting.

Advantages of the Double-Action Instruments

- double transmission to allow tactile handling
- made of special stainless steel
- needle holder with tungsten carbide insert to guarantee a long service life
- due to the round shape, the rotation is considerably facilitated, in particular during suturing, contrary to usual flat micro needle holders
- the turned design prevents threads from getting stuck



ZEPF Micro Scissors

Onyx-coated scissors offer a 3-5 times higher surface hardness. In combination with the "Supercut" grinding, this guarantees an extremely long product life and application as well as a very high precision and wear resistance. The extraordinary surface smoothness is leading to an easy slide of the scissor blades even under highest strain.

Furthermore, the anti-glare surface avoids disturbing light deflections. The extremely smooth surface prevents adhesion of proteins.



Micro Scissors sharp/sharp, 45° angulated, **ZEPF-Line**, 16 cm

46.321.16 stainless steel

46.321.16TISC **onyx**



Micro Scissors sharp/sharp, curved, **ZEPF-Line**, 17 cm

46.319.17 stainless steel

46.319.17TISC **onyx**



Suture Removal Scissors by Dentist Beck



The newly developed **HELMUT ZEPF** Suture Removal Scissors are combining two functions in one instrument.

Sectioning and Retaining

The curved micro scissors won recognition for periodontal microsurgery. They are qualified for controlled cuts in the soft tissue and their main task is the sectioning of the suture (ill. 1).

They are curved for an ideal access to all oral regions. One blade of the scissors is micro-serrated to prevent the soft tissue and the thread from slipping off (ill. 2).

The new trademarked gripping function allows the scissors to be used for the sectioning of the suture and subsequent thread removal without requiring a second instrument (ill. 2).



46.319.17N

Suture Removal Scissors with retaining function for suture removal by Dentist Beck, micro-serrations, sharp/sharp, **ZEPF-Line**, curved, SpinLock, 17.5 cm

Needle Holder by Dr. Kirsch



Needle Holder by Dr. Kirsch, lock, double spring, SpinLock, 17.5 cm, TC



41.200.17TC-K straight



41.201.17TC-K curved



Macro / Micro Needle Holder



41.010.17TC-M Macro Needle Holder 18 cm, TC
macro bit 11 x 2.0 mm, straight, **ZEPF-Line**, titanium, lock



What is TC ?

TC stands for "Tungsten Carbide", a material whose superior strength wear resistance and hardness are its major properties that distinguish it from conventional materials.



Micro Needle Holder

ZEPF-Line, with lock and protected inner spring, SpinLock, TC



41.200.15TC stainless steel, 16 cm

41.200.17TC stainless steel, 17.5 cm



41.201.15TC stainless steel, 16 cm

41.201.17TC stainless steel, 17.5 cm



Micro Needle Holder



5/0 - 8/0



41.010.17TC Micro Needle Holder

TC, straight, **ZEPP**-Line, lock, SpinLock, 17.5 cm



5/0 - 8/0



41.011.17TC Micro Needle Holder

TC, curved, **ZEPP**-Line, lock, SpinLock, 18 cm



5/0 - 8/0

41.015.17 Micro Needle Holder

Hold'n'Cut by PD Dr. Weng, combined with scissors, SpinLock, TC



The front part of the Hold'n'Cut Micro Needle Holder holds the end of the needle when entering the flap.



The front part of the needle holder, together with the micro surgical tweezers, holds the thread ends when knotting.



The back part of the Hold'n'Cut Micro Needle Holder offers scissors for the cutting of the thread without changing the instrument or needing any additional scissors.



Micro Forceps with Diamond Coating

Some forceps can also be ordered with diamond coated tips for better grip.



Cooley 18 cm

22.815.17 stainless steel



Cooley 18 cm

22.816.17 stainless steel



Tissue Forceps 1 x 2 teeth, 17.5 cm

22.811.17 stainless steel

22.811.17D diamond-tipped



Tissue Forceps 1 x 2 teeth, 17.5 cm

22.810.17 stainless steel

22.810.17D diamond-tipped





Micro Forceps with Diamond Coating

Some forceps can also be ordered with diamond coated tips for better grip.

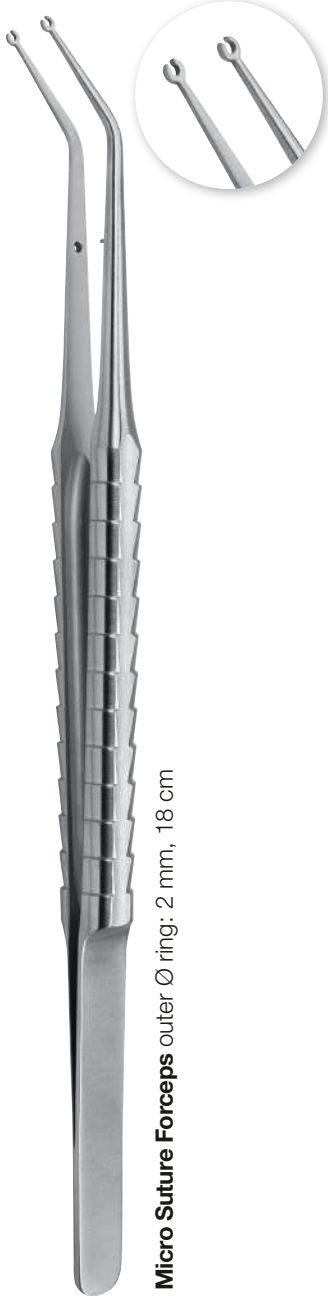

Micro Suture Forceps outer Ø ring: 2 mm, 18 cm

22.814.17 stainless steel



Dressing Forceps smooth, 18 cm

22.821.17 stainless steel

22.821.17D diamond-tipped



Dressing Forceps smooth, 18 cm

22.820.17 stainless steel

22.820.17TC TC inserts

22.820.17D diamond-tipped



Tissue Forceps Atraumatic, smooth, ring 1 x 0.5 mm, 18 cm

22.812.17 stainless steel

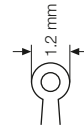

ImpacTray by PD Dr. Weng, Starnberg

The ImpacTray by PD Dr. Weng makes micro as well as macro surgical operations possible in implantology, periodontology and augmentation surgery.

The amount of necessary instruments is reduced to a minimum by developing and putting together an efficient, mainly double-ended and partially exchangeable instrument set.

The set composition is illustrated on the following two pages.

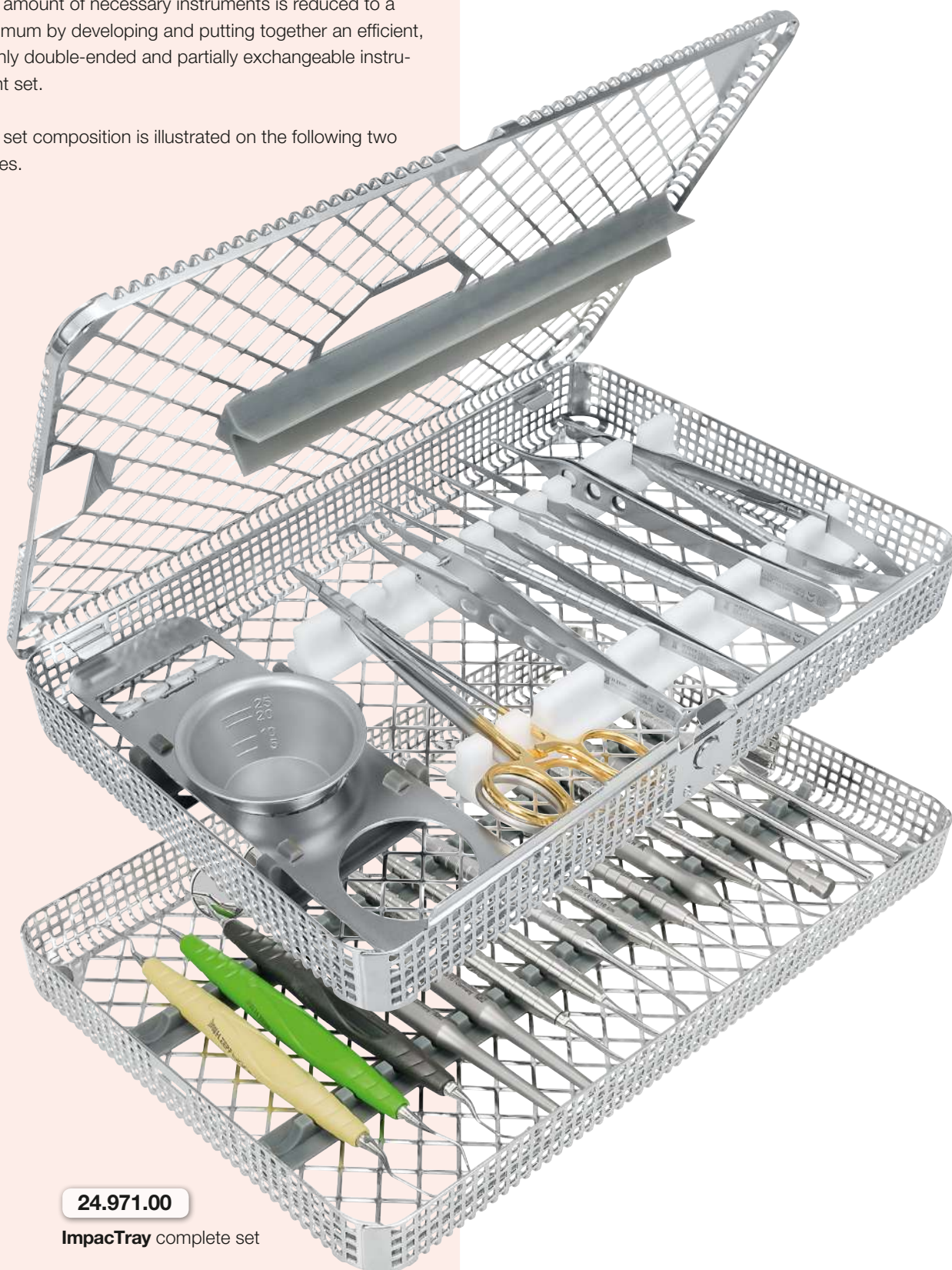

24.971.00

ImpacTray complete set



ImpactTray by PD Dr. Weng, Starnberg

The **ImpactTray** Set **24.971.00** incl. washtray consists of:



46.035.05 **PapillEx** Papilla Elevator by **PD Dr. Weng**, Starnberg



The blunt working end of the PapillEx has a lenticular shape and allows gentle elevation of the tip of the papilla by turning the instrument while positioned adjacently to the cervical part of the tooth.

The sharp working end, which is slightly bigger, is used to remove the periosteum from the bone along the sulcular or vertical incision.

Both working ends are exchangeable and can be removed from the instrument shank if necessary.



5/0 - 8/0

41.015.17 **Micro Needle Holder**

Hold'n'Cut by **PD Dr. Weng**, Starnberg, combined with scissors, SpinLock



85.252.25 **Medicine Cup** 25 ccm, stainless steel



3/0 - 4/0

41.252.15TC **Crile-Wood** straight, 15 cm



24.210.01L **bioH** Universal Curette, **Langer # L1/2**, black, exchangeable



24.208.03L **bioH** Universal Curette, **Langer # L3/4**, yellow green, exchangeable



24.201.05L **bioH** Universal Curette, **Langer # L5/6**, yellow, exchangeable



41.848.08 Sinus Elevator, double-ended 4.2 mm / 3.6 mm, blunt



22.489.00M Micro-Adson 1 mm, with suture disc, 15 cm



22.810.17 Micro Tissue Forceps, 1 x 2 teeth, 17.5 cm



46.081.16SC Joseph Scissors curved, micro serrated, 14 cm



22.025.03 Tweezers with stop-pin, ergonomic, 15 cm



24.087.02 Mouth Mirror Handle, titanium, Capstan-Line, with Mirror 24.071.22



26.183.00 Desmome for cutting the desmodontal fibres, titanium



24.747.04 Prichard Raspatory



24.747.06 Kirkland # 15/16, exchangeable



46.013.00Z Micro Surgical Scalpel Handle, titanium, ZEPF-Line, 13 cm



46.007.00 Scalpel Handle, ZEPF-Line, straight (without blade)



24.114.00 Probe combination by PD Dr. Weng, Starnberg

Papilla Elevators



46.035.05 **PapillEx** Papilla Elevator by **PD Dr. Weng**, Starnberg



The blunt working end of the PapillEx is lentiform and allows gentle elevation of the tip of the papilla by turning the instrument while positioned adjacently to the the cervical part of the tooth.

The sharp working end, which is slightly bigger, is used to remove the periosteum from the bone along the sulcular or vertical incision.

Both working ends are exchangeable and can be removed from the instrument shank if necessary.



46.035.00 **Papilla Elevator** to prepare fine soft tissue structures, **ZEPP**-Line, exchangeable inserts, 17.5 cm



Micro Scalpel Handles **ZEPP**-Line, 13 cm



46.013.00Z Titanium, included in the set illustrated on page **08-11**

46.013.05 Stainless steel

Micro Scalpel Blades for Micro Blade Holders, supplied in packs of 25 pieces



46.016.03 # 63, sterile

46.016.04 # 64, sterile

46.016.07 # 67, sterile

46.016.09 # 69, sterile

ZEPF Soft Tissue Micro Instrument Basic Set

24.967.05

ZEPF Soft Tissue Micro Instrument Basic Set

85.180.00

Incl. washtray 1/1, with 2 instrument supports and 1 longitudinal instrument retainer, dimensions: 275 x 178 x 24 mm

containing:

① 22.810.17

Tissue Forceps, straight, stainless steel, ZEPF-Line, with guide pin, 1 x 2 teeth, 17.5 cm

② 41.200.17TC-K

Needle Holder by Dr. Kirsch, straight, TC, lock, double spring, SpinLock, 17.5 cm

③ 41.864.13

Raspatory, ZEPF-Line

④ 46.319.17

Suture Removal Scissors with micro-serrations, sharp/sharp, curved, ZEPF-Line, stainless steel, 17 cm

⑤ 46.013.00Z

Micro Surgical Scalpel Handle, ZEPF-Line, light version, titanium, 13 cm



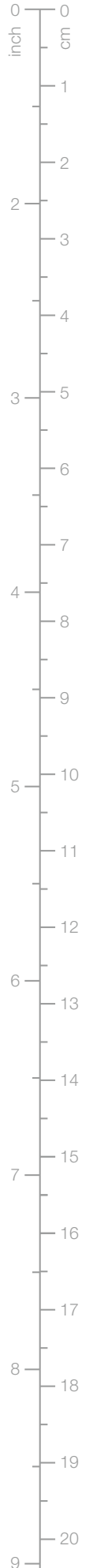

zepi-dental.com



MADE  **IN GERMANY**

The instruments illustrated in this catalogue are subject to modifications regarding technical progress and improvements.

Scale