

PRODUCT DESCRIPTION

\ User Guide \

Thank you for choosing the C8 Dual Dynamic Drivers Earphones developed by UiiSii! To better use this product, please read the Quick Start Guide carefully before use and properly manage it.

\ Product Specifications \

Speaker size	6mm
Frequency range	10~40000Hz
Cable length	120cm
Sensitivity	106±3dB
Impedance	16Ω
Plug pin	Type-C

\ Product Information \

■ C8

1. Nipple-level bullet silicone case
2. Gold plated ornament
3. Special ear hook
4. Mesh
5. TPE tail rubber
6. Volume+
7. Answer/Reject /Play/Pause /Previous/Next
8. Volume-
9. Cable gear
10. Type-C

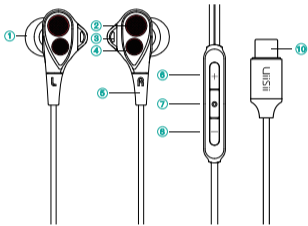

\ Directions on the Karaoke Voice Changing Earphone \

Plug the earphone into your mobile phone. The default setting is normal (without in-ear monitor monitoring).

Button 1: Press short to gradually decrease the volume. Press long to rapidly decrease volume.

Button 2: Press short to pause, double click to play the next song, and click three times to play the previous song.

Press short to pick up or hang up on incoming call. Press long to ignore the call.

Button 3: Press short to gradually increase the volume. Press long to rapidly increase the volume.

Double click to change the sound effect mode in a forward direction and click three times to change the sound effect mode in a backward direction. Button 1:

\ Directions on the Karaoke Voice Changing Earphone \

Sound Effect Mode Loop Sequence:

- Mode A (Theater Mode, without in-ear monitoring)
- Mode B (Natural Voice Mode, with in-ear monitoring)
- Mode C (Singing Mode, with in-ear monitoring)
- Mode D (Male to Female Voice Change Mode, with in-ear monitoring)
- Mode E (Female to Male Voice Change Mode, with in-ear monitoring)
- Mode F (3D Gaming Mode, without in-ear monitoring)
- Mode G (Normal Mode, without in-ear monitoring)

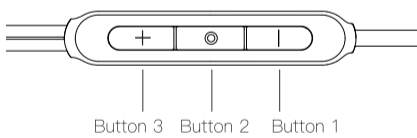

\ Earplug Selection \

Bullet silicone case



Bowl silicone case



The suitability of the earplugs will affect the sound quality. If it is correctly worn, you can better isolate the outside interfering noise, strengthen bass response, acquire better tonal balance, and allow the earphones to better fit into your ears. Meanwhile, correct wearing will also make you feel more comfortable. As everyone's ear shape is different, UiiSii offers several differently sized earplugs. Trial and error are required to obtain the earplugs that can perfectly match your ear shape. Please find the earplugs that most suit the size and profile of your ear canal in all the earplugs attached to the earphones you have purchased. We recommend you try the smallest earplugs first, and then try the bigger earplugs, until you find the earplugs that fit and are kept in the ear in a not-easy-to-fall and comfortable manner. You can also try different types of earplugs to find the type that suits you most.

\ Maintenance And Storage \

■ It is important to keep the earphones clean for safe and healthful use.

1. Do not wear the in-ear earphones that are dirty.
2. When the earphones are out of use, please always store it in the clean dry environment provided.
3. Do not store it with other articles, as it may cause pollution.
4. Avoid storing it in the environment that is too hot or too cold.
5. Avoid contact with liquid, and avoid extreme temperature or high humidity environment.
6. Do not stiffly pull out the earphones from the music player, but hold the terminal plug and pull it out to disconnect it.
7. Do not dismantle the earphones in an unprofessional and non-standard manner, to avoid partial sound of the earphones.

\ Frequently Asked Questions \

■ Bad sound quality

1. Please confirm if the earphone plug is fully inserted into the headset jack of the player.
2. Please confirm if the earplugs are tightly plugged.
3. Please try to change a player or music playing application.

■ Bad noise cancellation effect

1. Please confirm if the earplugs cannot be tightly plugged. If so, please replace with the silicone cover of a different size delivered.
2. Please confirm if the earphones are correctly worn.

■ No sound or sound change

1. Please confirm if the current device supports this product.
2. Please try to change a player or music playing application.