

# Parts

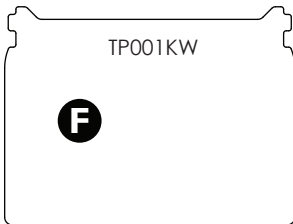
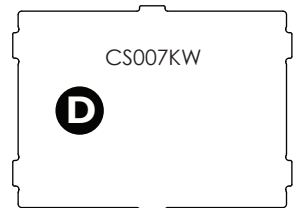
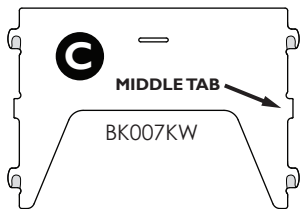
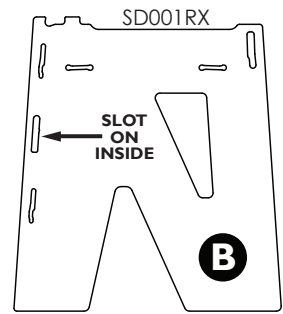
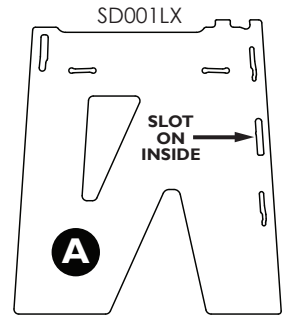

## Need Help?

Watch our **Assembly Video** at [sprout-kids.com/kda](http://sprout-kids.com/kda).  
Or talk to our customer service agent at : (877) 765-7860

**1** Push the **middle tab** of **C** all the way into its slot on **A**. Use technique shown and push until tab **pops** in.

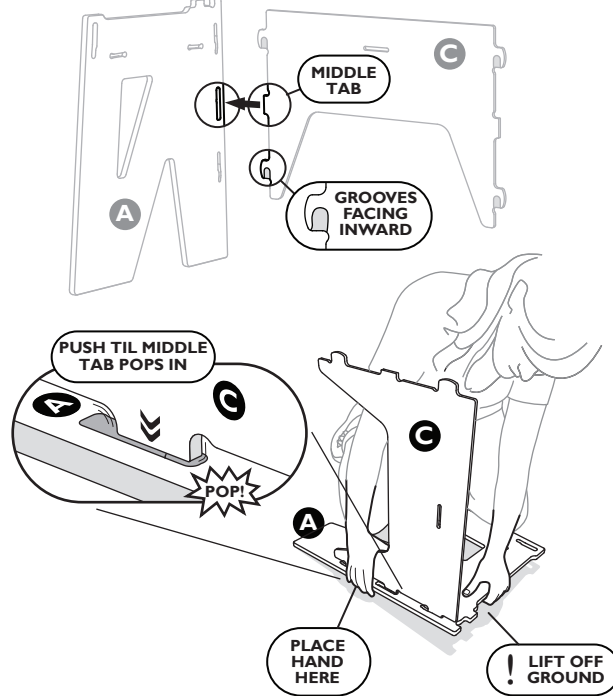

**2** Slide **C** downward in the slot until the middle tab locks into place.

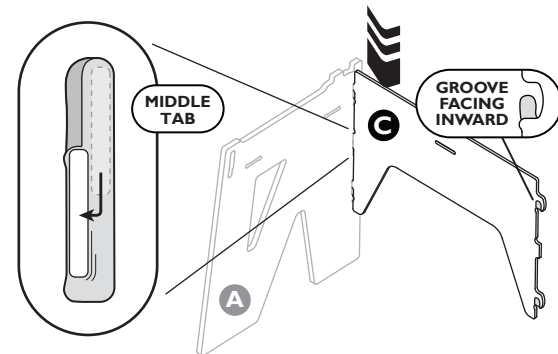

Repeat Steps **1** & **2** for side **B**.

**3** With legs slightly pushed apart, carefully push **D** into position.

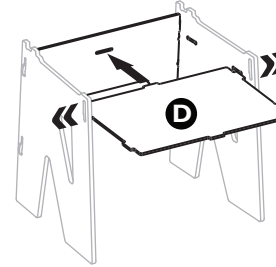

**4** With legs slightly pushed apart, place slot on **E** into tab of **D**, as shown.

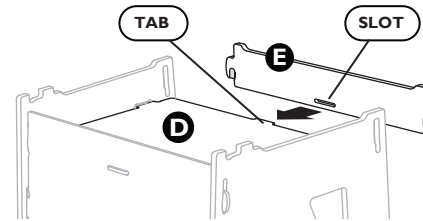

**5** Use feet to **PULL IN** desk legs (easiest in chair) while simultaneously **PUSHING DOWN** corner of **D** to allow tab to enter slot, as shown.

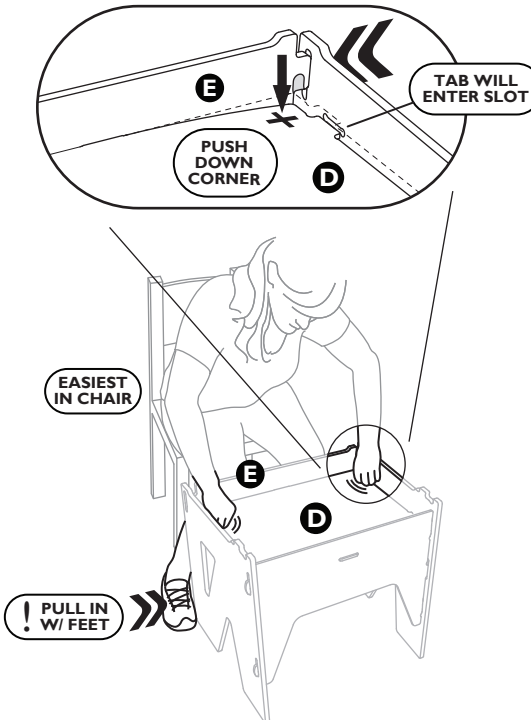

Simple. Modern. American Made.

**6** Place **F** on top. Enjoy!

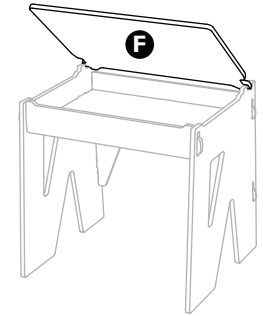

- Adult assembly only
- Weight capacity 90 lbs
- Assemble completely before use

## Disassembly

Follow Steps 3-6 in reverse order. Then for Step 2, use this simple technique to unlock the middle tab of **C**, allowing you to detach it from desk legs **A** and **B**.

