

Parts

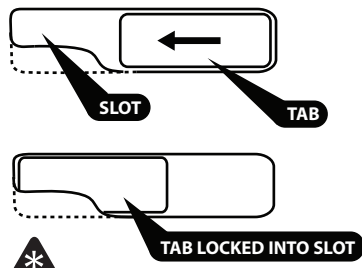

Place tab into open slot then lock tabs into the notch as pictured above.

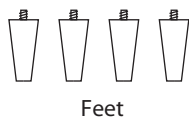
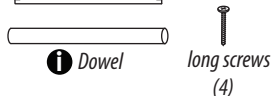
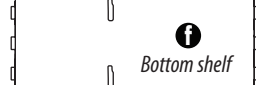
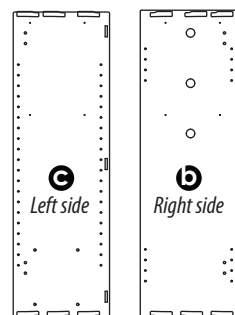
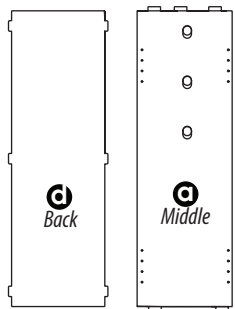
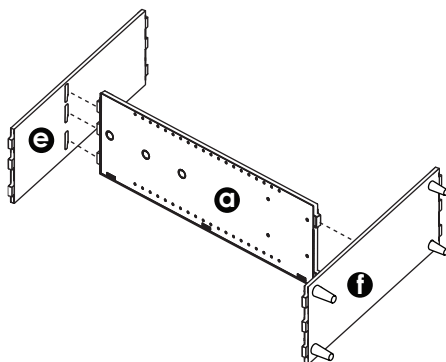

2 Refer to *. Pop Middle **d** into corresponding slots **e** and slots **f**. Tabs and slots must be lined up correctly or they will not properly tighten. See *

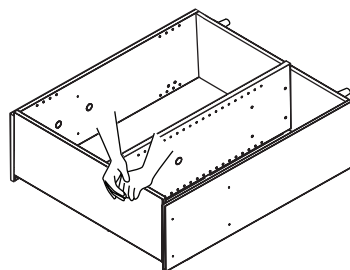

5 Refer to *. To fully tighten unit, push down on shelves until ends are flush with sides.

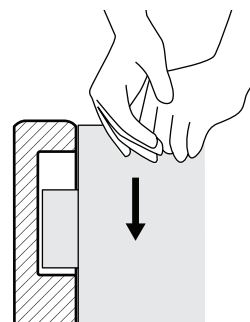

When tight, the edges should be flush.

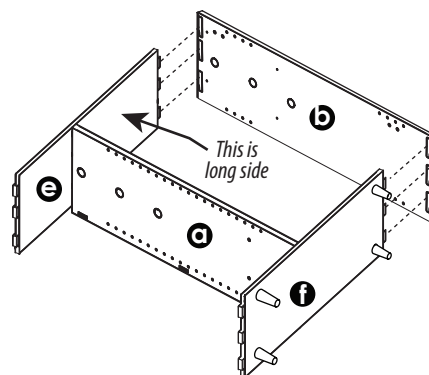

3 Insert Right side **b** slots into matching tabs in Top shelf **e** and Bottom shelf **f**. Then tighten according to *

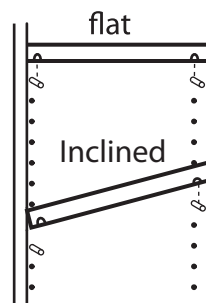

6 Put Pins into desired holes. Slide Shelves onto pins and push down into place. (4) Pins for each shelf.

! 2 people recommended for assembly. Assemble on a hard floor.

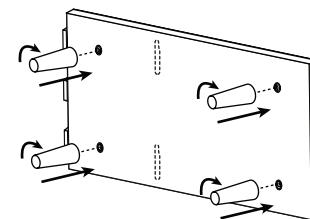

1 First, screw in the four legs into the Bottom Shelf until tight, as shown.

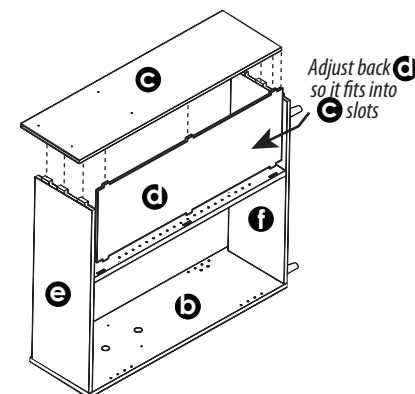

4 Turn shelf onto side **b** as shown. Insert Back **d** then Left side **c**. Then tighten according to *

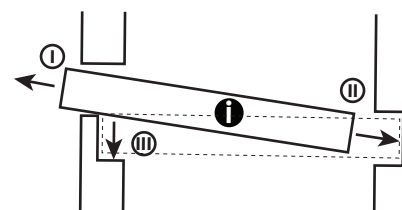

7 Place Dowel to desired height installing as shown.

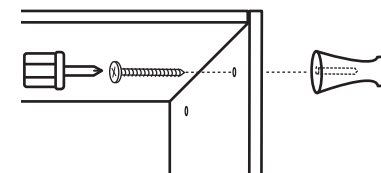

8 Install Pegs by inserting Screw from inside of wardrobe, then threading on Peg.

sprout
Simple. Modern. American Made.

Need Help?

Watch our Assembly Video at
sprout-kids.com/wra

Or talk to our
customer service agent at:
+1 (385) 208-1463

**Wardrobe
with Legs**

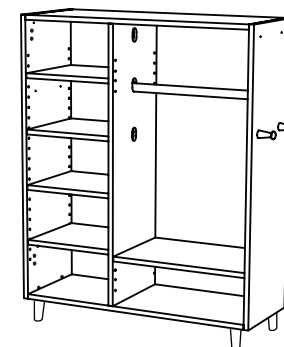

! Adult assembly only
! Assemble completely before use