

PARTS

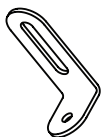

Bracket
(2x)



Short screws
(2x)

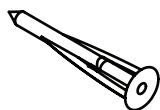

Wallclaw
Drywall Anchor
(2x)

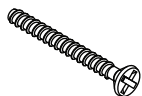

Wallclaw Screw
(2x)



REQUIRED:
A phillips head
screw driver or drill

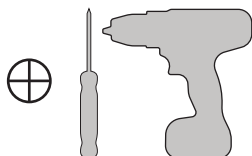

A hammer

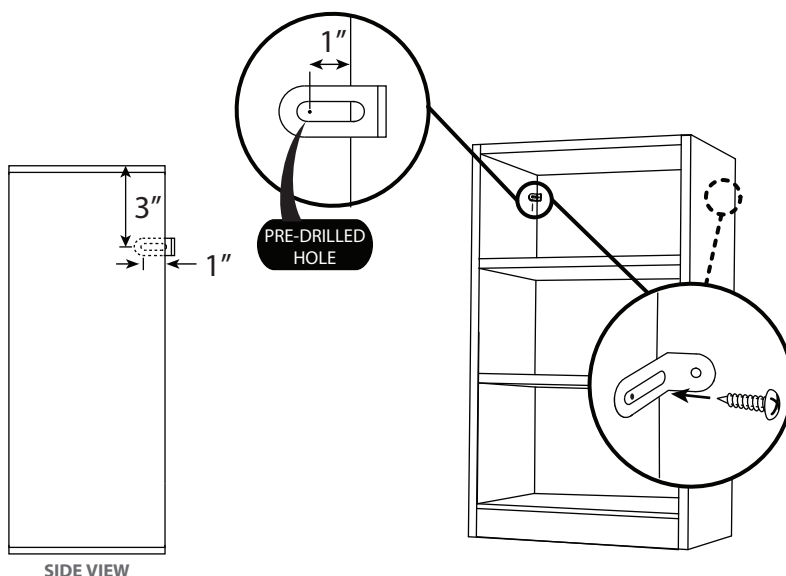
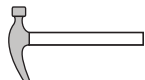

- 1 Locate the hole located on both the interior sides of the unit near the upper back. Position bracket with the long slot over the hole. Screw the short screws through the long slot on the brackets into the hole on the side of the shelf where the mark was made. Do this with both brackets.

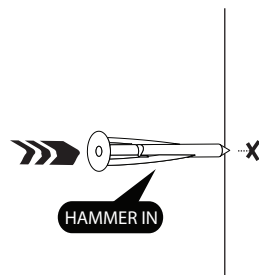

- 3 Move the brackets and shelf out of the way. Use a hammer to pound the Wallclaw Drywall Anchor into the wall at the two marked points.

- 2 Push the bracket flush against the wall, and mark the wall through the hole. Do this with both brackets.

Note: to use the Wallclaw Drywall Anchor, this mark will need to be on drywall without a stud directly behind it.

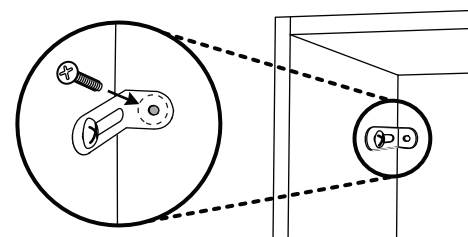

- 4 Move the shelf back against the wall, position the brackets against the Wallclaw Drywall Anchors, then screw in the Wallclaw Screw until tight.



Simple. Modern. American Made.

Need Help?

Talk to our
customer service agent at:
+1 (833) 530-0033

⚠ Do not allow children to
climb up shelves at any time.

Lexico Bookshelf Wall Anchor Instructions

