

## PARTS

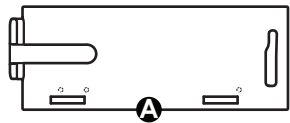

(1) Left Side

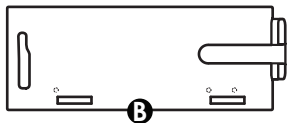

(1) Right Side



(1) Back

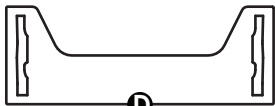

(1) Front

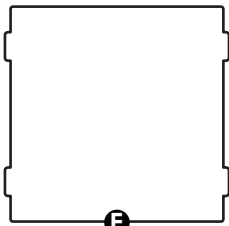

(1) Bottom



(2) Drawer Rails



(4) Long Screws



(6) Short Screws

## BEFORE YOU START

- \* Orient tabs so the side with the wider lip faces the same direction as the notch in the slot.

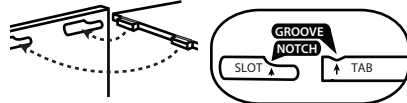

- \* Tab will 'pop' into slot when force is applied.

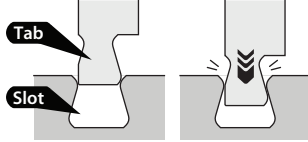

## ASSEMBLY INSTRUCTIONS

- 1 Remove small end of both Drawer Rails **F** by bending switch and pulling, as shown.

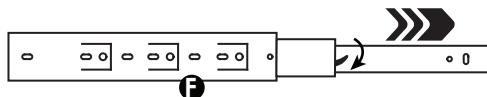

- 2 Install small ends of Drawer Rail **F** onto Sides **A** & **B** by threading (3) Short Screws **H** through holes indicated by points on side.

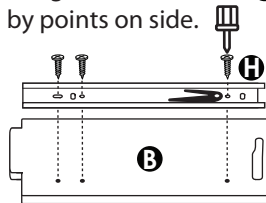

- 3 Refer to \*. Insert both Sides into the slots on Front **D**. Rails should be on the outside-bottom.

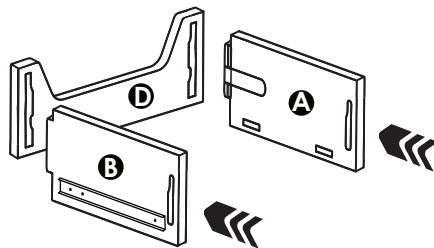

- 4 Push down on both ends of Front **D** until it is flush with Sides.

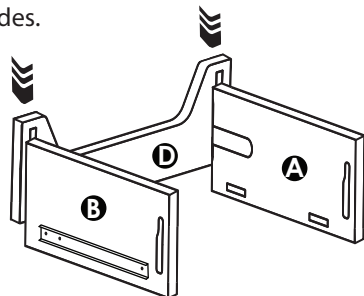

- 5 Gently Bend Sides apart, and insert Bottom **E** into position.

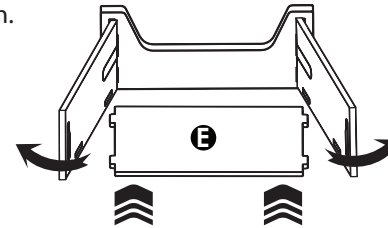

- 6 Place Back **C** into slots on end of Sides, with the groove facing inward and upward. Push tabs upward to tighten.

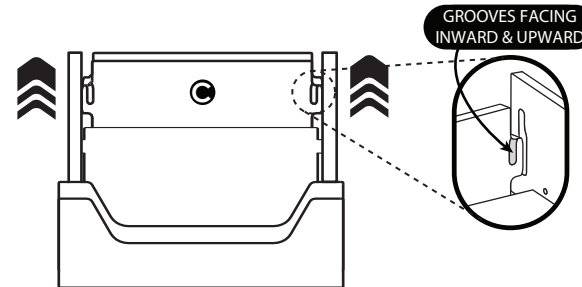

- 7 Install larger half of Drawer Rails **F** on both sides of the drawer space using Long Screws **G** as indicated.

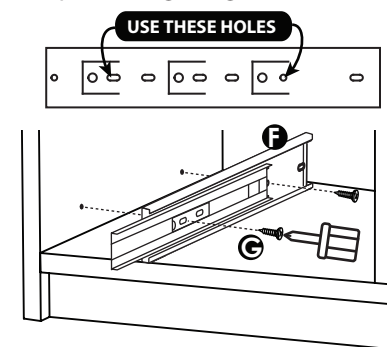

- 8 Carefully insert assembled Drawer into position, making sure the small end of Drawer Rails **F** snap back into the larger halves.

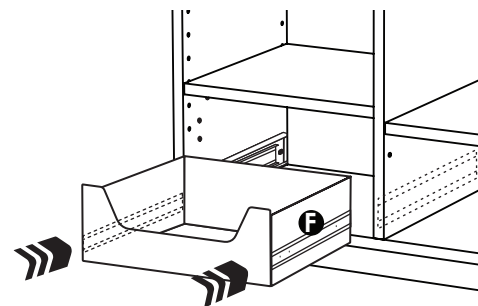

**sprout**

Simple. Modern. American Made.

## WARDROBE DRAWER

- ⚠ Adult assembly only
- ⚠ Assemble completely before use
- ⚠ Must anchor Wardrobe to wall when using drawers

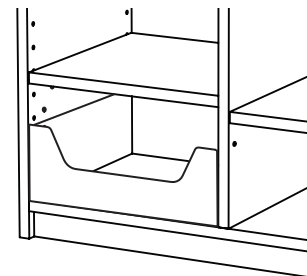

**STOP** Frustrated?  
Need Help?

Talk to our customer service agent at:

+1 (833) 530-0033

Or email us at:

support@sprout-kids.com