

PARTS

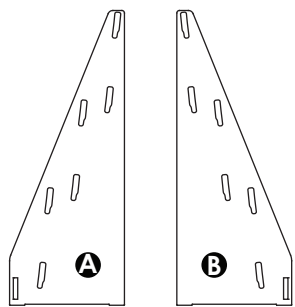

Left Side

Right Side

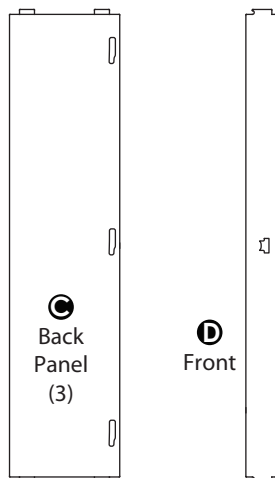

Back Panel (3)

Front

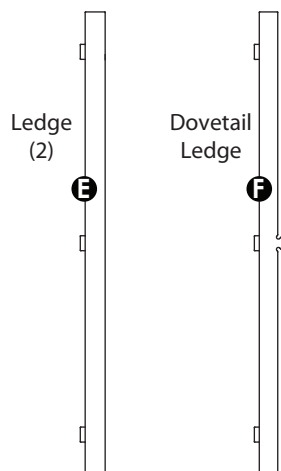

Ledge (2)

Dovetail Ledge

BEFORE YOU START

- * When inserting tabs into slots make sure the side with the wider lip on the tab faces the same direction as the notch in the slot.

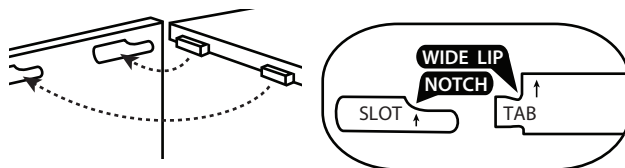

ASSEMBLY INSTRUCTIONS

- 1 Insert all Ledges (E & F) into the slots on a Back Panel (C). Push down until flush on end to tighten.

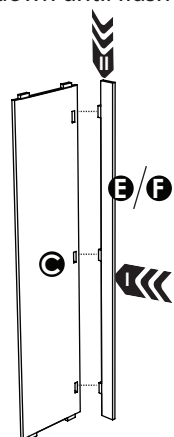

- 2 Insert the Back Panel with Dovetail Ledge (F) into its slots on Side (A) as shown, and push sideways to tighten. Repeat process with the two Back Panels with Ledge (E), one after the other.

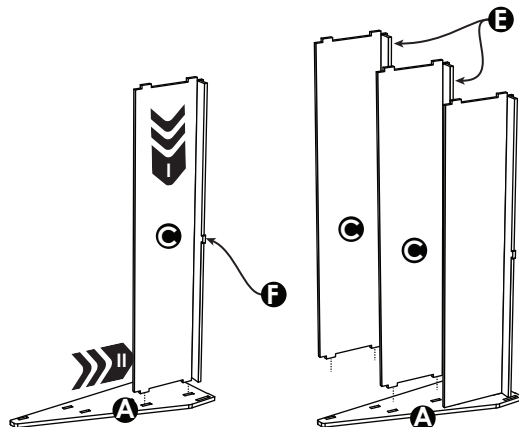

- 3 Insert the Front (D) into its slot on Side (A) in the orientation shown. Carefully slide the Dovetail on Ledge (F) into the slot on Front (D).

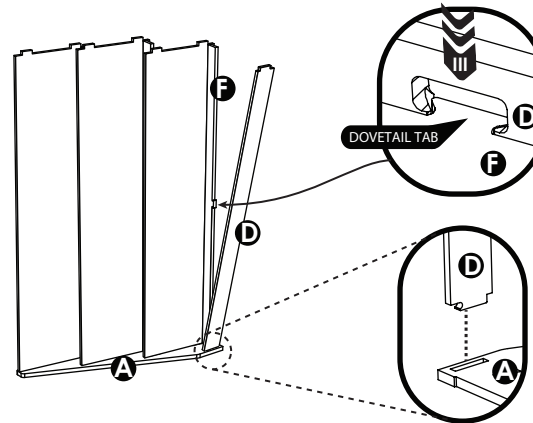

- 4 Carefully place Right Side (B) over tabs of Back Panels. Tabs should easily pop into the large side of the slots.

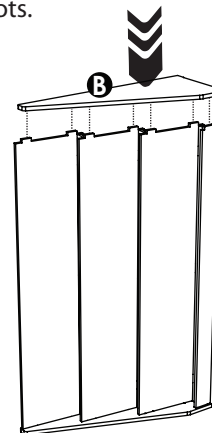

- 5 Carefully lay unit flat on ground, then tighten each Back Panel.

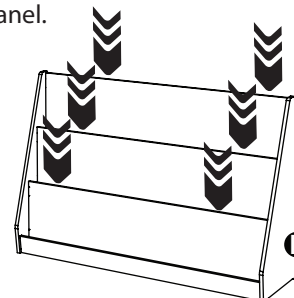

sprout

Simple. Modern. American Made.

Book Display Shelf

⚠ Adult assembly only

⚠ Assemble completely before use

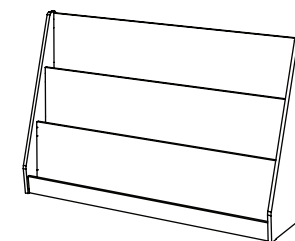

STOP Frustrated? Need Help?

Talk to our customer service agent at:
+1 (833) 530-0033
 Or watch our assembly video at:
sprout-kids.com/bds