

Assembly Manual

8x7

PATENTS ARE PENDING



Building Dimensions

Approximate Size	Storage Area		Exterior Dimensions Roof Edge to Roof Edge			Interior Dimensions Wall to Wall		
	Sq. Ft.	Cu. Ft.	Width	Depth	Height	Width	Depth	Height
8' x 7'	48.75	276.25	93.75"	86"	72"	90"	78"	71"
2.4 m x 2.1 m	4.53 m ²	7.82 m ³	238.13 cm	218.44 cm	182.88 cm	228.6 cm	138.12 cm	180.34 cm

712600303

Before You Begin Site Preparation

1. Before beginning construction, check local building codes regarding footings, location and other requirements. Study and understand this owner's manual.
2. Follow all directions and dimensions carefully.
3. Follow the step sequence carefully for correct results.
4. Be sure all the parts fit together properly before proceeding.
5. **SAFETY FIRST:** Care must be taken when handling various pieces of your kit since some contain sharp edges. **Wear work gloves, eye protection and long sleeves when assembling or performing any maintenance on your building.**
6. **GROUND MUST BE LEVEL:** Be sure Floor Frames lie flat on ground. To prepare earth bed, remove sod and other debris. Level the high spots with flat shovel and tamp the bed down.
7. Separate contents of the carton by the part number while reviewing parts list. Check to be sure that you have all the necessary parts for your building. Refer to Page 32 for the Parts List.



BASIC TOOLS

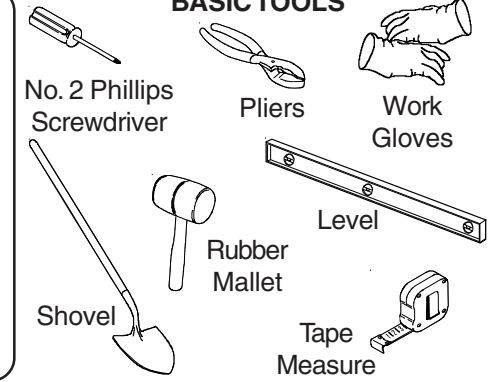

Foundation Recommendations

Local building codes vary by region, refer to your local codes for specifications.

Concrete Slab

1. Select level site for building.
2. Remove 6" of soil for slab.
3. Compact 4" gravel in hole.
4. Place 6 ml plastic over gravel.
5. Construct 2 x 4 form.
6. Pour concrete and level.

Slab Dimensions

80 1/2" (204,47 cm)

Door Opening

92 1/2" (235 cm)

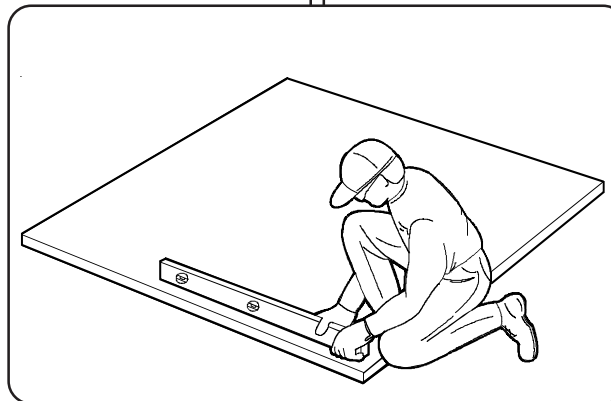

Wood Platform

1. Construct with 2 x 4 treated lumber and 5/8" minimum exterior grade plywood using galvanized nails.
2. Level platform.

16" Centers

80 1/2" (204,47 cm)

Door Opening

92 1/2" (235 cm)

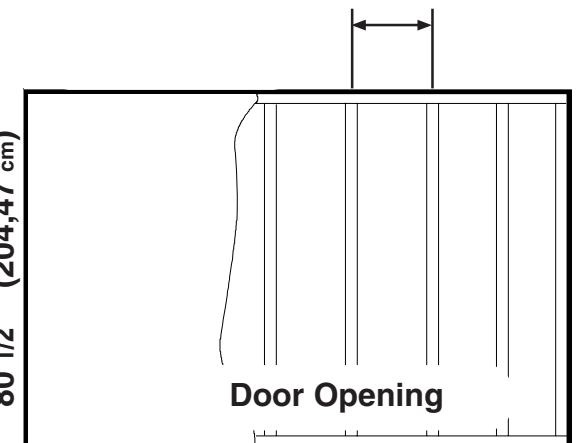

Care & Maintenance

Finish: For long lasting finish, periodically clean and wax the exterior surface. Touch up scratches as soon as you notice them on your building. Immediately clean the area with a wire brush; wash it and apply touch up paint per manufacturer's recommendation.

Roof: Keep roof clean of leaves and snow with long handled, soft bristled broom. Heavy amounts of snow on roof can damage the building making it unsafe to enter.

Doors: Keep doors closed to prevent wind damage.

Fasteners: Regularly check you building for loose screws, bolts, nuts, etc. and retighten them as necessary.

Moisture: With changing temperatures, condensation will accumulate inside the building.

Other Tips: A noncorrosive caulking is helpful to seal the building.



**Do Not store swimming pool chemicals in your building.
Combustibles and corrosives must be stored in air tight
containers.**



Step 1 Pre-Assembly Side Walls



Part No	Name	Quantity
10307	Wall Panel	12
10268	Corner Panel	2

ASSEMBLY COMMON FOR ALL PANELS

A

MAKE TWO (2) SIDE WALL SECTIONS
6 Panels & 1 Corner - Each

CAUTION
Sharp Edges

IMPORTANT
MUST USE FLAT SOLID SURFACE
DO NOT SNAP ON GROUND OR GRASS!

B

Raise Panel at Angle

NOTE: ALWAYS COVER THE AR-

Overlap Panels and align ends

C

Hook edge of top Panel to bottom Panel

Pre-Assembly Side Wallscont



D

Bring Top Panel down flat while maintaining pressure in the middle to keep edge hooked

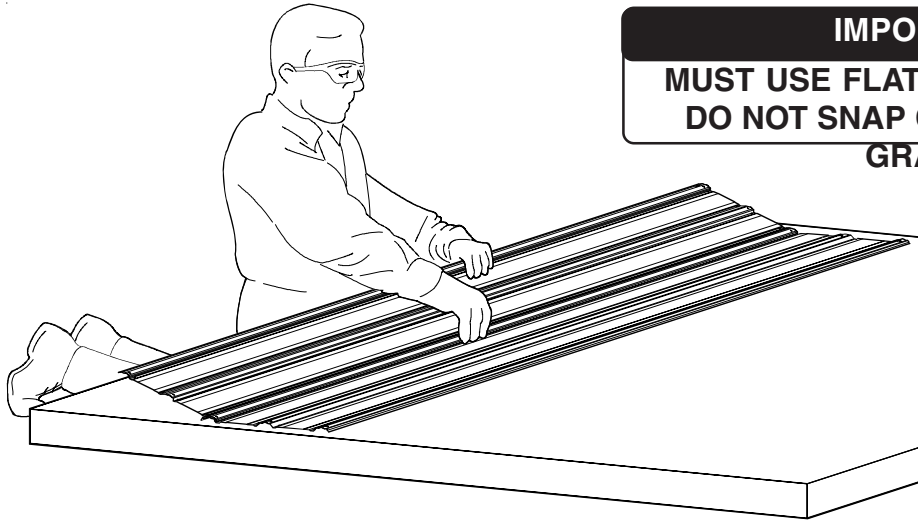

IMPORTANT

**MUST USE FLAT SOLID SURFACE
DO NOT SNAP ON GROUND OR
GRASS!**

E

Apply pressure in area shown

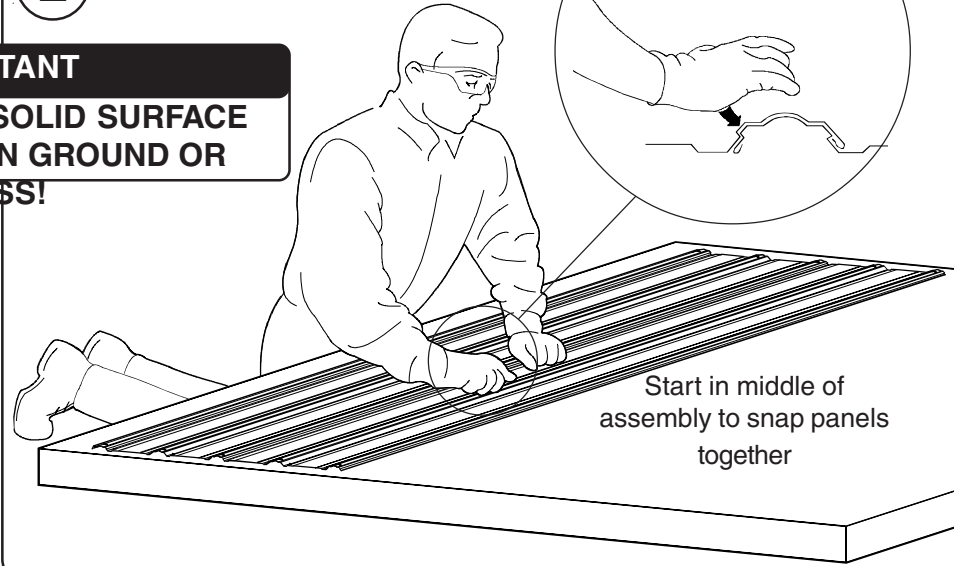
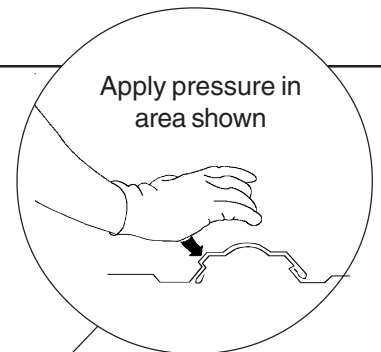

Start in middle of assembly to snap panels together

F

Push down to snap Panels together working from the center outward in both directions

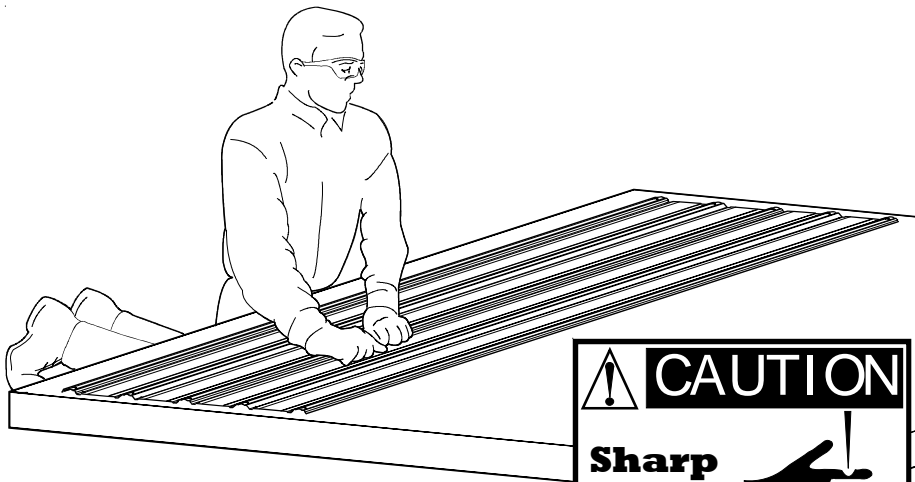

G

Push down to snap end of panels together

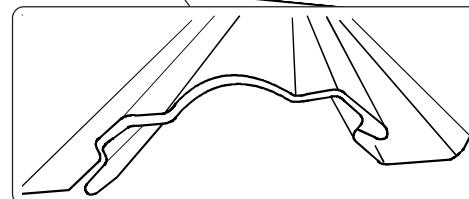
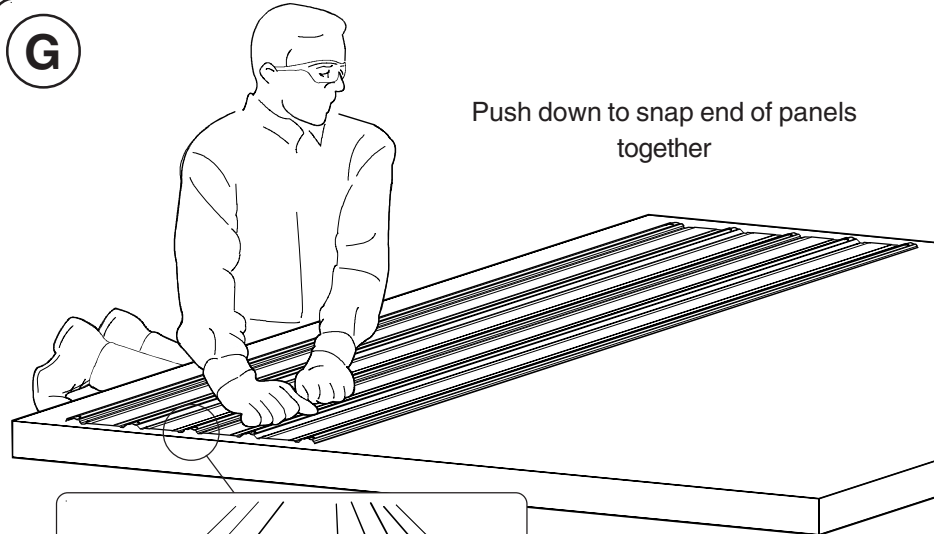

Pre-Assembly Side Walls . . . cont



H Install Corner Panel

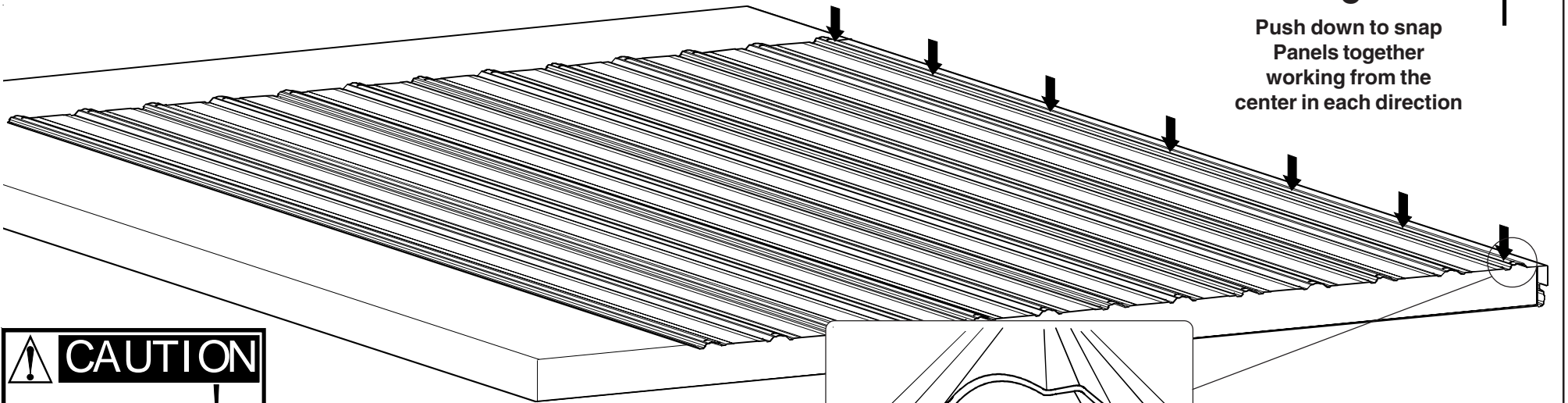
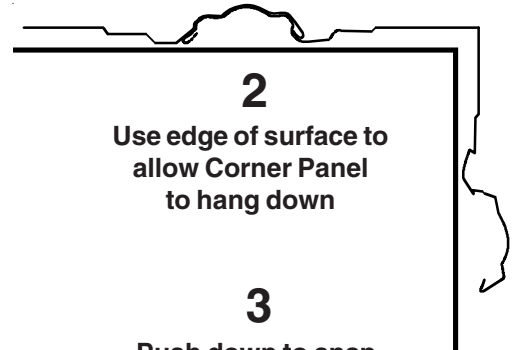
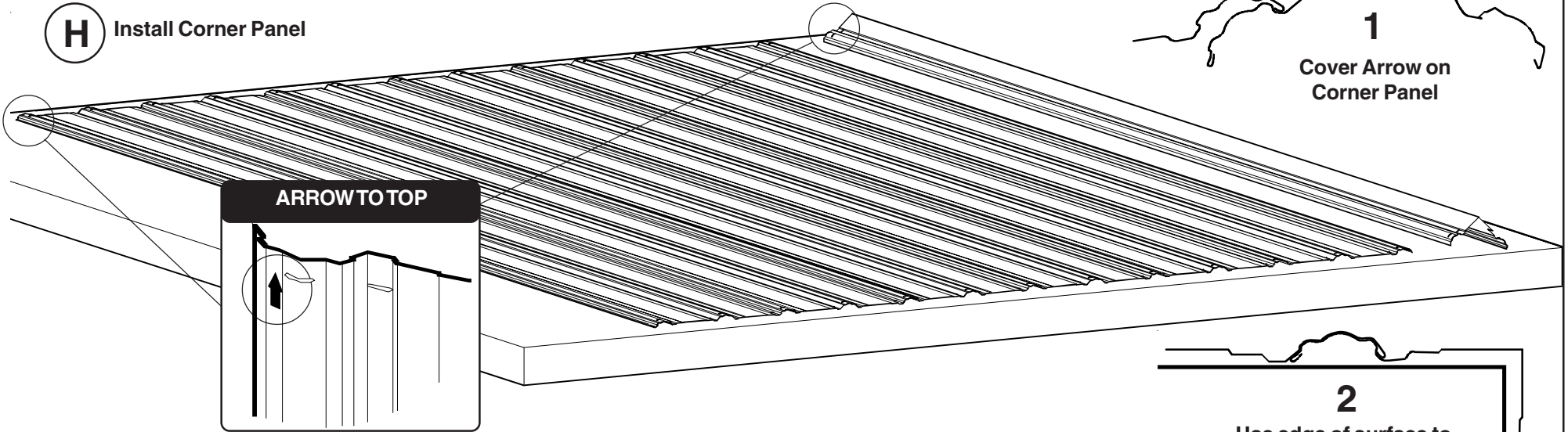
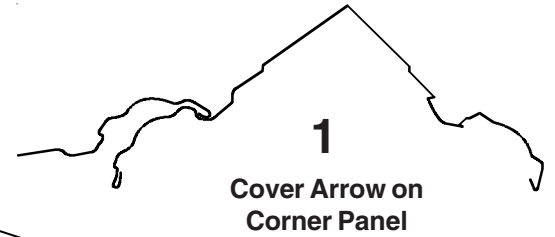

CAUTION

Sharp Edges

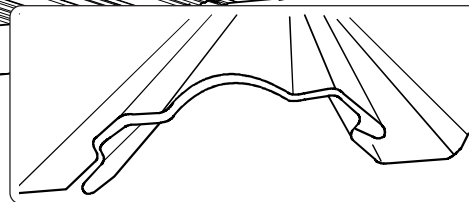

Pre-Assembly Side Walls . . . cont



Part No	Name	Quantity
10305	Upper Channel (painted)	4
10297	Floor Channel (unpainted)	4
10323	Channel Splice	4

I

MAKE TWO (2) Upper Channel Assemblies (painted)

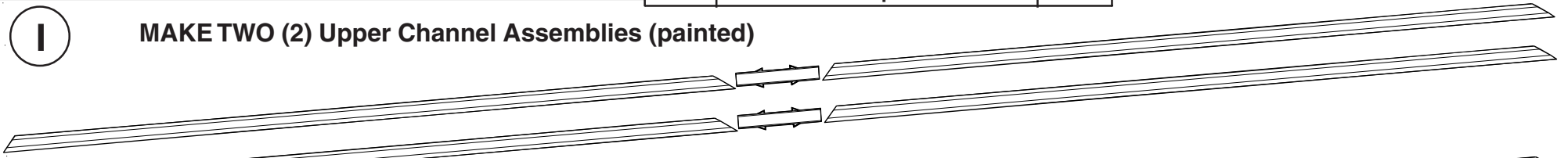

MAKE TWO (2) Floor Channel Assemblies (unpainted)

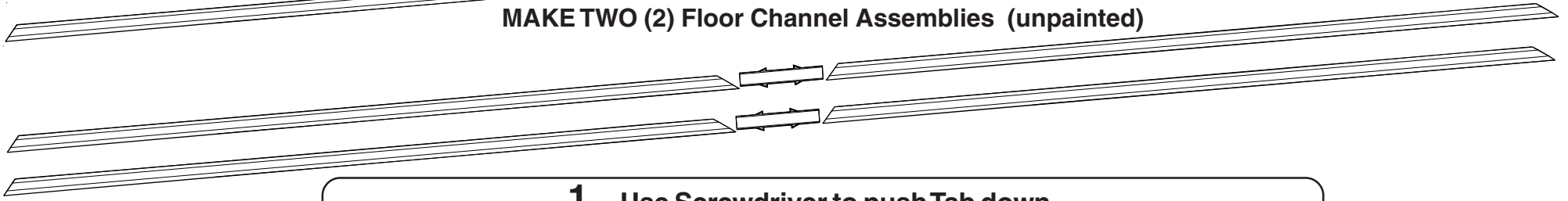

1 Use Screwdriver to push Tab down

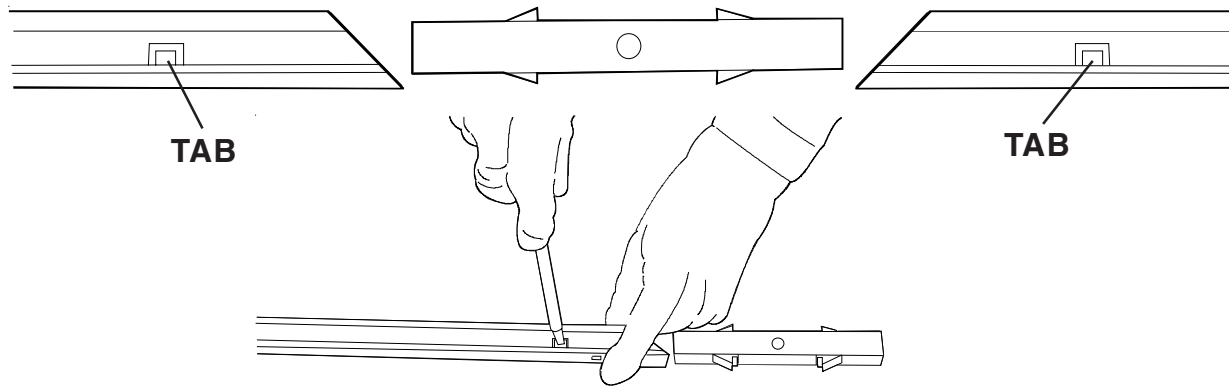

CAUTION

Sharp Edges

2 Splicing Channels

Turn Channel over & Insert Splice

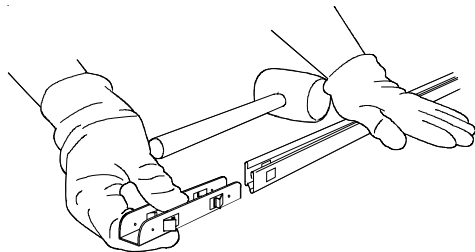

Use Rubber Mallet & **GENTLY** tap splice into channel until it snaps into place

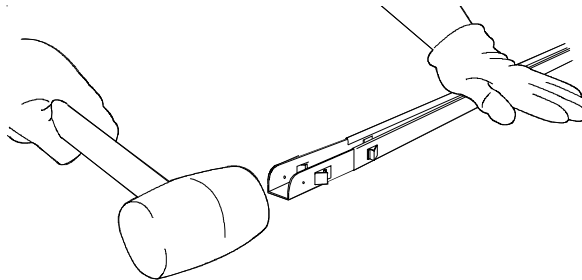

Join Channels

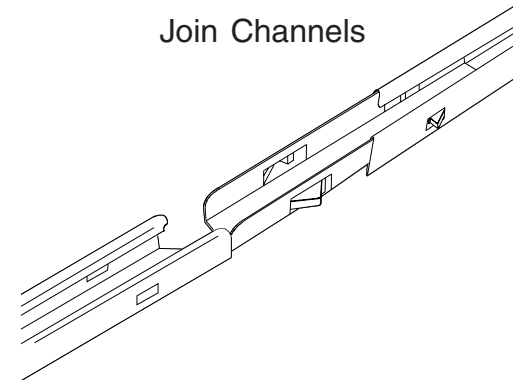

Pre-Assembly Side Walls . . . cont



Part No	Name	Quantity
	Upper Channel Assembly(painted)	2

J

Attach Upper Channel Assembly (painted)

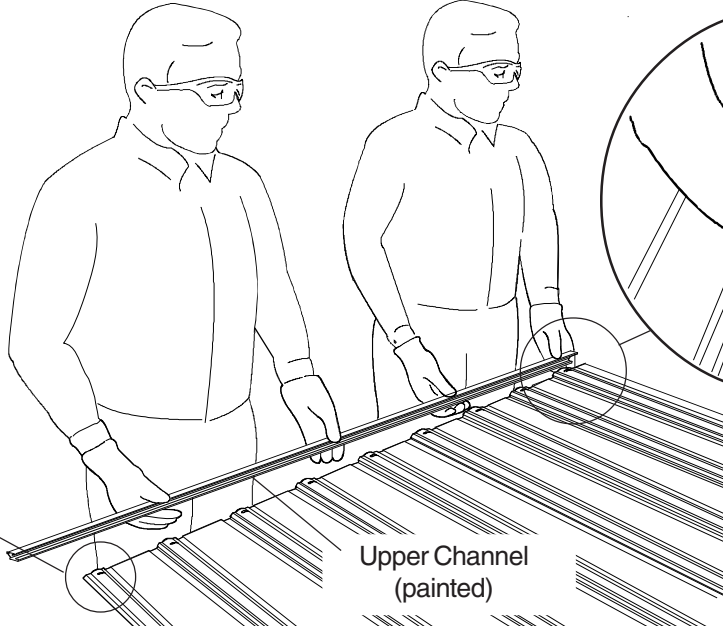

Upper Channel (painted)

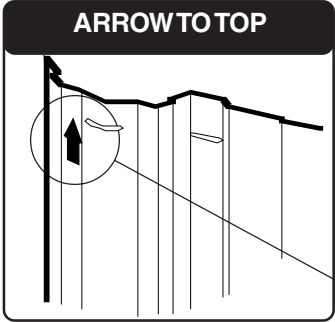

**-IMPORTANT-
START ASSEMBLY AT CORNER**

PANEL must be against 45° cut on Channel

K

Align Channel to Panel Ribs and pop into place at corner

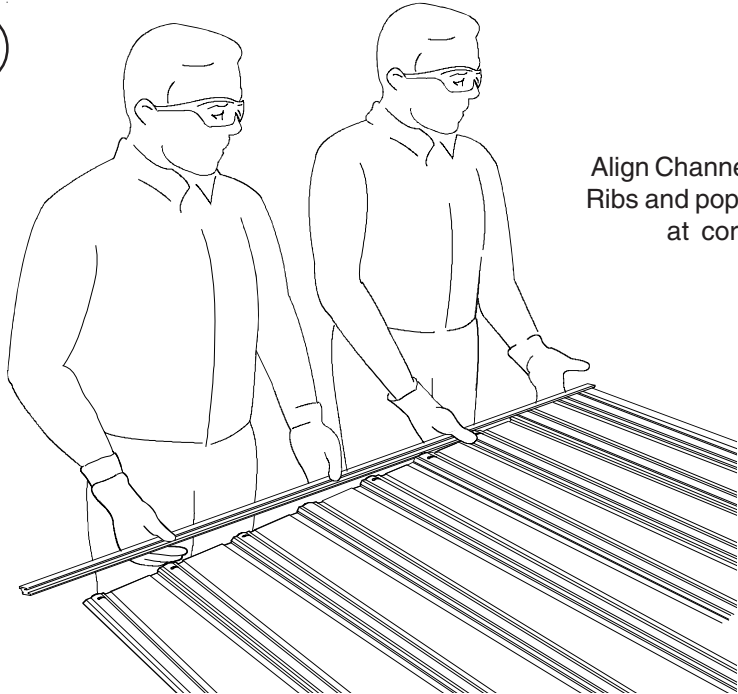

L

Continue aligning Channel and popping into place

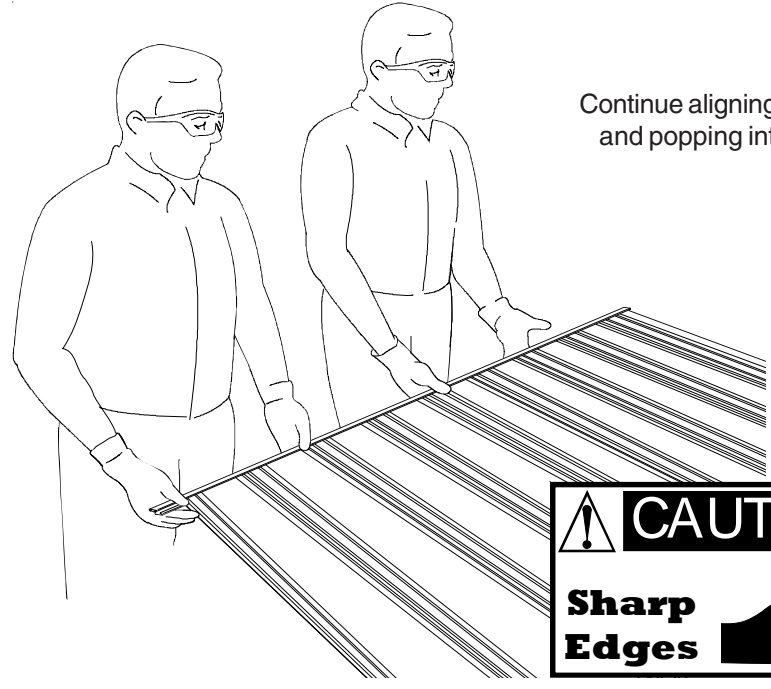

Pre-Assembly Side Wallscont



Part No	Name	Quantity
10280	Floor Channel Assembly (unpainted) Corner Clip	2 4

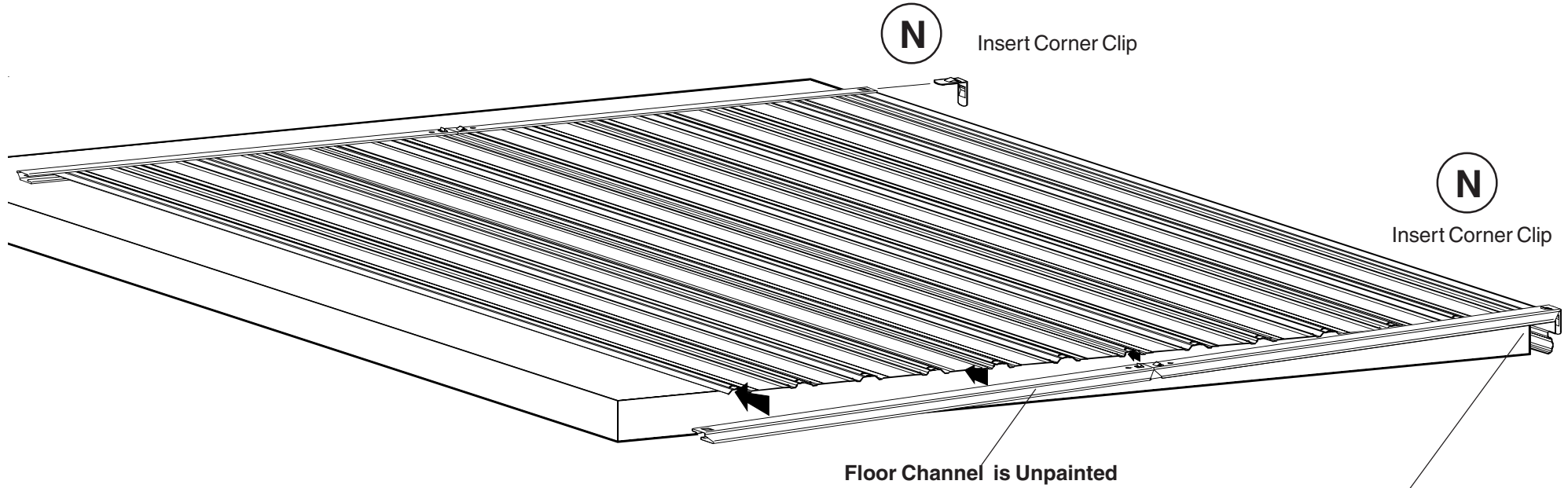

M
Attach Floor Channel Assembly

**-IMPORTANT-
 START ASSEMBLY AT CORNER
 PANEL**

Corner must be against
 45° cut on Channel



MAKE TWO (2) SIDE WALL SECTIONS

Step 2 Pre-Assembly Rear Wall



Part No	Name	Quantity
10268	Corner Panel	1
10307	Wall Panel	7

A MAKE ONE (1) REAR WALL SECTION 7 Panels and 1 Corner

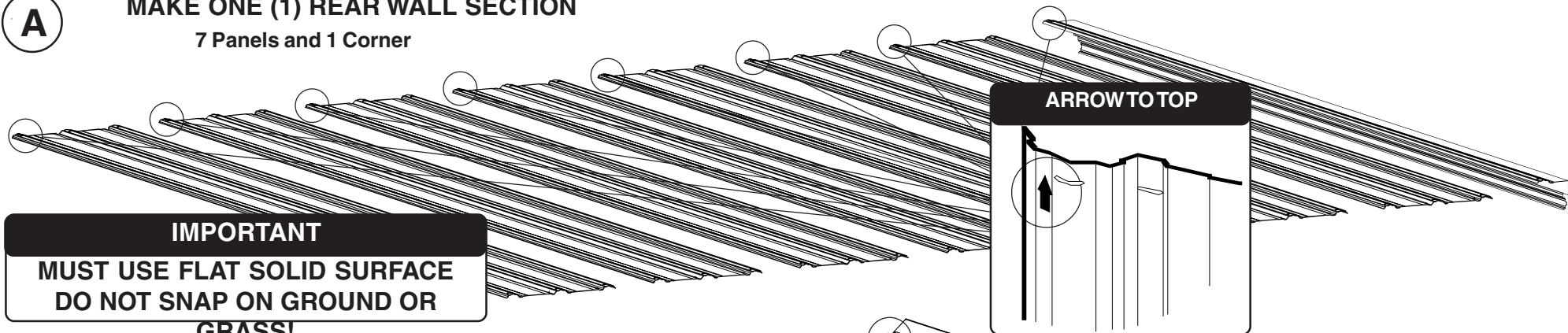

B Install Corner Panel

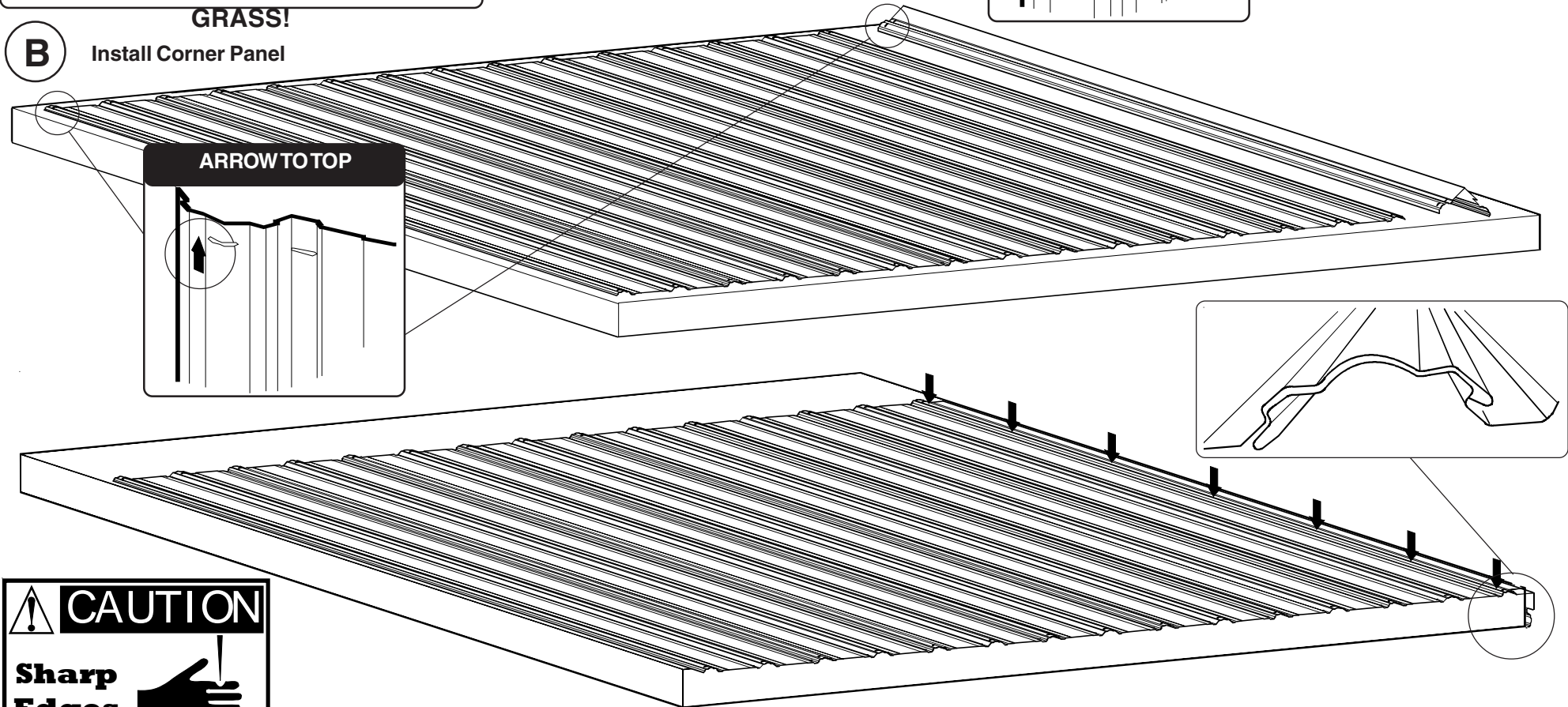

Pre-Assembly Rear Wallcont



Part No	Name	Quantity
10341	Upper Channel (painted)	4
10340	Floor Channel (unpainted)	4
10323	Channel Splice	4

C MAKE TWO (2) Upper Channel Assemblies (painted)

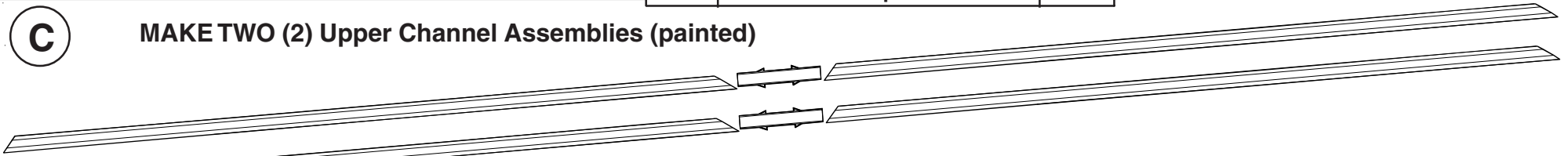

MAKE TWO (2) Floor Channel Assemblies (unpainted)

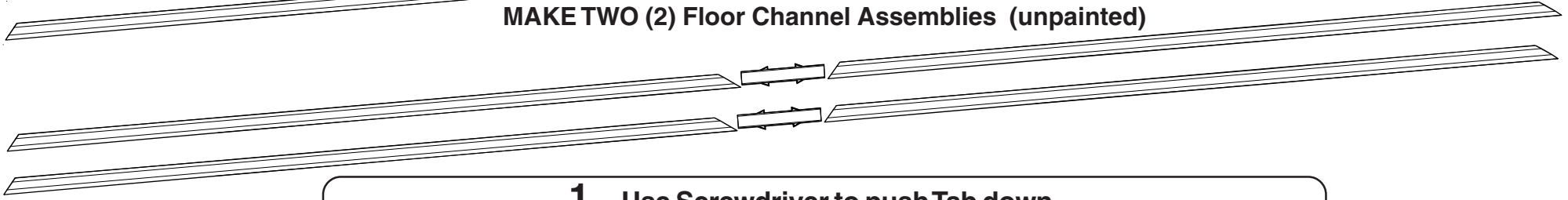

1 Use Screwdriver to push Tab down

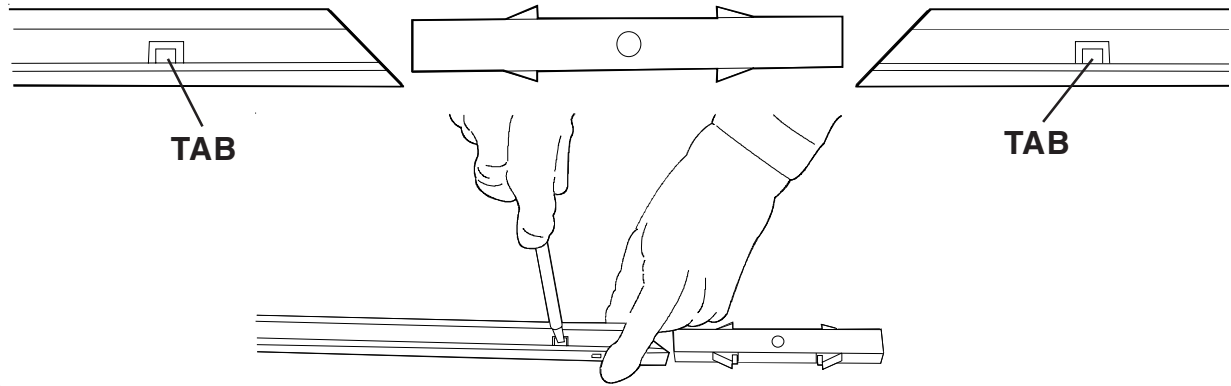

CAUTION

Sharp Edges

2 Splicing Channels

Turn Channel over & Insert Splice

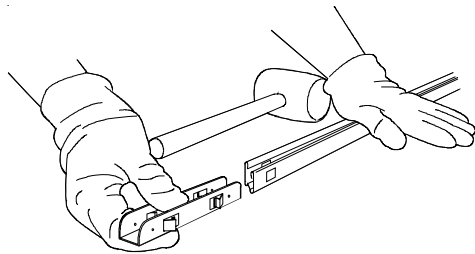

Use Rubber Mallet & **GENTLY** tap splice into channel until it snaps into place

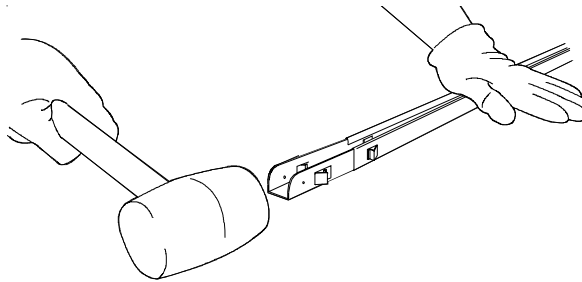

Join Channels

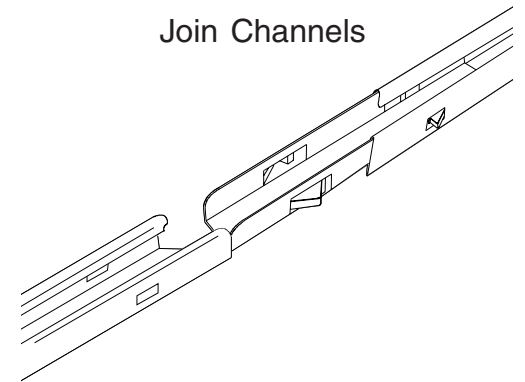

Pre-Assembly Rear Wallcont



Part No	Name	Quantity
10280	Upper Channel Assembly (painted)	1
	Floor Channel Assembly (unpainted)	1
	Corner Clip	2

D

Attach Upper Channel Assembly (painted)

Insert Corner Clip

E

**-IMPORTANT-
START ASSEMBLY AT CORNER**

Corner must be against 45° cut on Channel

Channel

Corner Panel

**-IMPORTANT-
START ASSEMBLY AT CORNER**

Corner must be against 45° cut on Channel

Channel

Corner Panel

G

Insert Corner Clip

F

Attach Lower Channel Assembly (unpainted).

CAUTION

Sharp Edges

Step 3 Pre-Assembly Front Wall



Part No	Name	Quantity
10316	Wall Panel - Right	1
10317	Wall Panel - Left	1
10371	Door Jamb	2
10268	Corner Panel	1

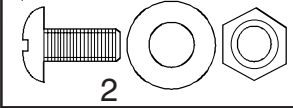

A Assemble Door Jambs to Wall Panels
Install Bolt, Washer & Nut in each Door Jamb

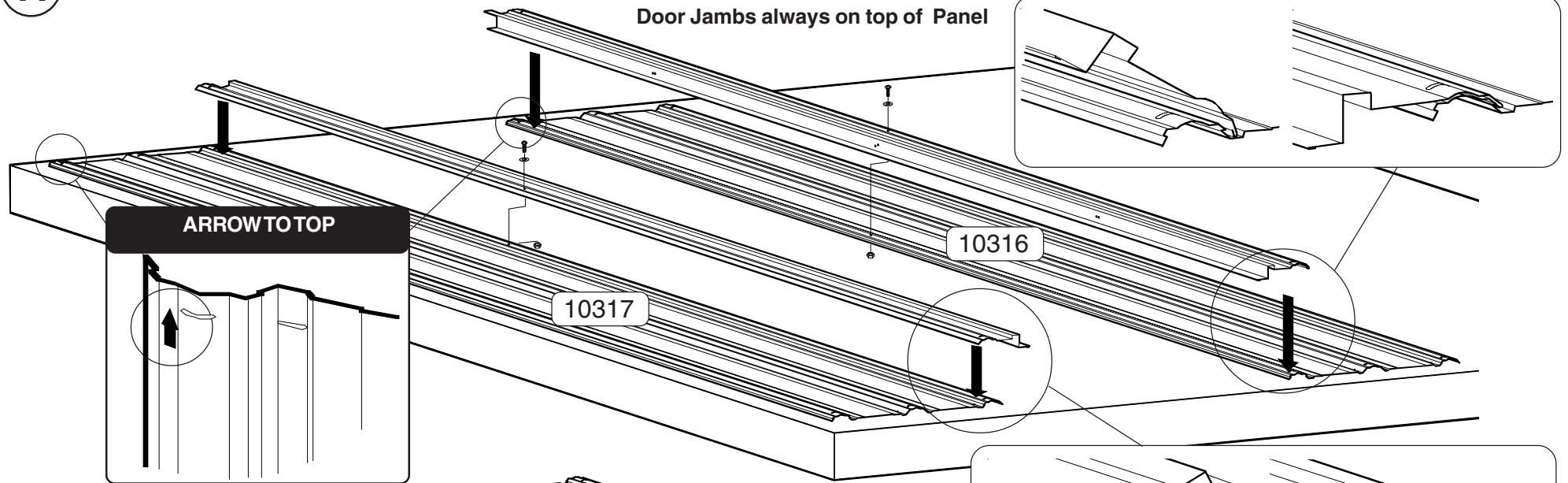

B Install Corner Panel

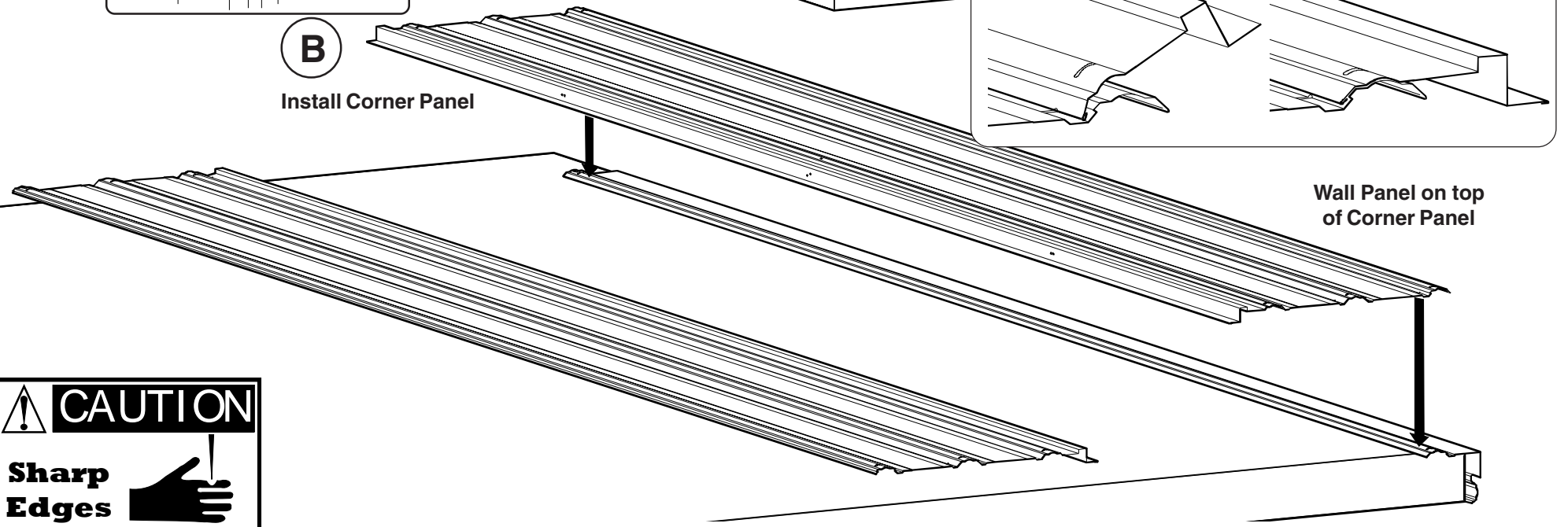

Pre-Assembly Front Wallcont



Part No	Name	Quantity
10291	Upper Channel Assembly (painted)	1
	Header Trim	1
10280	Floor Channel Assembly (unpainted)	1
	Corner Clip	2

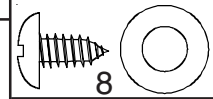

C Attach Upper Channel Assembly (Painted)

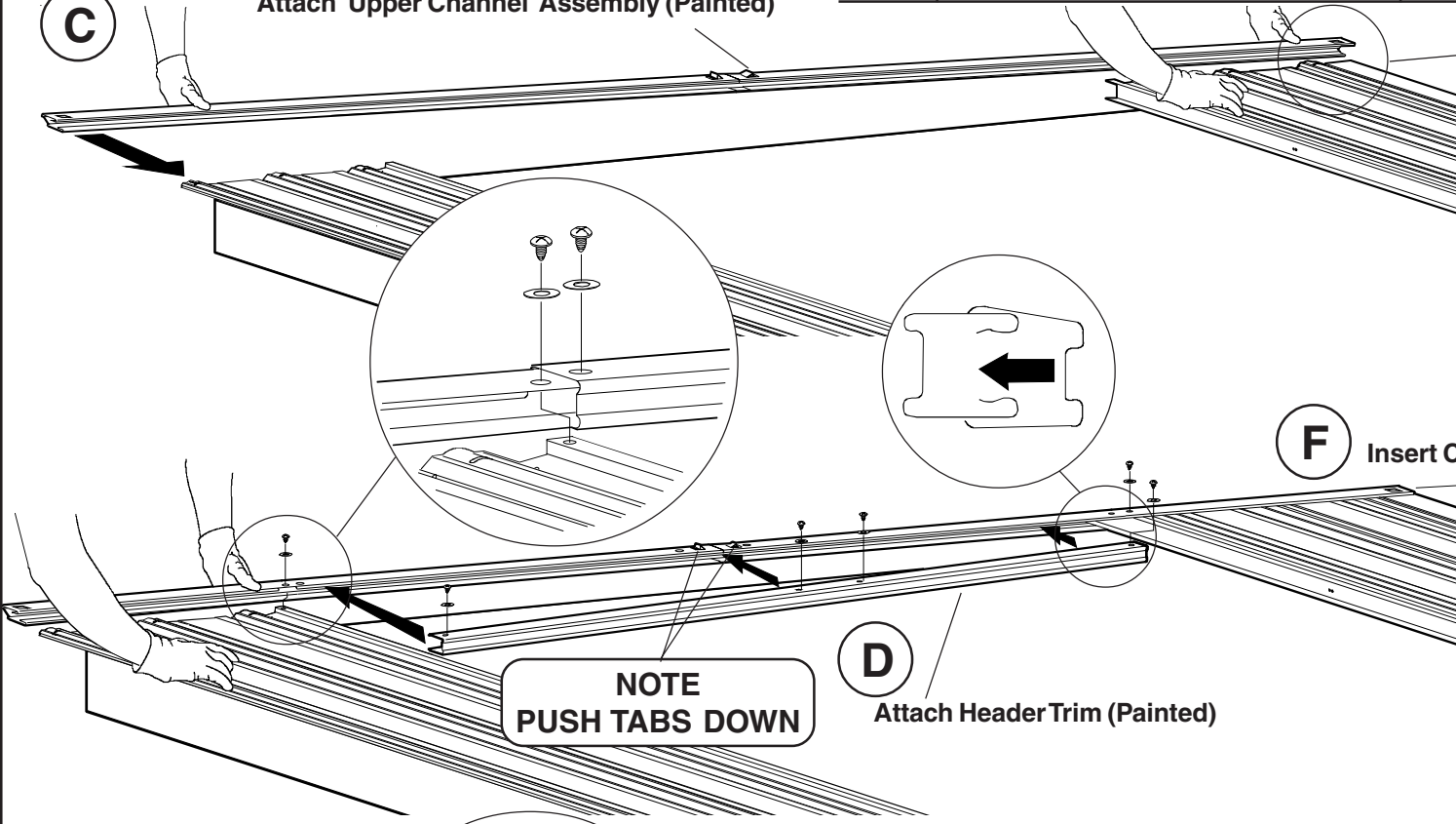

**-IMPORTANT-
START ASSEMBLY AT CORNER**

Corner must be against 45° cut on Channel

Channel

Corner Panel

F Insert Corner Clip

**-IMPORTANT-
START ASSEMBLY AT CORNER**

Corner must be against 45° cut on Channel

Channel

Corner Panel

**NOTE
PUSH TABS DOWN**

D Attach Header Trim (Painted)

E Attach Floor Channel Assembly (Unpainted)

F Insert Corner Clip

CAUTION

Sharp Edges

Step 4 Wall Assembly



Part No	Name	Quantity
	Side Wall Assembly	1
	Rear Wall Assembly	1

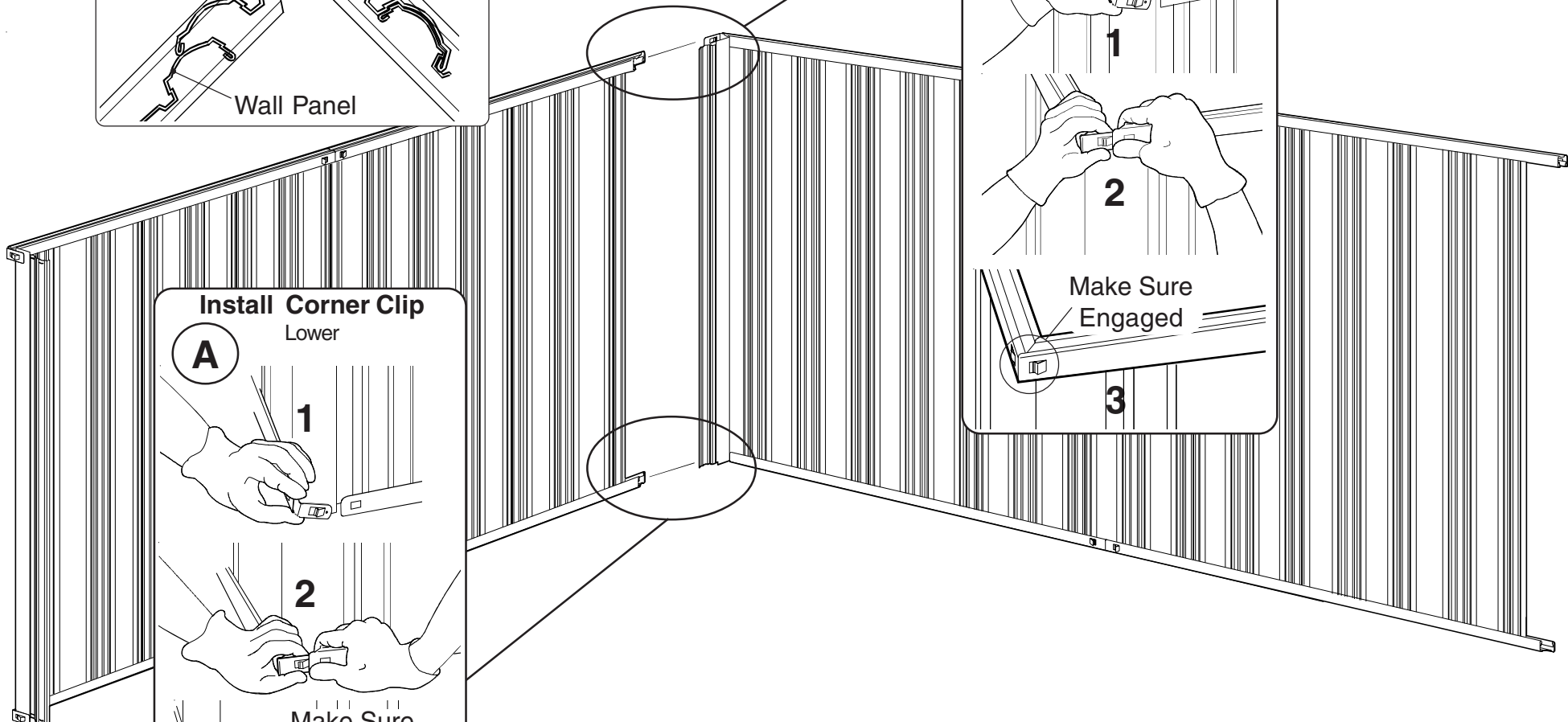
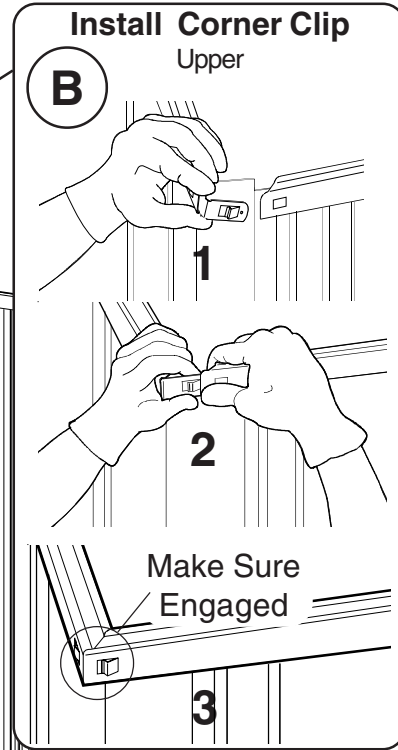
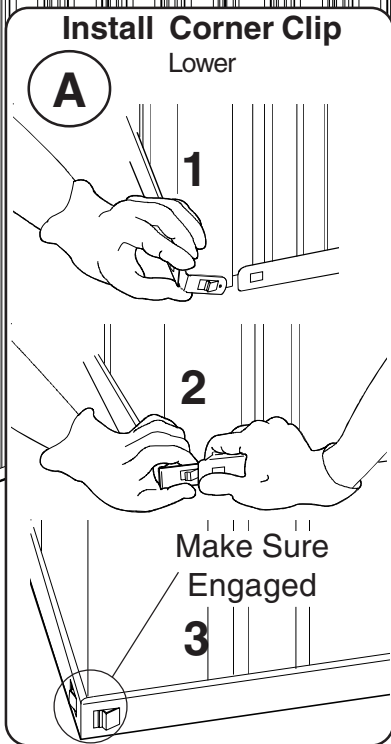
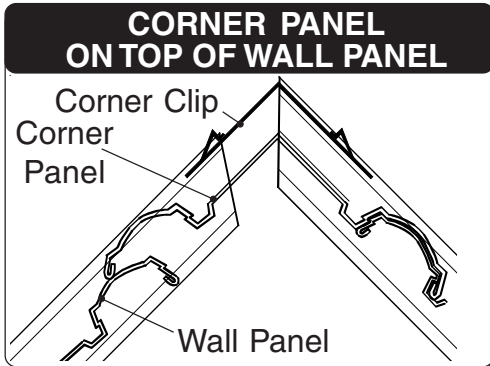

Wall Assembly . . .cont



Part No	Name	Quantity
	Side Wall Assembly	1
	Front Wall Assembly	1

Install Corner Clip Lower

C

- 1
- 2
- 3

Make Sure Engaged

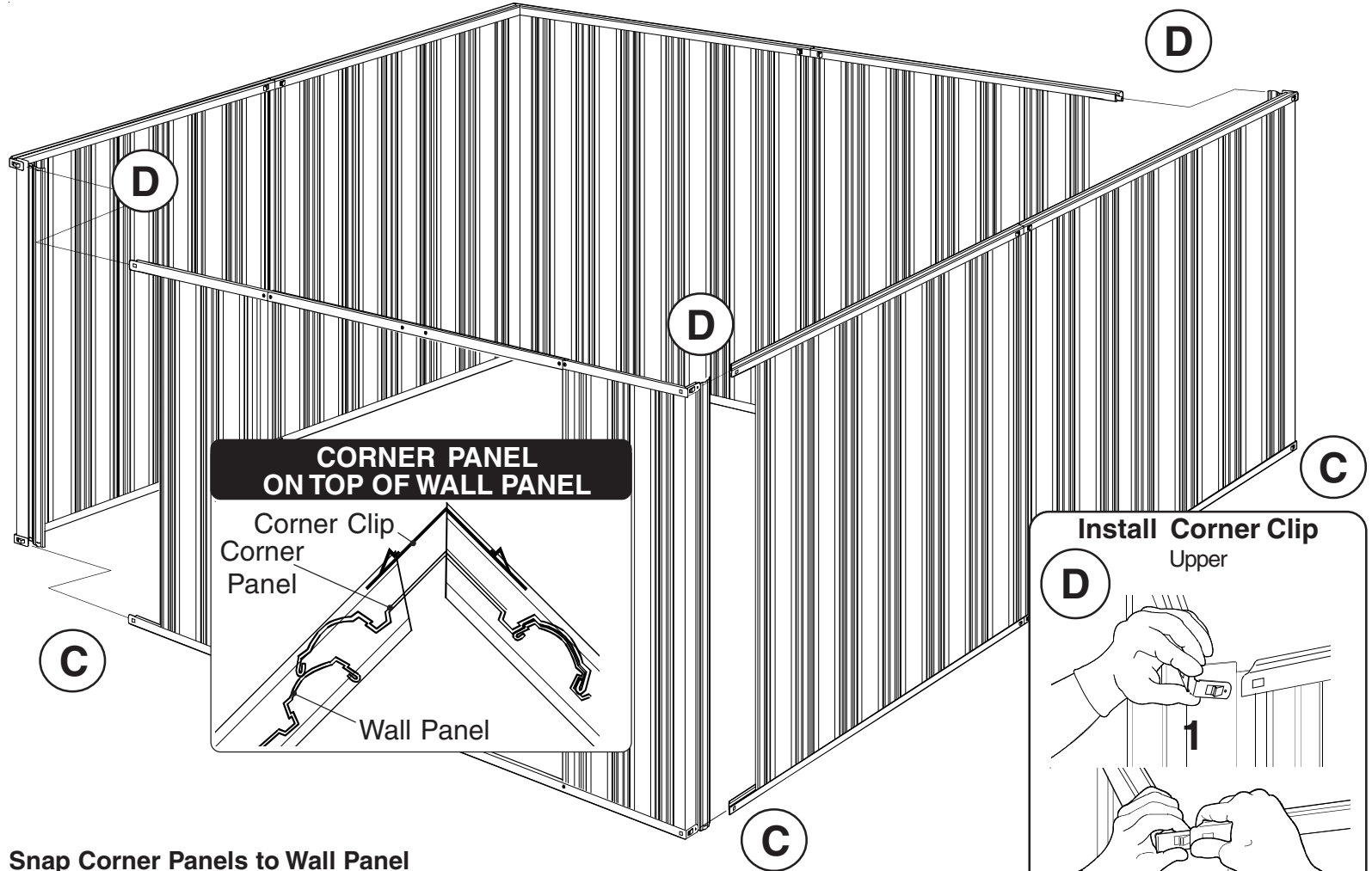

CAUTION

Sharp Edges

Snap Corner Panels to Wall Panel

E

Inside assembler applies pressure to hold wall firm

Outside assembler snaps corner panel to side panel top to bottom

Join Corner

IN-SIDE

IN-SIDE

Install Corner Clip Upper

D

- 1
- 2
- 3

Make Sure Engaged

Step 5 Gable & Ridge Beam Assembly



Part No	Name	Quantity
10293	Left Gable	2
10294	Right Gable	2
10260	Header Angle	1
10278	Gable Brace	2
10279	Gable Brace	4

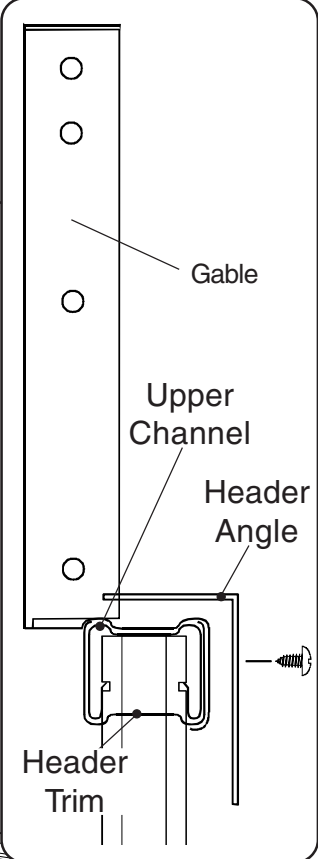
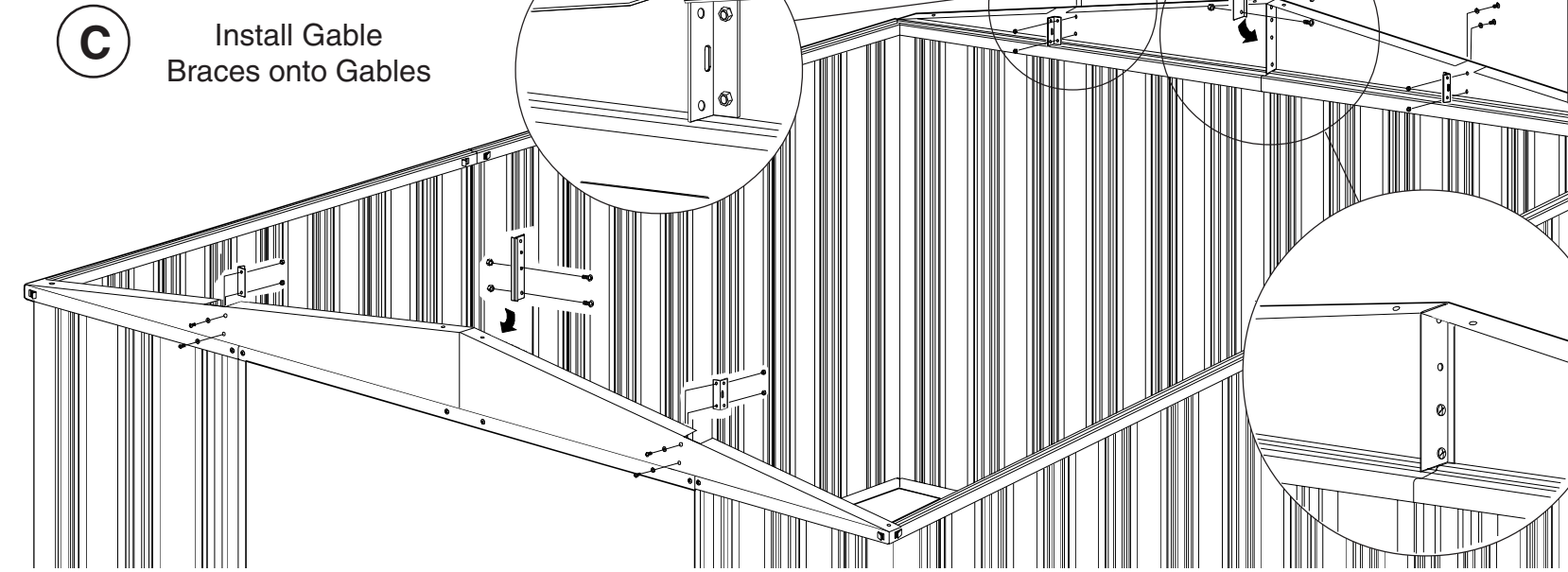
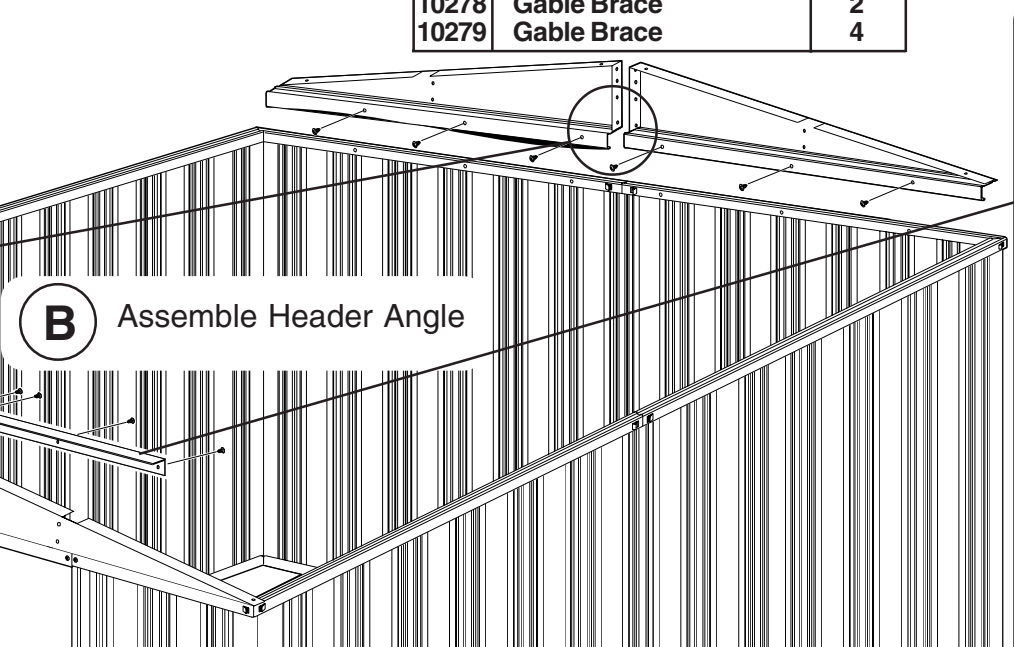
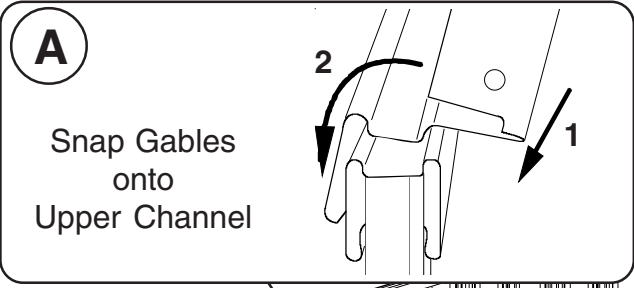
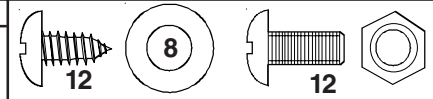

Gable & Ridge Beam Assembly . . .cont.



Part No	Name	Quantity
10302	Ridge Beam	4

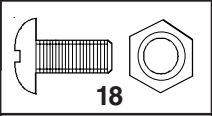

D1

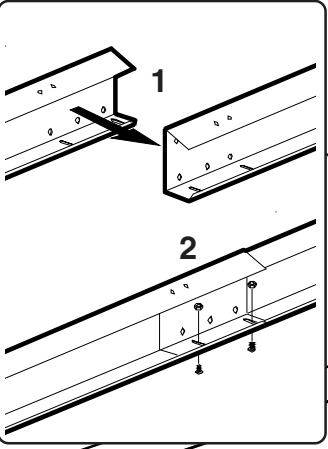

Assemble Ridge Beam

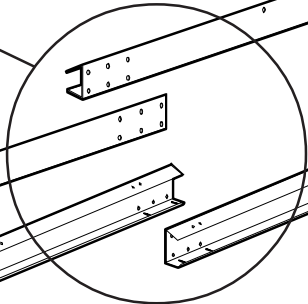

D2



Install Ridge Beam Assembly to Gables

E

Frame Must Be Square

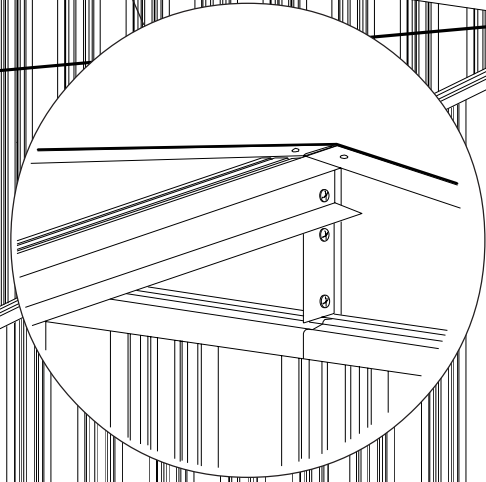

Step 6 Pre-assembly - Roof



Part No	Name	Quantity
10334	Right Roof Channel	4
10335	Left Roof Channel	4
10323	Channel Splice	4
10302	Beam	4

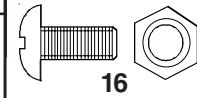

A Make Four (4) Roof Channel Assemblies

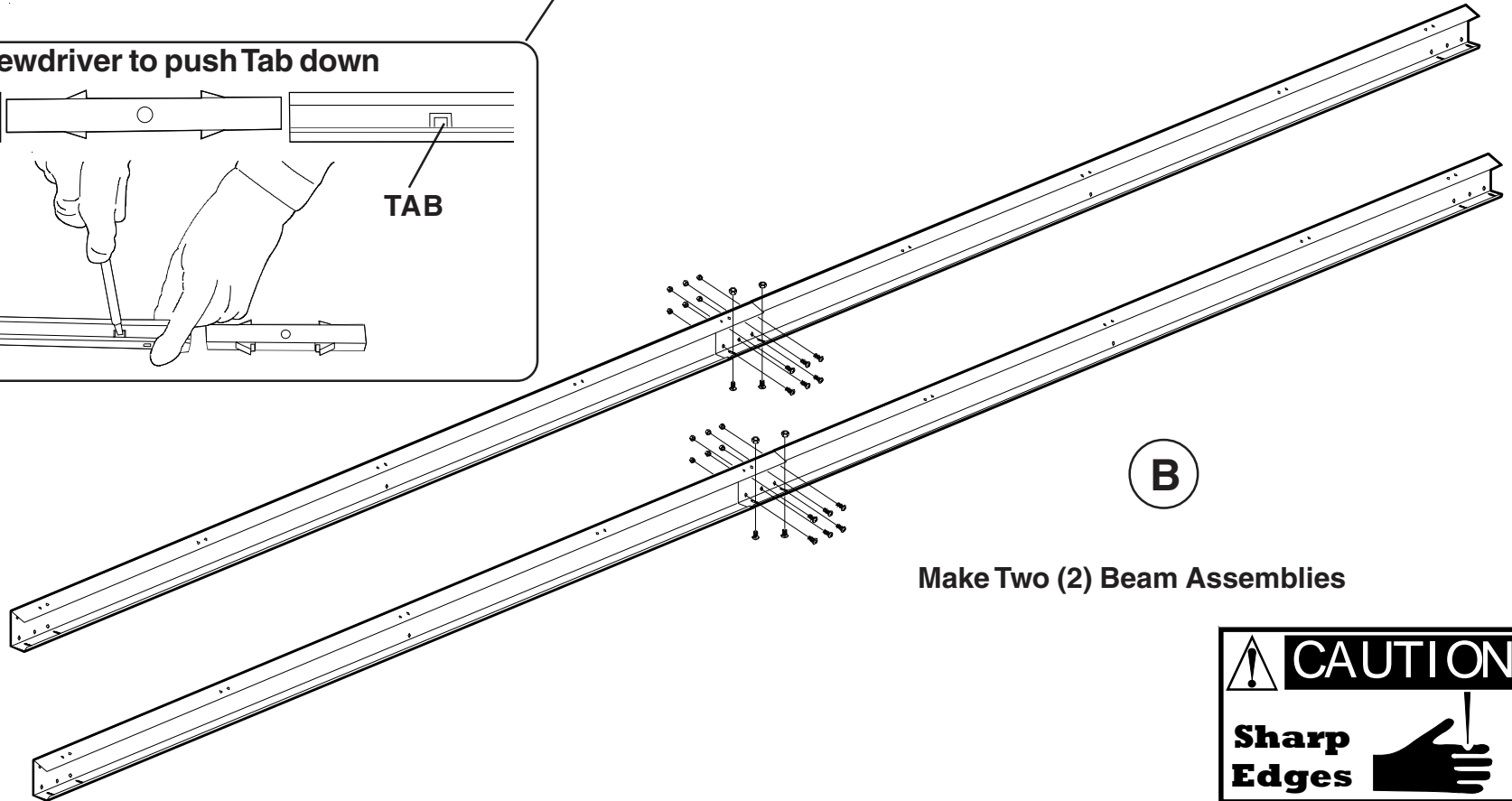
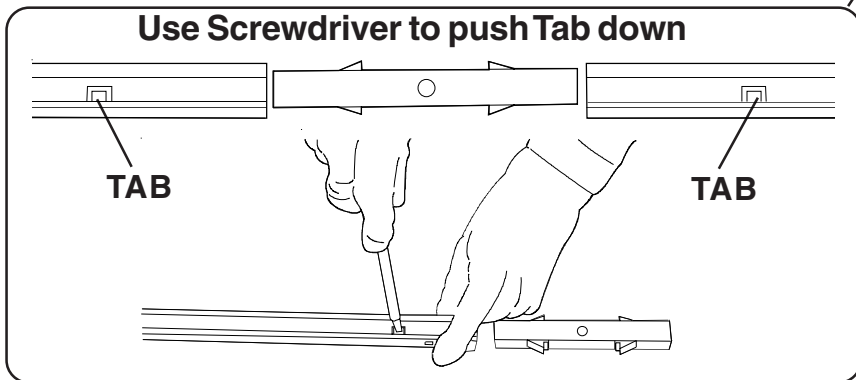
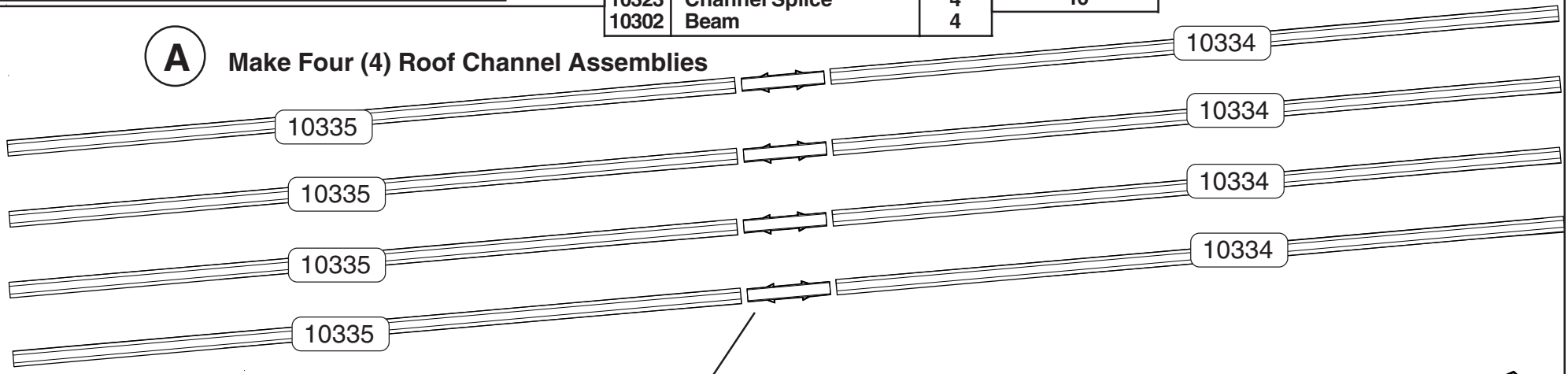

B

Make Two (2) Beam Assemblies



Pre-assembly - Roof . . .cont



Part No	Name	Quantity
10285	Roof Panel	10
10286	Roof Panel-Right	2
10287	Roof Panel-Left	2
	Roof Channel Assembly	4
10321	Roof Fascia	4

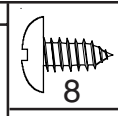

C MAKE TWO (2) ROOF SECTIONS

Align Roof Panels and snap panel ribs together

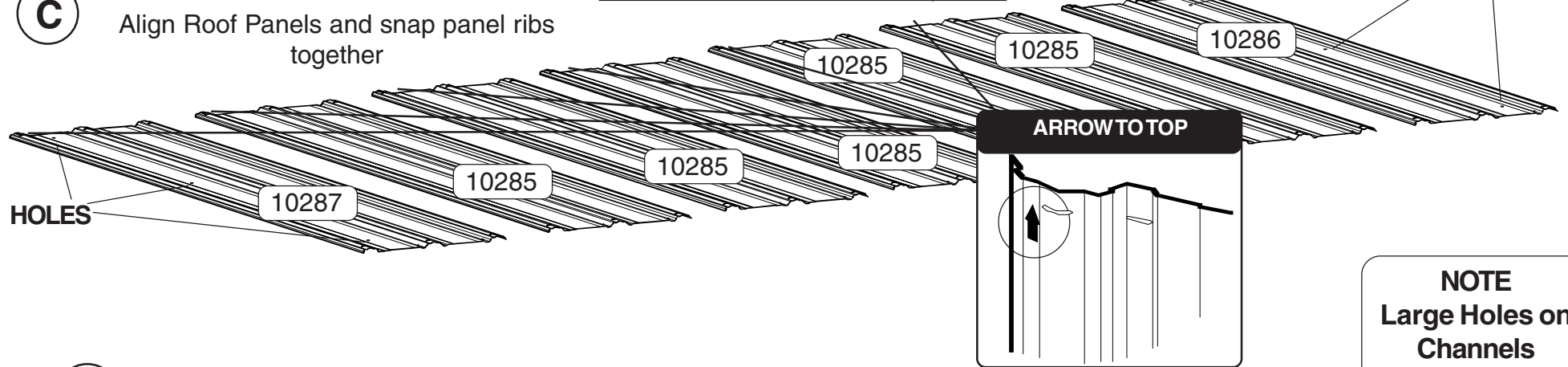

NOTE
Large Holes on Channels
FACE DOWN

D Assemble Roof Channel onto top and bottom

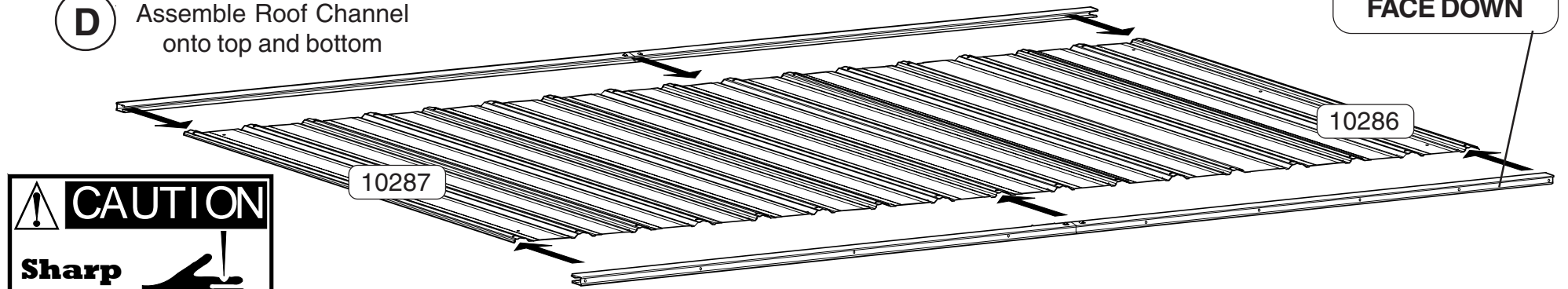

CAUTION
Sharp Edges

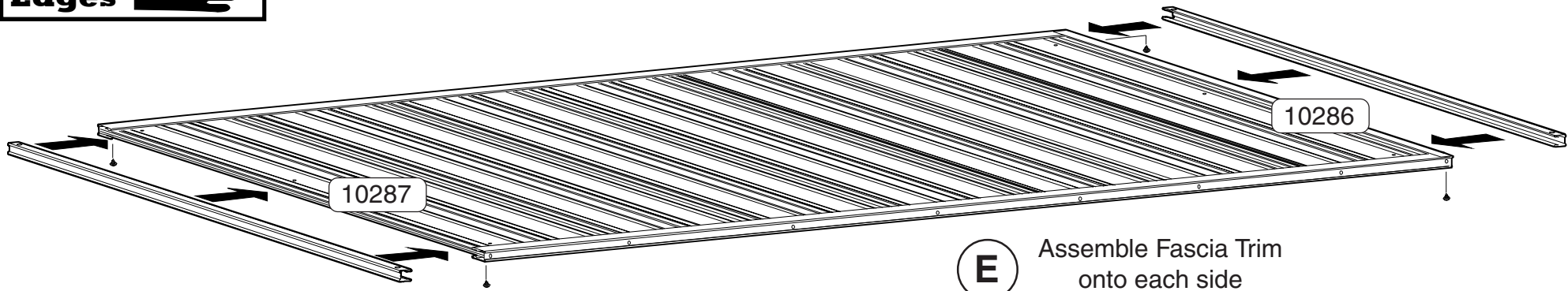

E Assemble Fascia Trim onto each side

Pre-assembly - Roofcont



Part No	Name	Quantity
	Beam Assembly	2

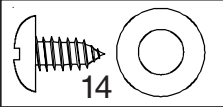

F

Attach Ridge Beam to
Roof Assembly

NOTE
HOLE POSITIONS

NOTE: ATTACH FROM CENTER OUT-
← W →

NOTE
HOLE POSITIONS

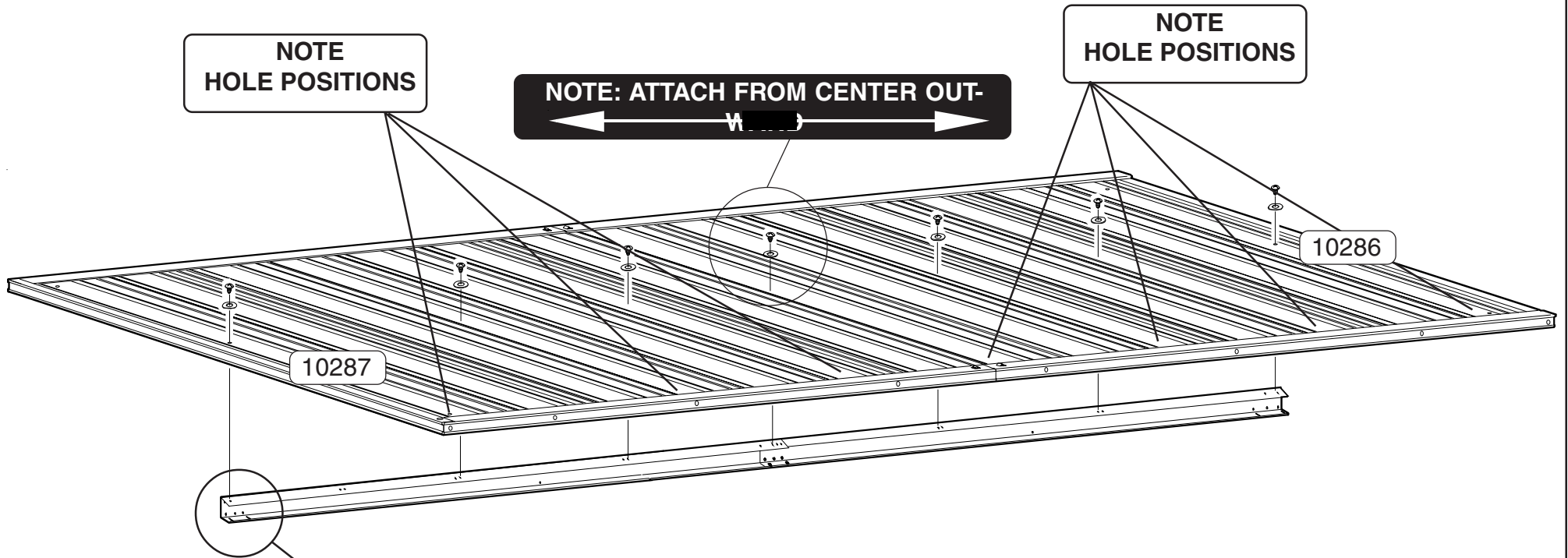

10287

10286

NOTE
LEGS OF RIDGE BEAM
FACE
HOLES ON ROOF PANELS



Step 7 Roof Assembly



Part No	Name	Quantity
10270	Ridge Cap	1
10306	Ridge Cap	1

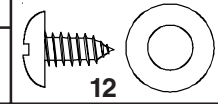

G

Assemble Left Roof Section
to building

NOTE
HOLE POSITIONS

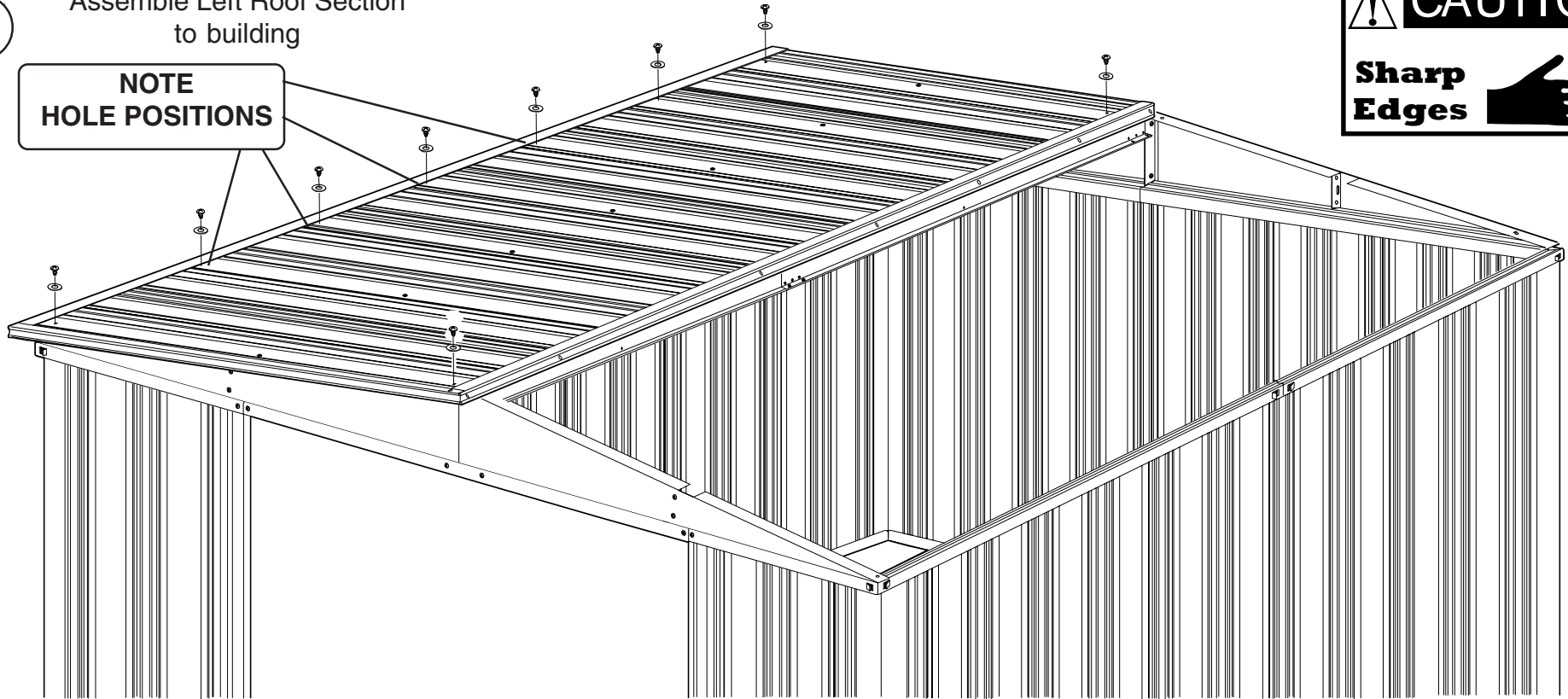

H

Install Ridge Cap on
Right Roof Section

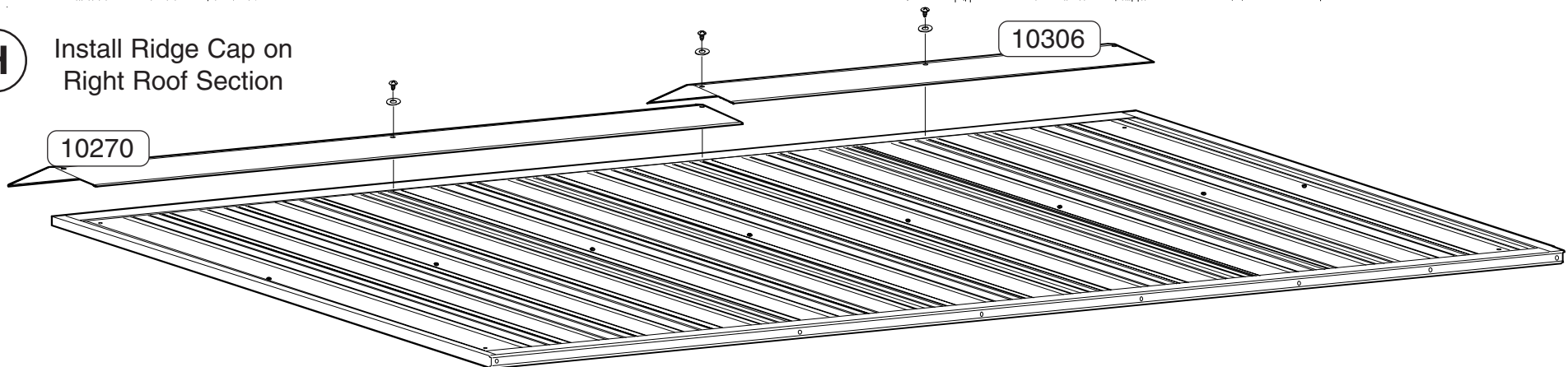

Roof Assembly...cont



Part No	Name	Quantity
	Peak Cap	2
	Corner Cap	4



I

Assemble Right Roof Section,
Peak Caps, & Corner Caps

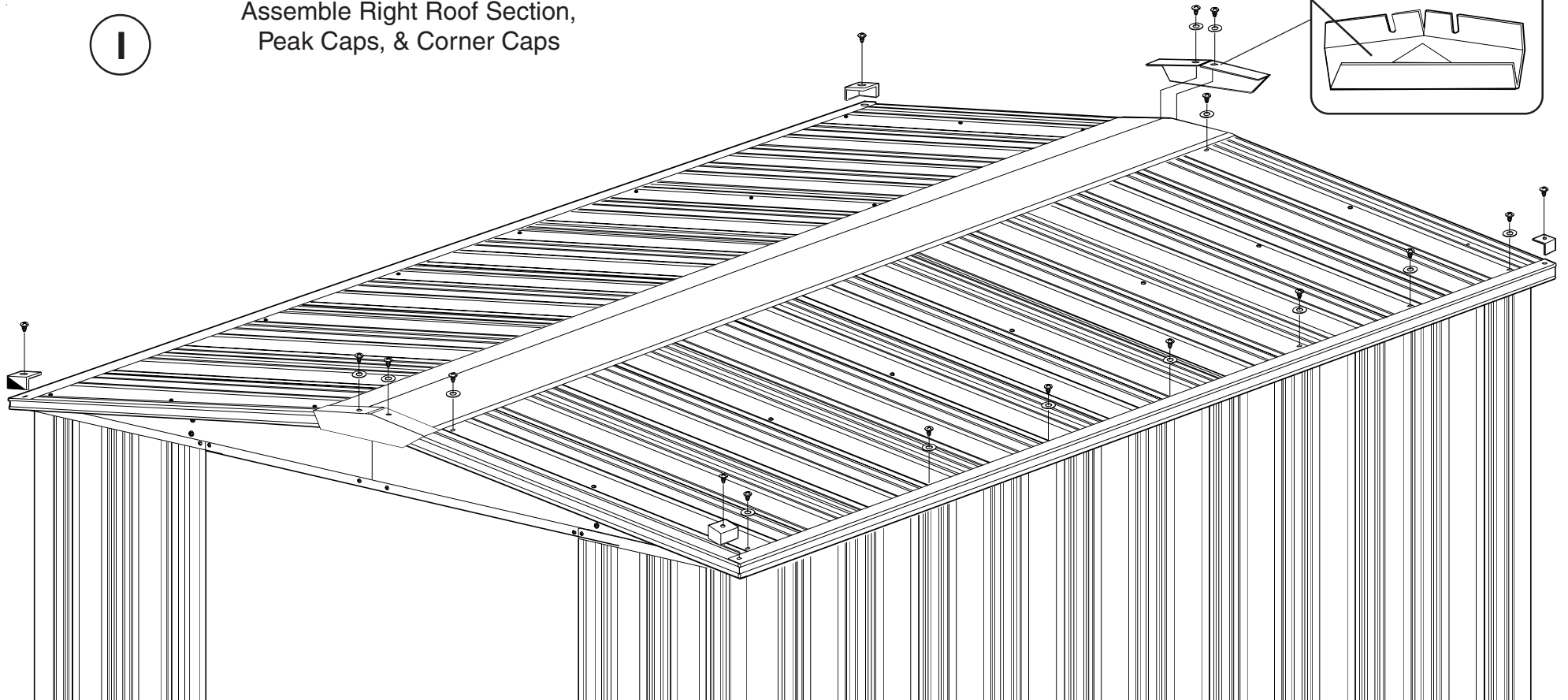

Roof Assembly...cont

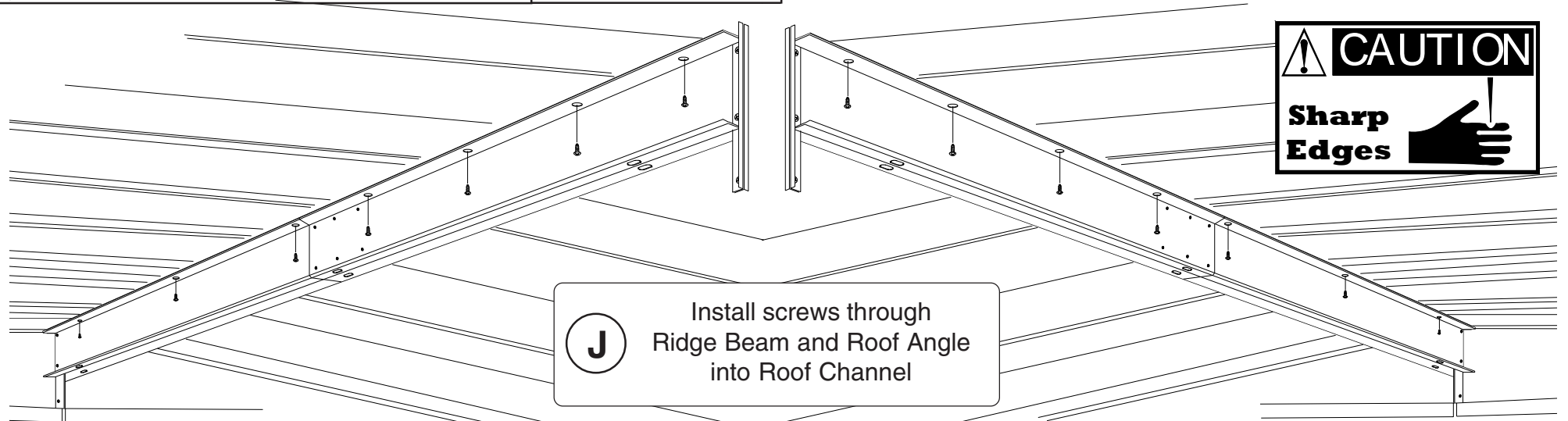
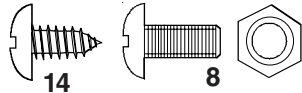

J

Install screws through Ridge Beam and Roof Angle into Roof Channel

HELPFUL HINT

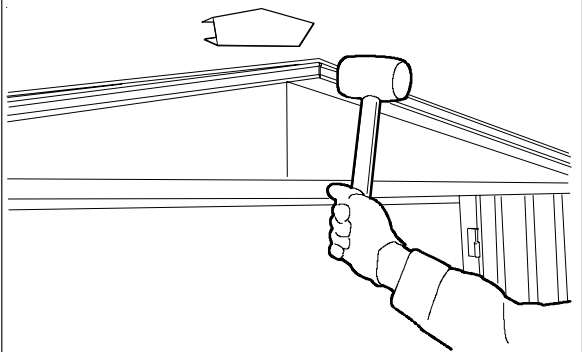

Gently tap Channel to align holes with Main Ridge Beam

K

Assemble Side Ridge Beams to Gable Braces

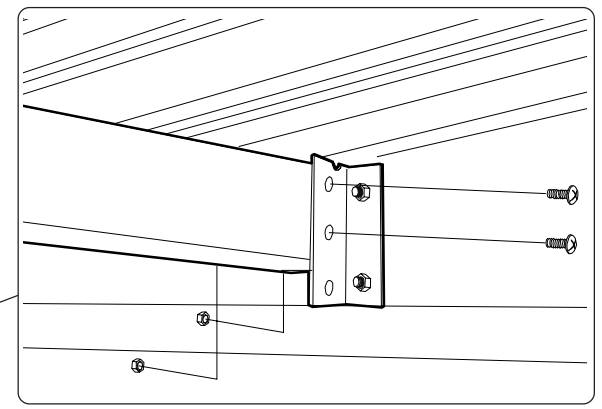
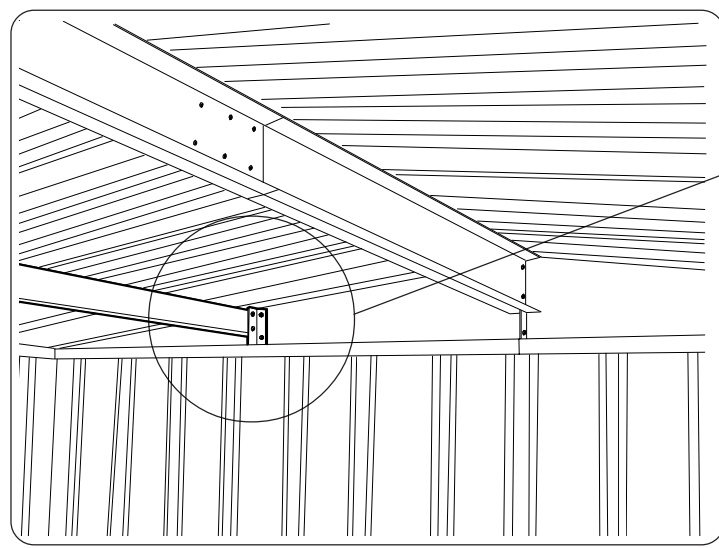

Typical (4) Places

Step 8 Right Door Assembly



Part No	Name	Quantity	Part No	Name	Quantity
10361	Vertical Door Brace	1	10364	Astragal	1
10363	Vertical Door Brace Handle	1		Clip	4
		1			

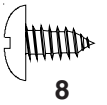

A Slide Clips onto Vertical Door Brace

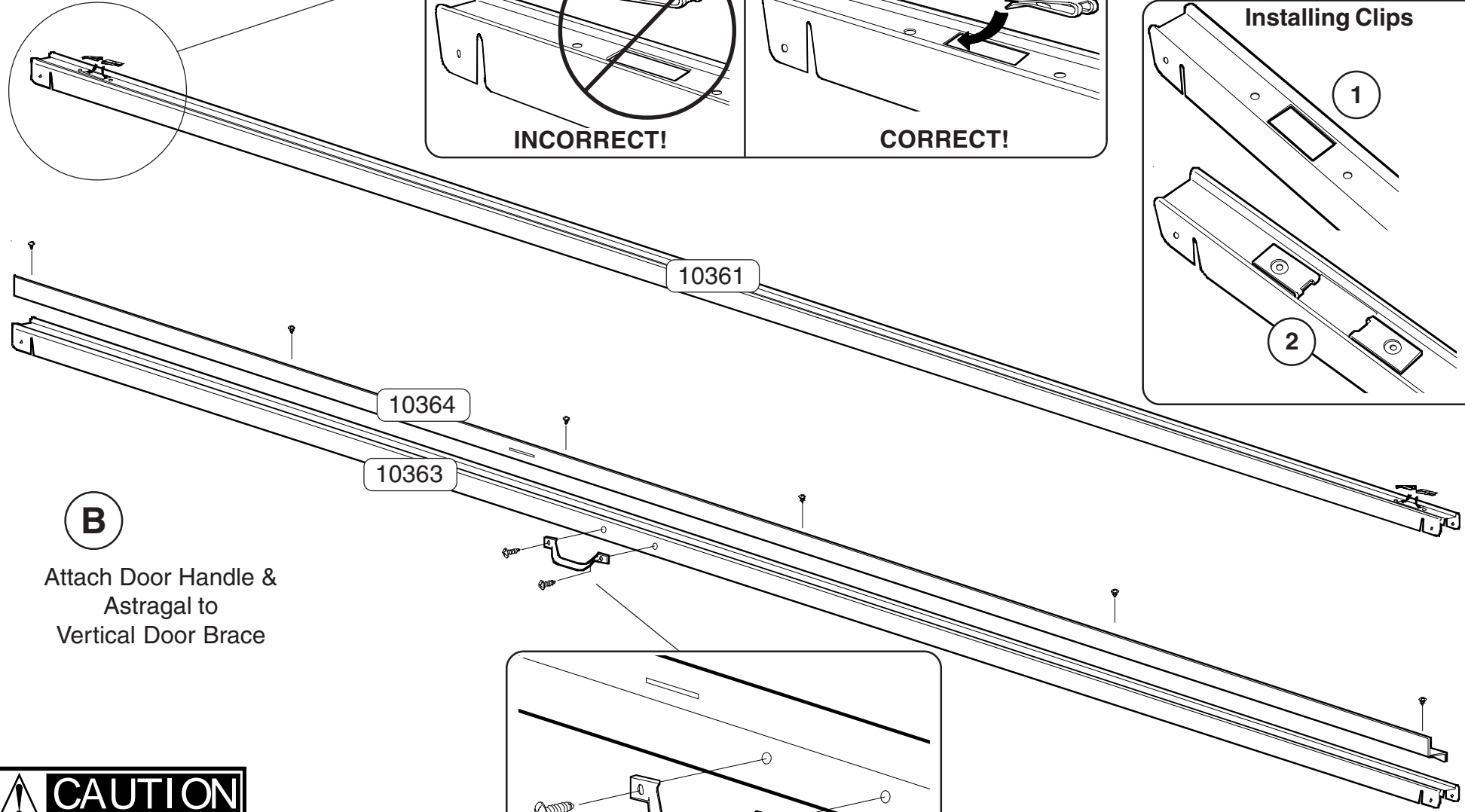
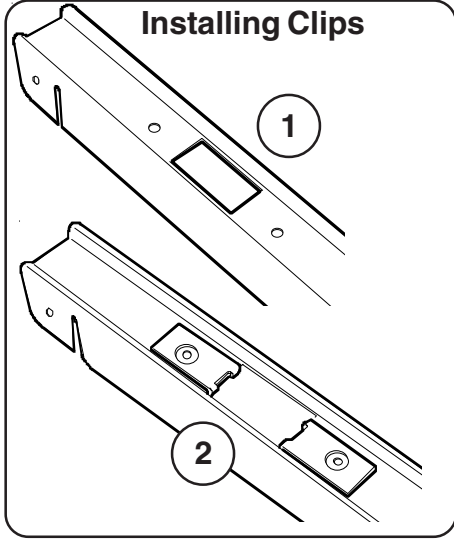
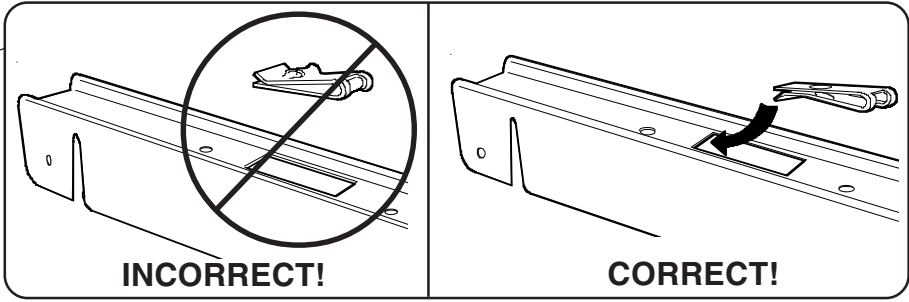

B Attach Door Handle & Astragal to Vertical Door Brace

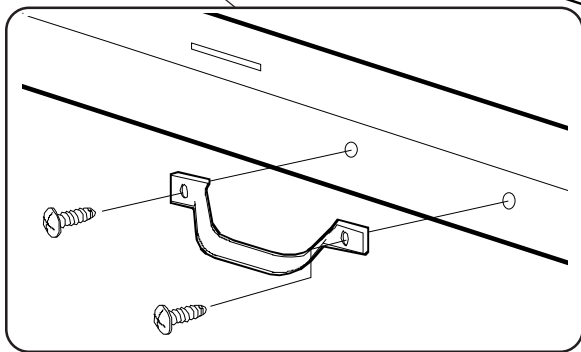

Right Door Assembly . . .cont



Part No	Name	Quantity	Part No	Name	Quantity
10310	Door Panel	1	10361	Vertical Door Brace	1
10311	Door Panel	1	10363	Vertical Door Brace	1
10301	Door Brace (Horz)	2			

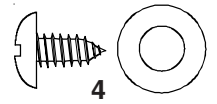

C Align Door Panels & snap Panel Ribs together

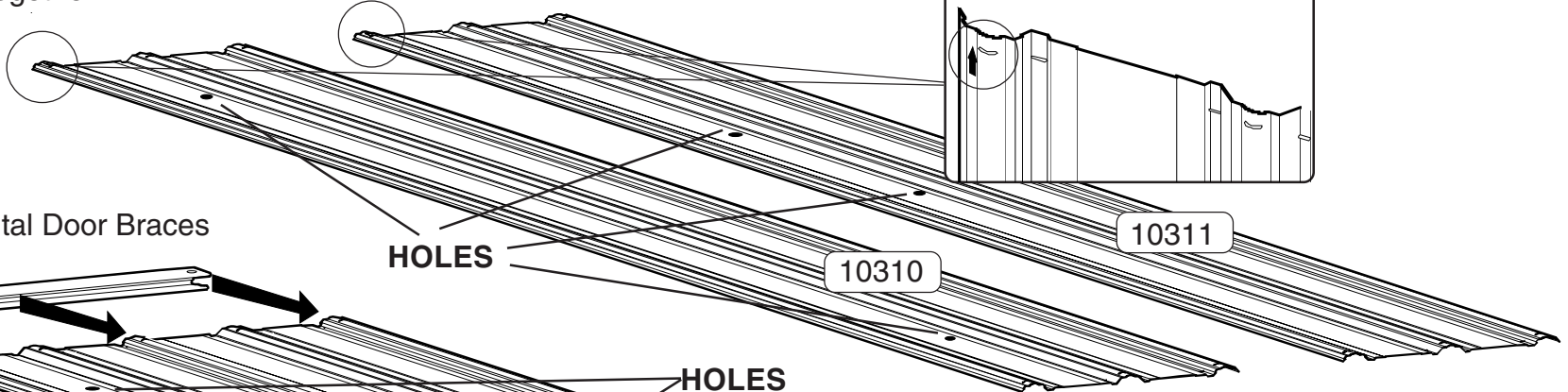

D Attach Horizontal Door Braces

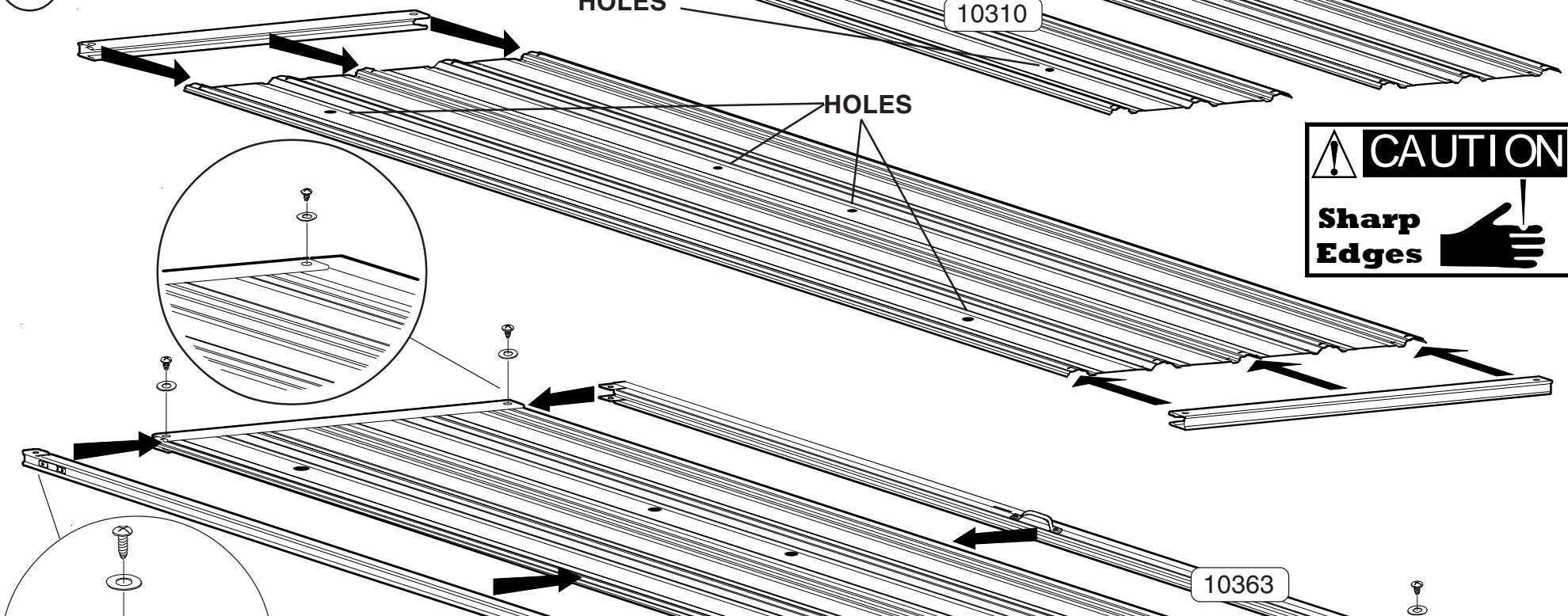

E Attach Vertical Door Braces

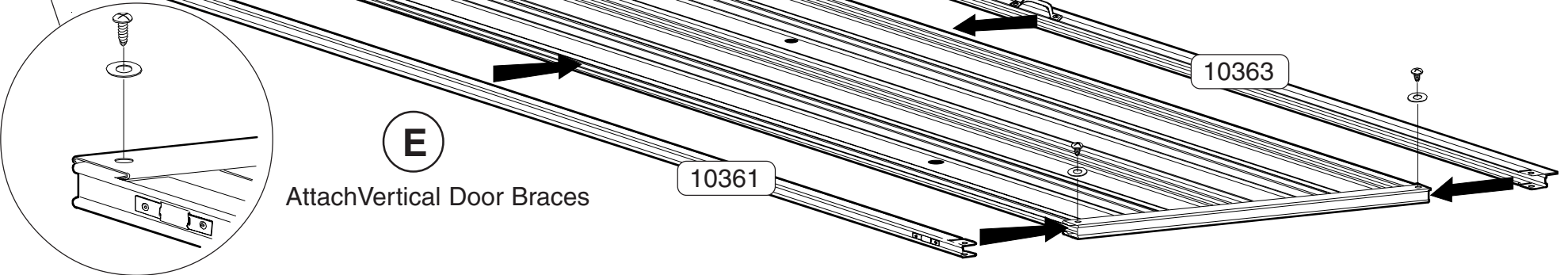

Right Door Assembly . . .cont



Part No
10295

Name
Diagonal Brace

Quantity
2

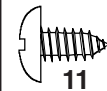

F Turn Door OVER

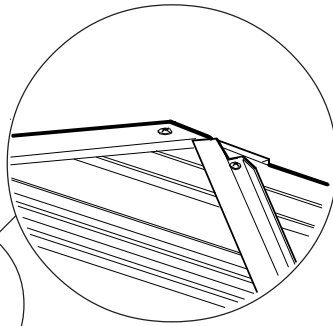
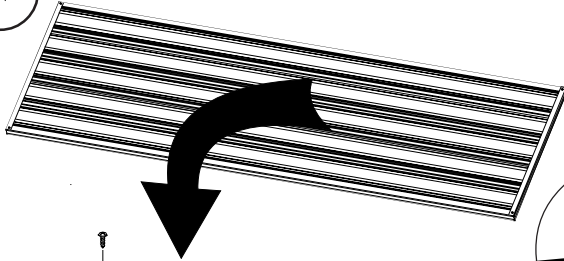

G

Attach Diagonal Braces & install Screws for Horizontal Braces

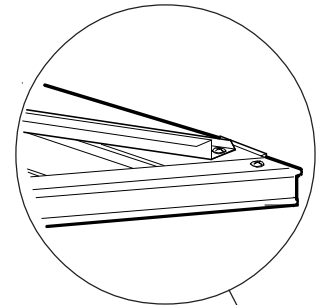

H Turn Door OVER

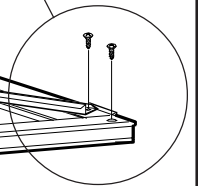
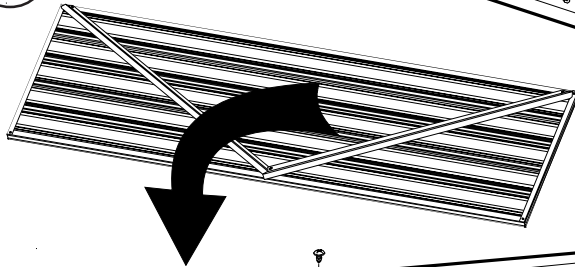

I

Install Screws for Diagonal Braces

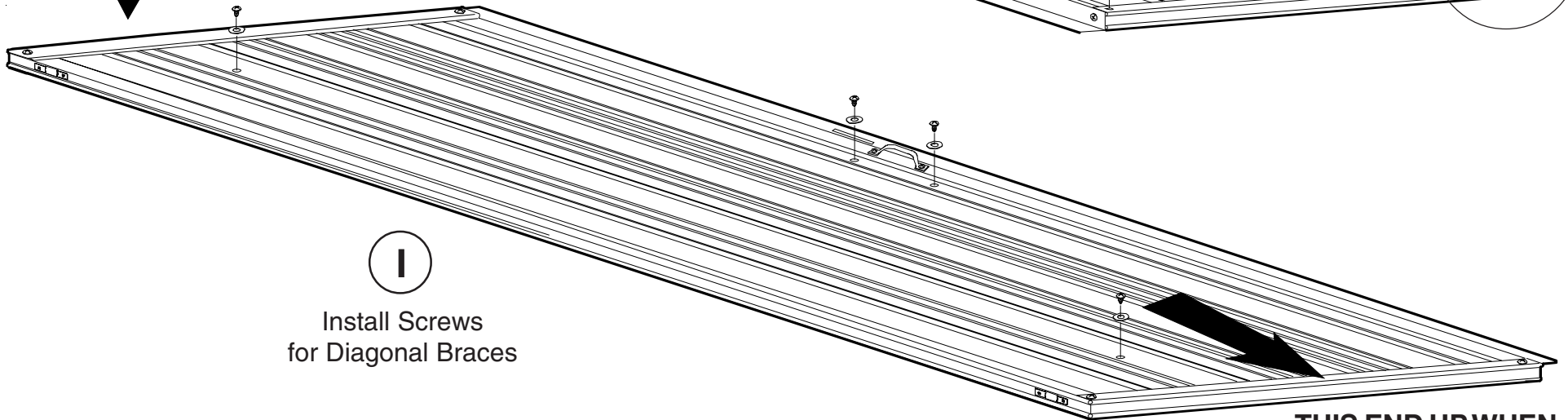

THIS END UP WHEN HANGING DOOR

Step 9 Left Door Assembly



Part No	Name	Quantity	Part No	Name	Quantity
10361	Vertical Door Brace	1		Padlock Eyelet	1
10362	Vertical Door Brace	1		Clip	4

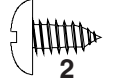

A Slide Clips onto Vertical Door Braces

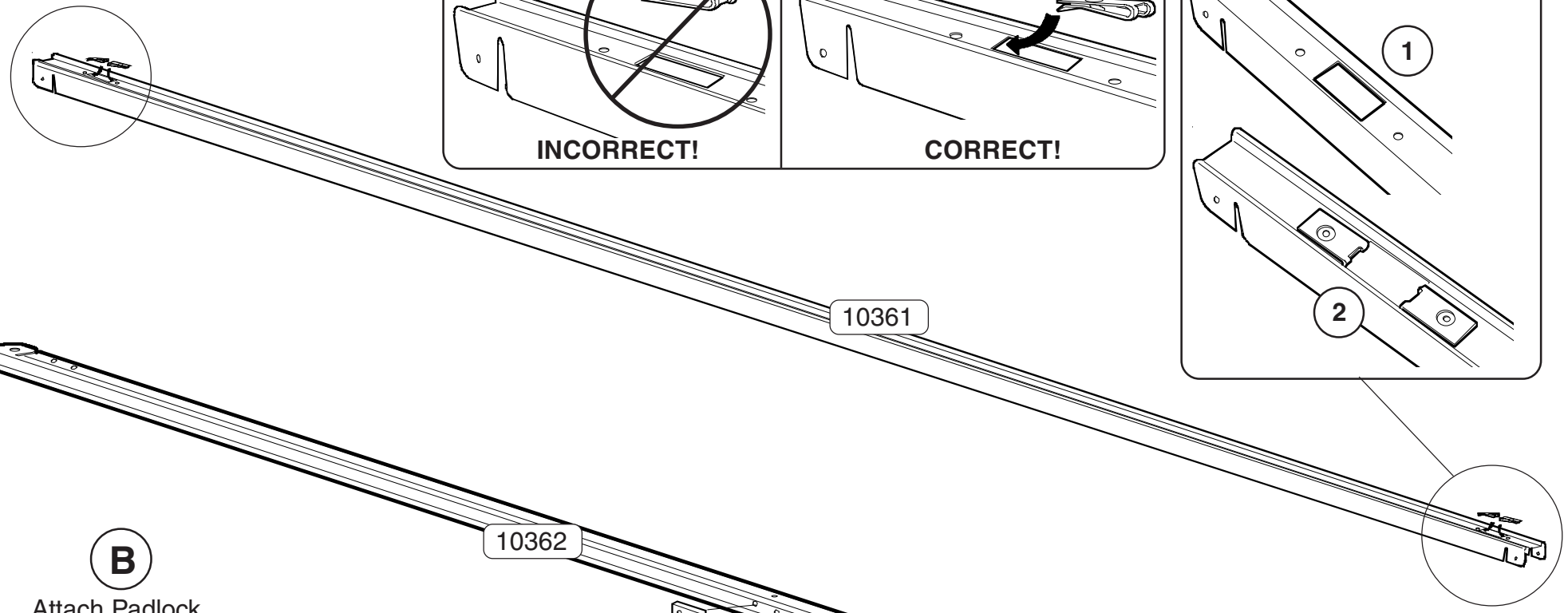
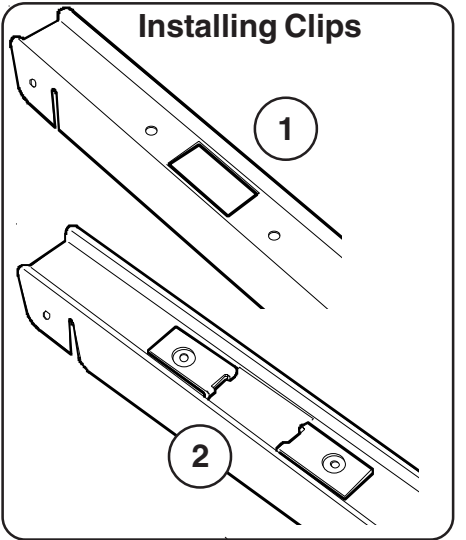
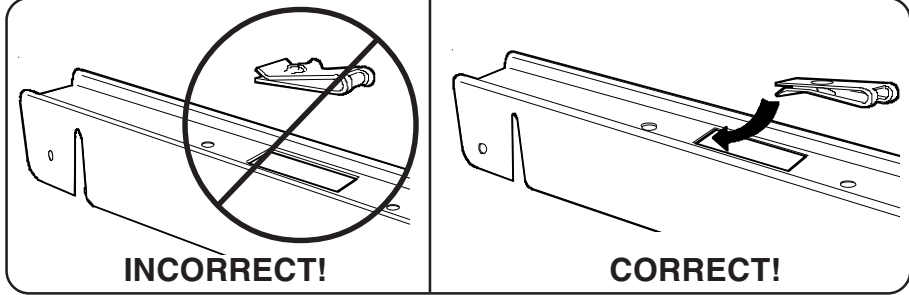

B Attach Padlock Eyelet to Vertical Door Brace

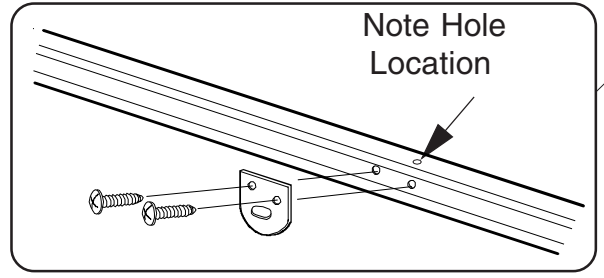

Left Door Assembly . . .cont



Part No	Name	Quantity	Part No	Name	Quantity
10310	Door Panel	1	10361	Vertical Door Brace	1
10311	Door Panel	1	10362	Vertical Door Brace	1
10301	Door Brace (Horz)	2			

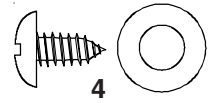

C Align Door Panels & snap Panel Ribs together

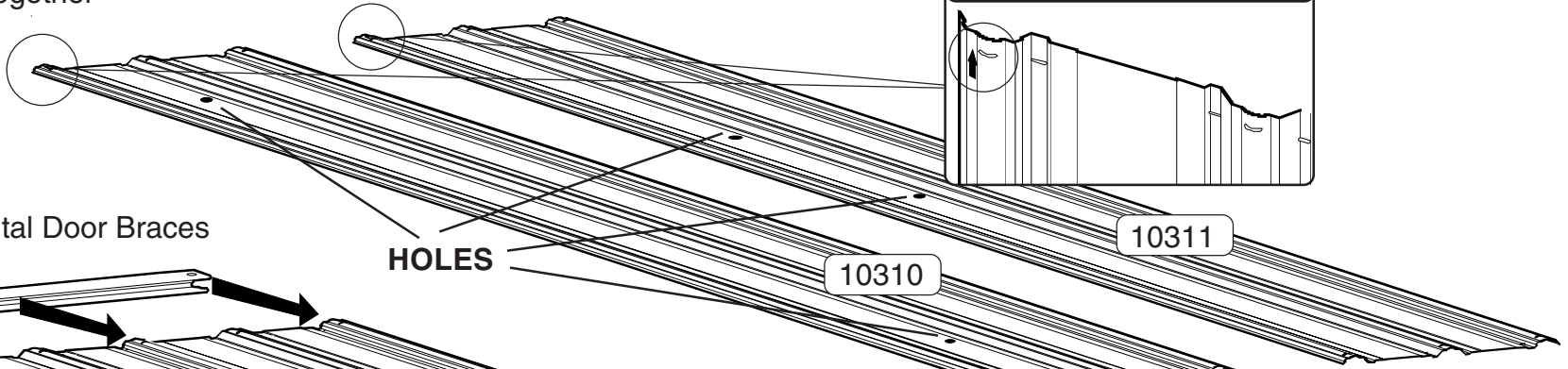

D Attach Horizontal Door Braces

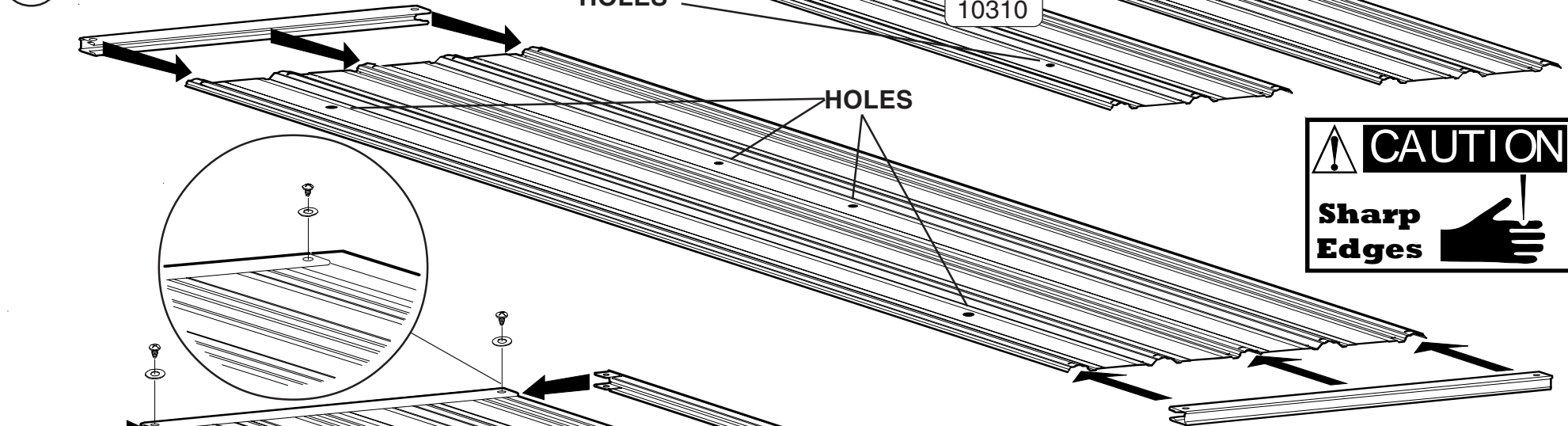

E Attach Vertical Door Braces

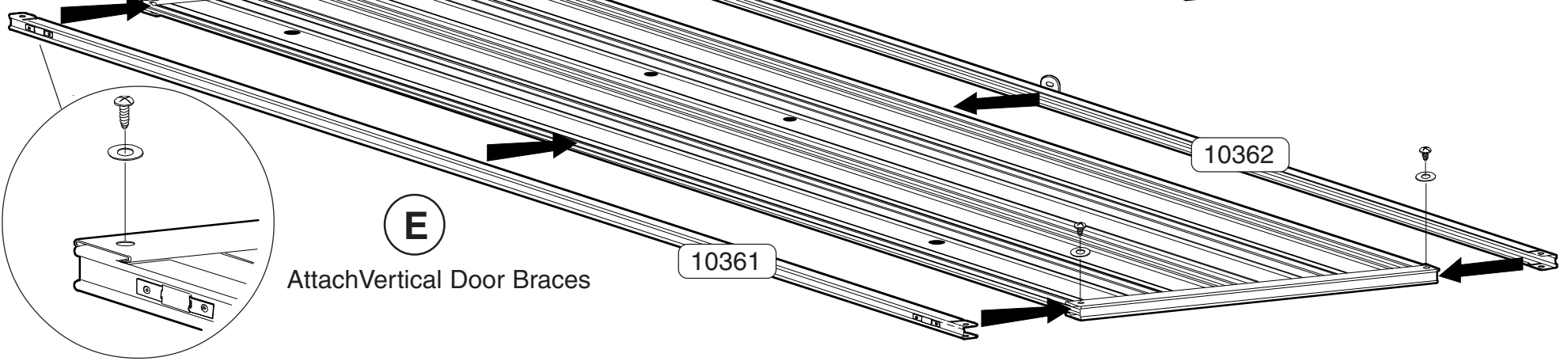

Left Door Assembly . . . cont



Part No	Name	Quantity
10295	Diagonal Door Brace	2
	Spring Pin upper	1
	Spring Pin lower	1

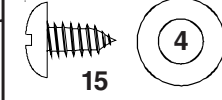

F Turn Door OVER

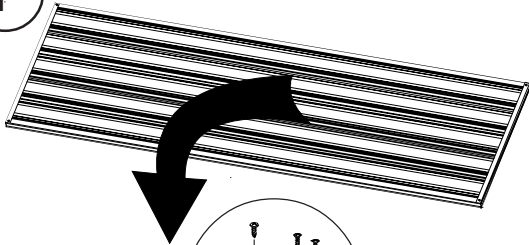

H
Attach Upper Spring Pin

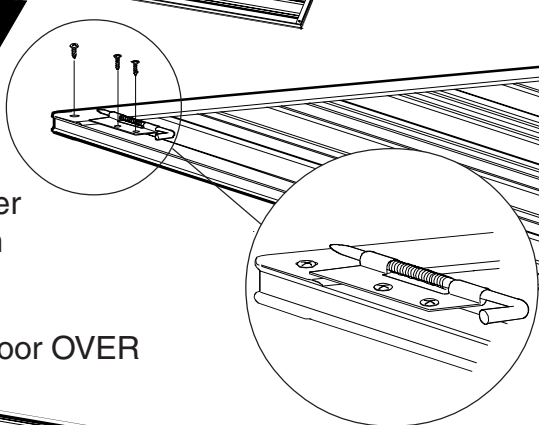

G
Attach Diagonal Braces & install Screws for Horizontal Braces

J Turn Door OVER

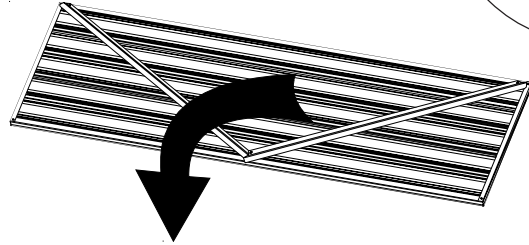

THIS END UP WHEN HANGING DOOR

I
Attach Lower Spring Pin

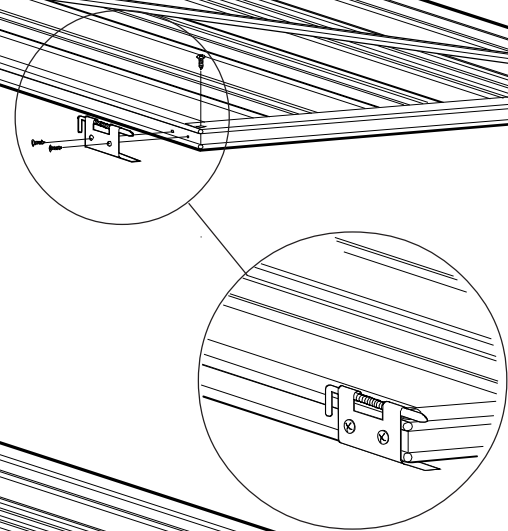

K
Install Screws & Washers for Diagonal Braces

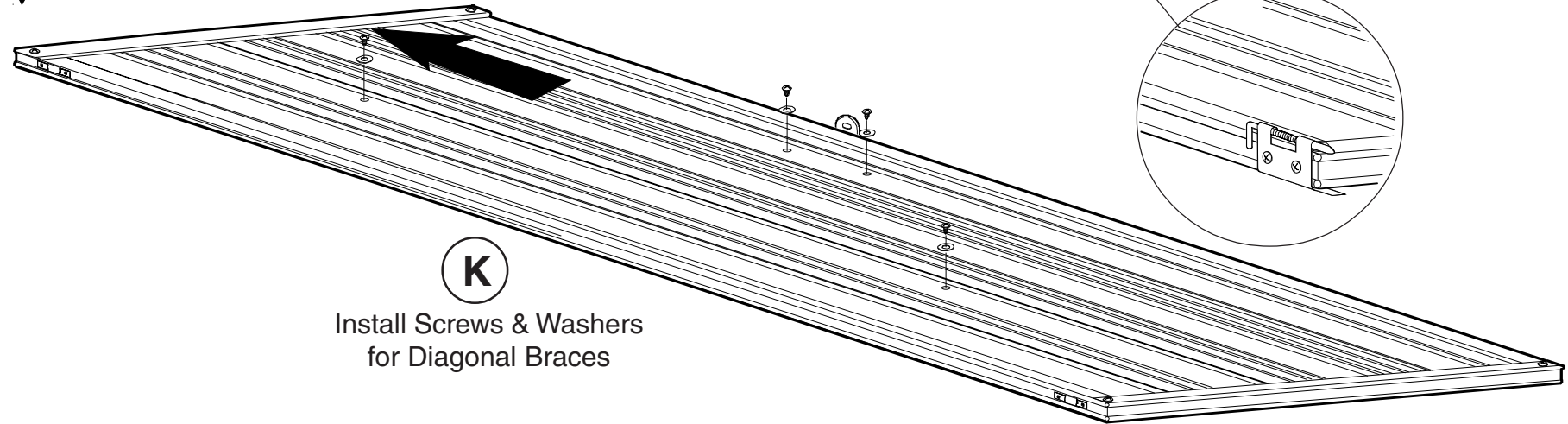

Door Assembly . . .cont



Part No	Name	Quantity
66718	Hinge	4
10292	Ramp	1

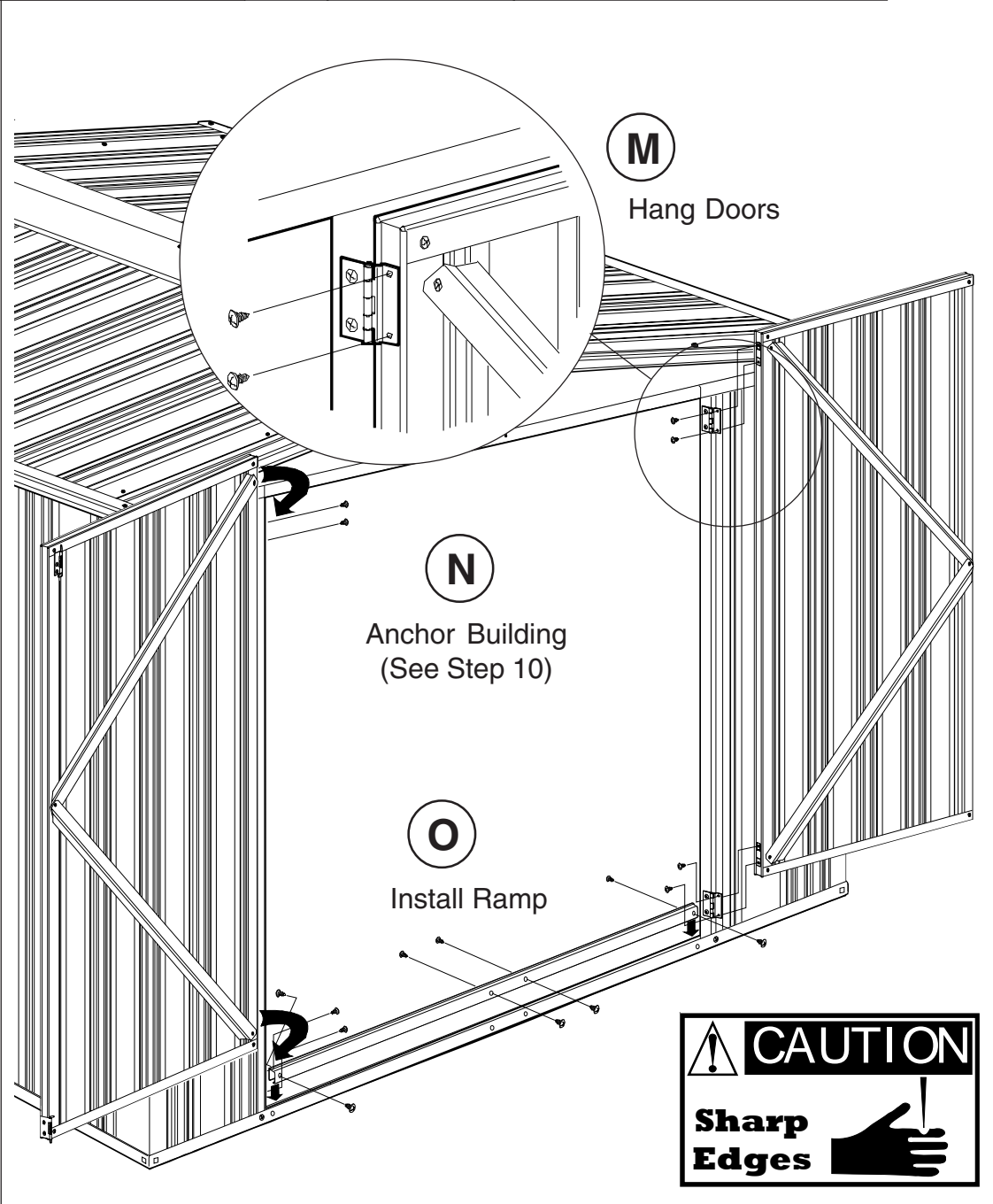
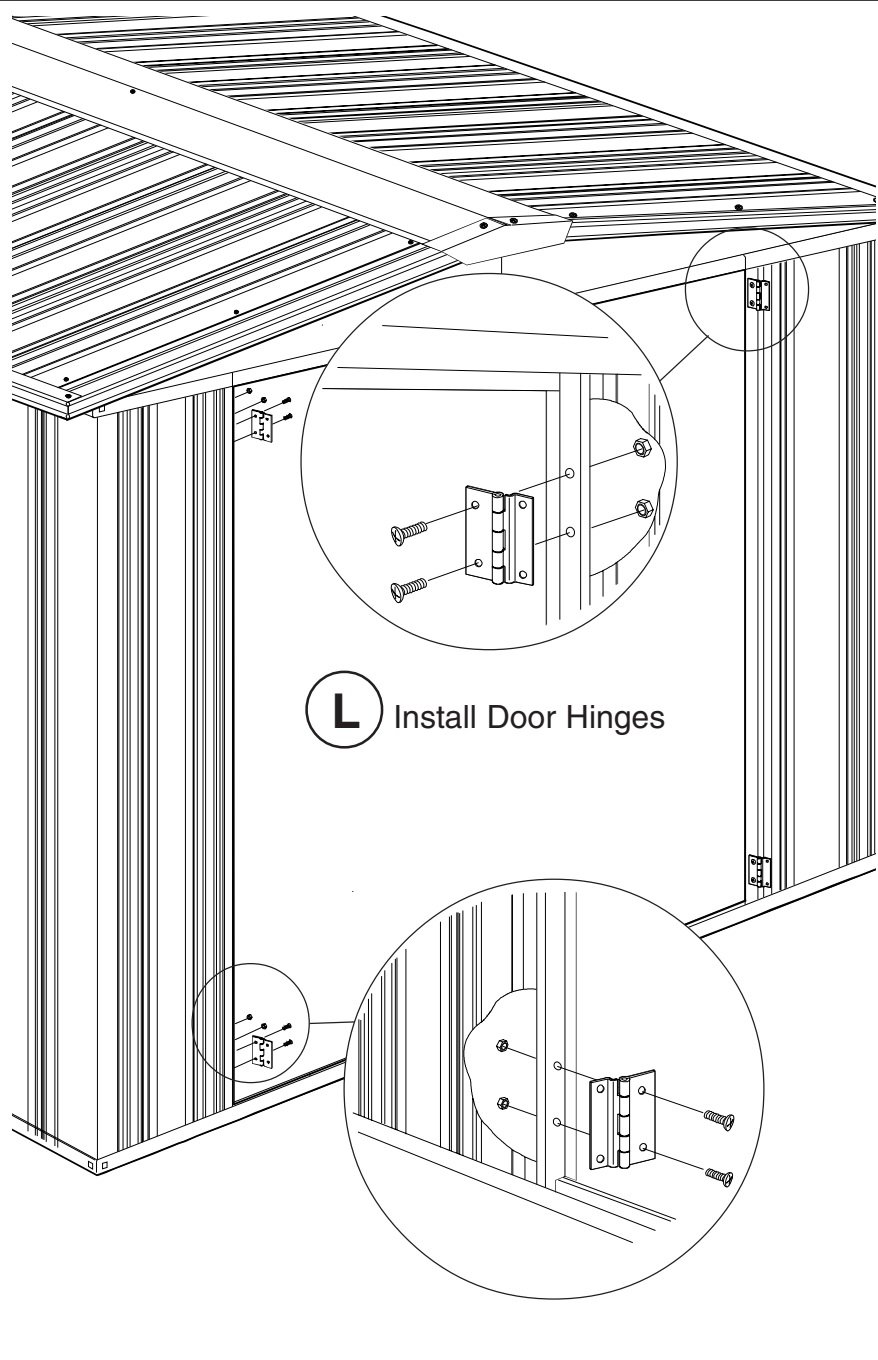
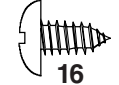
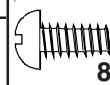

Step 10 Anchor Building



It is important that building be anchored after construction. These are recommended ways of anchoring.

Anchor Kit Model No AK100, SAK100 or 68383

Recommended for use with concrete foundation. Contains corner gussets, perimeter clips, hardware, 1/4" masonry drill bit and installation instructions.

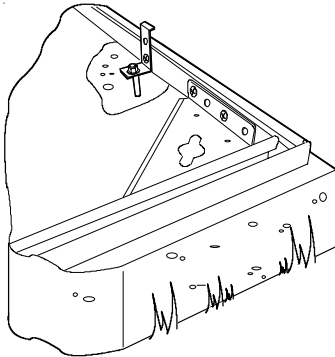

Anchor into Wood or Concrete

For wood platform. Use Decking Screws.
For concrete slab. Use Lag Screws.

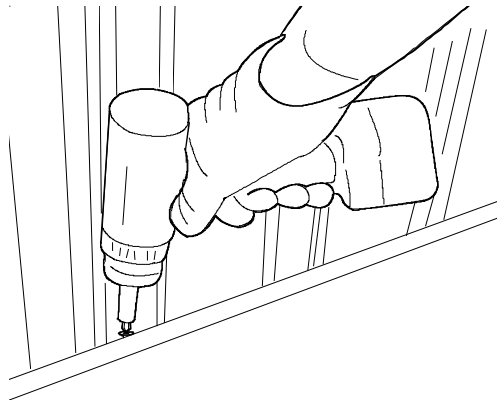

Anchor Kit Model No AK4, SAK4 or 60298

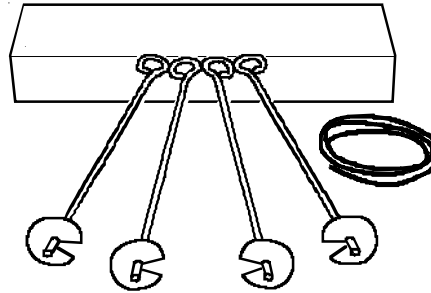

Recommended for use with any suggested base. Contains 4 Anchors with Cable, clamps and installation instructions.

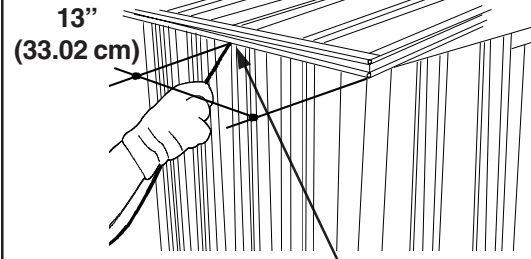

Insert Cable

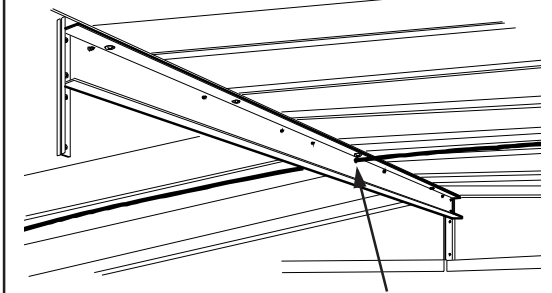

Feed Cable through hole in Ridge Beams

Turn Anchors into ground close to building and attach Cable.

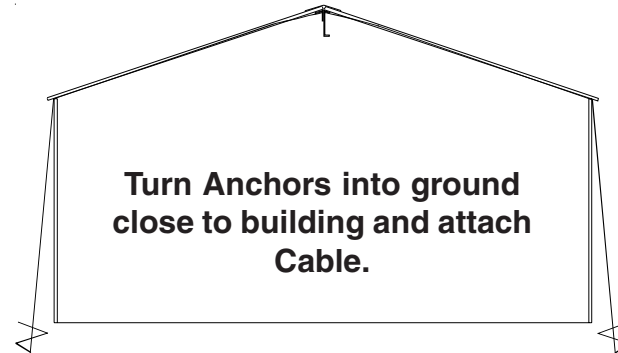

Parts List 8x7

Dia. No.	Part Name	Qty	Part No.
1	Wall Panel	19	10307
2	Corner Panel	4	10268
3	Upper Channel - Painted	4	10341
4	Floor Channel - Unpainted	4	10340
5	Channel Splice	12	10323
6	Corner Clip	8	10280
7	Wall Panel - Right	1	10316
8	Wall Panel - Left	1	10317
9	Upper Channel - Painted	4	10305
10	Floor Channel - Unpainted	4	10297
11	Door Jamb	2	10371
12	Header Trim	1	10291
13	Left Gable	2	10293
14	Right Gable	2	10294
15	Header Angle	1	10260
16	Gable Brace	2	10278
17	Gable Brace	4	10279
18	Ridge Beam	8	10302
19	Right Roof Channel	4	10334

Dia. No.	Part Name	Qty	Part No.
20	Left Roof Channel	4	10335
21	Roof Panel	10	10285
22	Roof Panel (left)	2	10287
23	Roof Panel (right)	2	10286
24	Roof Fascia	4	10321
25	Ridge Cap	1	10270
26	Ridge Cap	1	10306
27	Peak Cap	2	
28	Corner Cap	4	
29	Door Panel	2	10310
30	Door Panel	2	10311
31	Vertical Door Brace	1	10363
32	Vertical Door Brace	1	10362
33	Horizontal Door Brace	4	10301
34	Diagonal Door Brace	4	10295
35	Astragal	1	10364
36	Ramp	1	10292
37	Vertical Door Brace	2	10361

If you find any parts missing during construction call:

1-800-851-1085

or write:

CUSTOMER SERVICE

1101 North Fourth Street
Breese, Illinois 62230

www.sheds.com

*Please include your Model Number, Part Number,
and Part Name*

Keep this Assembly Manual for further reference.

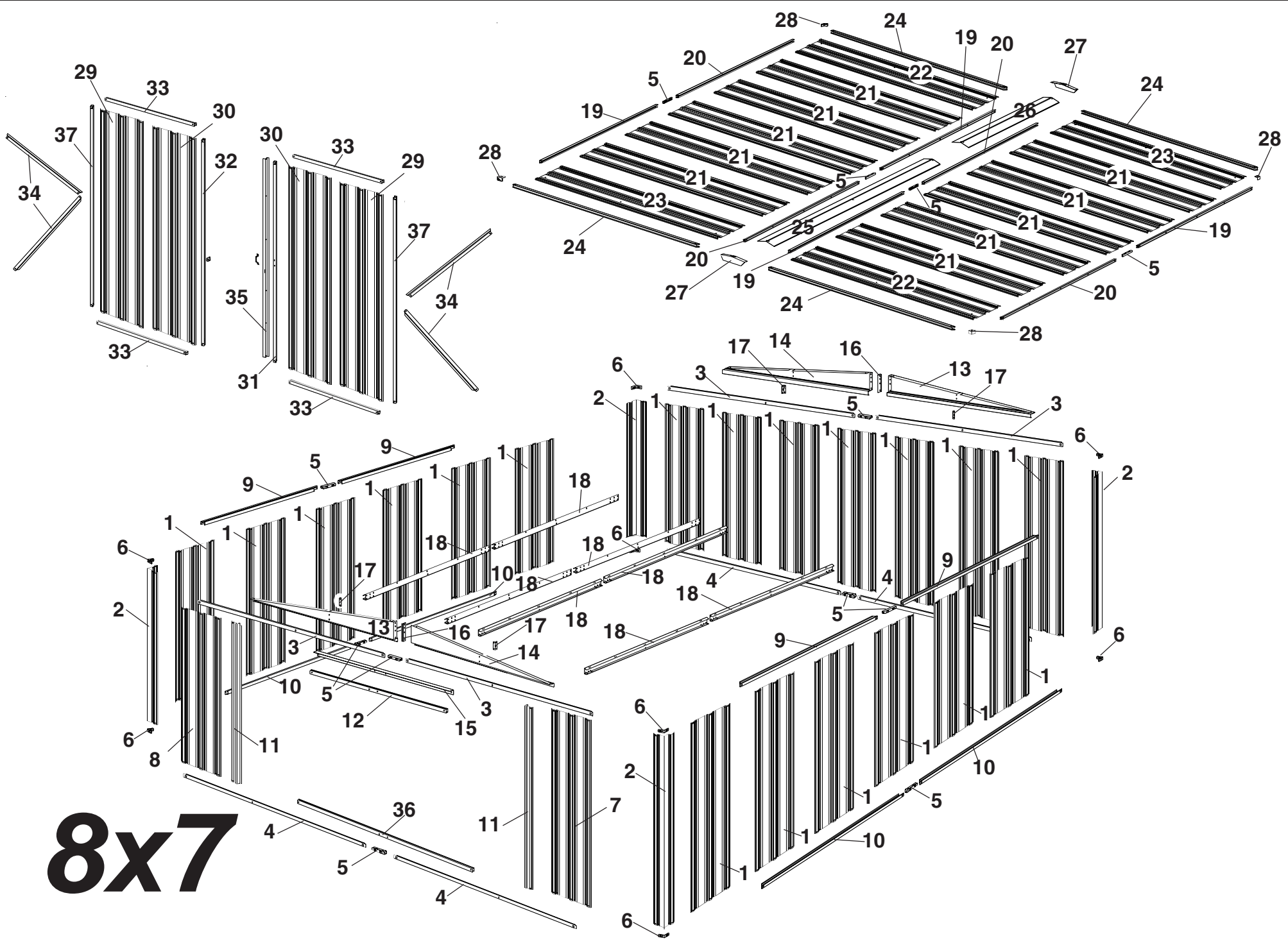

8x7