

**Montezuma**<sup>®</sup>  
LIFE ORGANIZED



OWNER'S MANUAL  
**40" MOBILE  
WORK CART**

MUC4039B

[www.montezumastorage.com](http://www.montezumastorage.com)

# LIFE ORGANIZED

Montezuma is committed to helping you succeed in both your work and personal life by being organized, prepared and equipped with the right tools, gear and home supplies at your finger tips.

We are here to ensure that your life is organized.

Thank you for your purchase of this Montezuma Mobile Work Cart.

## ATTENTION

**TO REDUCE THE RISK OF INJURY, THE USER MUST READ AND UNDERSTAND THIS INSTRUCTION MANUAL BEFORE USING THIS PRODUCT FOR THE FIRST TIME. SAVE THESE INSTRUCTIONS FOR FUTURE REFERENCE.**

Fill in the following information and retain this owner's manual for future reference:

MODEL(S):

---

DATE OF PURCHASE:

---

PLACE OF PURCHASE:

---

RECEIPT NO:

---

# SPECIFICATIONS

MAXIMUM PRODUCT WEIGHT (INCLUDING CONTENTS): 525 lb (238 kg)

MAXIMUM DRAWER WEIGHT: 80 lb (36 kg)

MAXIMUM TOP TRAY WEIGHT: 130 lb (59 kg)

MAXIMUM MIDDLE TRAY WEIGHT: 140 lb (64 kg)

MAXIMUM BOTTOM WEIGHT: 175 lb (79 kg)

## POWER STRIP

MODEL: DB-F-M

RATING: 125 V AC 15 A 60 Hz 1875 W

USB: TOTAL 2.1 A – Check your device for compatibility

USB O/P: IT EQUIPMENT ONLY

CONFORMS TO UL STD. NO 1363 AND ANSI/UL STD. NO. 1449

CERTIFIED TO CSA STD. C22.2 NO. 308&8

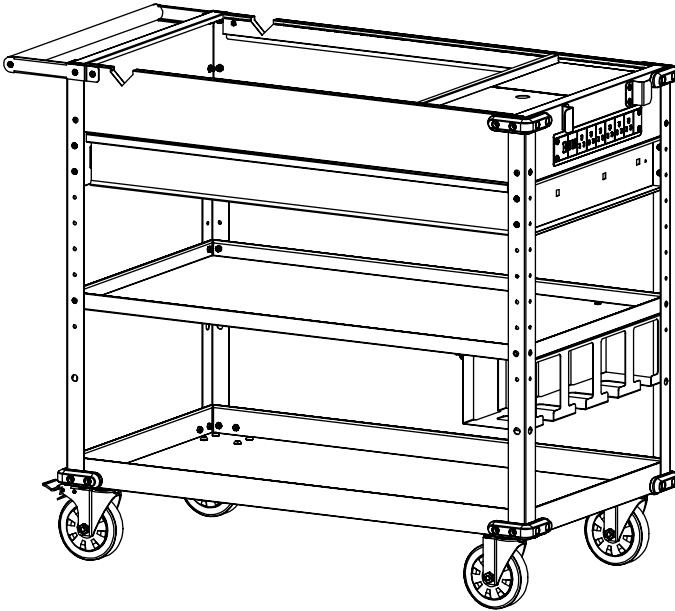

# MAINTENANCE

Periodically clean the drawer fronts, trim, and other surfaces with mild detergent and water.

Lubricate the casters with high quality bearing grease (annually/yearly).

Lubricate the slides (twice a year) with a product like WD40 or other quality lubricant. This is especially important in low temperatures, which can cause the bearing to become stiff.

Grease and oil can be removed with most standard cleaning fluids. For safety, use a nonflammable cleaning fluid.

Check the cart regularly to ensure the casters move freely and that the drawer slides are functioning properly.

# SAFETY

**RISK OF ELECTRIC SHOCK.** To reduce the risk of electric shock, use indoors in a dry location only. Grounding required.

Do not exceed the maximum weight limits described in this manual. Overloading the cart could cause it to tip, collapse or damage the drawer slides.

Balance the load of the cart to avoid tipping. Maximum weight limits given in this manual are for specific sections of the cart and are based on evenly distributed weights for that section.

Do not move the cart with the drawer extended. This could cause the cart to become unstable and tip.

Keep the cart on a level surface. Do not load, unload or park the cart on an incline. The cart could become unbalanced and tip, resulting in injury.

Lock the cart's casters when it is not being moved.

Do not modify this cart in any way. Drilling holes or modifications of any kind will lower the load capacities, which have been tested, and could cause the cart to collapse.

Keep children and bystanders away while loading, unloading or moving the cart.

Transport the cart when it is empty. Secure it properly during transport. Do not mount the cart to the bed of a truck or any other moving object.

Do not use the drawer or shelves as steps. Do not stand on the cart. The cart could tip or a shelf could collapse, which may cause serious injury.

Do not use in recessed areas or below floor levels. This cart has an electrical outlet – if actively being used, it could spark if exposed to flammable liquids, gases or dust.

The electrical plugs on the electrical socket on this cart must match the outlet they are plugged into. Never modify the plug in any way. Do not use any adapter plug with earth grounded power strips.

# PARTS LIST

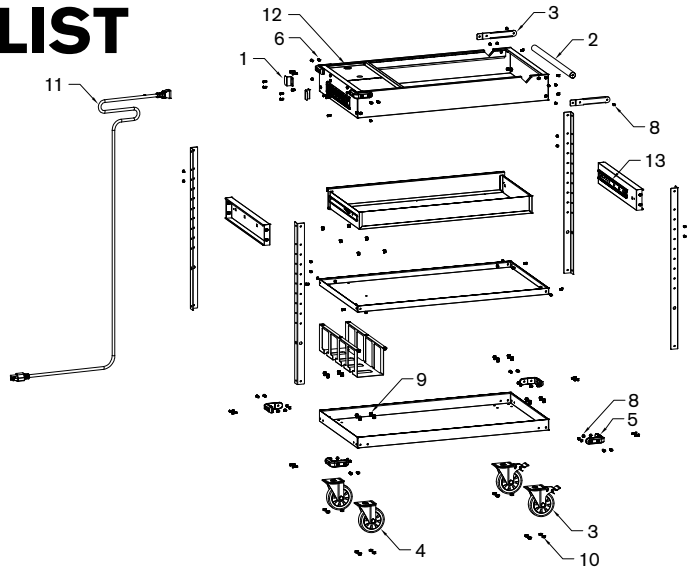

REF	DESCRIPTION	PART NUMBER	QTY
1	Cord Wrap Bracket	20.1000.2	2
2	Handlebar Assembly (includes handlebar and two handle attachments)	7.1001.2	1
3	Swivel Casters with Brake	16.1000.2	2
4	Swivel Caster	19.10002.1	2
5	Bumper	21.1000.2	6
6	M6 x 18 mm Bolt	10.1005.2	25
7	M6 x 12 mm Bolt	10.1004.2	48
8	M6 Nut	11.1000.2	25
9	M8 x 12 mm Bolt	10.1006.2	17
10	M8 Nut	11.1001.2	17
11	Master Power Cord	22.1000.2	1
12	Lock and Key (B)	1.1003.2	1
13	Slide Set	18.1003.2	1

To order replacement parts, email [service@montezumastorage.com](mailto:service@montezumastorage.com) or call 1-800-459-4409 (Monday–Friday, 8:00 am–4:30 pm, CST). Have the part number and quantity ready. Replacement keys may be ordered using the code that appears on the face of the lock. Not all parts are covered under warranty. Those parts not covered can be purchased.

1

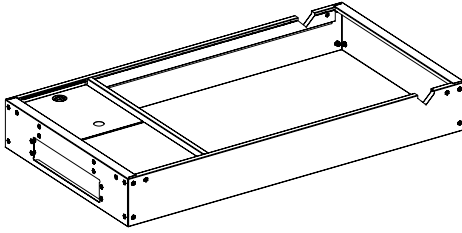

**Top Tray with Privacy Compartment**

1

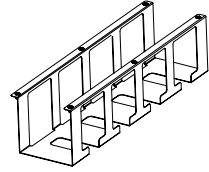

**Power Tool Rack**

1

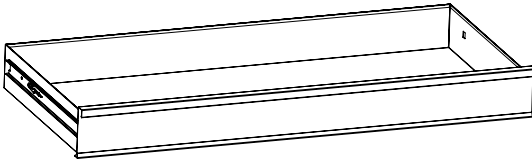

**Full Width Drawer with Inner Drawer Slides**

4

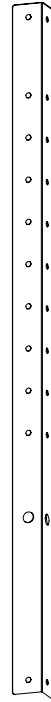

**Frame Post**

1

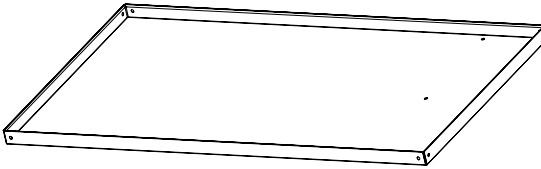

**Adjustable Shelf**

1

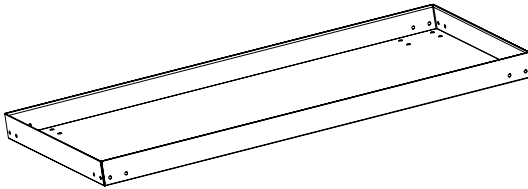

**Bottom Tray**

1

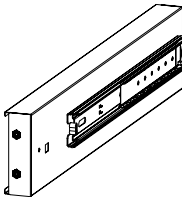

**Left Side Brace with Outer Drawer Slide**

1

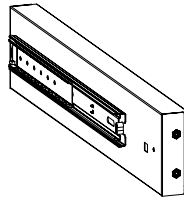

**Left Side Brace with Outer Drawer Slide**

1

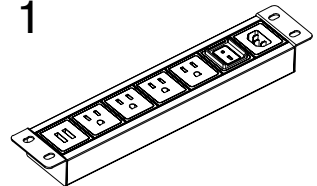

**Power Strip with USB Ports**

2

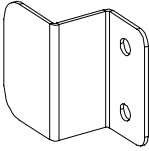

**Cord Wrap Bracket**

1

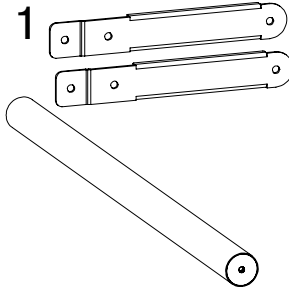

**Handlebar Assembly**

2

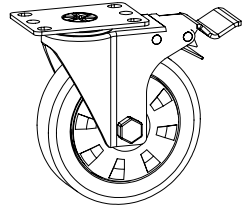

**Swivel Caster with Brake**

2

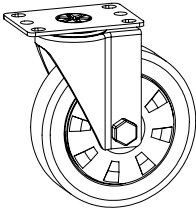

**Swivel Caster**

6

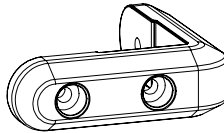

**Bumper**

25

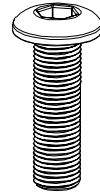

**M6 x 18 mm Bolt**

48

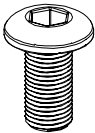

**M6 x 12 mm Bolt**

25



**M6 Nut**

17

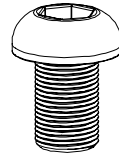

**M8 x 12 mm Bolt**

17



**M8 Nut**

1

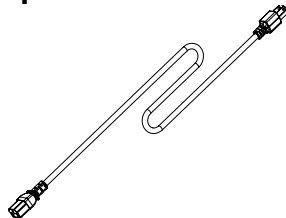

**Master Power Cord**

1



**Lock and Key**

# ASSEMBLY

FULLY ASSEMBLE THE CART PER THE FOLLOWING INSTRUCTIONS. DO NOT ASSUME HOW THE PART SHOULD BE ASSEMBLED. DO NOT LEAVE OFF PARTS.

DO NOT USE POWER TOOLS TO ASSEMBLE THE CART. USE HAND WRENCHES TO TIGHTEN ALL OF THE NUTS AND BOLTS.

## ATTACH THE FRAME POSTS AND BUMPERS TO THE BOTTOM TRAY

NOTE: There is a larger hole in the frame posts – please make sure these holes are oriented downward, towards the bottom tray.

Place the bottom tray, with the edge facing up, on a soft surface to protect the finish.

Place one bumper over the outside of one corner of the bottom tray. Line up all holes. Insert M6 x 18 mm bolts into ONLY the two outside holes on each side of the bumper and through the bottom tray. Loosely secure in place with M6 nuts.

Slide the end of one frame post down into the space between the bottom tray and the bumper. Line up the holes in the frame post with the two inside holes on the bottom tray and bumper. Insert M6 x 18 mm bolts through the inside holes of the bumper, then through the frame post and bottom tray. Secure with M6 nuts. Tighten all bolts and nuts.

Repeat to attach a frame post and bumper on the other three corners of the bottom tray.

Position the bottom tray so it is upright with the frame posts sticking straight up.

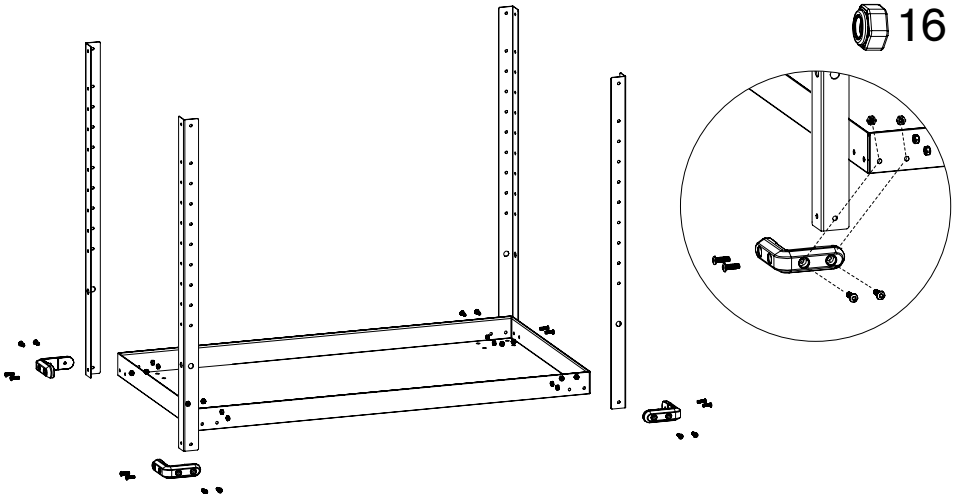



## ATTACH THE RIGHT AND LEFT SIDE BRACES WITH OUTER DRAWER SLIDES

NOTE: Make sure you attach each brace with the drawer slides facing towards the interior of the cart. On each brace, there is a large black stop that will keep the drawer from moving further back and an open slide that the drawer will fit into. Each brace should be attached with the large black stop at the back of the cart and the open slide at the front of the cart.

Position one brace in between the frame posts on one side of the cart. Line up the holes in the brace with the 3rd and 4th holes down from the top of the frame posts. Attach using four M6 x 12 mm bolts (two on each side). Secure the brace to the frame posts with only the bolts – nuts have already been welded in place to secure the bolts in place.

Repeat on the other side to attach the other brace.

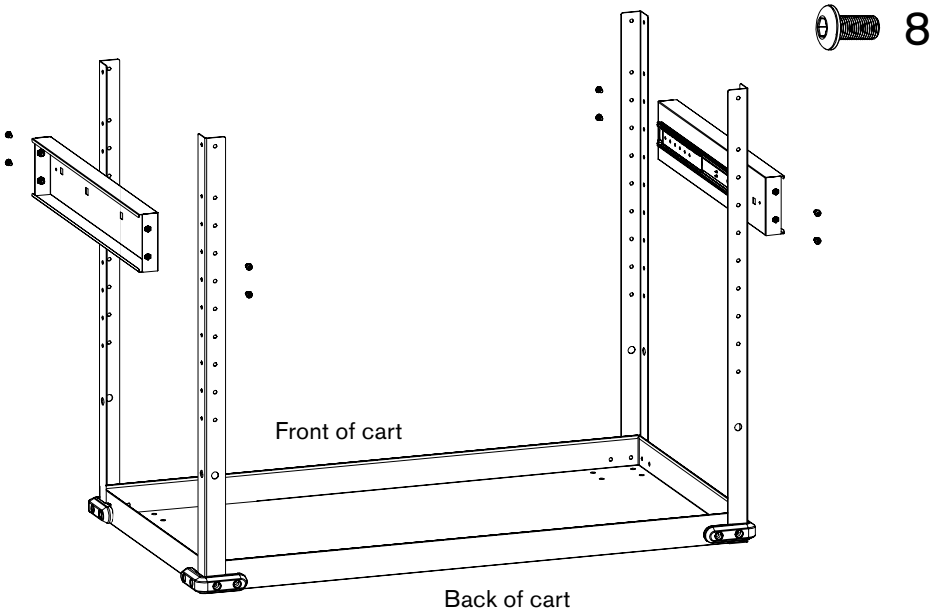

## ASSEMBLE THE TOP TRAY

**NOTE:** Make sure the privacy compartment is locked so it won't accidentally swing open when you turn the cart over.

Place the top tray, with the opening of the tray facing down, on a soft surface to protect the finish. Make note of which side of the top tray is the front. The lock on the privacy compartment is near the front of the tray. The cut out for the power strip is on the right side and the holes for installing the handlebar are on the left side.

Using two people, flip over the bottom tray/frame post assembly and place over the top tray. Make sure that the drawer slides are facing towards the front of the top tray. Line up the top two holes in the frame posts with the holes in the corners of the top tray.

Attach the frame posts to the top tray by inserting a M6 x 12 mm bolt into the second holes from the top of each frame post and into the top tray. There are welded in nuts so you can screw the bolts directly into place.

Also insert two M6 x 12 mm bolts into the top holes on the side with the caution label (which is the side where the handlebar will be installed).

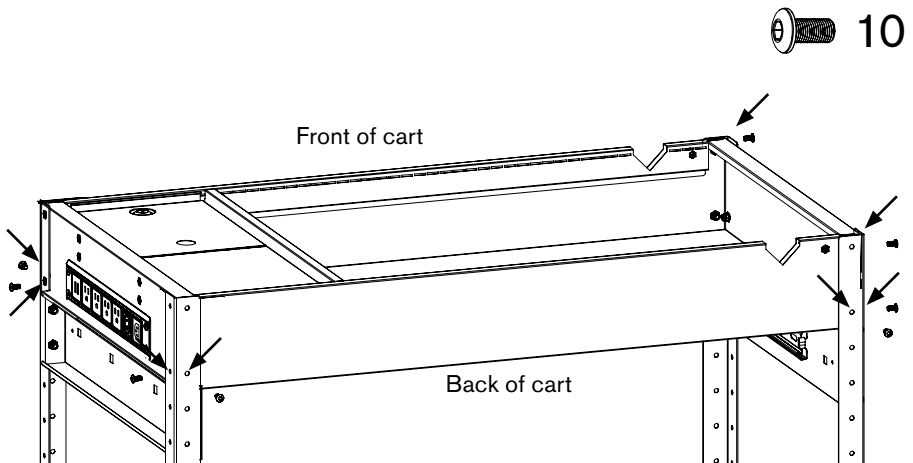

## ATTACH THE HANDLEBAR

Position one handle attachment over the end of handlebar with the smooth side (without the flange) of the handle attachment facing out. Line up the hole in the end of the handlebar with the single hole in one end of the handle attachment. Attach using a M6 x 12 mm bolt. Repeat to attach the second handle attachment to the other end of the handlebar.

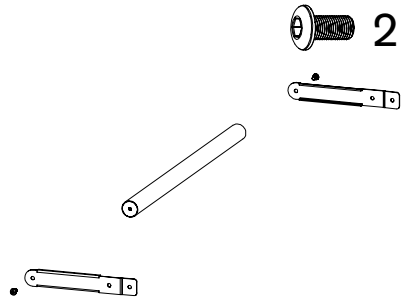

Then position the handle attachments over the top left side of the top tray (on the opposite side of the cart from the cutout for the electrical socket). Line up the two holes in each handle attachment with the top holes in the top tray/frame posts. Insert M6 x 12 mm bolts into the handle attachments, through the top holes of the frame posts and into the top tray. There are welded in nuts so you can screw the bolts directly into place. NOTE: Only two of the bolts will pass through the frame posts. The bolts used for the two outside holes on the handle attachments will pass through the handle attachments and directly into the top tray.

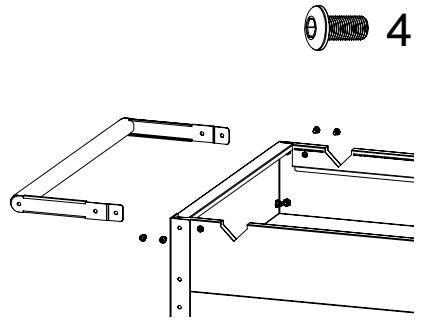

## ATTACH THE BUMBERS TO THE TOP TRAY

On the right side of the cart (on the side with the cutout for the power strip), place a bumper over the top of one frame post. Line up all holes. Insert M6 x 18 mm bolts into the bumper, through the frame post and into the top tray. There are welded in nuts so you can screw the bolts directly into place. NOTE: Only two of the bolts will pass through the frame posts. The bolts used for the two outside holes on the bumper will pass through the bumper and directly into the top tray.

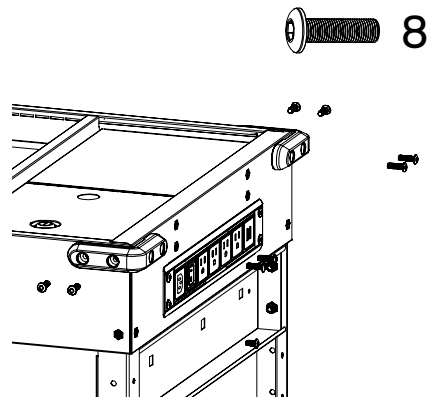

Repeat to attach the last bumper on the other corner.

## ATTACH THE POWER STRIP WITH USB PORTS AND CORD WRAP BRACKETS

**WARNING:** Do not assemble with the power strip plugged into an active electrical socket. Do not stick tools or other parts into the electrical outlets.

Insert the power strip with USB ports into the opening. Attach using four M6 x 12 mm bolts (two on each side of the electrical socket). These bolts will screw directly into nuts that are welded in place.

Place each cord wrap bracket just above the power strip with the flange facing out. Line up the holes in the brackets with the holes located just above the power strip. Secure each bracket with two M6 x 12 mm bolts inserted directly into nuts already welded in place.

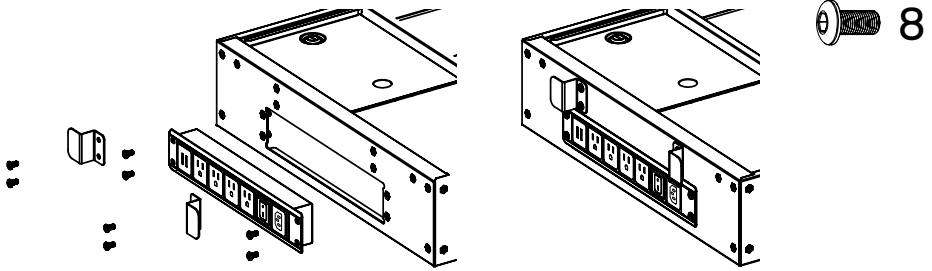

## INSTALL THE CASTERS

Position the four casters on the bottom of the cart. Line up the holes in the casters with the holes in the bottom tray. The two swivel casters with brakes should be positioned on the same side of the cart as the handle.

Insert four M8 x 12 mm bolts through the bottom tray and into each caster. Secure with M8 nuts on the bottom of the casters.

Using two people turn the cart upright.

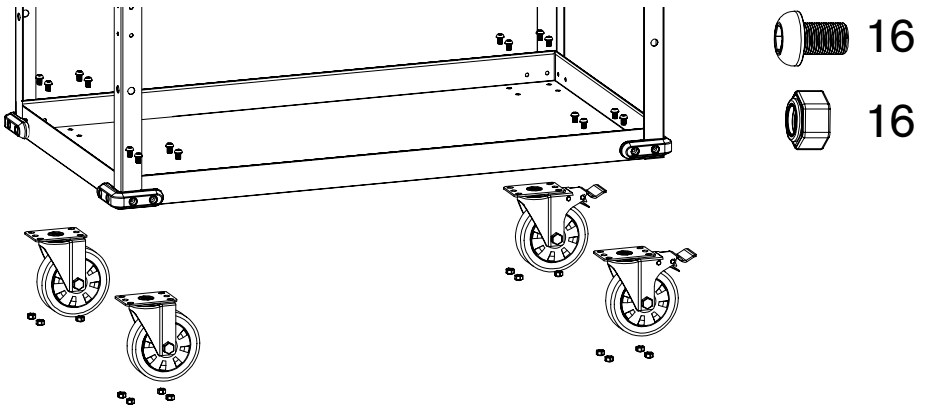

## INSTALL THE POWER TOOL RACK AND ADJUSTABLE SHELF

Using a soft surface to protect the finish, place the adjustable shelf, with the flanges facing up, over the power tool rack. Line up the holes and insert six M6 x 12 mm bolts through the adjustable shelf and into the power tool rack. There are welded in nuts on the power tool rack that the bolts will screw into.

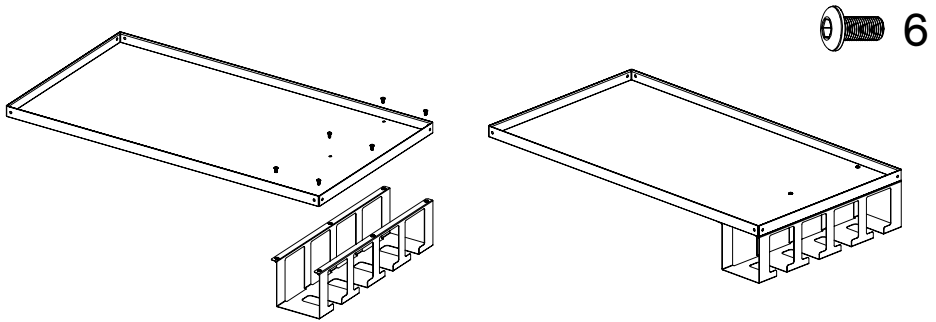

Position the adjustable shelf at the desired level. Line up the holes in the adjustable shelf with the holes in the frame posts. You can use any holes except the extra large holes near the bottom of the frame posts. Insert one M6 x 12 mm into each hole in the frame post and through the holes in the adjustable shelf. Secure with a M6 nut on the inside of the shelf.

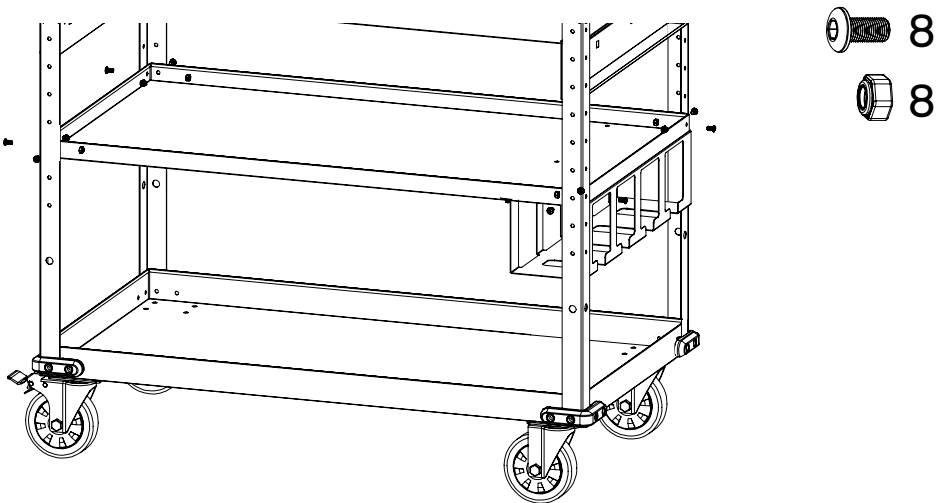

## INSTALL THE DRAWER

Insert the full width drawer by lining up the inner slides on the drawer with the outer sliders on the side braces.

## PLUG IN THE POWER STRIP

To provide power to the power strip, open the cord attachment panel on the front of the power strip next to the on/off switch and attach the master power cord. Plug the master power cord into a grounded power source. Flip the power switch on – it will turn red to let you know that the power strip is active. Store the master power cord in the handy cord wrap located above the power strip when not in use.

## PRIVACY COMPARTMENT

The privacy compartment can be locked for greater security. The lid can also be raised to form an easel that can be used to display a tablet, other electronic device or paperwork. There are several notches that allow you to adjust the angle of the easel. We recommend leaving the lid down in the locked position when the cart is not in use.

## INSTALL A ROD OR DOWL (OPTIONAL)

You can insert a rod or dowel (not included) in the extra large hole in the frame posts to hold spools of wire or other rolls of material. Do not let the wire or other material drag and get caught in the swivel casters.

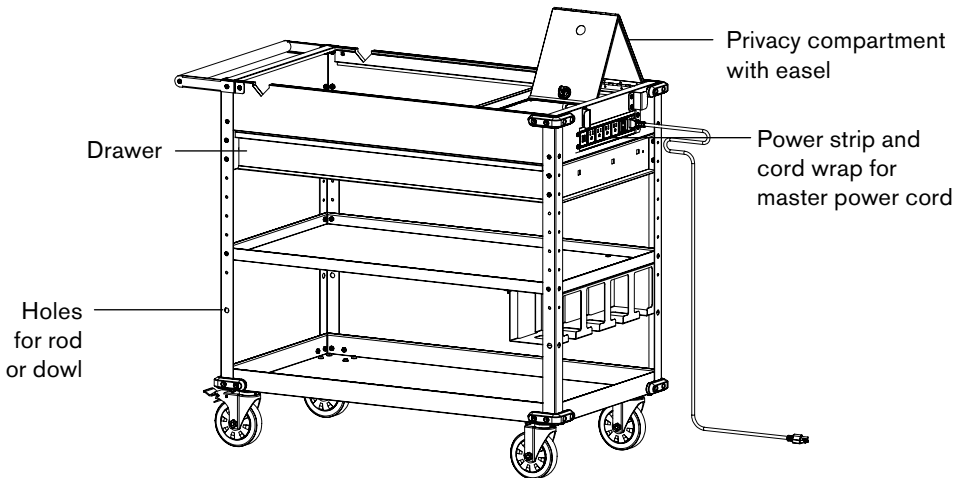



This product is warranted to be free from defects in materials and workmanship for a period of three (3) years from the date of original purchase.

If this product is defective, email [service@montezumastorage.com](mailto:service@montezumastorage.com) or call 1-800-459-4409 (Monday–Friday, 8:00 am–4:30 pm, CST). If the product is defective, we will replace the defective part at no cost to you.

Please do not ship your product back to the store or to us unless we send you written instructions for return.

In the event it becomes necessary for your product to be returned, we will notify you how to proceed.

A copy of your original purchase receipt must accompany the returned product.



**WARNING**

Cancer and Reproductive Harm – [www.P65Warnings.ca.gov](http://www.P65Warnings.ca.gov)



**Montezuma**<sup>®</sup>  
LIFE ORGANIZED

Manufactured by:

**QUALITY CRAFT**

Romeoville, IL, USA 60446

service@montezumastorage.com

1-800-459-4409

(Monday to Friday, 8:00 am–4:30 pm, CST)

Made in China

[www.montezumastorage.com](http://www.montezumastorage.com)

MUC4039B\_12/20