

# DOCK WIRELESS CHARGER

*SET UP GUIDE*

*GUIDE D'INSTALLATION*

*GUÍA DE INSTALACIÓN*

*INSTALLATIONSANLEITUNG*

無線充電座說明書





# WHAT IS INSIDE

CONTENU / LO QUE HAY DENTRO / INHALT / 内容

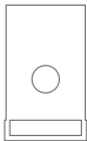
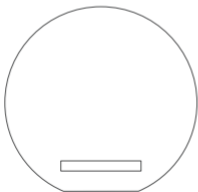
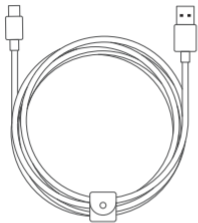

## HOW TO INSTALL

INSTALLATION / CÓMO INSTALAR / INSTALLATION / 安裝方法

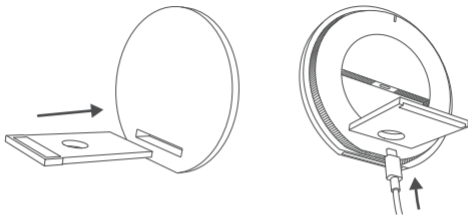

## HOW TO CONNECT

CONNEXION / CÓMO CONECTAR / VERKABELUNG / 連接方法

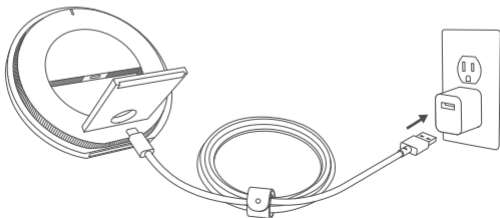

## ALIGNMENT

PLACEZ L'APPAREIL CORRECTEMENT SUR LA BASE SANS  
FIL / ALINEE EL DISPOSITIVO CORRECTAMENTE EN EL  
CARGADOR INALÁMBRICO / KORREKTE AUSRICHTUNG /  
充電擺放位置

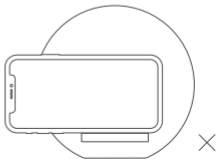
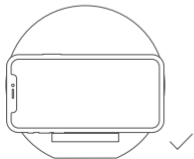
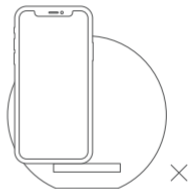
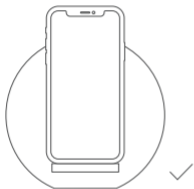

# NOTES

REMARQUES / OBSERVACIONES / BEMERKUNGEN / 注意

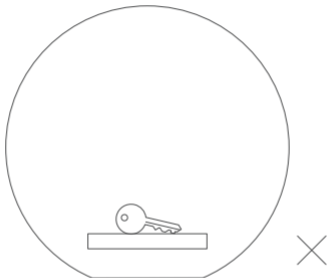

## LED INDICATION



### **White light**

Charging



### **Red light flashing**

Foreign object detected

e.g. metallic object

## SPECIFICATION

Input: DC5V, 2.0A; DC9V, 1.67A; DC12V, 1.5A

Frequency: 127.7 kHz

Output Power: 5W/7.5W/10W

Charging distance:  $\leq 2$ mm

Operating Temperature (°C): 0°C – 35°C

## SAFETY INFORMATION

1. This product is intended for home & office use
2. For indoor use only
3. Consult local staff before using the product near medical or industrial equipment or on board an aircraft
4. Prevent cables from being pinched or damaged
5. A damaged cable or device may malfunction and/or overheat (Fire Hazard)
6. Unplug the product if not used for an extended period of time



# REGULATORY INFORMATION



FCC responsible party: Design Pool LLC (dba Native Union)  
C/O Armanino LLP, 11766 Wilshire Blvd Fl 9, Los Angeles, CA 90025-1586  
Telephone +1 (855) 969 5525 Email: support@nativeunion.com

## FCC STATEMENT (USA)

This device complies with Part 18 of the FCC Rules

**WARNING:** Changes or modifications to this unit not expressly approved by the party responsible for compliance could void the user's authority to operate the equipment.

**NOTE:** This equipment has been tested and found to comply with the limits for a Class B ISM equipment, pursuant to Part 18 of the FCC Rules. These limits are designed to provide reasonable protection against harmful interference in a residential installation. This equipment generates, uses, and can radiate radio frequency energy and, if not installed and used in accordance with the instructions, may cause harmful interference to radio communications. However, there is no guarantee that interference will not occur in a particular installation. If this equipment does cause harmful interference to radio or television reception, which can be determined by turning the equipment off and on, the user is encouraged to try to correct the interference by one or more of the following measures:

- Reorient or relocate the receiving antenna.
- Increase the separation between the equipment and receiver.
- Connect the equipment into an outlet on a circuit different from that to which the receiver is connected.
- Consult the dealer or an experienced radio / TV technician for help.

The user is cautioned that changes and modifications made to the equipment without the approval of manufacturer could void the user's authority to operate this equipment.

### **RSS STATEMENT (CANADA)**

This device contains licence-exempt transmitter(s)/receiver(s) that comply with Innovation, Science and Economic Development Canada's licence-exempt RSS(s). Operation is subject to the following two conditions:

- (1) This device may not cause interference.
- (2) This device must accept any interference, including interference that may cause undesired operation of the device.

Caution: To maintain the compliance with the RF exposure guideline, place the unit at least 10 cm from nearby persons.



## TÉMOIN LUMINEUX LED



### Lumière blanche

Chargement en cours



### Lumière rouge clignotante

Corps étranger détecté  
(ex. : objet métallique)

## CARACTÉRISTIQUES

Entrée : CC 5 V, 2.0 A; CC 9 V, 1.67 A;  
CC 12 V, 1.5 A

Fréquence : 127.7KHz

Puissance de sortie: 5W/7.5W/10W

Distance de chargement :  $\leq 2$ mm

Température de fonctionnement (°C) :  
0 °C - 35 °C

## INFORMATIONS DE SÉCURITÉ

1. Ce produit est destiné à un usage domestique et de bureau
2. Exclusivement pour un usage en intérieur
3. Renseignez-vous auprès du personnel adéquat avant d'utiliser le produit à proximité d'équipements médicaux ou industriels, ou à bord d'un avion
4. Évitez que les câbles ne soient pincés ou endommagés
5. Un câble ou un appareil endommagé peut ne pas fonctionner correctement et/ou surchauffer (Risque d'incendie)
6. Débranchez le produit si vous ne l'utilisez pas pendant une période prolongée

# INFORMATIONS RÉGLEMENTAIRES

## DÉCLARATION DE CONFORMITÉ AVEC LE CNR

Cet appareil contient un ou des transmetteurs/récepteurs pouvant être utilisés sans licence qui sont conformes au Cahier des charges sur les normes radioélectriques (CNR) pour les appareils utilisables sans licence d'Innovation, Sciences et Développement économique Canada. L'utilisation de ce produit est soumise aux deux conditions suivantes :

- (1) Cet appareil ne doit pas entraîner d'interférences.
- (2) Cet appareil doit accepter toute interférence reçue, y compris les interférences pouvant causer un fonctionnement non souhaité de l'appareil.

\*Avertissement : Pour assurer la conformité avec les directives relatives à l'exposition aux radiofréquences, gardez l'appareil à au moins 10 cm des personnes à proximité.



# INDICADOR DE LED LAS ESPECIFICACIONES



## **La luz blanca**

Cargando

La entrada: DC5V, 2.0A; DC9V, 1.67A;

DC12V, 1.5A

Frecuencia: 127.7KHz

Energía: 5W/7.5W/10W

Distancia de carga:  $\leq 2$ mm

Temperatura de funcionamiento (°C):

0°C – 35°C



## **la luz roja intermitente**

Un objeto extraño detectado

e.g. un objeto metálico

## MEDIDAS DE SEGURIDAD

1. Este producto ha sido concebido únicamente para hogares y oficinas.
2. Solo para uso en interiores.
3. Consulte con el personal local antes de usar el producto cerca de equipos médicos o industriales, o en un avión.
4. Procure evitar los daños o el aprisionamiento de los cables.
5. Un cable o dispositivo dañados pueden funcionar mal y/o sobrecalentarse.
6. Desenchufe el producto si no va a ser utilizado por un largo periodo de tiempo.

## LED ANZEIGE



### LED weiß

Lädt



### LED blinkt rot

Fremdkörper erkannt

z.B. Metall

## SPEZIFIKATION

Zufuhr: DC5V, 2.0A; DC9V, 1.67A; DC12V, 1.5A

Frequenz: 127 kHz.

Power Profile: 5W/7.5W/10W

Ladedistanz:  $\leq 2$ mm

Betriebstemperatur (°C): 0°C – 35°C

## SICHERHEITSHINWEISE

1. Dieses Produkt ist zur Heim- und Büroanwendung gedacht
2. Nur zur Verwendung in Innenräumen
3. Kontaktieren sie Verantwortliche vor Ort bevor sie das Gerät in der Nähe von medizintechnischen oder industriellen Geräten oder im Flugzeug benutzen
4. Verhindern sie Beschädigung/Einklemmung des Kabels
5. Ein beschädigtes Kabel oder Gerät kann zu Fehlfunktionen und/oder Überhitzung führen (Brandgefahr)
6. Nehmen sie das Gerät vom Netz wenn es längere Zeit nicht benutzt wird.

## LED 燈光指示



白燈  
充電中



紅燈閃爍  
檢測到異物 e.g.金屬

## 規格

輸入: DC5V, 2.0A; DC9V, 1.67A; DC12V, 1.5A

頻率: 127.7KHz

輸出功率: 5W/7.5W/10W

充電距離:  $\leq 2\text{mm}$

溫度 (°C): 0°C – 35°C

\*本產品不配帶電源供應器，  
請使用符合台灣認證的電源作使用

## 安全資訊

1. 產品供居家及辦公室使用。
2. 只限室內使用。
3. 在醫療或工業設備附近或在飛機上使用本產品前，請諮詢當地的工作人員。
4. 請避免線纜遭到夾緊或損壞。
5. 損壞的線纜或裝置可能會發生故障和／或過熱。(火災危險)
6. 若長時間不使用，請拔除產品的電源插頭。

設備名稱 Equipment name : Dock Wireless Charger						
型號(型式) Type designation (Type) : DOCKW02 / DOCKWLT02						
單元 Unit	限用物質及其化學符號 Restricted substances and its chemical symbols					
	鉛 Lead (Pb)	汞 Mercury (Hg)	鎘 Cadmium (Cd)	六價鉻 Hexavalent chromium (Cr+6)	多溴聯苯 Polybrominated biphenyls (PBB)	多溴二苯醚 Polybrominated diphenyl ethers (PBDE)
皮革	○	○	○	○	○	○
帆布	○	○	○	○	○	○
塑膠上蓋	○	○	○	○	○	○
金屬下蓋	○	○	○	○	○	○
PCBA電路板	—	○	○	○	○	○

備考1. “超出0.1 wt %”及“超出0.01 wt %”係指限用物質之百分比含量超出百分比含量基準值。

Note 1. “Exceeding 0.1 wt %” and “exceeding 0.01 wt %” indicate that the percentage content of the restricted substance exceeds the reference percentage value of presence condition.

備考2. “○”係指該項限用物質之百分比含量未超出百分比含量基準值。

Note 2. “○” indicates that the percentage content of the restricted substance does not exceed the percentage of reference value of presence.

備考3. “—”係指該項限用物質為排除項目。

Note 3. The “—” indicates that the restricted substance corresponds to the exemption.



## 中国

有害物质 Restricted substances and its chemical symbols	零部件					
	电路板	附件	金属	塑料	布料	皮料
铅 (Pb)	○	○	○	○	○	○
汞 (Hg)	○	○	○	○	○	○
镉 Cadmium (Cd)	○	○	○	○	○	○
六价铬 (Cr, VI)	○	○	○	○	○	○
多溴联苯 (PBB)	○	○	○	○	○	○
多溴二联苯醚 (PBDE)	○	○	○	○	○	○

- 表示该有毒有害物质在该部件所有均质材料中的含量在 GB/T 26572-2011规定的限量要求以下。



### 只適用於台灣

根據NCC低功率電波輻射性電機管理辦法規定：

第十二條：經型式認證合格之低功率射頻電機，非經許可，公司、商號或使用者均不得擅自變更頻率、加大功率或變更原設計之特性及功能。

第十四條：低功率射頻電機之使用不得影響飛船安全及干擾合法通信；經發現有干擾現象時，應立即停用，並改善至無干擾時方得繼續使用。

前項合法通信，指依電信法規定作業之無線電通信。低功率射頻電機需忍受合法通信或工業、科學及醫療用電波輻射性電機設備之干擾。

## EU Declaration of Conformity

Hereby, Design Pool Limited declares that the product(s) DOCKW02, DOCKWLT02 is in compliance with directive 2014/53/EU. The full text of the EU DoC is available online: [nativeunion.com/product-compliance](http://nativeunion.com/product-compliance)

Manufacturer: Design Pool Limited. 2/F East Town Building, 41 Lockhart Road, Wan Chai, Hong Kong - [support@nativeunion.com](mailto:support@nativeunion.com)

EU Importer: Design Pool SAS, c/o The Bureau, 28 Cours Albert 1er, 75008 Paris, France

More information | Plus d'informations | Mehr Infos | Más información | Mais Informações  
| Maggiori informazioni | 更多信息 | 詳しくは | 추가 정보 | Дополнительная информация |  
رڤكك تاڤولڤع | Daha fazla bilgi | περισσότερες πληροφορίες | Více informací | Meer  
informatie | Lisää tietoa | Több információ | Mer informasjon | Więcej informacji | Mer  
information | ข้อมูลมากกว่านี้ | Thêm thông tin | अधिकि जानकारी |



[nativeunion.com/product-documentation](https://nativeunion.com/product-documentation)

[nativeunion.com/support](https://nativeunion.com/support)

© 2020 NATIVE UNION all rights reserved. NATIVE UNION is a registered trademark of Design Pool Limited. Trademarks and trade names are those of their respective owners. Copyright Design Pool Limited. 2/F, East Town Building, 41 Lockhart Road, Wan Chai, Hong Kong. Made in China. © 2020 NATIVE UNION. NATIVE UNION est une marque déposée de Design Pool Limited. Les marques et noms commerciaux sont ceux de leurs propriétaires respectifs. Fabriqué en Chine. © 2020 NATIVE UNION. NATIVE UNION es una marca registrada de Design Pool Limited. Hecho en China. © 2020 NATIVE UNION alle Rechte vorbehalten. NATIVE UNION ist eine eingetragene Marke von Design Pool Limited. Marken und Handelsnamen sind Eigentum ihrer jeweiligen Inhaber. In China hergestellt.

