

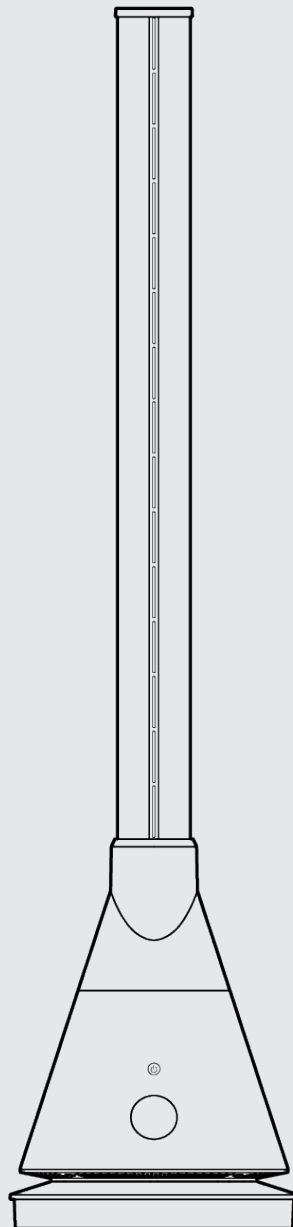

## **Multi -3-IN-1**

Heater | Cooling Fan | Air Steriliser

VS001-W (white) | VS001-B (black)



Before using the unit, please read these instructions and keep them for future reference

Vybra Solutions Ltd, 5 Kingsway, Andover, UK  
sales@vybrasolutions.co.uk +44(0) 330 100 5206

# 1. Important Safety Information

## WARNING

When using electrical appliances, basic precautions should always be followed to reduce the risk of fire, electrical shock and injury.

1. This appliance is suitable for indoor use only and should not be used outdoors.
2. The appliance must not be repaired or modified by laypersons or unauthorised repair personnel.
3. Before connecting the power supply unit, verify that the rated voltage matches the voltage in your home.
4. Keep the appliance at least 1.5 metres away from any fire sources and do not expose to direct sunlight.
5. The appliance must not be used near objects that are flammable or explosive or sensitive to heat, deformation, discolouration or deterioration.
6. Do not use the appliance in places with a high amount of dust.
7. Never switch the appliance on or off by connecting or unplugging the power plug instead of using the on/off switch.
8. To avoid overheating, do not cover the heater.
9. To avoid the risk of electric shock, never insert any wires or other foreign objects into the openings of the appliance.
10. Ensure the power outlet is behind the fan when the appliance is in use.
11. Do not connect any further high-power appliances to the same socket.
12. Do not use the appliance in the vicinity of bathtubs, shower heads or swimming pools.
13. There is a risk of fire when the appliance is covered or wrongly positioned.
14. Do not use any programmers or timers which will start the appliance automatically.
15. If the appliance fails, immediately turn off the power and unplug the power cord.

## 2. Product Description

Equipped with PTC heating elements, this product generates heat through hot air which heats the room.

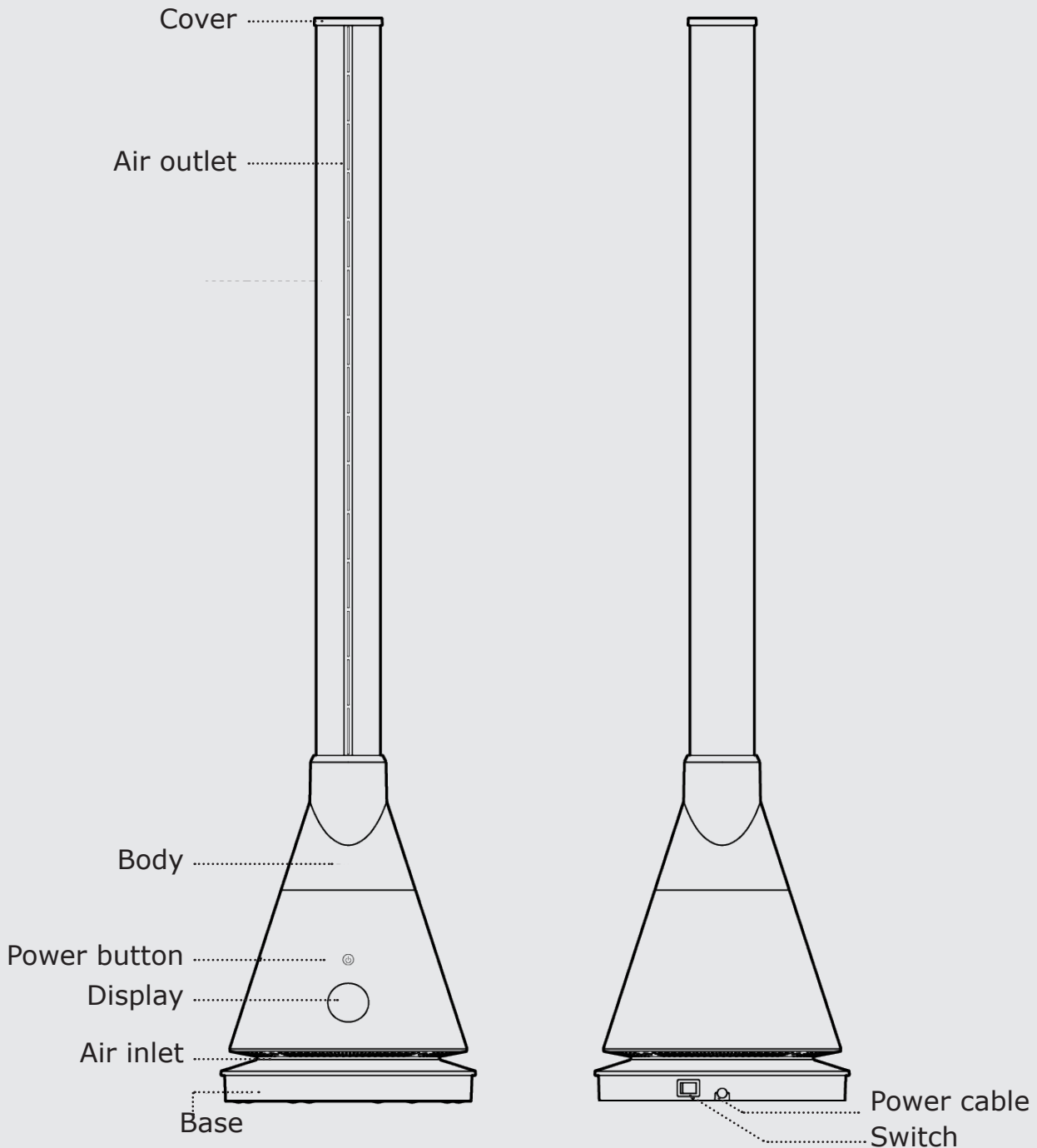

### Basic information

Model no:	VS001-W (White) VS001-B (Black)		
Rated voltage:	220-240V~		
Rated frequency:	50-60Hz	Output power:	2000W (H) /30W (C)
Oscillating Angle:	80°	Timer:	1-8h

### 3. Remote Control

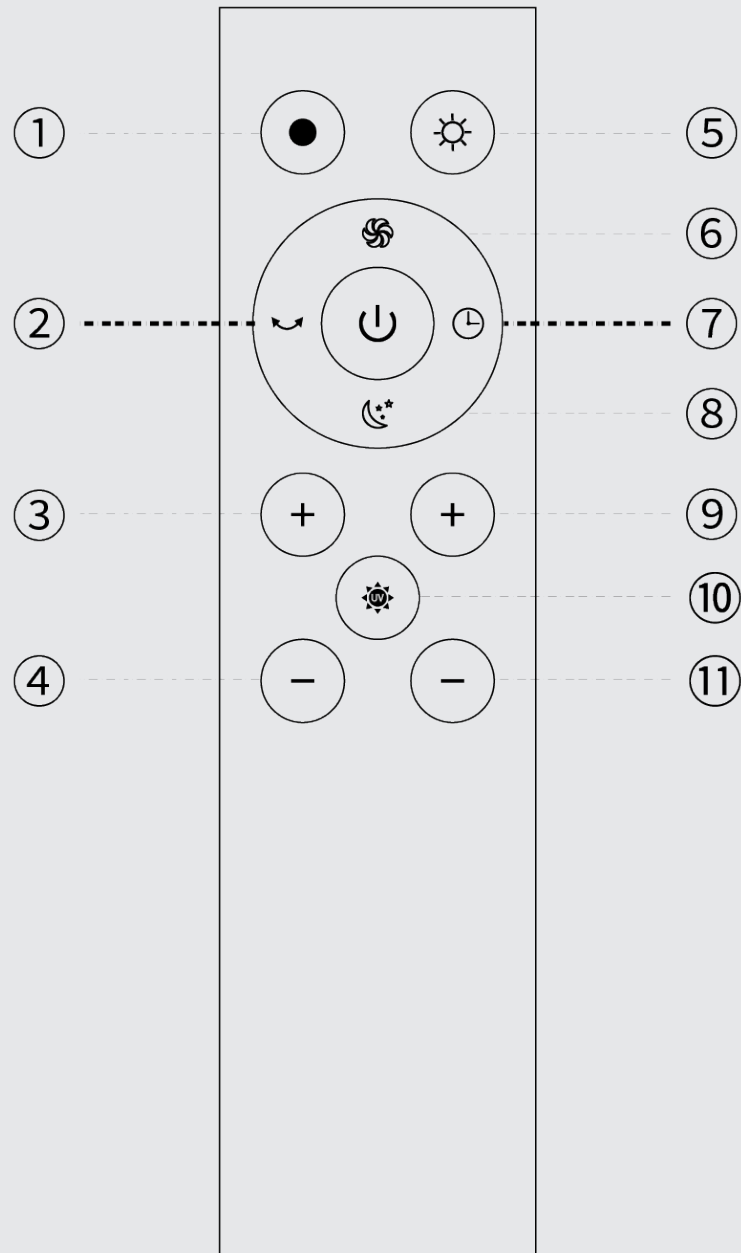

- |                        |                         |
|------------------------|-------------------------|
| 1. Cooling mode        | 7. Timer                |
| 2. Oscillation mode    | 8. Sleep mode           |
| 3. Increases air speed | 9. Increase temperature |
| 4. Reduces air speed   | 10. UV sterilisation    |
| 5. Heating mode        | 11. Reduces temperature |
| 6. Turbo mode          |                         |

**NOTE:**

When the remote is operated, the main buzzer will make a "beep" sound.



The appliance can be switched on and off by pressing the "ON/OFF" button

---



Press the sleep mode button on the remote control  
The display reads "L" and the air speed is minimised  
Press the button again to exit the sleep mode  
(You can also exit the current mode by pressing the "air speed +" button)

---



Press the turbo mode button on the remote control  
The display reads "H" and the air speed is maximised  
Press the button again to exit the turbo mode  
(You can also exit the current mode by pressing the "air speed +" button)

---



Press the oscillation button to activate the oscillation mode  
The fan can swivel to the left and right by 80°  
Press the button again to stop the oscillation mode

---



Press this button to turn on the germicidal UV lamp  
The display reads "U"  
The UV lamp will be turned off after one hour of operation  
Press the button again to turn off the germicidal UV lamp

---



In cooling mode, the LED lights up blue  
Press this button to activate the cooling mode  
Note: The cooling mode is the appliance's default mode

---



To increase or decrease the air speed, press the "+" or "-" button on the left side of the remote control  
The cooling mode offers 9 different speed options.  
The heating mode offers 4 different speed settings

---



In heat mode, the numbers are displayed in red  
Press this button to activate the heating mode  
**Note:** In heating mode, there are no turbo or sleep features available

---



Press the temperature button on the right side of the remote control to set the temperature when the appliance is in heating mode (1-30°C)  
**Note:** This button does not work in cooling mode.

---



Press the timer button on the remote control to set the timer between 1 and 8 hours.

## 4. How to Use the Remote Control

For the best signal, point the remote control at the unit.

Effective distance is 5 m

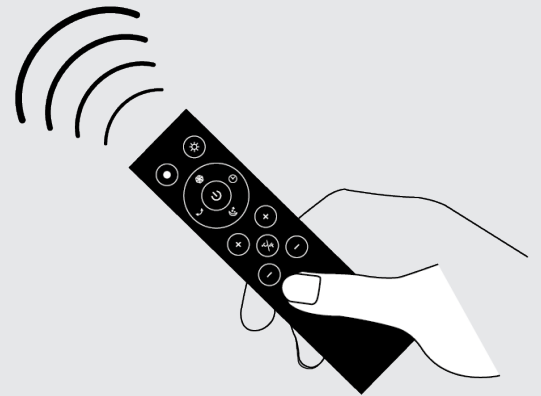
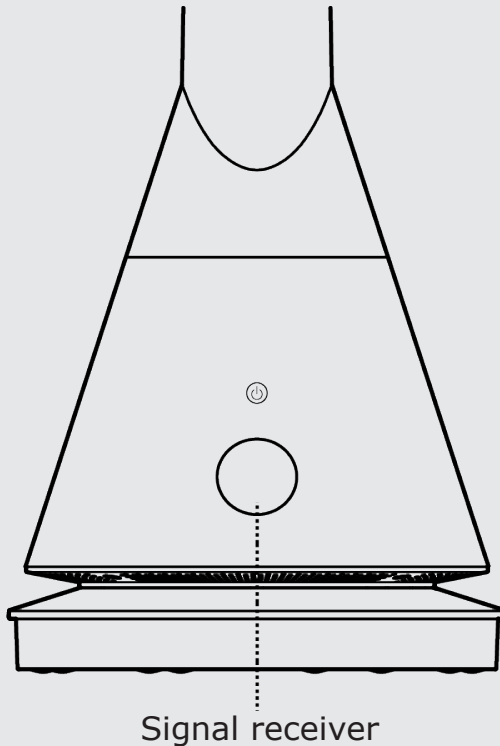

### **Warning:**

1. When appliances are controlled remotely, frequency overlapping may occur.
2. The unit may react when using remote controls operating other appliances.
3. When using the remote control of this bladeless heater, other electrical appliances may also react

When pressing the on/off button on the remote control, the appliance is not turned off completely, but switched into standby mode only.

If you are not using the unit, switch it off using the power switch.

If the appliance is not to be used for a longer period of time, unplug the unit.

## 5. Instruction for using the heating mode

Press the heating mode button.

The ambient temperature will be shown on the display.

Press the temperature button to set the desired temperature. The display flashes and allows the temperature to be set between 1 and 30°C.

For the heating function to be activated, the set temperature should be higher than the ambient temperature.

Once the ambient temperature has reached the set temperature, the hot airflow will stop and turn into a cool breeze.

If the ambient temperature is lower than the set temperature, the heating function will be switched on automatically.

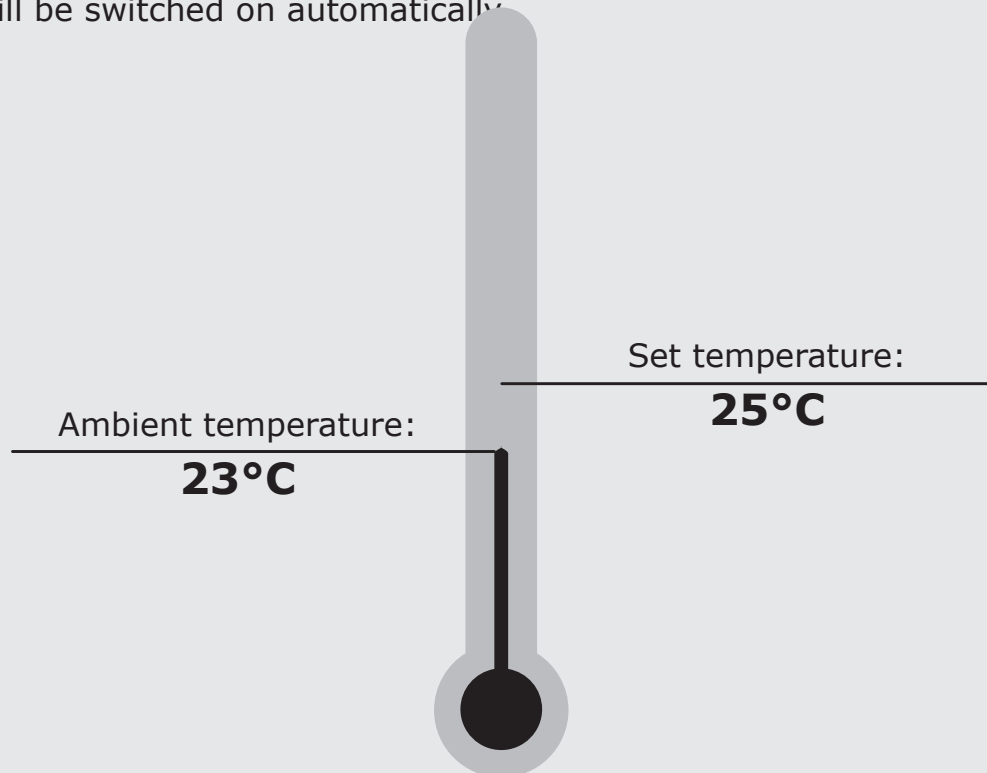

Set temperature > ambient temperature: heating function enabled.

Set temperature ≤ ambient temperature: heating function disabled.

**Note:** The default temperature setting is 25 °C.

If the ambient temperature is below 0 °C in heating mode, the display reads 01.

It cannot display negative temperature values.

If the appliance has been running in heating mode for more than 9 hours, it will be switched off automatically.

Use the switch on the appliance or the remote control to restart the appliance.

### **Heating mode:**

Use the remote control to set the temperature.

The temperature cannot be set directly at the appliance.

## 6. Unit

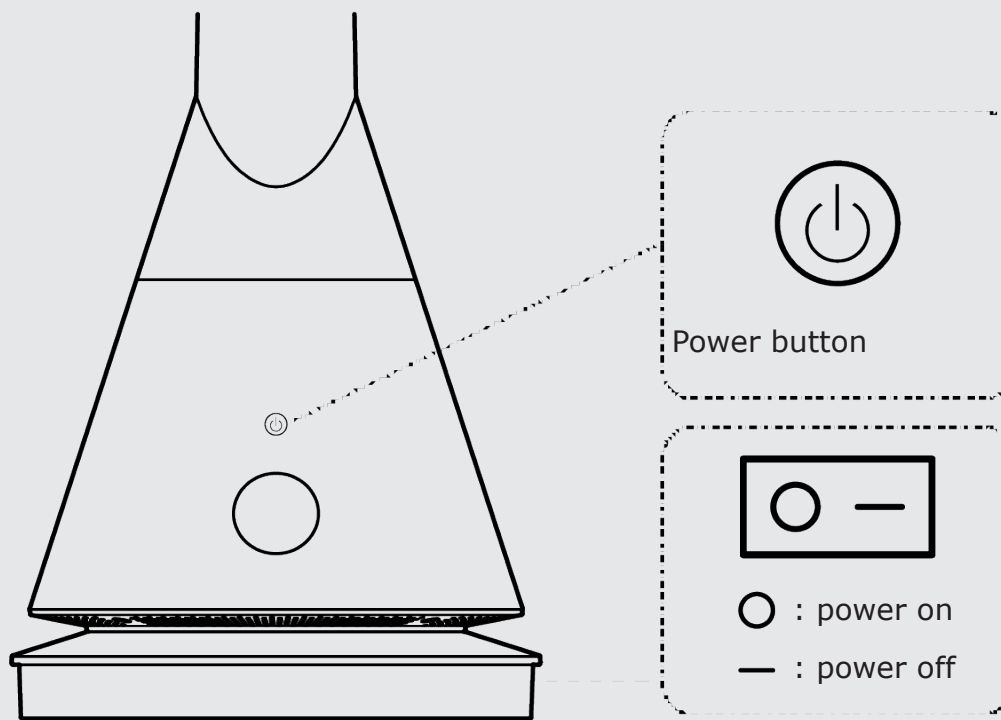

Insert the plug into the socket then press the power on/off switch to start the unit - this puts it into standby mode.

Press the power button of the unit.

The buzzer will prompt you to click and the fan will start running.

Press and hold the power button for 2 seconds.

The buzzer will prompt you twice and stop running when you release the button.

### **Adjusting air speed**

When the appliance is running, press the main power button to adjust the air speed.

You can choose from 9 different settings.

### **Oscillation mode**

Press and hold the power button for 1 second.

The buzzer will beep once and the fan will start oscillating.

Press and hold the power button for 1 second again.

The buzzer will beep once and the fan will stop oscillating.



## 7. Installation Location and Precautions

### Location

Place the appliance in a horizontal position. Do not use the appliance in high-temperature and high-humidity environments (bathroom, kitchen).

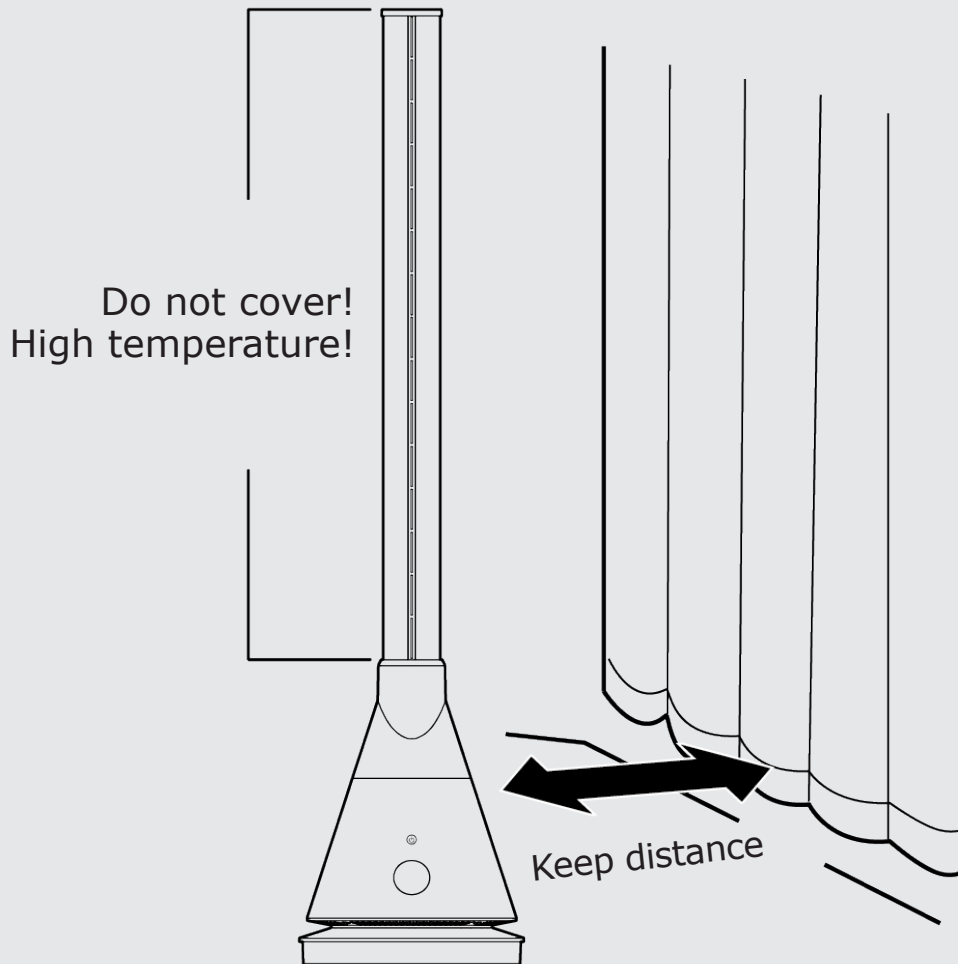

Do not place objects within 1metre

### **Safety system:**

Equipped with an overheat protection sensor and automatic failover, this unit will switch off automatically if it falls over or overheats.

If the sensor is triggered, unplug the appliance and allow it to cool down.

## 8. Remote control and Troubleshooting

How to insert the batteries:

1. Open the battery cover of the remote control
2. Insert two new AAA batteries
3. Close the battery cover of the remote control

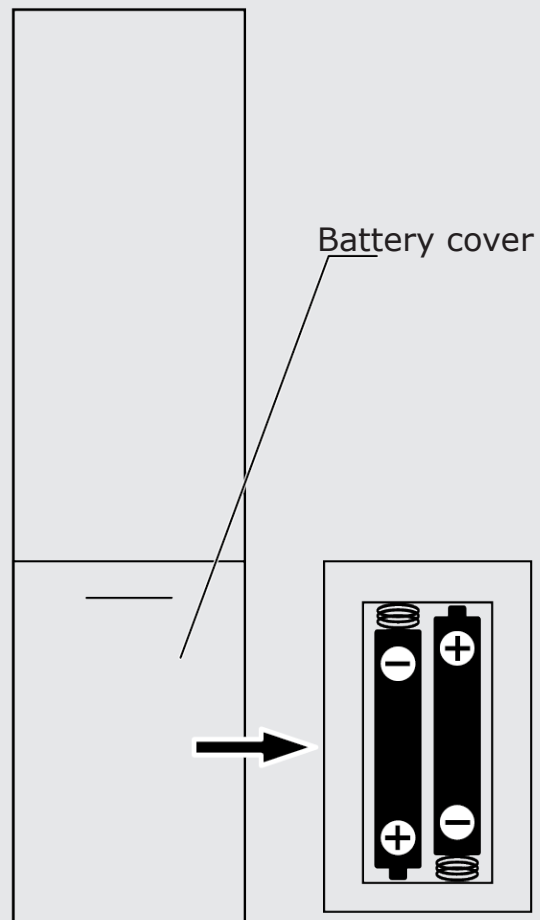

Check batteries have been inserted correctly.

### Troubleshooting

The appliance does not work

- check the unit is plugged in to the power socket
- check the unit is switched ON at the ON/OFF switch on the base of the unit

The remote control does not work

- are the batteries dead?
- have the batteries been correctly inserted?
- is the remote control aligned with the signal receiver?

If none of the aforementioned methods work, contact the customer service - [sales@vybrasolutions.co.uk](mailto:sales@vybrasolutions.co.uk) +44(0)330 100 5206  
Do not disassemble or repair the appliance yourself.

## 9. Maintenance and Care

Unplug the power supply before performing any maintenance or cleaning work

**The appliance must NOT be placed in water, or covered in water. Keep away from water.**

**Do not use petrol, alcohol, bleach or any metal objects to wipe the surface of the appliance, as these substances/objects might cause discolouration of the surface.**

### How to clean the surface

Wipe the surface with a soft, dry cloth.

If the surface is extremely dirty, wipe it with a soft cloth soaked in a mild detergent diluted with water.

Use a soft and dry cloth to wipe the surface dry.

### Air inlet/outlet

Use a soft brush or a vacuum cleaner to remove the dust from the air inlet and outlet. Make sure you clean the appliance when there is a small amount of dust. Too much dust is not healthy and will reduce the fan's efficiency.

### Remote control

Use a soft, dry cloth to gently wipe the surface of the remote control.

If the remote is not to be used for a longer period of time, remove the batteries to prolong their life.

### Storage

If the appliance is not to be used for a long period of time, it can be placed into a plastic bag for storage.

Do not keep the appliance in places which are subject to vibration (car boots) and do not store it close to any electrical appliances with cooling/heating functions.

Do not expose the appliance to direct sunlight and do not use it in high-temperature and high-humidity environments.

**Keep the appliance out of reach of young children.**

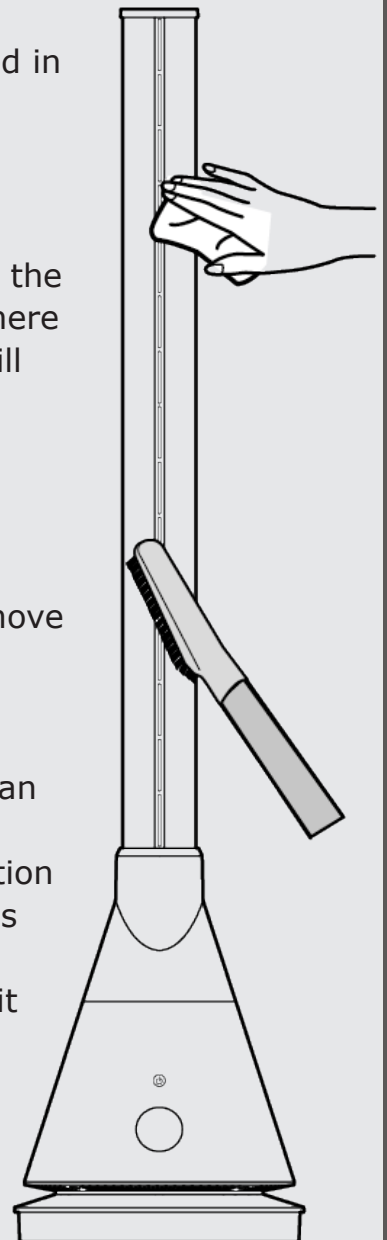

## 10 How to Connect the Appliance with the App

1. Your phone must be connected to a Wi-Fi network.
2. Download the "TUYA smart" or "SMART life" app or scan one of the following QR codes:



TUYA smart



SMART life

3. When you use the app for the first time, you have to create an account.
4. Press and hold the LED display for 5 seconds until it beeps 3 times.  
When "F" appears and blinks, press "confirm" to continue. Select your Wi-Fi network and enter your password. Press "confirm" to continue.
5. Sign in to the app and click "+" or "add device" in the upper right corner. Click "all devices" on the right side and select the fan.
6. The app will automatically pair to the appliance. Once the appliance has been found, you will be notified. You can now rename your appliance. Press "done" to finish the process.

# 11 A guide to 2.4GHz and 5GHz networks

If you own a “dual band” router (identified on the sticker on the back), you will have the option of using two bands throughout your home: 2.4GHz and 5GHz.

## What’s the difference between 2.4GHz and 5GHz?

Each WiFi enabled device in your home can connect to one of the 2.4GHz or 5GHz bands at one time. The 2.4GHz network is slightly slower, but can cover a large area, as the signal is more effective at penetrating thick walls. The 5GHz network is faster but has a shorter range, offering a better connection for devices within close proximity. It’s worth noting some connected devices, such as older smart phones, are not compatible with 5GHz networks.

## How do I find out which band I’m using by default?

Most dual band routers will be set up with two separate WiFi networks by default. Often the 5GHz network will often have “5G” or “AC” at the end of its name. If this isn’t the case, either the router may be selecting the band automatically, or the router or device may not support 5GHz. (Note: 5GHz WiFi is not to be confused with 5G wireless mobile networks).

Some routers will automatically do a quick scan to determine which channels have the least interference and choose the best option for your device. In other cases, your device will connect to its preferred network, which could be the one you most recently connected to, or the one you have manually selected the most often.

To see which band you’re connected to, open the WiFi preferences on your device. Whether you’re using a phone, tablet, computer, TV or another connected device, you should be able to see two WiFi network options in the settings. From there you can select which one you’d prefer to use.

## How do I switch between 2.4GHz and 5GHz on my device?

### Windows

- Click on the WiFi icon in the bottom right corner of the task bar.
- Then click on the network you want to use from the list of available networks.
- Click Connect (type in the password and click Next if it’s your first time connecting to this network).

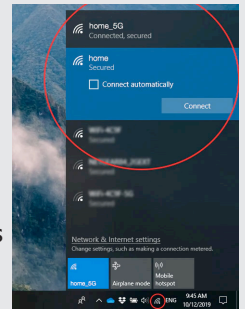

### Apple Mac

- Click on the WiFi icon in the top menu bar
- Then select the network you want to use from list of available networks.
- If applicable: type in the password when prompted and click Join.



### Apple IOS

- On most iOS devices you can tap Settings > WiFi.
- Then select the network you want to use from the list of available networks
- If applicable: type in the password and click Join.

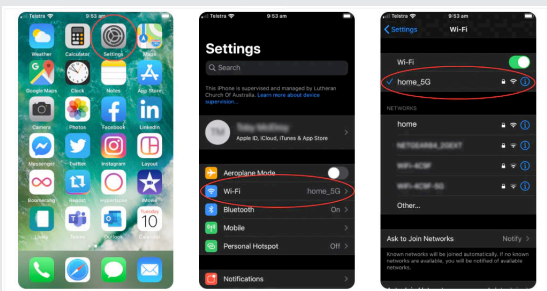

### Android

- On most Android devices you can tap Settings > Connections > WiFi.
- Then select the network you want to use from the list of available networks.
- If applicable: type in the password, then click Connect.

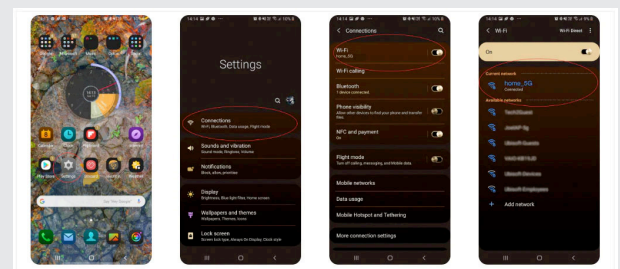

## How do I adjust the settings on my router?

Every router has an IP address (e.g. 192.168.1.1) displayed somewhere on the device. Type that into a web browser while you’re connected to your WiFi network. You’ll reach a login page – use the default login details (written near the IP address on the device) to proceed. Once logged in you’ll see a configuration page where you can edit network preferences, as needed.