

# Blackcard<sup>TM</sup>

2019 – Android User Manual



## TABLE OF CONTENTS:

Download the App	3
Quick Tips	4
Setting up the App	7
Claiming your BlackCard	8
Using the BlackCard	9
BlackCard Settings	10
Voice Assistants	11
Crowd GPS & Left Behind Features	12
Re-enabling Permissions	13
FCC Caution	15
Declaration of Conformity	16
NCC Caution	17

# Download the App

The Pebblebee Finder app can be downloaded by searching for the Pebblebee Finder app in the Google Play Store or by visiting [pebblebee.com/download](http://pebblebee.com/download).

- 1 Please make sure your mobile device has Bluetooth ON.
- 2 Once downloaded, please allow all permissions for full operation. See Quick Tips on following steps for more information.



[pebblebee.com](http://pebblebee.com)

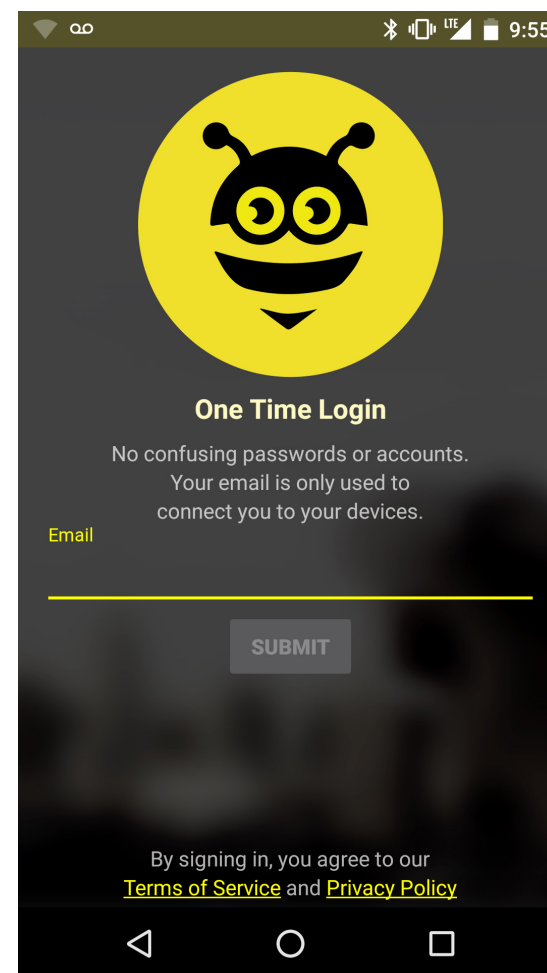

## Quick Tips

### 1 **KEEP BLUETOOTH® ON**

The BlackCard communicates with your phone via your Bluetooth® connection. Keep Bluetooth® ON so that your Pebblebee and phone are always connected.



### 2 **LOCATION SERVICES ON**

Always keep track of your devices by enabling and keeping Location Services ON. Make sure to 'Always Allow', this will allow you to locate and see the device's last known location on a map.

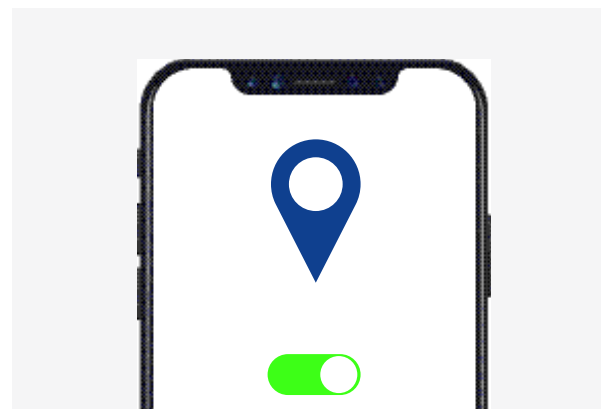

## Quick Tips

**3**

### BLUETOOTH® SHARING ON

Enable Bluetooth® Sharing so that your device is always communicating with your phone even while you're not using the App. This will allow the Pebblebee® App to register last known location of your device.

**4**

### NOTIFICATIONS ON

Allow notifications including alerts and sounds to be sent to your phone. This allows voice activated functionality and CrowdGPS® lost notifications.

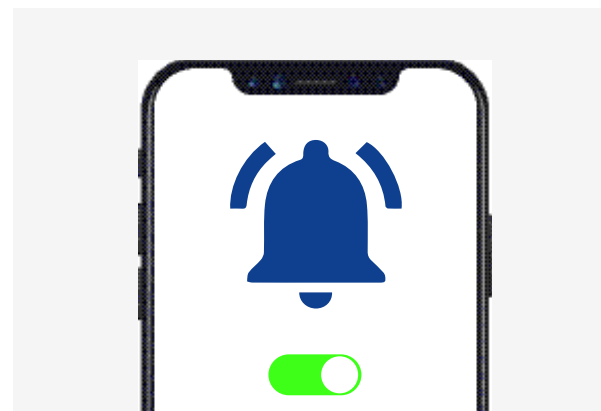

# Quick Tips

**5****REMEMBER ...**

The Pebblebee® device can also help you find your phone by quickly and briefly pressing your device button once, even if your phone is on Silent.



# Setting up the App

The Pebblebee app can be downloaded by searching for the Pebblebee app in the Google Play Store or by visiting [pebblebee.com/download](http://pebblebee.com/download).

- 1 Open the Pebblebee® App
- 2 Enter email and tap 'submit' button
- 3 Open your email and retrieve your activation code.

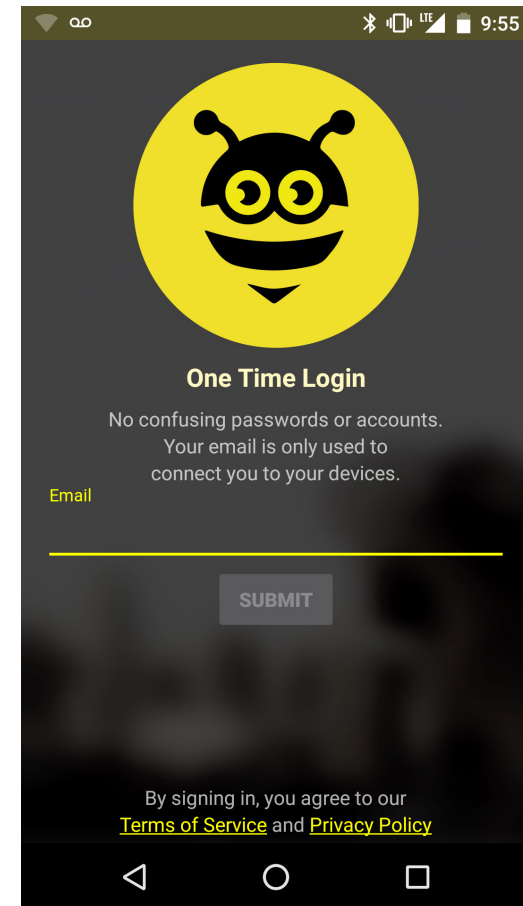

## Claim the BlackCard®

Now that you have an account, you can claim your brand new BlackCard®!

- 1 Tap the bee icon on top to show a list of all claimed devices and the claiming button.
- 2 Tap on Add Device to access the claiming screen.
- 3 Briefly press your BlackCard's button (the center front of the device)
- 4 The app will prompt you to name your device, then will add it to your account. The name can be changed later.

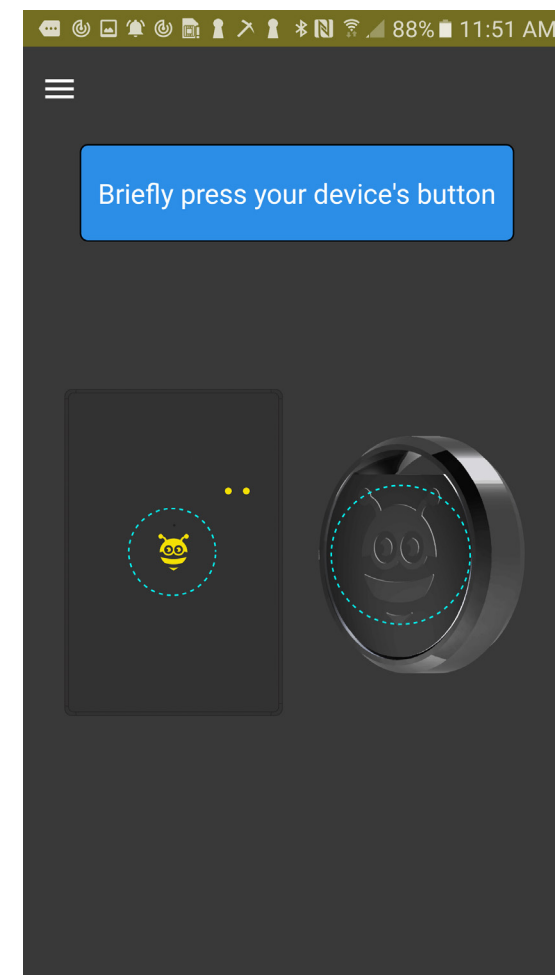

\*If you see a message that the BlackCard has already been claimed, double check that it has not already been claimed to an account using a different email.



# Using the BlackCard®

From this screen, you can do just about anything

- 1 **Menu** - Tap here to see overall account information.
- 2 **Device List** - Tap here to see all claimed devices and navigate between devices. New devices can also be claimed here.
- 3 **Settings** - Tap here to view settings for the currently selected device.
- 4 **Find** - Tap on FIND to Beep and Flash your BlackCard when it's within range of your phone. While beeping, the BlackCard's alarm can be stopped by pressing the BlackCard's button.
- 5 **Map** - The map will show the last known location of the BlackCard, which is the last time it was within range of the app. Tap on the map to expand it.

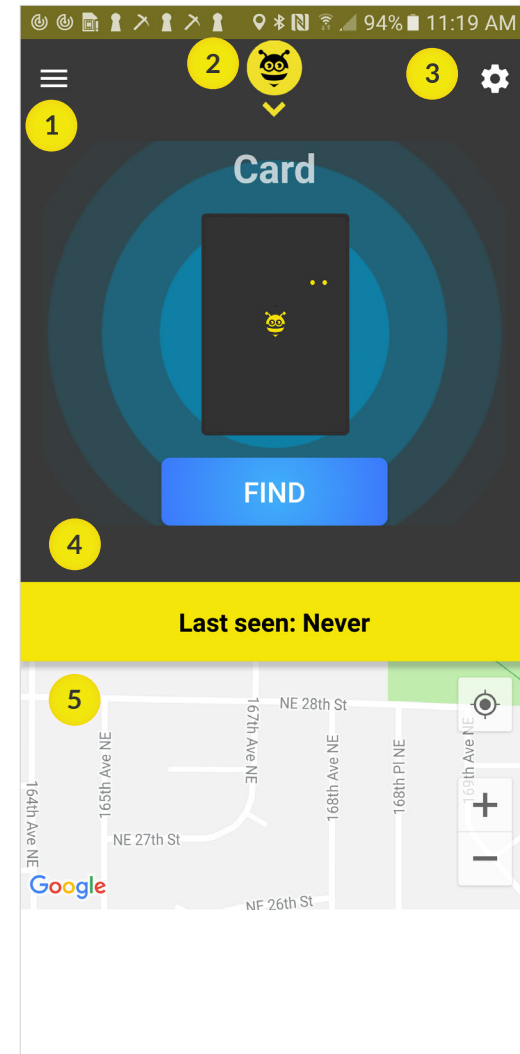

# BlackCard® Settings

## BlackCard® Details:

- Change the name of your BlackCard®
- Check the battery status of the BlackCard®
- Change the tone that's used for the Find Phone feature or turn it off entirely
- Enable the Left Behind Alert
- Set the keyword used to find the device with voice assistants (Google Assistant or Amazon Alexa)
- Mark device as Lost
- Delete your BlackCard® from the account. Deleting it removes all settings.

## Profile:

- See a list of previous notifications
- Access the website for device Help

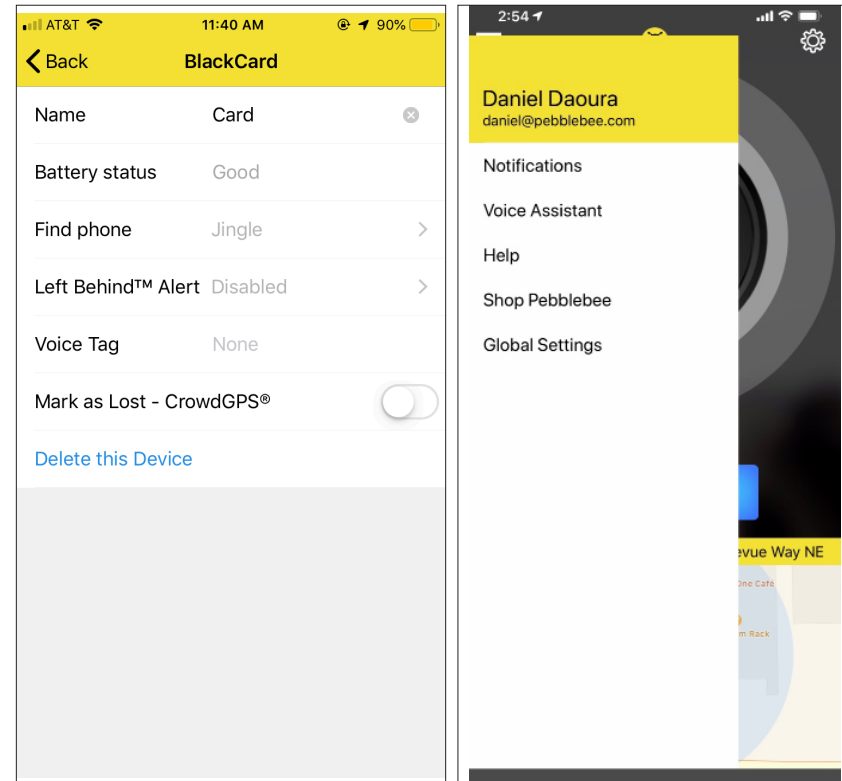

# Voice Assistants

The Pebblebee app now offers Amazon Alexa and Google Assistant integrations. That way if you can't find your phone and BlackCard, you can ask Alexa or Google to find them for you through voice commands.

To set up, go to the Account settings page in the app. Then, follow the directions to get started.

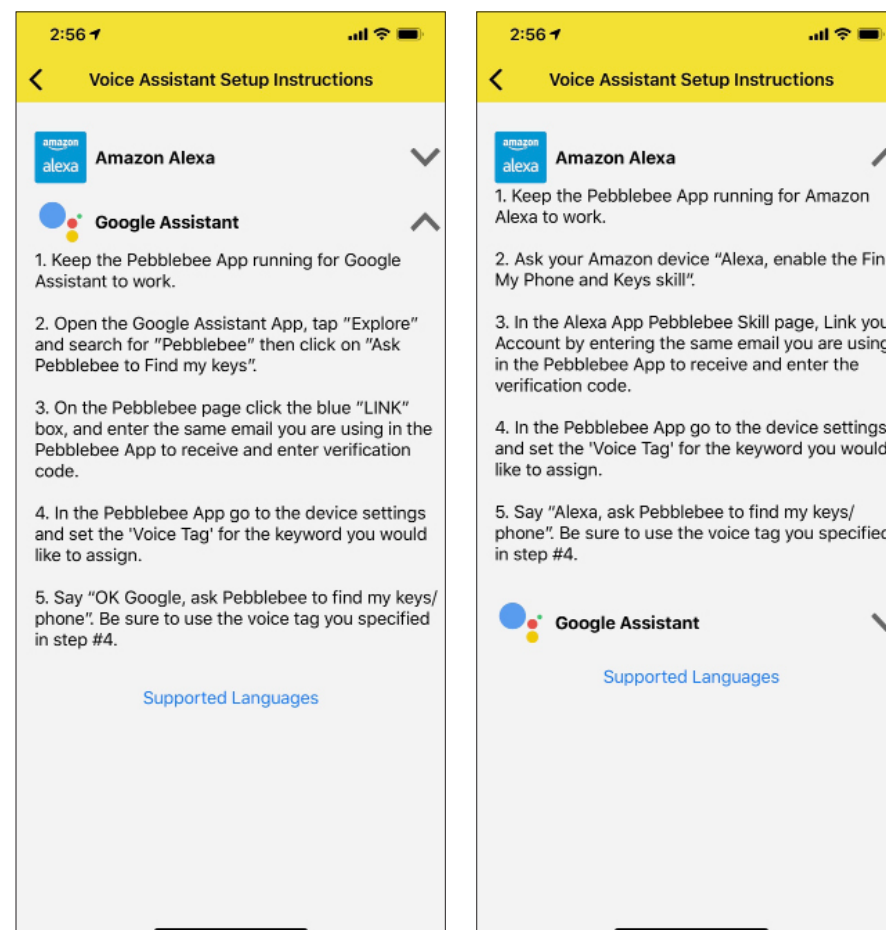

# CrowdGPS® & Left Behind Features

## CrowdGPS®

If your device is out of range and can't be found, mark it as Lost. When it comes within range of any Pebblebee app user, you'll get a notification alerting you to its new location.

Once found, be sure to turn off the Lost button, or you'll continue to get "Found" notifications for updated locations.

## LEFT BEHIND

When the Left Behind alert is enabled, you'll receive an alert when the phone notices that your BlackCard has been out of range for too long (~10 minutes).

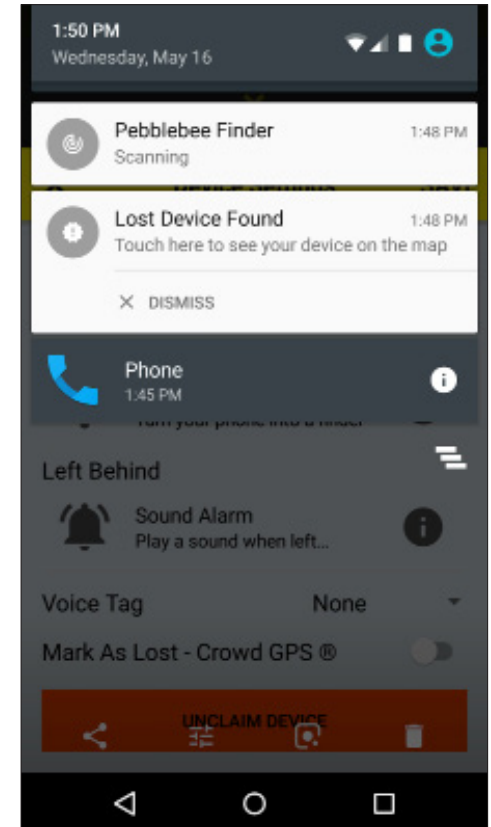
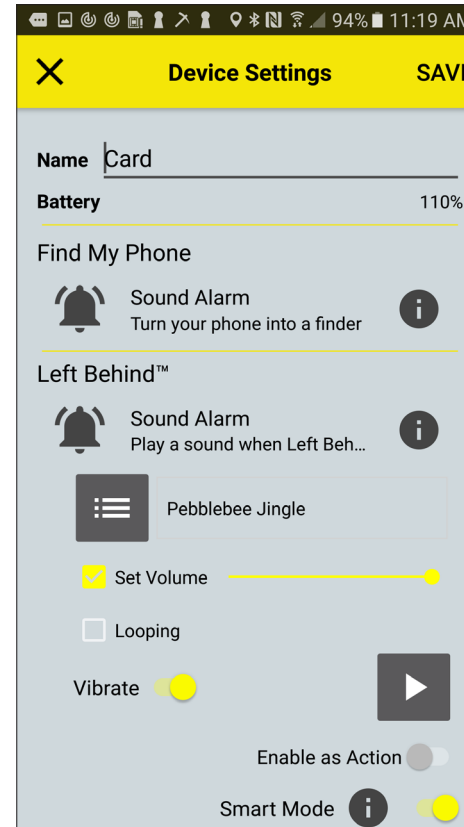

# Re-Enabling Permissions

If you've disabled some permissions, here's how you can re-enable them:

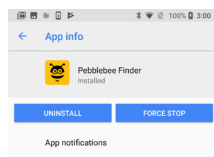

Go to your phone's Settings.



Pebblebee

Scroll down the list and tap on Pebblebee.

Make sure that you have enabled all settings as following screens.

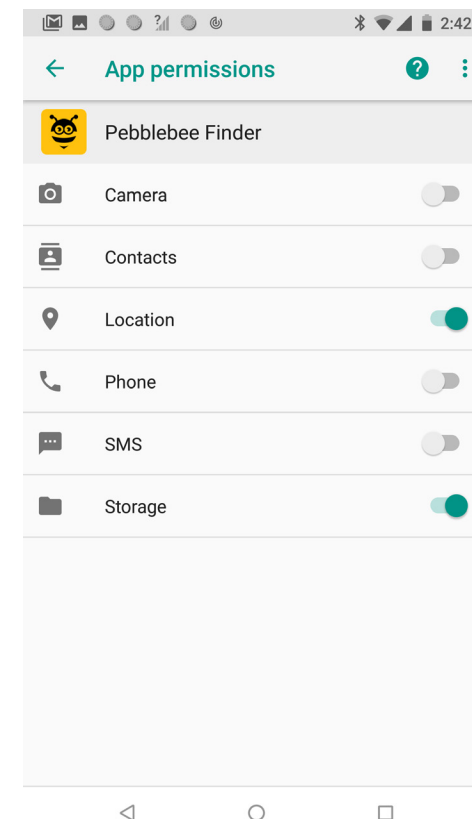
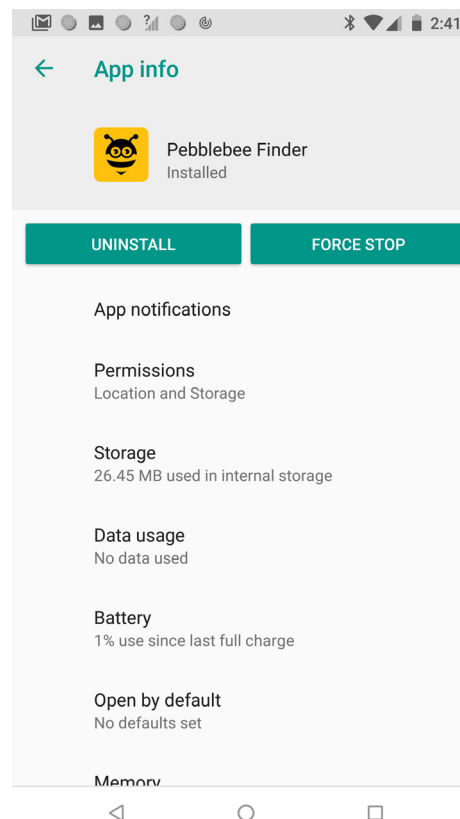

# Disclaimers

The Following slides are Disclaimers and safety information

## FCC Caution

This device complies with part 15 of the FCC Rules. Operation is subject to the following two conditions: (1) This device may not cause harmful interference, and (2) this device must accept any interference received, including interference that may cause undesired operation.

Any Changes or modifications not expressly approved by the party responsible for compliance could void the user's authority to operate the equipment.

**Note:** This equipment has been tested and found to comply with the limits for a Class B digital device, pursuant to part 15 of the FCC Rules. These limits are designed to provide reasonable protection against harmful interference in a residential installation. This equipment generates uses and can radiate radio frequency energy and, if not installed and used in accordance with the instructions, may cause harmful interference to radio communications. However, there is no guarantee that interference will not occur in a particular installation. If this equipment does cause harmful interference to radio or television reception, which can be determined by turning the equipment off and on, the user is encouraged to try to correct the interference by one or more of the following measures:

- Reorient or relocate the receiving antenna.
- Increase the separation between the equipment and receiver.
- Connect the equipment into an outlet on a circuit different from that to which the receiver is connected.
- Consult the dealer or an experienced radio/TV technician for help.

# Declaration of Conformity

P.O. Box 2962, Bellevue, WA 98056

October 29th, 2018

**DECLARATION OF CONFORMITY**  
(in accordance with ISO/IEC 17050-1)

**Manufacturer's Name:** PB INC  
**Manufacturer's Address:** P.O. Box 2962 Renton, WA 98056

**Equipment:** Pebblebee Wireless Tracker  
**Product Name:** Pebblebee Finder  
**Model Number:** PB-501 (Also known by SKU PB-501-G, PB-501-B, PB-501-S, PB-502-SG)  
**Brand:** Pebblebee

The undersigned hereby declares, on behalf of PB INC, Bellevue, Washington, USA, that the above-referenced product, to which this declaration relates, is in conformity with the provisions of:

**RED 2014/53/EU (Radio Equipment Directive)**  
EN 60950-1:2006+A11:2009+A1:2010+A12:2011+A2:2013  
EN 50663:2017  
Draft ETSI EN 301 489-1 V2.2.0 Draft ETSI EN 301 489-17 V3.2.0  
ETSI EN 300 328 V2.1.1

**RoHS Directive 2011/65/EU (Restricted Substance Requirements)**  
IEC 62321-3-1:2013  
IEC 62321-4:2013  
IEC 62321-5:2013  
IEC 62321-6:2015  
IEC 62321-7-1:2015  
IEC 62321-7-2:2017  
IEC 62321-8:2017

**Per Article 2**  
**Frequency:** RF Power (ERP)  
2402-2480 MHz -21dBm ERP

**Signed:** 

**Name:** Daniel Dacora **Place of Issue:** Bellevue, WA (USA)

© 2018 PB INC - CONFIDENTIAL



## FCC Caution

根據 **NCC** 低功率電波輻射性電機管理辦法規定：

第十二條 經型式認證合格之低功率射頻電機，非經許可，公司、商號或使用者均不得擅自變更頻率、加大功率或變更原設計之特性及功能。

第十四條 低功率射頻電機之使用不得影響飛航安全及干擾合法通信；經發現有干擾現象時，應立即停用，並改善至無干擾時方得繼續使用。前項合法通信，指依電信法規定作業之無線電通信。低功率射頻電機須忍受合法通信或工業、科學及醫療用電波輻射性電機設備之干擾。

# THANK YOU



©2019 PB Inc., all rights reserved. pebble bee® is a registered trademark of PB Inc. All other trademarks are property of their respective owners. Granted US patents US9,392,404, US9,564,774, US10,074,049, US9,774,410; 9,900,119; 10,063,331; 9,961,523; 9,892,626, USD790373, USD790372 and other PB Inc. pending patents that have not been published at the time this document was created.  
MODEL NO. PB-S01-B, FCC ID 2AG5ONPB-S01-B, IC 23453-PB501B, Bluetooth SIG certified

