

| Ø mm | O/D mm | I/D mm | Rolled Edge (nom. mm.) | Length (nom. mm) | Weight kg | Galvanised Steel | |
|---------|-----------|-----------|---------------------------|---------------------|--------------|---------------------|-----|
| 80 | 81 | 80 | 6 | 300 | 0.5 | 0.7 | |
| 100 | 101 | 100 | 6 | | 0.6 | | |
| 125 | 127 | 126 | 6 | | 0.7 | | |
| 140 | 142 | 141 | 6 | | 0.8 | | |
| 150 | 151 | 150 | 6 | | 0.9 | | |
| 160 | 162 | 161 | 6 | | 0.9 | | |
| 180 | 182 | 181 | 8 | | 1.0 | | |
| 200 | 204 | 203 | 8 | | 1.2 | | |
| 224 | 228 | 227 | 8 | | 1.3 | | |
| 250 | 253 | 252 | 8 | | 1.4 | | |
| 300 | 301 | 300 | 10 | | 1.7 | | |
| 315 | 317 | 316 | 10 | | 1.8 | | |
| 350 | 352 | 351 | 10 | | 2.0 | | |
| 400 | 402 | 400 | 10 | | 2.9 | | 0.9 |
| 450 | 452 | 450 | 10 | | 3.3 | | |
| 500 | 502 | 500 | 10 | | 3.7 | | |
| 560 | 562 | 560 | 10 | 4.1 | | | |
| 630 | 632 | 630 | 10 | 4.6 | | | |
| 710 | 712 | 710 | 10 | 5.2 | | | |

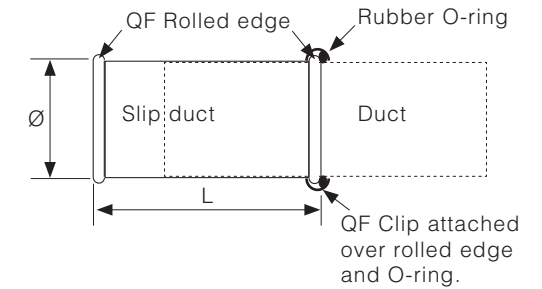
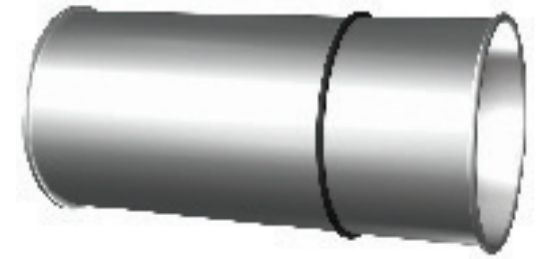

Construction
Longitudinal seam type: plasma welded.

Ends
QF (Quick-Fit rolled edge).

| Temperature Rating of Product Components | | |
|--|------------------|------------------------------|
| ° C | Slip Duct | Sealants |
| 200° | Galvanised Steel | |
| 121° | | Joka Seal Metal Sealant 2315 |
| -20° | | |

| Additional Notes |
|--|
| At temperatures ranging between 200° C and 250° C, the zinc-iron alloy layers in galvanised steel will continue to provide a high level of protection from corrosion. However, there may be some peeling, changes in mechanical properties, and reduction in the corrosion protection. Recommended max. service temperature is 200° C. |

| Compliance / Rating of Product Components | | |
|---|---------------|--------------------------|
| Product | Material | Compliance / Rating |
| Slip Duct | Galvanised | DX51D with Z275 Coating |
| Joka Seal Metal Sealant 2315 | Acetone blend | AAMA Specification 801.1 |