

Quick Start

1 Connecting your SideTrak

Check your laptop's USB-C port for compatibility, you should see one of the below symbols.



Mac and Chromebook laptops are compatible even if there are no symbols.

If you don't have a compatible USB-C port, download DisplayLink: sidetrak.com/pages/displaylink-download.

Plug in your monitor and wait 2 minutes for the screen to light up.

If you are having issues, refer to the user manual for troubleshooting before you attach your monitor.

2 Close laptop

Make sure your SideTrak is unplugged from the laptop and the laptop is closed.

Right-Side Attachment

To put your monitor on the right of your laptop, make sure your laptop opening is *facing you*.

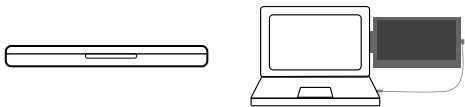

Left-Side Attachment

To put your monitor on the left of your laptop, make sure the laptop opening is *facing away* from you.

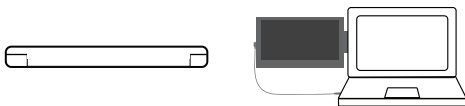

Single Screen Attachment Guide

Scan to watch the installation video.



3 Align the guide with your laptop

Based on step 2, place this paper on top of your laptop and move it all the way to the right side. The right edge of this paper should be aligned with the right edge of your laptop.

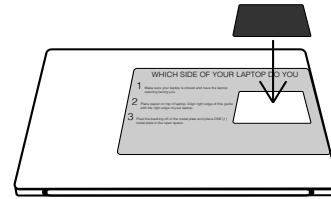

or

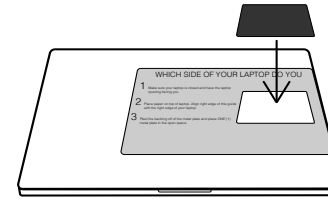

Laptop opening facing away from you
Left screen attachment

Laptop opening facing you
Right screen attachment

4 Place metal plate in open space

Peel the backing off of ONE (1) metal plate and place it in the open space on this guide. Apply light pressure for 10 seconds. Remove guide from laptop.

5 Attach monitor

Clip your monitor to the metal plate on your laptop. Use the small opening on the monitor's mounting frame to help guide you. Through the open space on the mounting frame you should be able to see the line that goes across the metal plate. It's easiest to clip when the monitor is fully extended. You will hear a loud click when its properly placed.

6 Now plug in and you're ready to use your SideTrak!

If using a triple screen setup continue to the other side for triple screen attachment.

Align this side with the right edge of your laptop. →

Place metal plate here ↓

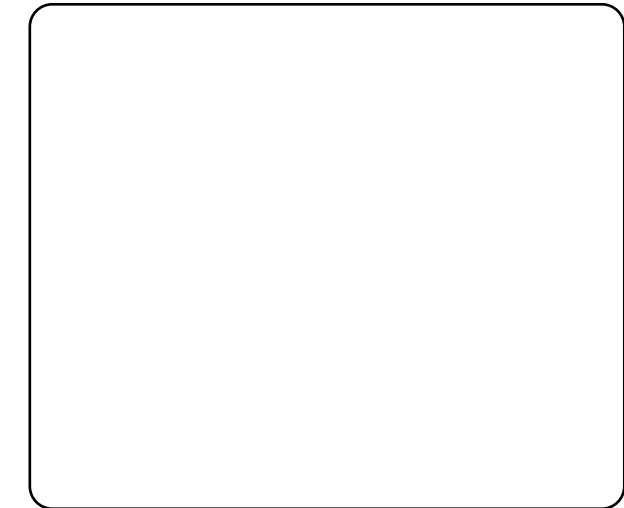

SideTrak logo should be in this corner ↷

Flip the paper over for triple screen attachment. →

Continue to step 3 →

Triple Screen Attachment Guide

Scan to watch the installation video.



Quick Start

1 Connecting your SideTrak

Check your laptop's USB-C port for compatibility, you should see one of the below symbols.



Mac and Chromebook laptops are compatible even if there are no symbols.

If you don't have a compatible USB-C port, download DisplayLink: sidedtrak.com/pages/displaylink-download.

Plug in your monitor and wait 2 minutes for the screen to light up.

If you are having issues, refer to the user manual for troubleshooting before you attach your monitor.

2 Close laptop

Make sure your SideTrak is unplugged from the laptop and the laptop is closed.

Right-Side Attachment

To put your monitor on the right of your laptop, make sure your laptop opening is *facing you*.

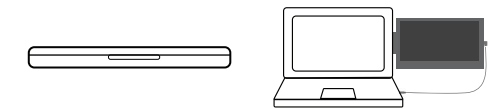

Left-Side Attachment

To put your monitor on the left of your laptop, make sure the laptop opening is *facing away you*.

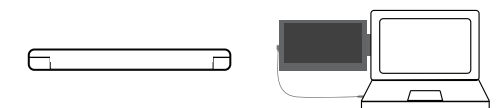

Continue to step 3

Align this side with the left edge of your laptop.

Place metal plate here



SideTrak logo should be in this corner

Flip the paper over for single screen attachment.

! Attach first metal plate

Using the single screen attachment guide (opposite side) attach first screen before continuing. !

1 Rotate and align laptop

Rotate your laptop, so the metal plate you just attached is on your right. Align the left edge of this paper to the left edge of your laptop.

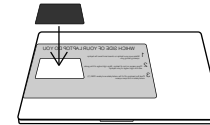

2 Fold guide for metal plate spacing

Fold the paper on the solid blue line. If needed fold the paper in a different spot until the metal plate is revealed.

3 Align to metal plate

Align the blue dotted line to the top and bottom of your already placed metal plate.

Optional: Use tape to keep the paper in place.

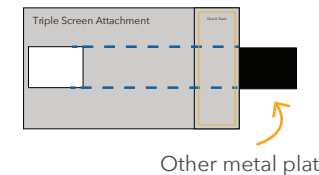

4 Place metal plate in open space

Peel the backing off of ONE (1) metal plate and place it in the open space on this guide. Apply light pressure for 10 seconds. Remove guide from laptop.

5 Attach monitor

Clip your monitor to the metal plate on your laptop. Use the small opening on the monitor's mounting frame to help guide you. Through the open space on the mounting frame, you should be able to see the line that goes across the metal plate. It's easiest to clip when the monitor is fully extended. You will hear a loud click when its properly placed.

6 Now plug in and you're ready to use your SideTrak!