



Installation Guide



Dimensions

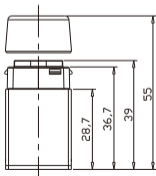
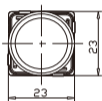

Table of Contents

Section	page
1.0 Product Range	1
2.0 Description.....	2
3.0 Features.....	3
4.0 Electrical Specification.....	4
5.0 Load Compatibility	5
6.0 Installation	6
7.0 Wiring Diagram	7
8.0 Warranty Statement	8

1.0 Product Range

Product No.	Description
LED-L400DIM-K	Knob LED Dimmer 400VA

2.0 Description

The LED Dimmer is a rotary controlled, modular dimmer mechanism rated at 400VA. Up to six dimmer mechanisms can be installed in a plate!

Designed for LED lamps, the unit utilises powerful and sophisticated dimming technology to provide control.

The LED Dimmer also incorporates over-current and thermal fuse cutoff (non-recoverable) protection devices and is capable of withstanding persistent short circuit conditions.



3.0 Features

- Modular dimming mechanism.
- Two-wire phase control wall plate dimmer.
- Soft-start for lamp and driver life.
- Provide optimised dimming of LED based lamps and drivers.
- Compatibility with incandescent lamps, 240V halogen lamps, Low voltage halogen lamp with dimmable electronic transformer, etc
- Wall or architrave mounting options.
- Wide range of plate styles and colour variants available.
- Suitable for new installations or retro-fit applications.
- Inbuilt Over-Current and Over-Temperature protection.
- Full short circuit protection.
- Immune to high frequency (ripple) signal injection on mains supply.
- Complies with Australian and International EMC Standards.

4.0 Electrical Specification

Parameter	Value
Nominal Operating Voltage	220-240Vac ~
Nominal Operating Frequency	50Hz
Maximum Load	400VA @1 Gang Derate for multi-gang applications
Minimum Load	5VA
Dimming Technique	Trailing Edge Phase Control
Mounting Centres	84mm Australian Pattern Plate
Shipping Weight	25g Dimmer Mechanism Only
Safety Compliance	AS/NZS3100, AS/NZS3133, IEC60669-2-1
EMC Compliance	AS/NZS CISPR15, IEC60669-2-1 (26.1, 26.2), IEC61000-3-2 (Excepting when used in conjunction with Electronic loads)
Specifications Typical @ 240V ~ 25°C	
Suitable for Indoor Use Only	
No User Serviceable Parts Inside	

5.0 Load Compatibility

Load Symbol	Compatible Loads	Product Number
		LED-L400DIM-K 400VA
	Dimmable LED Lighting	✓
	Incandescent Lighting 240V Halogen Lamps	✓
	Low Voltage Halogen Lighting with Electronic Transformers	✓

6.0 Installation

To connect the required lighting loads, then follow the following steps:

Step 1

Leave the dimmer connected, but remove the dimming knob from the dimming shaft



Step 2

Turn the dimmer shaft anti-clockwise until the available installation level is reached.

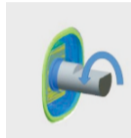

Step 3

Align the plane on the front face of the dimmer with the plane on the inside of the dimmer knob



Step 4

Push the dimmer knob back onto the shaft such that the plane remain aligned



7.0 Wiring Diagram

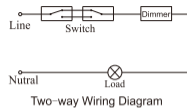
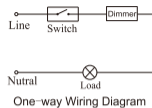

NOTE:

- The LED dimmer series are designed for One-Way or Two-Way operation as above diagrams.
- Two or more dimmers cannot be connected in parallel or series to control the same load from two different locations.
- Dimmer Mechanism wiring is not polarity sensitive
It is illegal for persons other than an appropriately licensed electrical contractor or other persons authorised by legislation to work on the fixed wiring of any electrical installation. Penalties for conviction are severe!

8.0 Warranty Statement

1. This DimEzy product is guaranteed against faulty workmanship and materials for a period of two years from the date of installation.
2. This warranty is expressly subject to the DimEzy product being installed, wired, tested, operated and used in accordance with the manufacturer's instructions.

DimEzy

LiquidLeds Lighting Pty Ltd

Add: 602 Botany Road Alexandria NSW 2015

Tel: 02 88809033 Email: help@liquidleds.com.au