

PARTS LIST			
ITEM	QTY	PART NUMBER	DESCRIPTION
1	1	DV-208030	DRIVE ASSEMBLY- CW
2	1	GA-207691	PINION HOUSING GASKET
3	1	HG-208031	PINION HOUSING ASSEMBLY - SAE 3
4	1	HM-202656-3	HYDRAULIC MOTOR ASSEMBLY - CW
5	4	SC-100196	SOCKET HEAD CAP SCREW
6	4	WA-6-10BL	LOCK WASHER

REVISIONS		
REV	DESCRIPTION	DATE
G	SEE ECN	8/26/2013

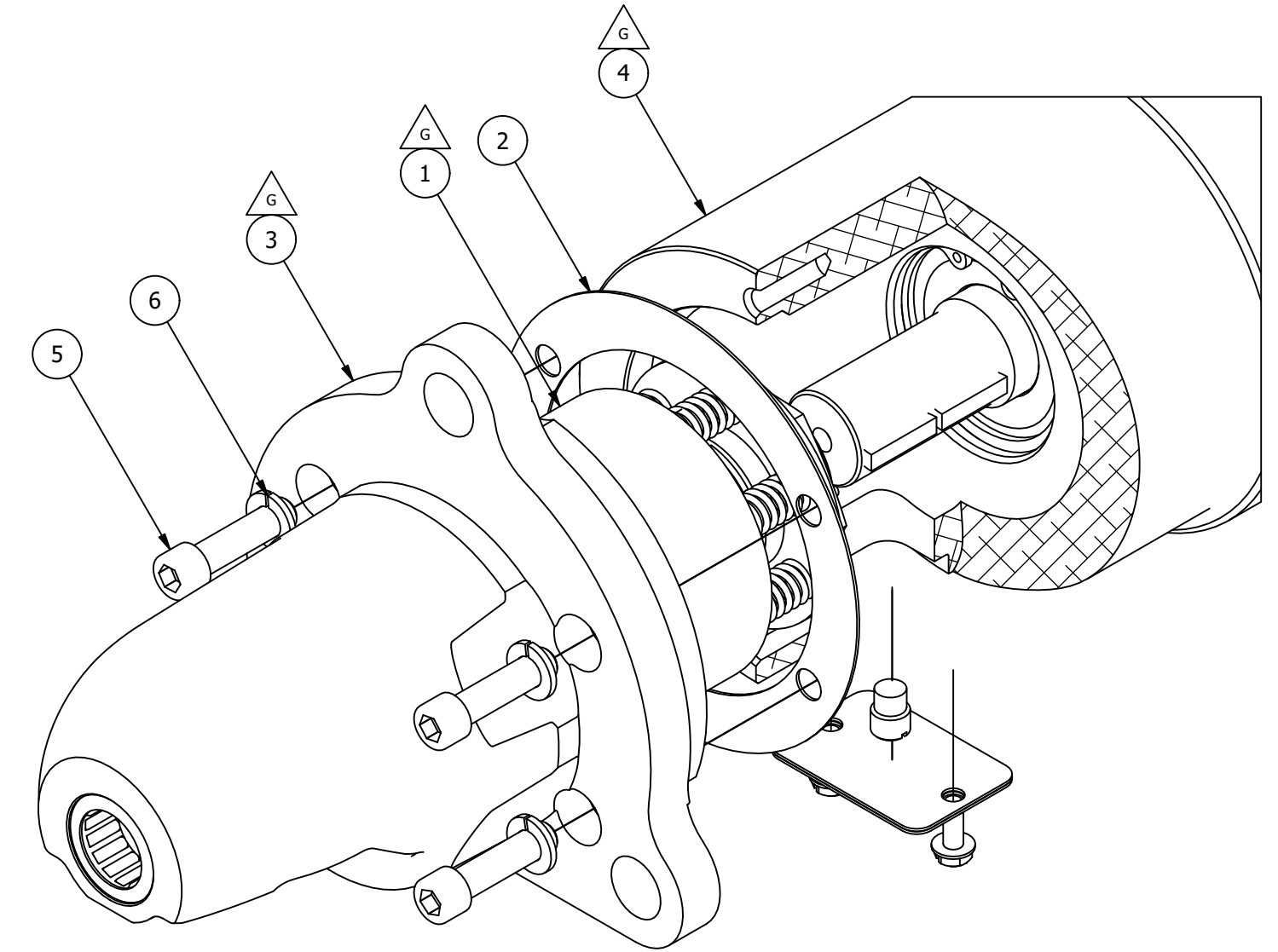

ASSEMBLY DETAIL VIEW
SCALE: 0.65 : 1

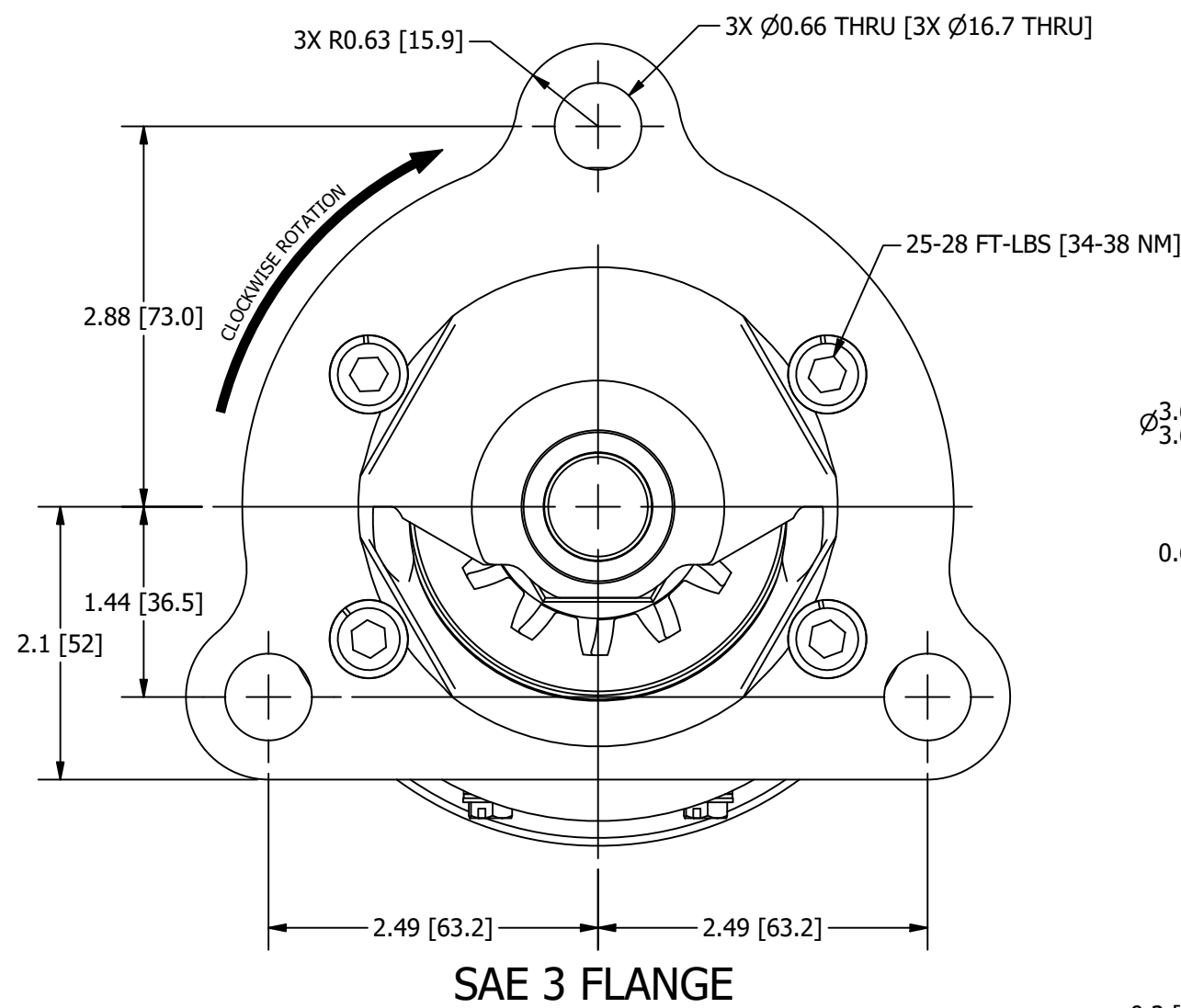
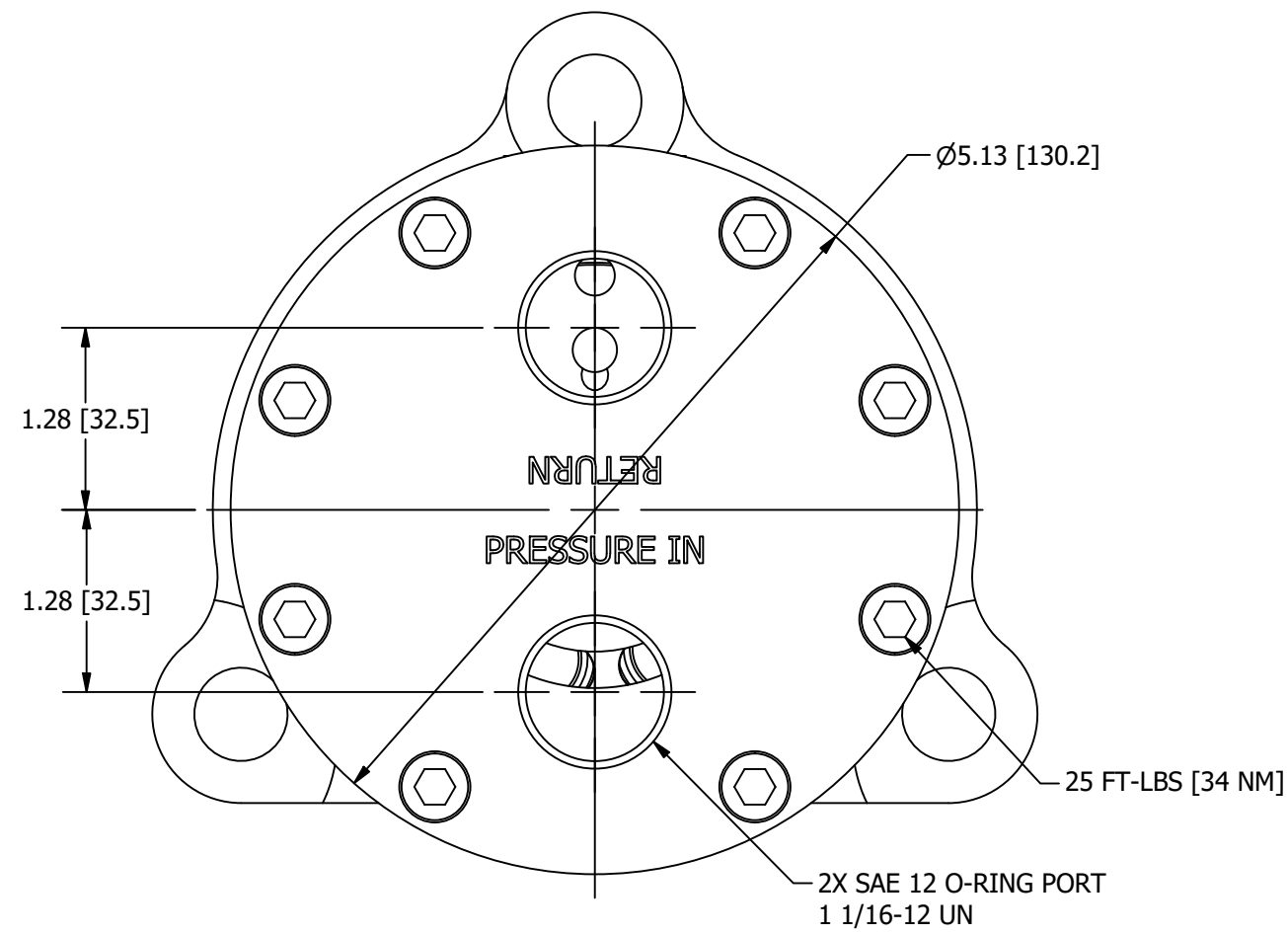
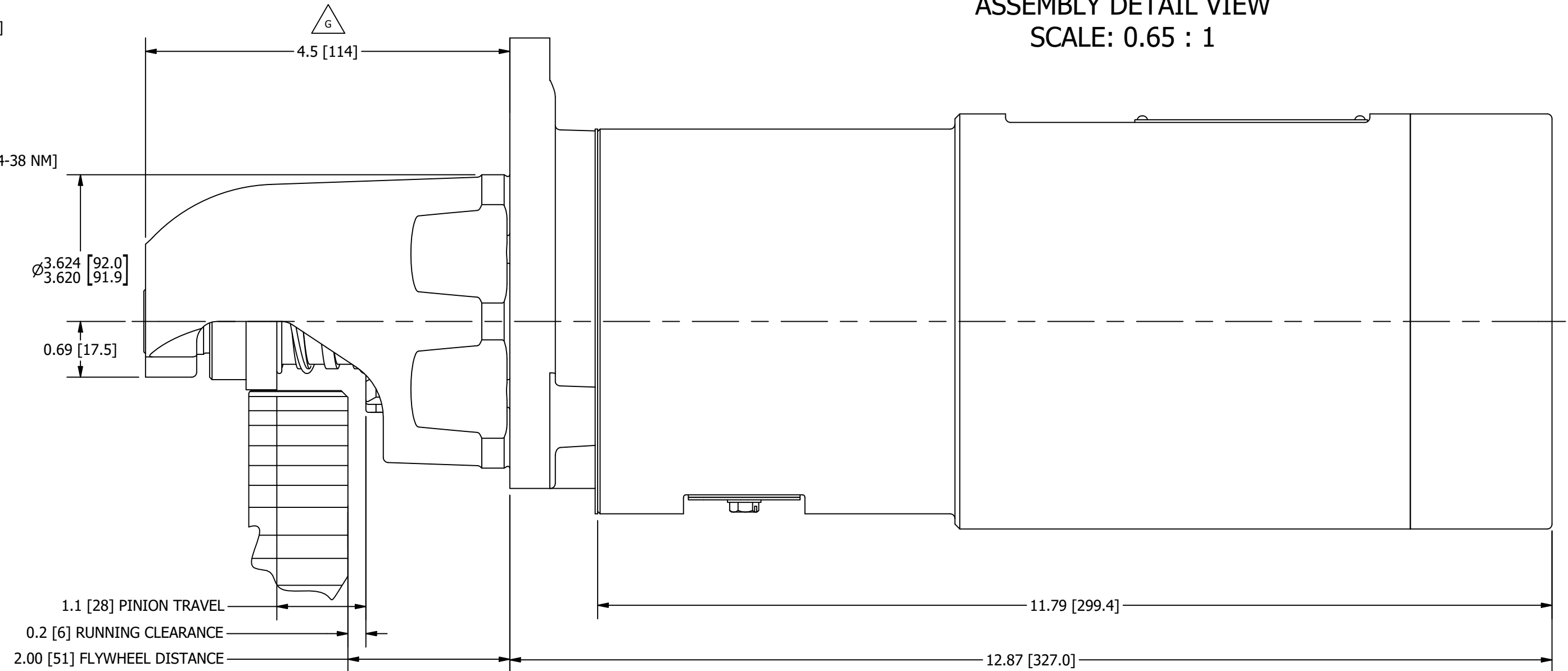

CW D SERIES PERFORMANCE DATA	
DISPLACEMENT	3.50 IN ³ /REV [8.9 CM ³]
DUTY CYCLE	INTERMITTENT
MAX TORQUE	120 FT-LBS [163 Nm]
MAX WORKING PRESSURE	3000 PSI [207 BAR]
SPEED RANGE	0-4500 RPM
ROTATION	(CW)

DV-208030 DATA	
NUMBER OF TEETH	12
OUTSIDE DIA. (PITCH DIA.)	2.25 [5.7 mm] 2.00 [5 mm]
PITCH	6/8
PRESSURE ANGLE (ROOT DIA.)	20° 1.72 [4.4 mm]

UNLESS OTHERWISE SPECIFIED:

TOLERANCES:	INDICATES REFERENCE TO A NOTE
0.X = ±	△ INDICATES REFERENCE TO A REVISION
0.XX = ±	○ INDICATES REFERENCE TO BOM NUMBERS NOT SHOWN DO NOT APPLY
0.XXX = ±	THIRD ANGLE PROJECTION:
ANGLES = ±	⊕
✓ FINISH =	⊖
FRACTION = ±	

Kocsis Technologies, Inc.
11755 South Austin Ave. Alsip, IL 60803

HYDROTOR® ASSEMBLY

PART NUMBER: D1-12C2200-30200 REVISION: G

MATERIAL: SEE PARTS LIST

SCALE: NTS WEIGHT: 38.1 LBS

ENGINEER: J.AGUILERA 8/13/2013
APPVD BY: J.AGUILERA 8/13/2013
FILENAME: D1-12C2200-30200.dwg SHEET 1 OF 1

LEGACY KTI P/N: CMD-3A-111
CMD-3A-209
CMD-3A-214