

**READ AND SAVE THESE INSTRUCTIONS**



**Live Pure<sup>®</sup>**  
**Orbital Oscillating Fan**

Owner's Manual



**English**

**Models:**

**LP1200FAN  
LP1200FAN-M  
LP1200FAN-S  
LP1200FAN-G  
LP1200FAN-W  
LP1200FAN-R**

Form #LP1200FAN

20211221

©2021 Registered Trademark/TM Trademark of  
LivePure LLC. Manufactured exclusively for LivePure LLC  
All rights reserved

# Table of Contents

## **Important Safety Instructions**

Safety Warnings.....	1
----------------------	---

## **Using Your Fan**

Getting to Know your Fan.....	4
Basic Set-Up.....	5
Specifications.....	5
Control Panel Functions.....	6
Using the Remote.....	8
Replacing the Fuse.....	9

## **Maintenance**

External Cleaning.....	10
Internal Cleaning.....	11

## **Fan Assistance**

Troubleshooting.....	12
Technical Support.....	13

## **Warranty**

3 Year Guarantee.....	14
-----------------------	----

# Safety Warnings

## READ AND SAVE THESE INSTRUCTIONS!

### **Important Safety Instructions: Read all instructions before using this fan.**

- DO NOT disassemble, repair or modify the product. Doing so can cause fire, electric shock or injury.
- ALWAYS use only as described in this LivePure Owner's Manual. Any other use not recommended by the manufacturer may cause fire, electric shock, or injury to persons.
- DO NOT turn on the product unless the fan blade and guard are installed properly.
- DO NOT use this product with any solid-state speed control device. This will reduce the risk of fire or electric shock.
- Product intended for household use only.
- DO NOT use product for anything other than its intended use. Doing so could cause the product to malfunction or cause fire.
- DO NOT use near radio or televisions. Doing so may interfere with radio or television signals.
- DO NOT use in places exposed to direct sunlight or heating devices.
- ONLY use product on a level, stable surface. Failing to do so could cause the product to tip over.
- ALWAYS place product in locations away from curtains and hoisting strings. Failing to do so can cause damages to the articles near the product.
- DO NOT spray with insecticides, hair sprays, or lubrication oils, etc.
- DO NOT use near flammable substances, objects that have flames, or combustible materials. Failure to do so could cause fire.
- DO NOT place product in a spot where it could fall. If unit falls, it could malfunction.
- DO NOT place product near water sources, like a bathtub, sink or swimming pool.
- DO NOT get the unit wet. Doing so can cause fire or electric shock.
- DO NOT use in rooms with high humidity levels, such as bathrooms.

# Safety Warnings

- DO NOT use product outdoors.
- DO NOT use the product with the air flow pointed at a combustible appliance such as a heater. Doing so can cause carbon monoxide poisoning and fire.
- DO NOT use in locations where there is a lot of dirt or dust.
- DO NOT use while covered or blocked with cloth, paper, or plastic bags, etc.
- DO NOT insert foreign objects such as metal into the fan outlet.
- DO NOT place fingers into the guard, or any moving part of the fan.
- ALWAYS keep fan away from children unless supervised by an adult.
- **CHOKING HAZARD:** the remote control contains a small battery. Keep the remote away from children and do not swallow the battery. If battery is swallowed, seek medical advice immediately.
- DO NOT climb on or tip the product over. Doing so may lead to injury or electric shock.
- DO NOT point air flow directly at your body. The air flow can be very strong.
- DO NOT place near plants. Air blowing directly on plants can be harmful.
- ALWAYS plug directly into a wall socket. NEVER use with an extension cable. Doing so could result in the cable overheating and catching fire.
- ALWAYS grab the power plug to unplug it. Pulling on the the power cord can damage it, which can cause fire or electric shock.
- ALWAYS unplug the product when it is not in use for extended periods of time.
- ALWAYS pick up and carry the fan by the base of the unit.
- DO NOT run the cord under carpeting or any type of rug, furniture or appliances.
- ALWAYS place the cord away from high traffic areas to avoid it being tripped over.
- ALWAYS unplug the product when performing maintenance, inspecting, or moving the product.

# Safety Warnings

- ALWAYS use with the supplied power plug. Failure to do so may cause electric shock or malfunction.
- CAUTION: if the plug is loose in the socket, the socket may need to be replaced. Check with a qualified electrician to replace the socket.
- This appliance has a polarized plug (one blade is wider than the other). To reduce the risk of electric shock, this plug is intended to fit in a polarized outlet only one way. If the plug does not fit fully in the outlet, reverse the plug. If it still does not fit, contact a qualified electrician. DO NOT attempt to defeat this safety feature.
- This product employs overload protection (fuse). A blown fuse indicates an overload or short-circuit situation. If the fuse blows, unplug the product from the outlet. Replace the fuse as per the user servicing instructions (follow product marking for proper fuse rating) and check the product. If the replacement fuse blows, a short-circuit may be present and the product should be discarded or returned to an authorized service facility for examination and/or repair.
- Do not operate any fan with a damaged cord or plug. Discard fan or return to an authorized service facility for examination and/or repair.
- Do not run cord under carpeting. Do not cover cord with throw rugs, runners, or similar coverings. Do not route cord under furniture or appliances. Arrange cord away from traffic area and where it will not be tripped over.
- Use only 100-240V~. Other current/voltage can cause fires.
- DO NOT use if the power cord or the power plug is damaged.
- DO NOT damage the power cord. This can cause fire or electrical shock.
- DO NOT use if the power cord is bundled up. Always extend the power cord out before using.
- DO NOT unplug power plug when hands are wet.
- STOP use immediately if you experience any of the following malfunctions: Abnormal sounds or odors; power plug or cord becoming abnormally hot; product periodically stops during operation; loss of power when the power cord is used; tingling sensation from electric current felt when the product is touched
- **Contact LivePure Customer Service when service or repair is required.** DO NOT disassemble the product as it may result in an electric shock or fire.

# Getting to Know Your Fan

**Front View:**

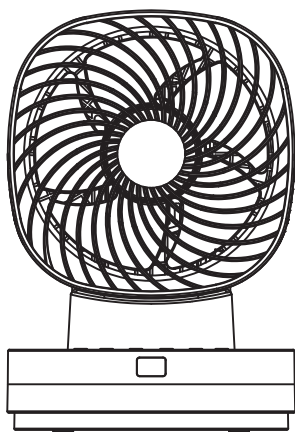

**Back View:**

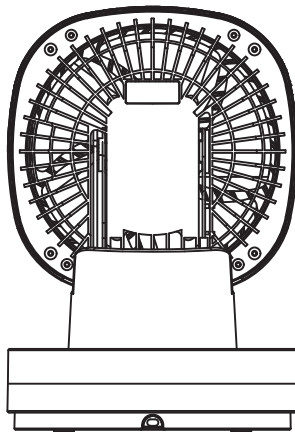

**Control Panel:**

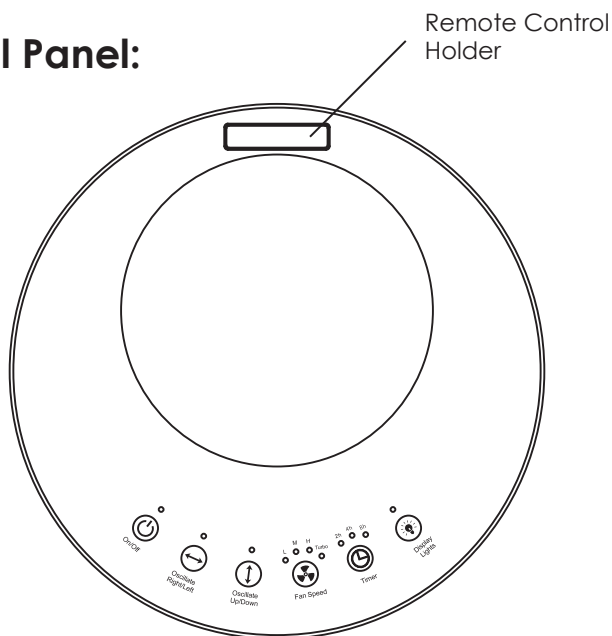

# How to Use Your Fan

## Basic Set-Up:

1. Carefully remove fan from box and remove any packaging material. Your box should contain a remote and a fan.
2. Extend power cord and inspect for any signs of damage. If damaged, contact LivePure customer service.
3. Plug into wall outlet.
4. Turn on unit by pressing ON/OFF button on fan or remote. The product should beep when buttons are pressed.
5. Refer to "How to Use Your Fan" for more information on operating your fan.

## Specifications:

Setting	Power (W)	Noise (dB)
Low	19.5	37.3
Medium	28.7	43.2
High	37.4	48.1
Turbo	48.5	54.1

Voltage (V)	Frequency (Hz)	Rotation Angle Vertical	Rotation Angle Horizontal	Cord Length (ft)
120	60	83.5°	75°	7.55
Weight (lbs)	Height (in)	Width (in)	Depth (in)	
6.06	12.74	8.66	8.86	

# How to Use Your Fan

## On/Off:



Press the power button “On/Off” on the unit or the remote to turn on the product. The light above the button will light up when powered on.

**Note:** *The product will always start running on medium fan speed when turned on.*

## Oscillation:

You cannot manually change the angle of the product. You must press the oscillation buttons to change the angle. Trying to change the angle manually could damage the product.

### Horizontal Oscillation:



Press the “Oscillate Right/Left” button on the unit or the remote to make the fan rotate horizontally. Press the button again to make the horizontal oscillation stop. The light above the button on the unit will be on if the setting is in use (unless the display lights were turned off).

### Vertical Oscillation:



Press the “Oscillate Up/Down” button on the unit or on the remote to make the fan rotate vertically. Press the button again to make the vertical oscillation stop. The light above the button on the unit will be on if the setting is in use (unless the display lights were turned off).

**Note:** *The product can operate with both horizontal and vertical oscillation running at the same time for a full oscillation effect.*



# How to Use Your Fan

## Fan Speed:



Press the “Fan Speed” button on the unit or the remote to control the speed of the fan. The product will automatically start on the medium “M” speed when turned on. Press the button again to pick the high “H” speed setting, once more for the turbo “Turbo” speed setting, and once more for the low “L” speed setting. The light above the “Fan Speed” button on the unit will be on under your chosen setting (unless the display lights were turned off).

## Timer:



You can program your fan to turn off after a set time using the Timer button. You are able to choose between 2 hours, 4 hours and 8 hours. Press the “Timer” button on either the product or remote once to set the timer to 2 hours, press again to set the timer to 4 hours, and press one more time to set the timer to 8 hours. Press the button again to reset the timer and turn it off. The light will be displayed above your chosen time. If no light is lit above the “Timer” button on the product, there is no timer set (unless the display lights were turned off).

## Display Lights:



Press the “Display Lights” button on either the product or the remote to turn off the blue lights on the display panel. The light above the “Display Lights” button will remain on but dimmed. The chosen settings, including oscillation, fan speed and timer, will remain even with the display lights turned off. Press the button again to turn the lights back on.

# How to Use Your Fan

## Using the Remote:

Your remote comes with a battery installed and does not need to be programmed. Before using your remote for the first time, you must take out the pull tab. To use remote, make sure to point it at the front of the unit. The remote will not work when pointed to the backside of the unit. You should store your remote on the backside of the unit in the built-in holder.

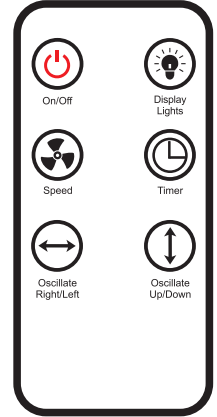

## Replacing the Remote Battery:

It is recommended to replace the battery when the product takes a long time to respond or stops responding when the buttons are pressed.

1. Turn over remote control. Press tab A toward the right and pull.
2. Pull out battery holder B and replace the battery. Only use the specified battery type (Lithium Button Cell Battery CR2025). The battery must be installed with the positive side facing up.
3. Insert battery holder B back into remote.

**Note:** Do not apply excessive force to battery holder. Remove battery when not using for an extended period of time. When disposing of used battery, please use the correct method of disposal.

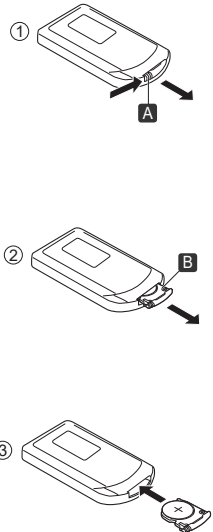

Battery : Lithium Button Cell Battery (CR2025)

**WARNING**

**Keep the lithium battery out of reach of small children.**

Small children may accidentally swallow it. If swallowed, call your doctor immediately.

# How to Use Your Fan

## Replacing the Fuse:

This product uses an overload protection fuse. A blown fuse indicates an overload or short-circuit situation. If the fuse blows, unplug the product from the outlet. Replace the fuse following the instructions below:

1. Grasp the plug and remove from the outlet. Do not unplug by pulling on the cord.
2. Open fuse cover. Slide open the fuse access cover on top of attachment plug towards blades.
3. Remove fuse carefully. Push the fuse from the other side over to remove fuse.
4. Replace fuse only with 2.5 AMP, 125 V fuse
5. Close fuse cover. Push cover closed so that the tabs latch.



### WARNING

#### **Risk of fire. Do not replace attachment plug.**

Contains safety device (fuse) that should not be removed. Discard product if the attachment plug is damaged.



### WARNING

#### **CHEMICAL BURN HAZARD. KEEP BATTERIES AWAY FROM CHILDREN.**

This product contains a lithium button/coin cell battery. If a new or used lithium button/coin cell battery is swallowed or enters the body, it can cause severe internal burns and can lead to death in as little as 2 hours. Always completely secure the battery compartment. If the battery compartment does not close securely, stop using the product, remove the batteries, and keep it away from children. If you think batteries might have been swallowed or placed inside any part of the body, seek immediate medical attention. The cells shall be disposed of properly, including keeping them away from children; Even used cells may cause injury.

# Maintenance

## Cleaning the Fan:

*Before cleaning the fan, please read the following:*

- Always unplug the fan and disconnect from power before cleaning.
- Do not immerse the fan in water or other liquid and never allow water to drip on the motor housing.
- Do not use gasoline, paint thinner, or any other corrosive cleaning solutions to clean the fan.
- If the fan will not be in use for an extended period of time, you may leave the fan assembled. Cover to protect from dust. Store in a cool, dry place.

## External Cleaning:

- Wipe the external grill lightly with a soft cloth.
- Use only a soft, damp cloth to gently wipe the outer surfaces of the fan.
- If needed, you can use a cloth with a diluted neutral detergent.
- To clean between the grills, we recommend using a pipe cleaner, flexible dust wand, vacuum cleaner or compressed air to gently remove dust.

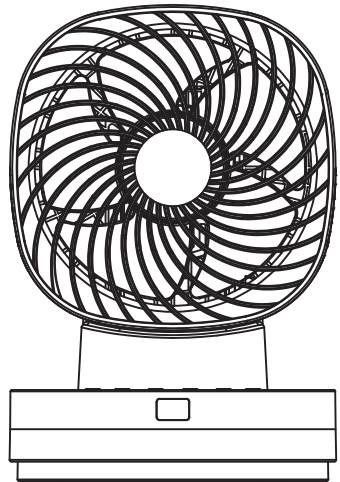

# Maintenance

## Internal Cleaning:

Dust may collect on the internal fan blades. To clean the fan blades you must take off the grille. To do so, follow the directions below.

1. Make sure the fan is unplugged and powered off.
2. Remove the screws from the back of the unit.
3. Remove the fan's grille.
4. Use a vacuum cleaner to remove dust and debris.
5. Use a soft, damp cloth to further clean the blades.
6. Insert the grille back on the product.
7. Reattach the screws back into the unit.

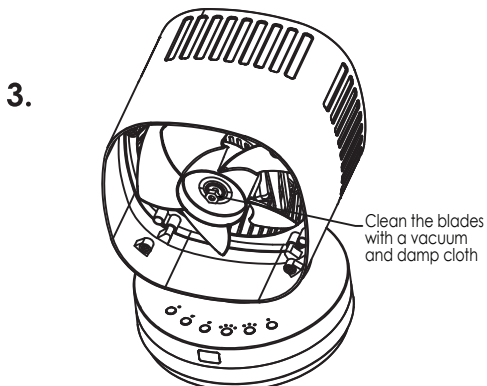
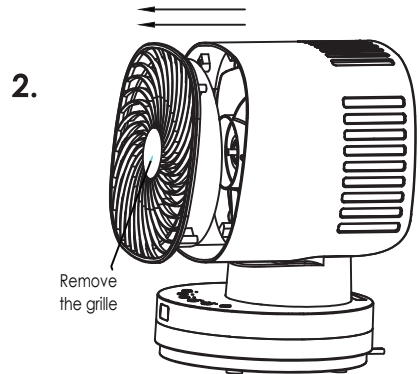
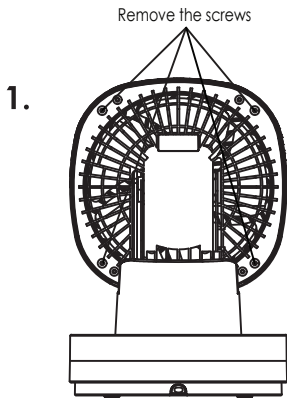

# Troubleshooting

**Problem:** Fan makes an unusual/excessive noise

**Solution:**

1. Reset the fan. Unplug the fan for 1 minute, then plug back in.
2. Check for excessive dust build up and clean accordingly.
3. If fan is still making unusual noise, unplug it from the wall outlet and contact LivePure Customer Service.

**Problem:** Fan is not working

**Solution:**

1. Make sure the fan is plugged into a working electrical outlet.
2. Make sure the fan is powered on. Press "On/Off" button on either the remote or unit.
3. Check if a household fuse has blown, or if a circuit breaker tripped. Replace the fuse or reset the circuit breaker. If the problem continues, call an electrician.

**Problem:** Fan has reduced air flow.

**Solution:**

1. Reset the fan. Unplug the fan for 1 minute, then plug back in.
2. Check for excessive dust build up and clean accordingly.

# Troubleshooting

**Note:** If your fan experiences any of the following problems, stop using the fan immediately, unplug from the wall outlet and contact the LivePure Customer Service Center toll-free (USA & Canada): 888-855-5426 OR see your warranty.

1. After connecting to power supply and turning on, the fan still does not operate
2. Abnormal noise is observed during operation
3. Moving the power cord stops operation
4. Fan rotates slowly or irregularly
5. Burning smell is observed
6. Motor, plug or power cord become abnormally hot

**WARNING: DO NOT** attempt to take apart the unit by yourself. Doing so may void your warranty and cause damage to the product or personal injury.

## Customer Support

If you need any assistance with setup, operation, or parts for your new LivePure® Fan, please call us. Our technical support staff is ready to help! Hours of operation are from 8:00 AM to 6:00 PM EST.

Telephone:

**USA/Canada: 888-855-5426**

Email:

**info@livepureshop.com**

Online Chat:

**www.livepureshop.com**

# Warranty

The LivePure® company, Inc. makes the following warranty to the original residential user or consumer purchaser of the Orbital Oscillating Fan. If any part of the Orbital Oscillating Fan fails during the first 3 (three) years from the date of purchase due to a defect in material or workmanship, we will provide a replacement part free of charge. If no replacement part can be provided, we will replace your fan.

IF THE ORIGINAL RESIDENTIAL USER OR CONSUMER PURCHASER CEASES TO OWN THE ORBITAL OSCILLATING FAN, THIS WARRANTY AND ANY IMPLIED WARRANTY WHICH THEN REMAINS IN EFFECT, INCLUDING BUT NOT LIMITED TO ANY IMPLIED WARRANTY OF MERCHANTABILITY OR FITNESS FOR A PARTICULAR PURPOSE, ARE VOIDED. THIS WARRANTY IS IN LIEU OF ALL OTHER EXPRESS WARRANTIES. THE DURATION OF ANY IMPLIED WARRANTY, INCLUDING BUT NOT LIMITED TO ANY IMPLIED WARRANTY OF MERCHANTABILITY OR FITNESS FOR A PARTICULAR PURPOSE IS EXPRESSLY LIMITED TO THE PERIOD OF THE EXPRESS WARRANTY SET FORTH ABOVE.

This warranty is voided if your Orbital Oscillating Fan is not purchased and used in the USA or Canada. This warranty excludes and does not cover defects, malfunctions, or failures of the fan which were caused by repairs by persons not authorized by us, use of parts, or accessories not authorized by us, mishandling, modifications, or damage to the fan while in your possession, or unreasonable use, including failure to provide reasonable and necessary maintenance. This warranty does not cover fans used in commercial applications. There are no express or implied warranties as to commercial purchasers or users.

To obtain service, contact LivePure® Customer Service at 888-855-5426. You will be responsible for insurance and freight or other transportation to our factory service center. We will return the fan freight prepaid. The fan should be properly packaged to avoid damage in transit since we will not be responsible for any such damage. Proof of purchase is required when requesting warranty service. The purchaser must present sales receipt or other document that establishes proof of purchase.



# Warranty

IN NO EVENT SHALL LIVEPURE COMPANY BE LIABLE FOR DIRECT, INDIRECT, SPECIAL, CONSEQUENTIAL OR INCIDENTAL DAMAGES IN EXCESS OF THE PURCHASE PRICE OF THE FAN. YOUR SOLE REMEDY WILL BE REPAIR OR REPLACEMENT AS PROVIDED ABOVE. SOME AMERICAN STATES AND CANADIAN PROVINCES DO NOT ALLOW:

LIMITATIONS ON HOW LONG AN IMPLIED WARRANTY LASTS; THE EXCLUSION OR LIMITATION OF DIRECT, INDIRECT, SPECIAL, INCIDENTAL OR CONSEQUENTIAL DAMAGES; THE EXCLUSION OR INVALIDITY OF EXPRESS OR IMPLIED WARRANTIES IF THE USER CEASES TO OWN THE FAN; THE LIMITATION OF THE REMEDIES AND RECOURSES AVAILABLE TO THE PURCHASER; OR THE INVALIDITY OF AN EXPRESS WARRANTY WHEN A PRODUCT IDENTIFIED BY BRAND NAME IS NOT USED (UNLESS SPECIFIC CONDITIONS ARE FULFILLED);

SO THE ABOVE LIMITATIONS OR EXCLUSIONS MAY NOT APPLY TO YOU. THIS WARRANTY GIVES YOU SPECIFIC LEGAL RIGHTS AND YOU MAY ALSO HAVE OTHER RIGHTS WHICH VARY FROM STATE TO STATE OR PROVINCE TO PROVINCE.