

GT3 compared to GTS (exploded
view)

The PCBA components are changed but the size of PCBA is the same as before.



**Everything else is the same.
For part detail names refer to
the next page from GTS
exploded view.**

The Chassis Bottom covers Left and Right are removed

The Chassis Bottom is redesigned

Zeus Arc GTS

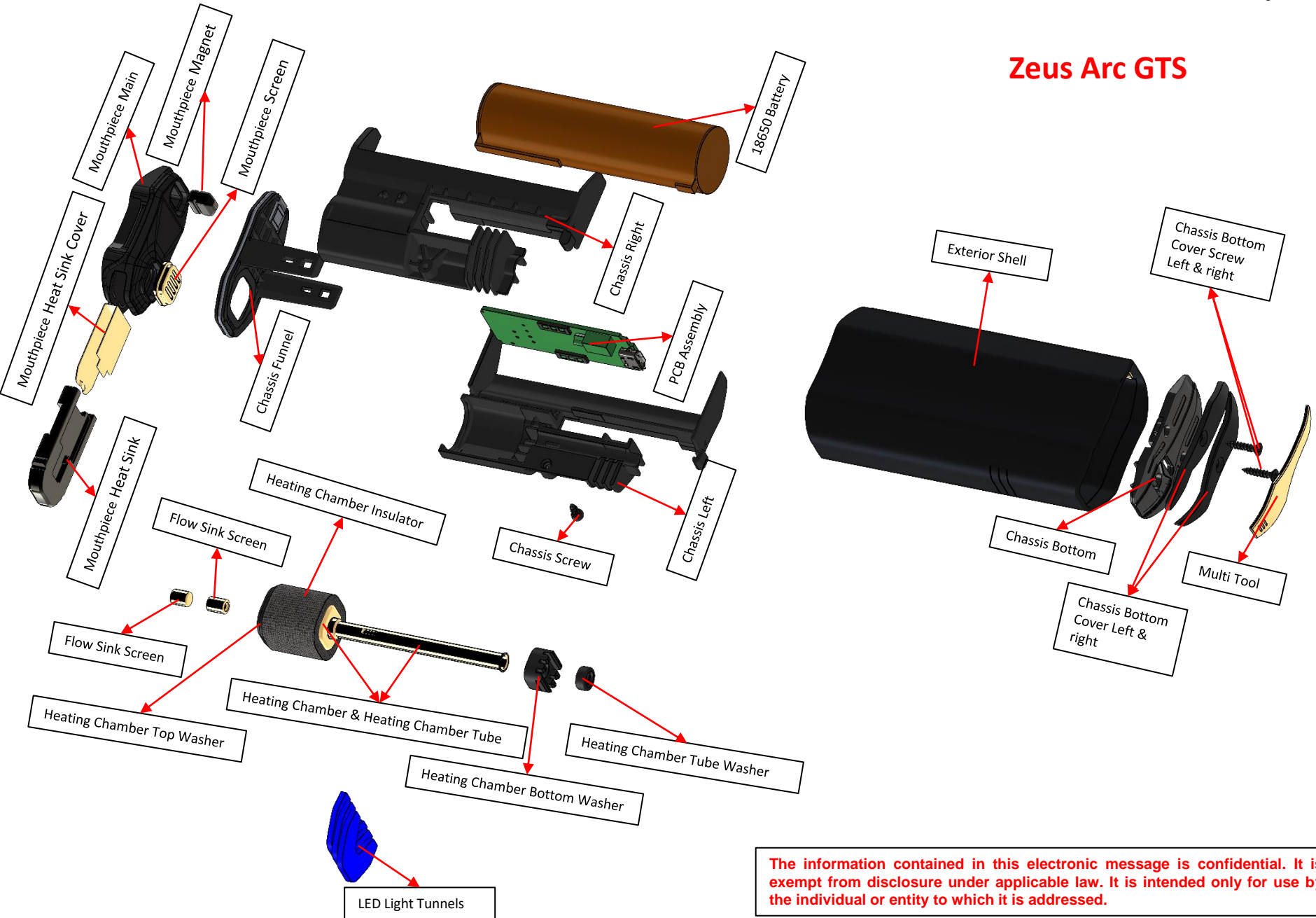

The information contained in this electronic message is confidential. It is exempt from disclosure under applicable law. It is intended only for use by the individual or entity to which it is addressed.