

Part Number	Description	Part Included
F60202	AXLE,TRACE,J-BEND,FRONT,15x110	C
F60123	BEARING,18X30,CN,AM	B
F60199	ENDCAP,SET,TRACE,J-BEND,FRONT,15x110	A, A
F60185	BEARING,DRIFT,KIT,VAULT,F+R,AM	NOT SHOWN

NOTES:

1. See raceface.com for service and repair instructional videos
2. F60185 BEARING,DRIFT,KIT,VAULT,F+R,AM required for bearing service
3. Remove end caps by hand, if tight try using a rubber glove or blind bearing puller tool
4. Always install rotor side bearing first
5. End cap are the same for both ends of the hub
6. Lube outside facing bearing seals and end cap seals with light grease

V1.0 10/6/2020

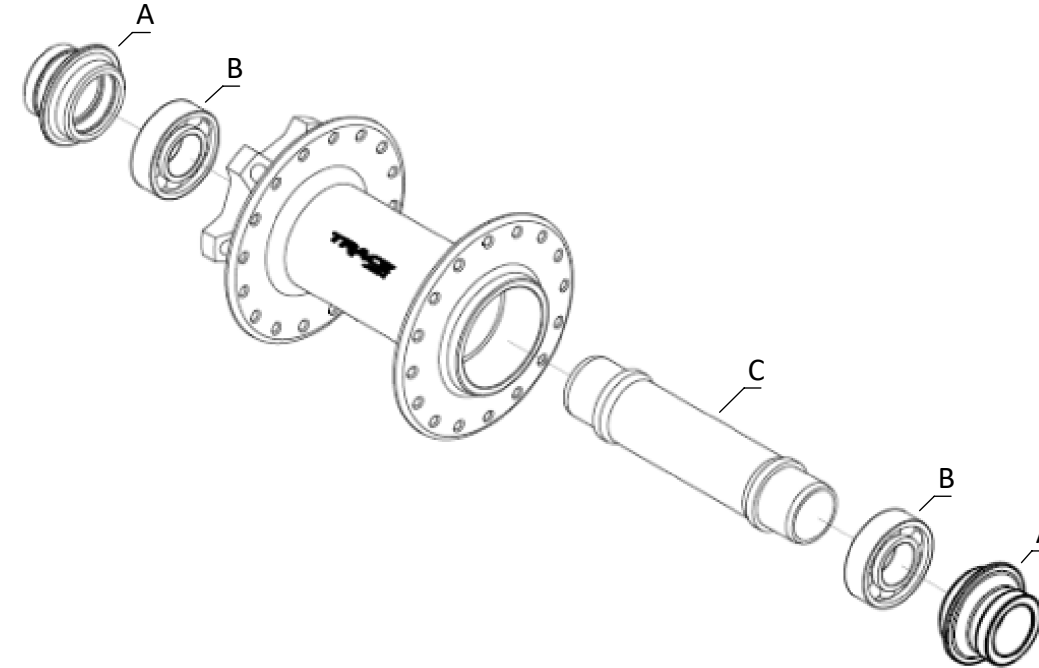

REVISIONS				This document contains proprietary information belonging to Race Face / Easton Cycling.	SYMBOLS	DIMENSIONS ARE IN MILLIMETERS. INTERPRET DIMENSIONS AND TOLERANCES PER ANSI/ASME Y14.5M. UNLESS OTHERWISE SPECIFIED, TOLERANCES ARE:	THIRD ANGLE PROJECTION	RACEFACE EASTON CYCLING			
REV.	DATE	DESCRIPTION	DRAWING BY					915 Disc Drive Scotts Valley, CA 95066 USA	FOX FACTORY INC. TAIWAN BRANCH No.8, Jingke 6th Rd., Nantun Dist., Taichung City 408, Taiwan (R.O.C.)	#209 - 8327 East Lake Dr. Burnaby, BC V5A 4W2 Canada	DESCRIPTION: HUB ASSEMBLY; J6XX; TRACE J-BEND; SPARE PARTS DRAWING
A	10/13/2020	RELEASE	TCC	This information may not be disclosed to others for any purpose nor used for manufacturing purposes without express written permission from Race Face / Easton Cycling	# BOM ITEM (X)XX.X±X CRITICAL DIMENSION Used for First Article Inspection & Process Control	DIMENSION	--- TOLERANCE ---	(degrees)	DWG. SIZE: B	ID # OF REFERENCED PART / ASSEMBLY: 10039180	REV: A
					△ REVISION CHANGE XX.X±X STANDARD DIMENSION Used for First Article Inspection	X	+/- 1.0	+/- 0.039	+/- 0.5	SCALE: 1:1	
				# CROSS REFERENCE TO A NOTE (XX.X) REFERENCE DIMANSION For reference only Measurements not needed	X.X	+/- 0.50	+/- 0.020	+/- 0.5	SHEET: 1 of 2		
					X.XX	+/- 0.10	+/- 0.004	+/- 0.5			
					X.XXX	+/- 0.05	+/- 0.002	+/- 0.5			

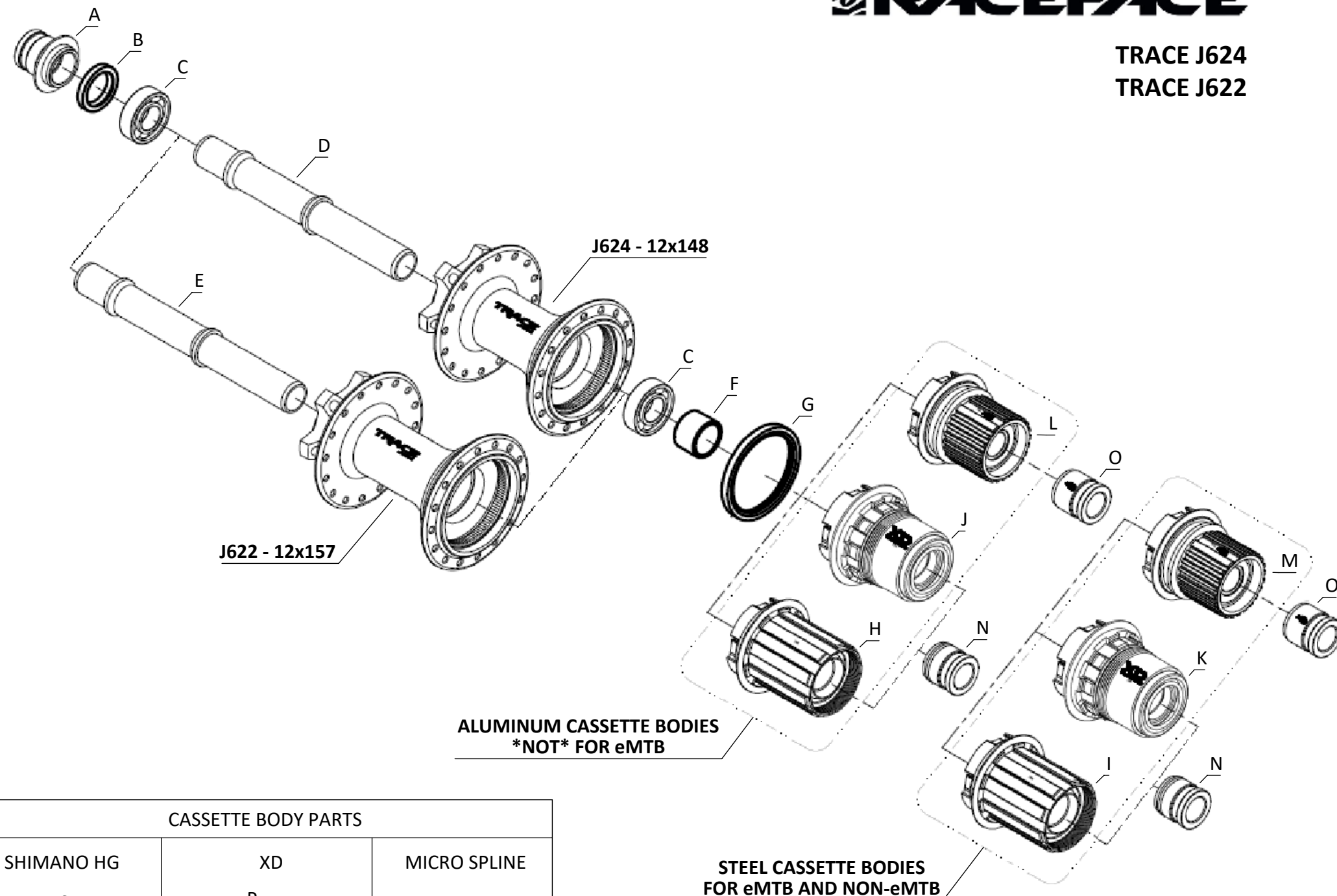

Part Number	Description	Part Included
F60200	AXLE,TRACE,J-BEND,REAR,12x148	D
F60201	AXLE,TRACE,J-BEND,REAR,12x157	E
F60078	BEARING,6902 CM	C
F60196	ENDCAP,SET,TRACE,J-BEND,REAR,12x148/157	A, N, O
F60203	SPACER,TRACE,J-BEND,CASSETTE BODY	F
F60204	SEAL,TRACE,J-BEND,CASSETTE BODY,NDS	G, B, Q
F60079	BEARING,15267 CM	P
F60146	BEARING,6802,2PCS	R
F60190	CASSETTE BODY,TRACE,J-BEND,MTN-HG,ALLOY	H
F60191	CASSETTE BODY,TRACE,J-BEND,MTN-HG,STEEL	I
F60192	CASSETTE BODY,TRACE,J-BEND,XD,ALLOY	J
F60193	CASSETTE BODY,TRACE,J-BEND,XD,STEEL	K
F60194	CASSETTE BODY,TRACE,J-BEND,MS,ALLOY	L
F60195	CASSETTE BODY,TRACE,J-BEND,MS,STEEL	M
F60185	BEARING,DRIFT,KIT,VAULT,F+R,AM	NOT SHOWN

* ONLY STEEL CASSETTE BODIES PERMITTED FOR eMTB USE *

NOTES:

- See raceface.com for service and repair instructional videos
- F60185 BEARING,DRIFT,KIT,VAULT,F+R,AM required for bearing service
- Remove end caps by hand, if tight try using a rubber glove or blind bearing puller tool
- Always install drive side bearing first
- Longer end cap install on rotor side
- See raceface.com for list of recommended lubricants
- Lube with light grease
 - Outside facing bearing seals
 - Inside lip of end cap seals
 - Drive ring and pawls
- Lube with light oil
 - Cassette Body Seal
- Lube with waterproof grease
 - Cassette / cassette body stop interface

CASSETTE BODY PARTS		
SHIMANO HG	XD	MICRO SPLINE

V1.0 10/6/2020

REVISIONS		DRAWING BY	This document contains proprietary information belonging to Race Face / Easton Cycling.	SYMBOLS	DIMENSIONS ARE IN MILLIMETERS. INTERPRET DIMENSIONS AND TOLERANCES PER ANSI/ASME Y14.5M. UNLESS OTHERWISE SPECIFIED, TOLERANCES ARE:	THIRD ANGLE PROJECTION	RACEFACE EASTON CYCLING	
REV.	DATE						DESCRIPTION	DESCRIPTION
-	-	-	This information may not be disclosed to others for any purpose nor used for manufacturing purposes without express written permission from Race Face / Easton Cycling	(#) BOM ITEM (XX.X±X) CRITICAL DIMENSION Used for First Article Inspection & Process Control Δ REVISION CHANGE XX.X±X STANDARD DIMENSION Used for First Article Inspection # CROSS REFERENCE TO A NOTE (XX.X) REFERENCE DIMANSION For reference only Measurements not needed	--- TOLERANCE --- DIMENSION [mm] [IN] [degrees] ANGLES X +/- 1.0 +/- 0.039 +/- 0.5 X.X +/- 0.50 +/- 0.020 +/- 0.5 X.XX +/- 0.10 +/- 0.004 +/- 0.5 X.XXX +/- 0.05 +/- 0.002 +/- 0.5	DWG. SIZE: B SCALE: 1:1 SHEET: 2 of 2	FOX FACTORY INC. TAIWAN BRANCH No.8, Jingke 6th Rd., Nantun Dist., Taichung City 408, Taiwan (R.O.C.) #209 - 8327 East Lake Dr. Burnaby, BC V5A 4W2 Canada DESCRIPTION: HUB ASSEMBLY; J6XX; TRACE J-BEND; SPARE PARTS DRAWING ID # OF REFERENCED PART / ASSEMBLY: 10039180 MATERIAL:	
See Sheet 1		-						REV: A