

HOW TO THREAD NEEDLES

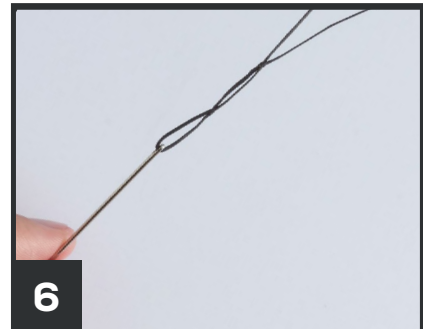
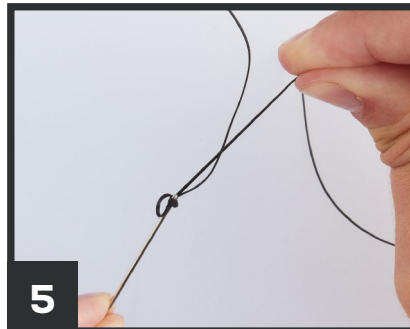
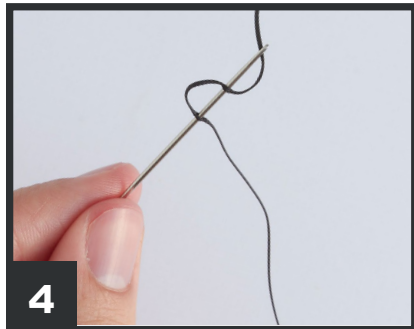
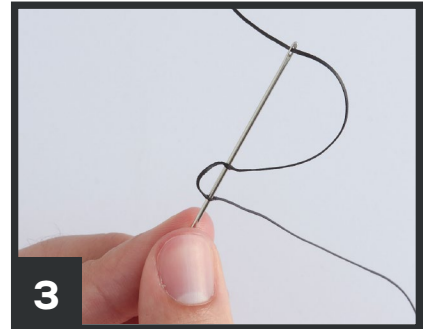
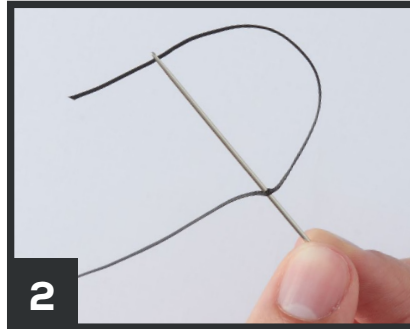
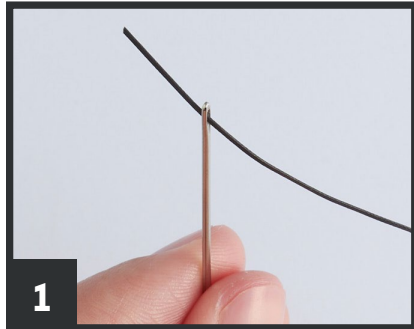

1. Cut your thread to 5 times the length of the stitch line.

2. Feed one end through the eye of one needle. (Figure 1)

3. Take the point of the needle and push it through the longer portion of the thread. Repeat and push needle through again. (Figures 2-3)

4. Pull long side of thread toward the eye of the needle to form a knot. (Figure 4-6)

5. Repeat steps 2-4 on the other side with other needle.