

BICYCLE WALL MOUNT INSTALLATION MANUAL

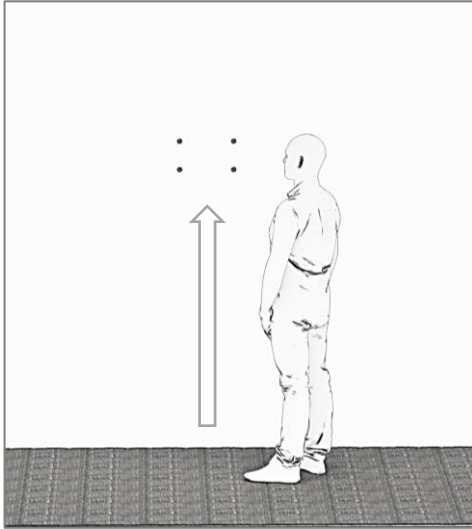

1. To determine the ideal height for your bicycle wall mount, use a marking pen to measure and mark a comfortable position based on your height and reach. Before drilling holes into the wall, make sure to check that the marks are level.

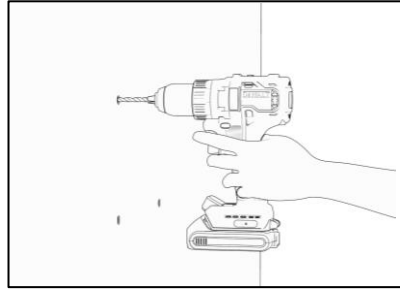

2. To securely install the bike mount, use a hand drill to drill $\varnothing 12\text{mm}$ holes where the M6 roll bolts will go. Once the holes are drilled, use a 10mm spanner or socket tool to fasten the roll bolts, which will cause the bolts to expand inside the wall and secure the mount in place. After this step, turn the M6 bolts counter-clockwise to loosen them, leaving the stud inside the wall.

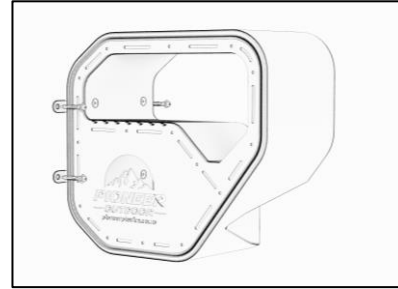

3. Hold the bike mount in position and fasten the roll bolts in the expanding sleeve and turn the bolt in a clockwise rotation to fasten the unit onto the wall

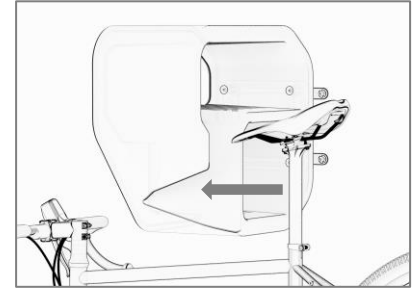

4. Mounting your bicycle: Use the saddle recess on the product and slide your saddle forward into it to secure your bike in place.

Storing your riding gear: Make use of the available compartment spaces to store your riding gear.

Tools Needed:

- Hand Drill
- $\varnothing 12\text{mm}$ Concrete drill bit
- 10mm Spanner or Socket Spanner Set

