

# Boblov X9 Body Worn Camera

User Setup Manual



## Product Precautions

### Table of Contents:

|  |    |
|--|----|
| <a href="#">Product Precautions</a>                | 1  |
| <a href="#">Product Specifications</a>             | 2  |
| <a href="#">Quick Operations - Recording</a>       | 3  |
| <a href="#">Quick Operations - File &amp; Edit</a> | 4  |
| <a href="#">Key Features</a>                       | 5  |
| <a href="#">Operation Instructions (Basics)</a>    | 6  |
| <a href="#">Operation Instructions (Basics)</a>    | 7  |
| <a href="#">Menu Options</a>                       | 8  |
| <a href="#">Menu Options</a>                       | 9  |
| <a href="#">Menu Options</a>                       | 10 |
| <a href="#">Menu Options</a>                       | 11 |
| <a href="#">Finding your Files on Windows</a>      | 12 |

- Keep product away from fire
- Keep product away from strong magnets
- Avoid water where possible
- Bodycamera.co.uk and Speak-IT do not take responsibility for any breach of data while using this product

## Product Specifications

|               | Specification                              |   |
|---------------|--|---|
| Video & Photo | Video Resolution (30fps)                   | 2560*1440p, 2304*1296p, 1920*1080p, 1440*1080p, 1280*720p, 848*480p |
|               | Camera Megapixel Resolution                | 12MP, 32MP, 36MP  |
| Dimensions    | Device Dimensions (Height x Width x Depth) | 70mm x 47mm x 26.3mm  |
|               | Screen Size                                | 1.5Inch TFT LCD-HD Colour Display                                   |
|               | Camera Angle                               | 140° Wide Angle Lens  |
| Storage       | Media Storage                              | 64GB SD Card Included (Up to 128GB Storage Space Available)         |
|               | Product Weight                             | 260 grams   |
| Battery       | Record Time                                | Up to 8 Hours   |
|               | Charge Time                                | 4 Hours   |

## Quick Operations - Recording

### Power Button

Press - Dark Mode  
Long Hold - Turn camera on/off

### Camera Button (📷)

Press - Take a photo  
Long Press - Toggle Flashing Lights

### Record Button (📹)

Press - Toggle Recording  
Long Hold - Toggle Resolution

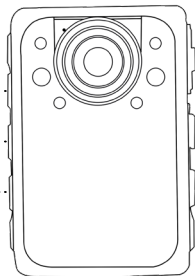

### Night Vision Button (🌑)

Press - Toggles Night Vision

## Quick Operations - File and Edit

### Menu Button (M)

Press - Access to camera settings

### OK Button

Acts as a confirm button when in M Menu  
OR press for access to recordings

### Audio Record Button (🎤)

Used as a back button when in M Menu

### Arrow Button (➤)

Used as a forward button in M Menu  
Used to play file

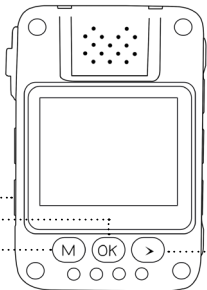

4

## Key Features

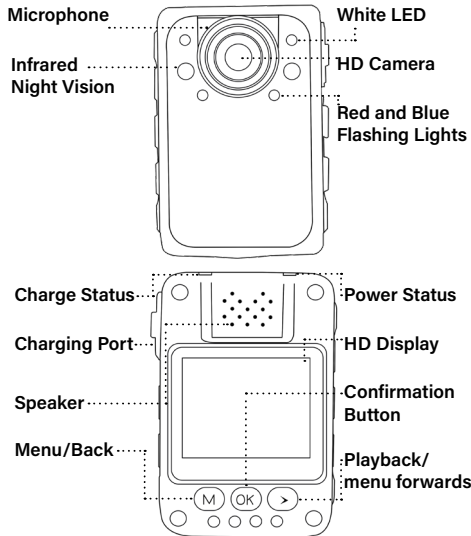

5

## Operating Instructions - Basics

### **Power**

Press and hold the power button for 4 seconds to turn on the body camera.

### **Record**

Press the record button to begin recording and press record again to end the recording.

### **Photo**

Press the camera button to take a picture.

### **Zoom**

Whilst recording, use the arrow and M buttons to zoom in/out.

### **One Click Record**

If you wish to quickly enter a recording state from an off state, hold the record icon for 4 seconds.

### **Infrared Night Vision**

Press the Sun icon on the side of the device to toggle infrared lighting.

## Operating Instructions - Basics

### **Quick Playback**

To play back files on the move, press the arrow button for easy access to the last files recorded on the device

### **Fast-forward/Rewind**

When re-watching footage, you can press the M or arrow buttons to fastforward or rewind in 2x, 4x or 8x speed.

### **File Selection**

When the camera is on and not recording, press the OK button to select a file type to playback (Audio, Video, Photo) then confirm with OK again and select a file.

### **Menu Selection**

Press the M button when the camera is on and not recording to access all customization settings for the bodycamera such as resolution, password protection etc.

## Menu Options

### **Video Resolution**

The Resolution of the video

### **Photo Size (Resolution)**

The Megapixel quality of photos

### **Video Quality**

Fast settings for low, medium and high

### **Continuous Shooting**

Burst Photo Mode for rapid image capture

### **Time Lapse Photo**

Set a 5 or 10 second photo timer

### **Timed Photographing**

Capture an image every 5 or 10 seconds

### **File Type**

Set a job description, E.G. Traffic Control

### **Loop Recording**

Automatically delete oldest stored data when memory becomes full

---

## Menu Options

### **Video Split Time**

Set a max record time for the video

### **Slide Show**

Filters through images in timed intervals

### **Motion Detection**

Detects motion on screen and records for 10 second intervals for every movement

### **Video Mute**

Mutes Video Files

### **Date Stamp**

Toggle a date/time stamp appearing on your footage

### **Auto Power Off**

Set a time until camera automatically turns off

### **Key Tone**

A toggleable noise made when pressing a key

---

## Menu Options

### Language

Language select

### Password Setting

Set a password

### Volume

Volume of key press

### Date/Time

Adjust Date/Time settings

### Format

Reformat the device (All files will be deleted)

### Default Settings

Reverts all settings back to the default

### Firmware

Displays latest firmware version

### Screen Save

Set a time before screen will turn black

## Menu Options

### Vibrate Warning

A vibration indicator which can be toggled

### LED

Can be toggled to turn off all LEDs

### ID Setting

Can be used to set a police number or machinery code



## Finding your Files on Windows

**Connect your body camera** via the USB cable provided whilst computer is on the desktop. **You should receive a prompt to 'choose what to do with this device'**

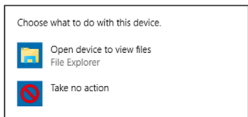

**Click 'Open device to view files!'** Here there will be three folders in which you can view all your files.

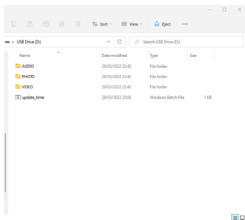

**Please note!** Mac is incompatible with this device

Thank you for taking the time to read this instruction manual for your new Boblov X9 body camera.

If you have any further questions, please feel free to call us on:  
0121 456 7800  
or email us at  
[sales@speakit.co.uk](mailto:sales@speakit.co.uk)