

PARTS

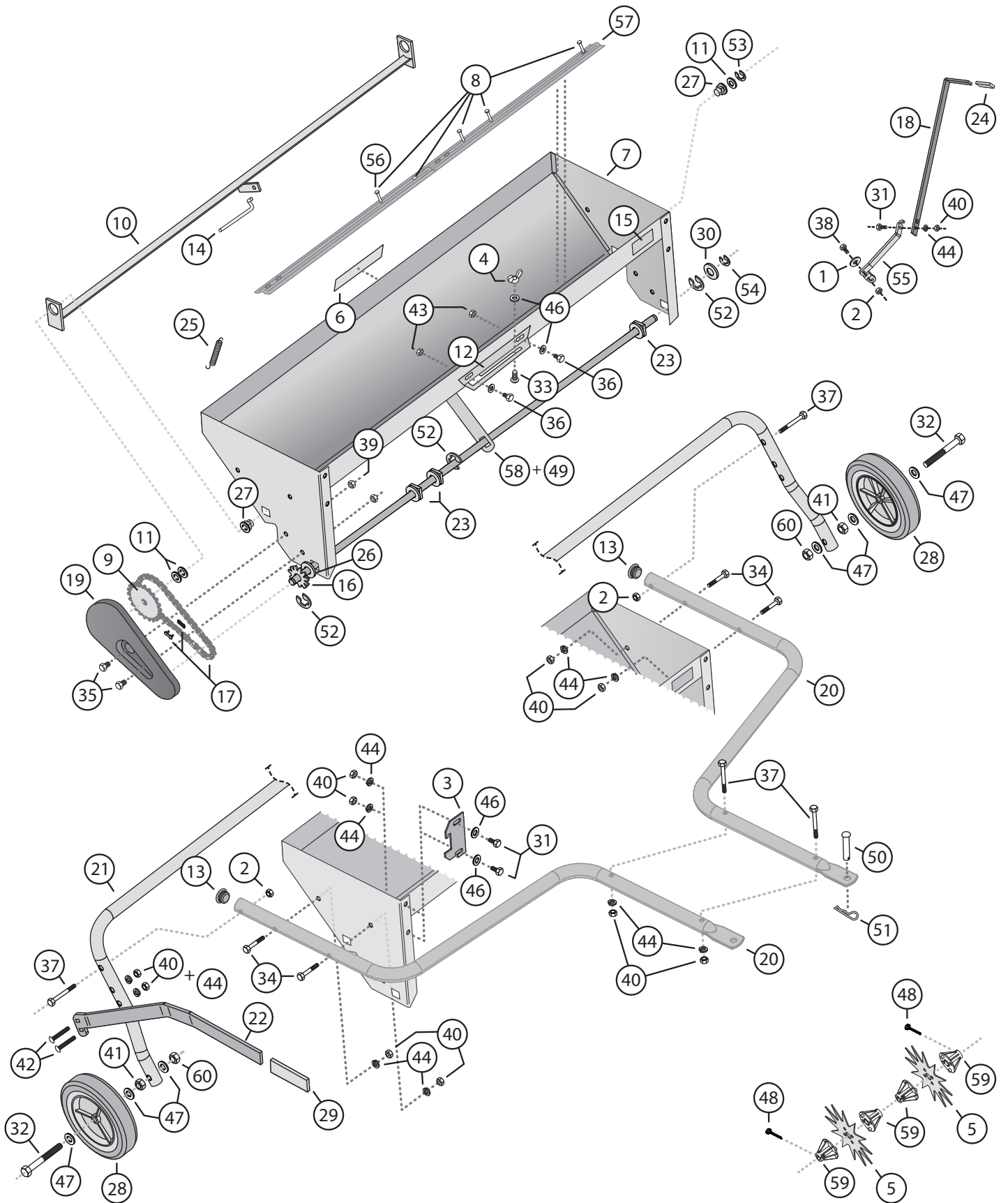

PARTS

AS-40BH

Ref #	Part #	Description	Qty
1	R-774	Flat Washer - Large	2
2	B-1674P	5/16" Hex Lock Nut	1
4	B-4030	1/4" Wing Nut	1
5	1018833	Aerator Tine	11
6	1008563	Brinly Logo Decal	1
7	B-5718-10	Hopper Assembly	1
8	K-654	Agitator Kit (Hwd. Incl.)	2
9	B-5720-10	Agitator Shaft Assembly	1
10	B-5726-10	Shutter Assembly	1
11	B-4713	1/2" Washer	3
12	B-4715Y	Calibration Plate	1
14	B-4719-01	Shutter Link	1
15	R-1946	Decal, Instruction w/ CE.	1
16	B-5722	Tine Shaft Assembly	1
17	B-4724-CPT	Drive Chain and Offset Link	1
18	B-6515-10	Upper Lever	1
19	B-4726	Chain Shield	1
20	B-6410-10	Tow Bar	2
21	B-6412-10	Wheel Support Assembly	1
22	B-6413-10	Lift Handle	1
23	B-4732	5/8" Square Bearing (Large)	3
25	B-4747	Tension Spring	1
26	B-4768	5/8" (Thin) Washer	3
27	F-383	1/2" Square Bearing (Small)	2
28	B-6526	Wheel	2
30	B-5456	5/8" (Thick) Washer	3
33	10M0808P	Carriage Bolt, 1/4" x 1/2"	1
35	2M0808P	Hex Bolt, 1/4" x 1/2"	2
36	2M1008P	Hex Bolt 5/16" x 1/2"	2
38	2M1016P	Hex Bolt 5/16" x 1"	1
39	B-4785	Lock Nut, 1/4"	2
43	B-4786	Lock Nut, 5/16"	2
46	45M1111P	Flat Washer, 5/16"	4
48	50M0524P	Cotter Pin, 5/32 x 1-1/2"	2

Ref #	Part #	Description	Qty
49	V-302P	Pop Rivet, 3/16" x .277	4
52	B-4307	"E" Ring, 1"	3
53	F-621	"E" Ring, 1/2"	1
54	F-577	"E" Ring, 5/8"	1
55	B-6414-10	Lower Lever	1
56	B-5804	Pop Rivet, 3/16" x .815	4
57	B-5461-10	Agitator	2
58	B-5680-10	Center Strap	1
59	B-5425	Bearing	22
60	B-5096Y	Nylon Lock Nut, 1/2" -13	2

HARDWARE PACK - Used during assembly:

Z-1762	SKIN PACK	1	
2	B-1674P	5/16" Hex Lock Nut	2
3	B-6520	Transport Lock	1
13	B-6484	Cap, Tube	2
24	B-4733	Vinyl Grip (1/8" x 3/4")	1
29	R-2435	Handle Grip (5/16" x 1-1/4")	1
31	2M1012P	Hex Bolt, 5/16" x 3/4"	3
32	B-6517	Hex Bolt, 1/2" x 3-1/2"	2
34	2M1032P	Hex Bolt, 5/16" x 2"	4
37	4M1048P	Hex Bolt, 5/16" x 3"	4
40	30M1000P	Hex Nut, 5/16"	11
**41	31M1600P	Hex Jam Nut, 1/2"	4
42	11M1028P	Carriage Bolt, 5/16" x 1-3/4"	2
44	40M1000P	Lock Washer, 5/16"	11
**45	40M1600P	Lock Washer, 1/2"	2
46	45M1111P	Flat Washer, 5/16"	2
47	45M1717P	Flat Washer, 1/2"	6
50	B-3861	Drawbar Pin	1
51	D-146P	Hairpin Cotter	1

**** Part numbers 41 (Qty. 2) and 45 (Qty. 2) will be leftover after assembly and not needed for this model.**

HARDWARE IDENTIFIER

Illustrations on this page are to scale for faster identification of hardware during assembly.

DO NOT RETURN PRODUCT IF YOU ARE MISSING PARTS.

Please Call: 1 (877) 728-8224

51 Hairpin Cotter (x1)
D-146P

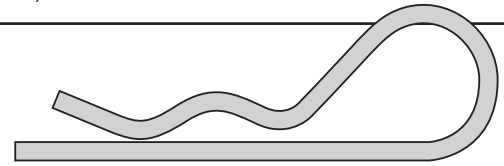

44 Washer: Lock
5/16" (x11)

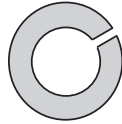

40M1000P

45 Washer: Lock
1/2" (x2)

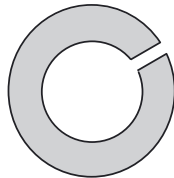

40M1600P

46 Washer: Flat
5/16" (x2)

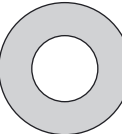

45M1111P

47 Washer: Flat
1/2" (x6)

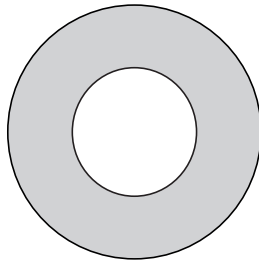

45M1717P

2 Nut: Hex Head Locking
5/16" -18 (x2)

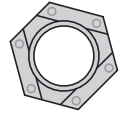

B-1674P

40 Nut: Hex Head
5/16" -18 (x11)

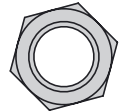

30M1000P

41 Nut: Hex Jam
1/2" (x4)

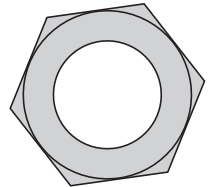

31M1600P

60 Nut: Nylon Lock
1/2" -30 (x2)

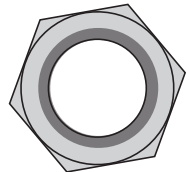

B-5096Y

31 Bolt: Hex Head,
5/16 x 3/4" (x3)

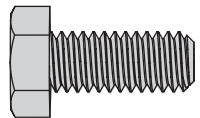

2M1012P

32 Bolt: Hex Head,
1/2" x 3 1/2" (x2)

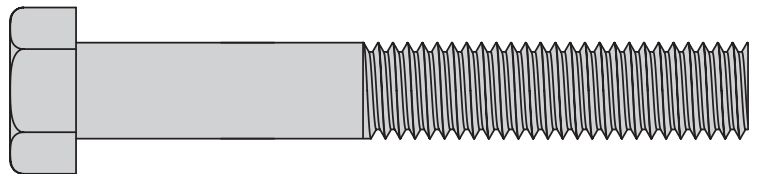

B-6517

34 Bolt: Hex Head 5/16 x 2" (x4)

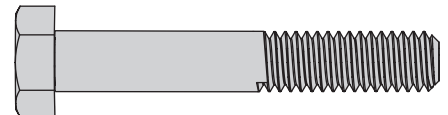

2M1032P

37 Bolt: Hex Head 5/16 x 3" (x4)



4M1048P

42 Bolt: Carriage 5/16 x 1-3/4" (x2)

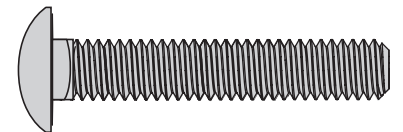

11M1028P

50 Drawbar Pin: 1/2" x 2 1/2" (x1)



B-3861