

# PART LIST

Ref.	Part #	Description	Qty.
1	1020336SER	Cart Bed; Poly RPC-10BH-A	1
4	1020374	Draw Bar; Poly Cart	1
6	B-4261	Axle, 3/4" x 34-3/4"	1
7	B-4599-10	Axle Support	1
8	1008575	Wheel; Pneumatic	2
9	1018697-10	Right Pivot Arm	1
10	1018698-10	Left Pivot Arm	1

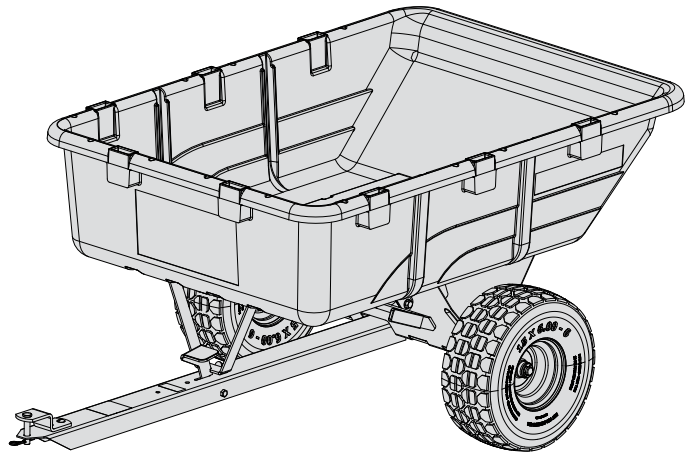

1019851		INNER PACK #1	
2	B-3520-10	Lock Bracket	1
3	1008604	Foot Pedal	1
5	B-3034-10	Clevis	1
N/A	Z-1737	Hardware Skin Pack <i>* illustrated on page 8</i>	1
21	40M1000P	- Washer; Lock, 5/16"	12
22	45M1111P	- Washer; Flat, 5/16"	10
24	B-5606	- Bushing; Machine	4
25	30M1000P	- Nut; Reg Hex, 5/16"-18	12
26	B-1675P	- Nut; Hex Lock, 3/8"-16	1
27	B-6299	- Nut; Keps Hex, 3/8-16	2
28	B-6298	- Bolt; Hex Head, 3/8 x 3-3/4	1
29	20M1016P	- Screw; Round Head Machine, 5/16" x 1"	12
30	B-4305	- E-Ring; Retaining, 3/4"	2
31	B-6300	- Spring; Latch	1
32	B-3861	- Pin; Hitch, 1/2" x 2-1/2"	1
33	D-146P	- Hairpin Cotter, 1/8"	1
<i>Extra parts in Skin Pack that are not needed:</i>			
	1007732	- Washer; Nylon	4
	R-618	- Washer; Special	2

1020347		INNER PACK #2	
11	1018681-10	Rocker Base	1
12	1018687-10	Axle Support Bracket	1
13	1018682-10	Rocker Motion Bracket	1
14	1018881	Rocker Handle	1
15	1018684-10	Rear Pivot Bracket	2
N/A	1020338	Hardware Bag <i>* illustrated on page 9</i>	1
21	40M1000P	- Washer; Lock, 5/16"	6
34	45M1313P	- Washer; Flat, 3/8"	2
25	30M1000P	- Nut; Reg Hex, 5/16"-18	6
35	B-4786	- Nut; Nylon Lock, 5/16"-18	2
36	B-4820	- Nut; Nylon Lock, 3/8"-16	4
37	11M1016P	- Bolt; Carriage, 5/16" x 1"	8
38	2M1220P	- Bolt; Hex Head, 3/8" x 1-1/4"	2
39	2M1248P	- Bolt; Hex Head, 3/8" x 3"	2
40	1001301	- Spinner Shaft Bushing, 3/8"	2
31	B-6300	- Spring; Latch	1
41	R-1882	- Grip; Flat	1

# EXPLODED VIEW (1 of 2)

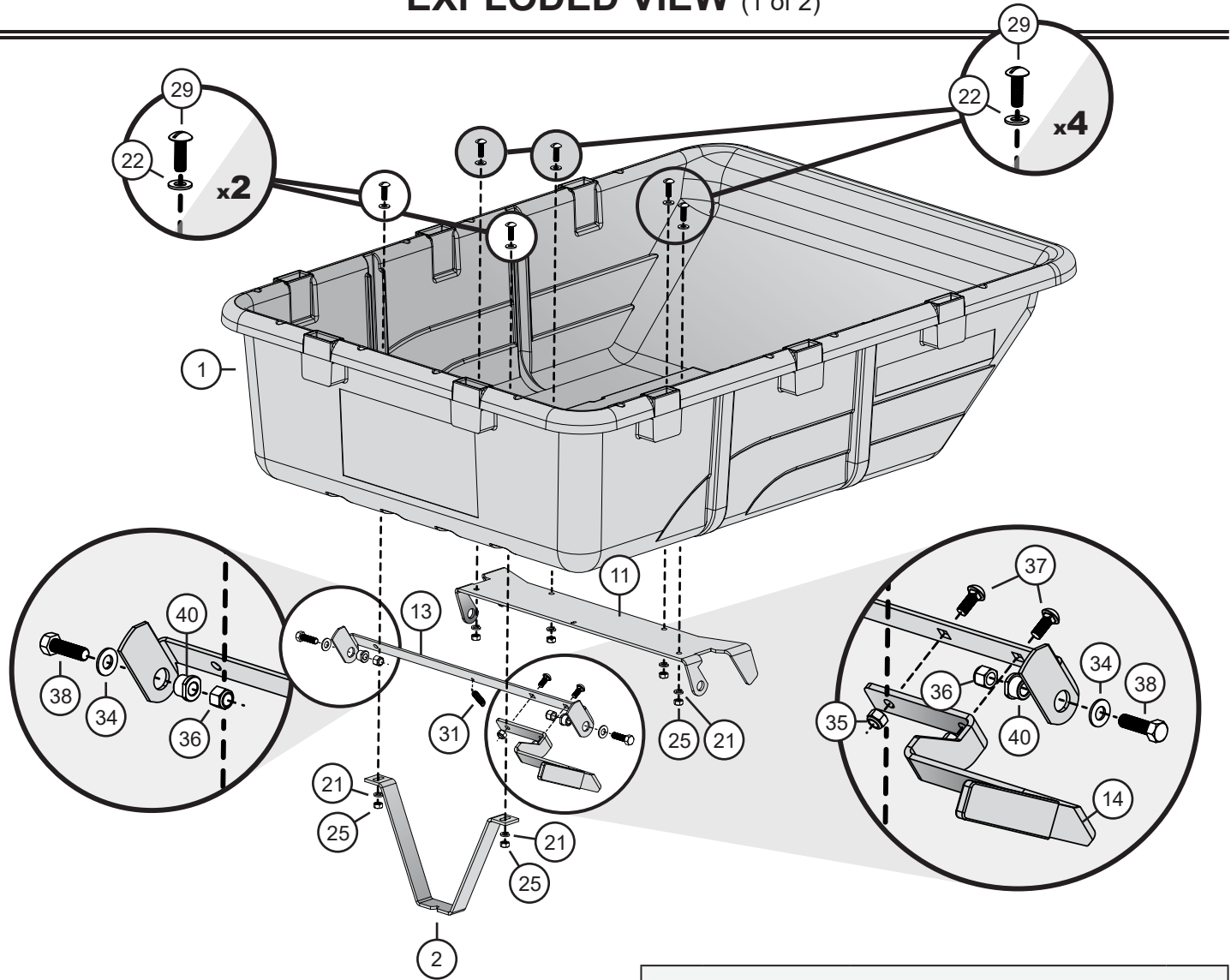

Ref.	Part #	Description	Qty.
1	1020336SER	Cart Bed; Poly RPC-10BH-A	1
4	1020374	Draw Bar; Poly Cart	1
6	B-4261	Axle, 3/4" x 34-3/4"	1
7	B-4599-10	Axle Support	1
8	1008575	Wheel; Pneumatic	2
9	1018697-10	Right Pivot Arm	1
10	1018698-10	Left Pivot Arm	1

1019851	INNER PACK #1	Qty.
2	B-3520-10 Lock Bracket	1
3	1008603 Foot Pedal	1
5	B-3034-10 Clevis, BIK.	1
N/A	Z-1737 Hardware Skin Pack * contents on page 5 * illustrated on page 8	1

1020347	INNER PACK #2	Qty.
11	1018681-10 Rocker Base	1
12	1018687-10 Axle Support Bracket	1
13	1018682-10 Rocker Motion Bracket	1
14	1018683-10 Rocker Handle	1
15	1018684-10 Rear Pivot Bracket	2
N/A	1020338 Hardware Bag * contents on page 5 * illustrated on page 9	1

# EXPLODED VIEW (2 of 2)

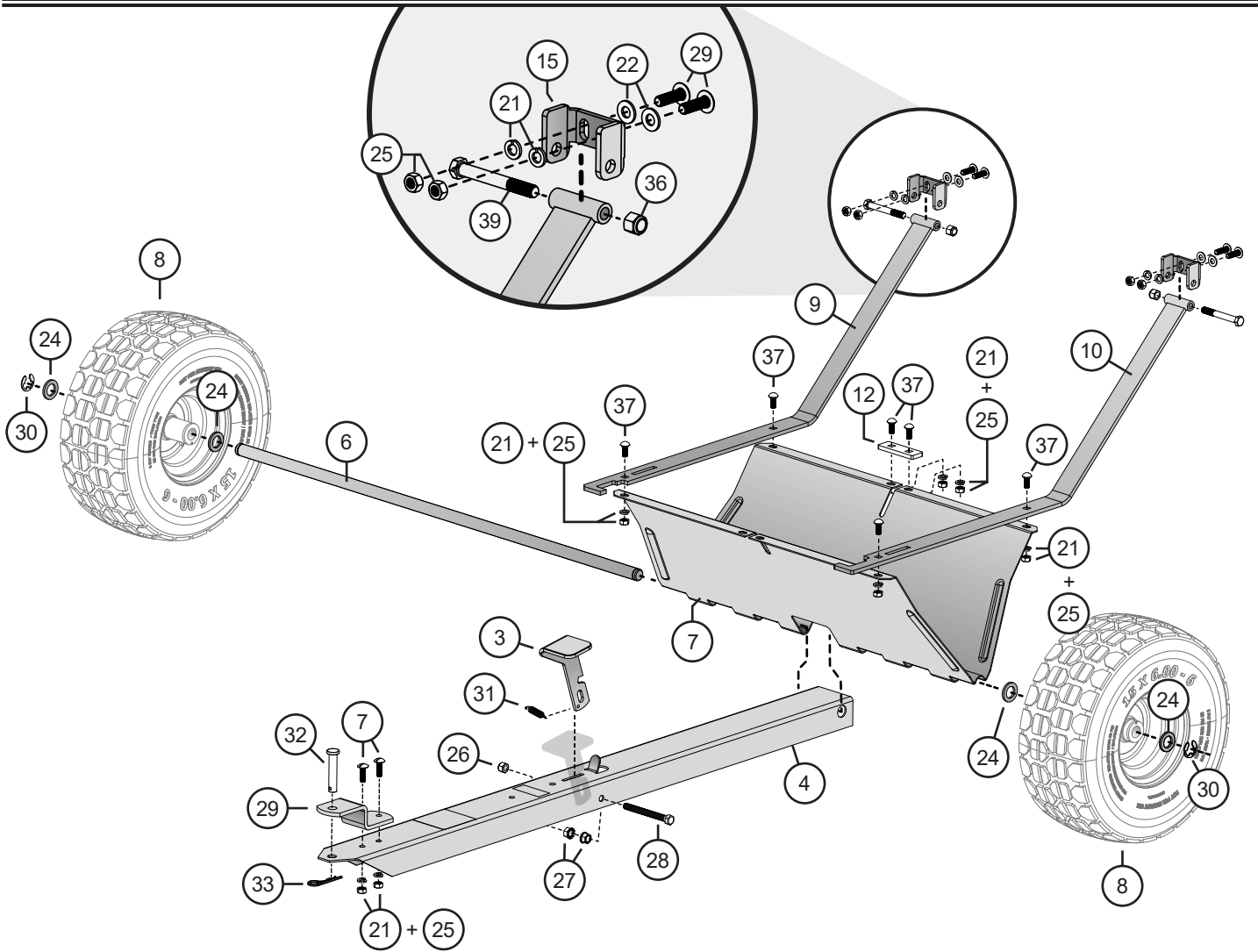

Ref.	Part #	Description	Qty.
1	1020336SER	Cart Bed; Poly RPC-10BH-A	1
4	1020374	Draw Bar; Poly Cart	1
6	B-4261	Axle, 3/4" x 34-3/4"	1
7	B-4599-10	Axle Support	1
8	1008575	Wheel; Pneumatic	2
9	1018697-10	Right Pivot Arm	1
10	1018698-10	Left Pivot Arm	1

1019851	INNER PACK #1		Qty.
2	B-3520-10	Lock Bracket	1
3	1008603	Foot Pedal	1
5	B-3034-10	Clevis, Blk.	1
N/A	Z-1737	Hardware Skin Pack * contents on page 5 * illustrated on page 8	1

1020347	INNER PACK #2		Qty.
11	1018681-10	Rocker Base	1
12	1018687-10	Axle Support Bracket	1
13	1018682-10	Rocker Motion Bracket	1
14	1018683-10	Rocker Handle	1
15	1018684-10	Rear Pivot Bracket	2
N/A	1020338	Hardware Bag * contents on page 5 * illustrated on page 9	1

# HARDWARE IDENTIFIER

Illustrations on this page are to scale for faster identification of hardware during assembly.

**DO NOT RETURN PRODUCT IF YOU ARE MISSING PARTS.**

Please Call: 1 (877) 728-8224

Contents of this page can be found in: **Hardware Skin Pack Z-1737** →

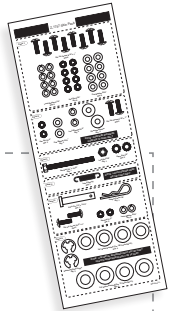

21 Washer: Lock  
5/16" (x12) .....  
**40M1000P**

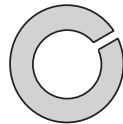

22 Washer: Flat  
5/16" (x10) .....  
**45M1111P**

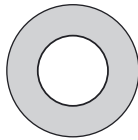

25 Nut: Hex Head  
5/16" -18 (x12) .....  
**30M1000P**



26 Nut: Lock  
3/8" -16 (x1) .....  
**B-1675P**



27 Nut: Keps  
3/8" (x2) .....  
**B-6299**

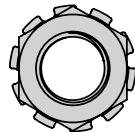

28 Bolt: Hex Head  
3/8 x 3 3/4" (x1) .....  
**B-6298**

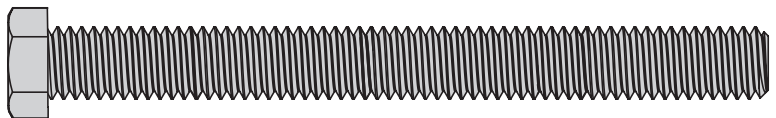

29 Screw: Round Head  
5/16 x 1" (x12) .....  
**20M1016P**

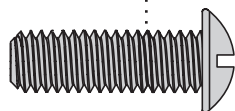

24 Machine  
Bushing (x4) .....  
**B-5606**

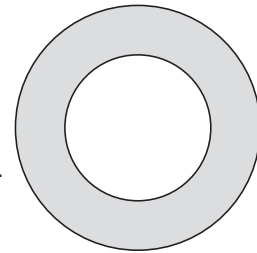

30 Retaining Ring, E  
3/4" (x2) .....  
**B-4305**

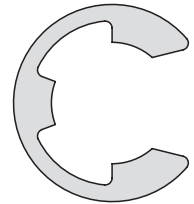

31 Spring, Latch (x1)  
**B-6300**

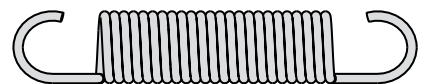

33 Hairpin Cotter, 1/8" (x1)  
**D-146P**

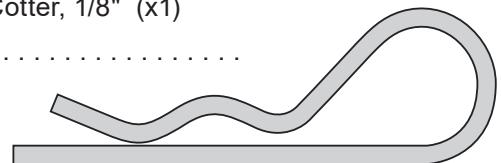

32 Hitch Pin;  
1/2" x 2 1/2" (x1) .....  
**B-3861**

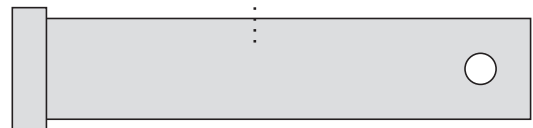

## EXTRA PARTS:

**A few extra parts will be leftover that are not used on this model.**  
( 3/4" Nylon Washer - Qty. 4 ) and ( 3/8" Special Washer - Qty. 2 )

# HARDWARE IDENTIFIER

Illustrations on this page are to scale for faster identification of hardware during assembly.

**DO NOT RETURN PRODUCT IF YOU ARE MISSING PARTS.**  
Please Call: 1 (877) 728-8224

Contents of this page can be found in: **Hardware Bag 1020338**

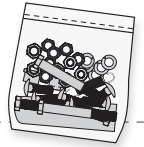

**25** Nut: Hex Head  
5/16" (x6) .....  
**30M1000P**



**35** Nut: Nylon Lock  
5/16" (x2) .....  
**B-4786**

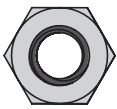

**36** Nut: Nylon Lock  
3/8" (x4) .....  
**B-4820**

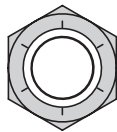

**31** Spring (x1) .....  
**B-6300**

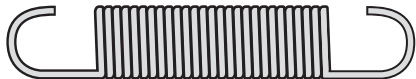

**21** Washer: Lock  
5/16" (x6) .....  
**40M1000P**

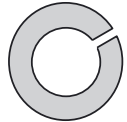

**34** Washer: Flat  
3/8" (x2) .....  
**45M1313P**

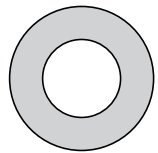

 Exterior circumferences of the washers can vary. These dimensions are a measurement of the internal diameter of the washer.

**40** Bushing; Hex Head  
3/8" x 1/2" (x2) .....  
**1001301**



**37** Bolt; Carriage  
5/16 x 1" (x8) .....  
**11M1016P**

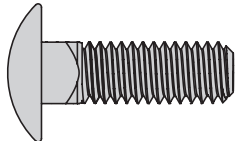

**38** Bolt; Hex Head  
3/8 x 1 1/4" (x2) .....  
**2M1220P**

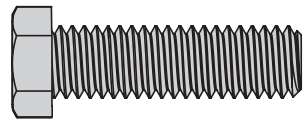

**39** Bolt: Hex Head 3/8 x 3" (x2) .....  
**2M1248P**



**41** Grip: Flat  
( for Handle )  
(x1) .....  
**R-1882**

