

PARTS

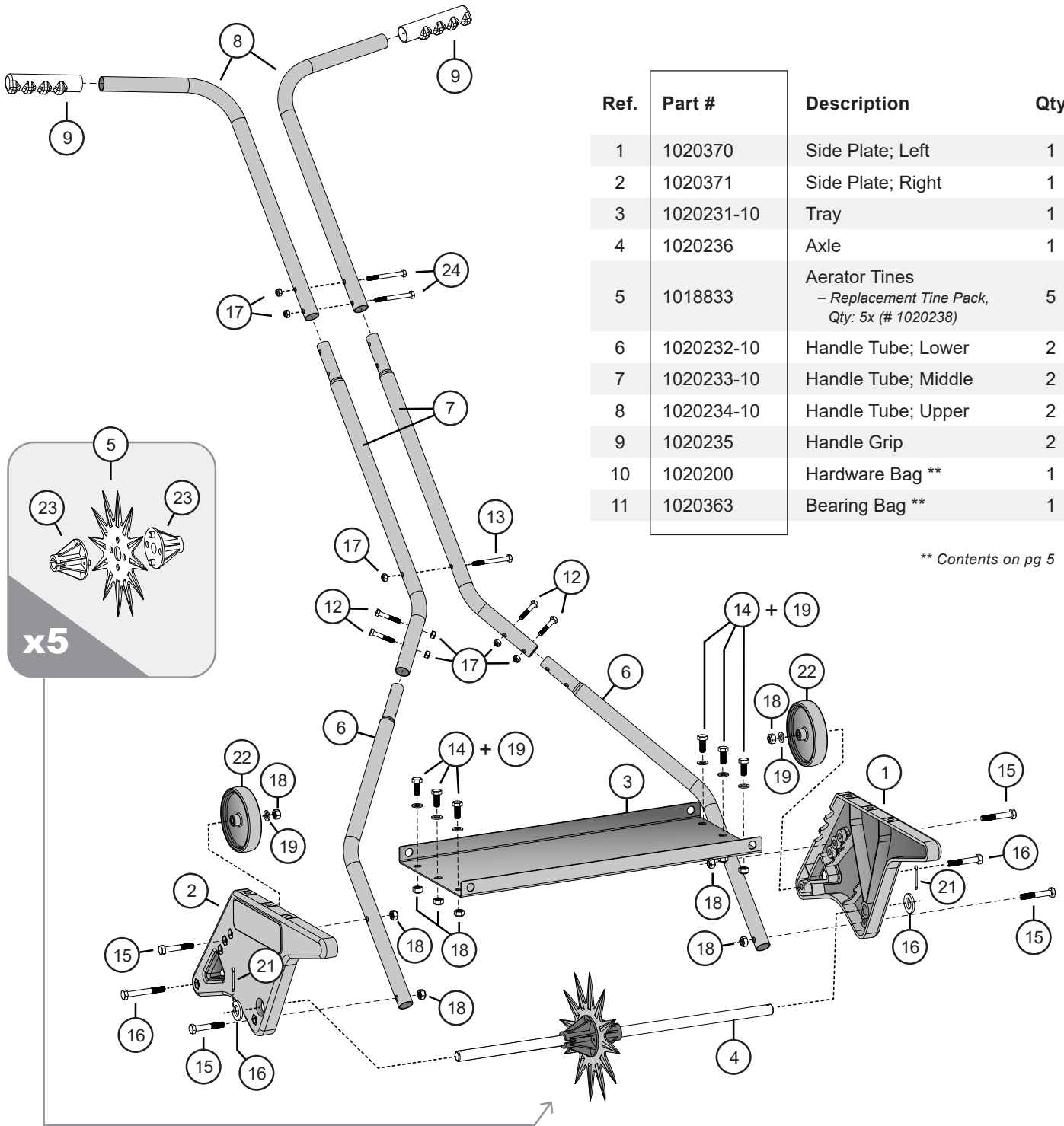

Ref.	Part #	Description	Qty
1	1020370	Side Plate; Left	1
2	1020371	Side Plate; Right	1
3	1020231-10	Tray	1
4	1020236	Axle	1
5	1018833	Aerator Tines - Replacement Tine Pack, Qty: 5x (# 1020238)	5
6	1020232-10	Handle Tube; Lower	2
7	1020233-10	Handle Tube; Middle	2
8	1020234-10	Handle Tube; Upper	2
9	1020235	Handle Grip	2
10	1020200	Hardware Bag **	1
11	1020363	Bearing Bag **	1

** Contents on pg 5

Installation Questions?
Missing Parts?
Replacement Parts?

DON'T GO BACK TO THE STORE!

Please call our Customer Service Department,
Toll Free: 877-728-8224 or customerservice@brinly.com

PARTS

Illustrations on this page are to scale for faster identification of hardware during assembly.

DO NOT RETURN PRODUCT IF YOU ARE MISSING PARTS.

Please Call: 1 (877) 728-8224

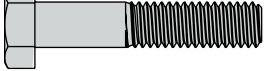
- 12 Bolt; Hex Head, M6 x 1.00 x 30 (x4) 

M06H10030P05
- 13 Bolt; Hex Head, M6 x 1.00 x 50 (x1) 

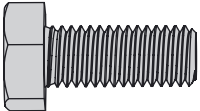
M06H10050P05
- 14 Bolt; Hex Head, M8 x 1.25 x 20 (x6) 

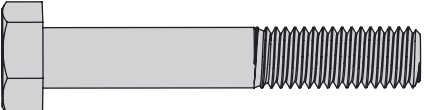
M08H12520P05
- 15 Bolt; Hex Head, M8 x 1.25 x 50 (x4) 

M08H12550P05
- 16 Bolt; Hex Head, M8 x 1.25 x 65 (x2) 

M08H12565P05
- 24 Bolt; Hex Head, M6 x 1.00 x 55 (x2) 

M06H10055P05

- 17 Locknut; Nylon, M6 x 1.00 (x7) 

M06N100P05

- 18 Locknut; Nylon, M8 x 1.25 (x12) 

M08N125P05

- 19 Washer; M8 (x8) 

M08P16016FL

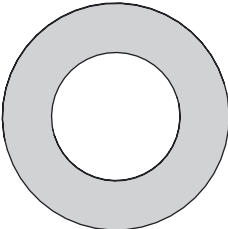
- 20 Washer; Flat, M16 (x6) 

M16P30030FW

- 21 Cotter Pin 3.5mm, (x2) 

M16P30030FW

Ref.	Part #	Description	Qty
10	1020200	Hardware Bag	1
12	M06H10030P05	Bolt; Hex Head, M6 x 1.00 x 30	4
13	M06H10050P05	Bolt; Hex Head, M6 x 1.00 x 50	1
14	M08H12520P05	Bolt; Hex Head, M8 x 1.25 x 20	6
15	M08H12550P05	Bolt; Hex Head, M8 x 1.25 x 50	4
16	M08H12565P05	Bolt; Hex Head, M8 x 1.25 x 65	2
17	M06N100P05	Locknut; Nylon, M6 x 1.00	7
18	M08N125P05	Locknut; Nylon, M8 x 1.25	12
19	M08P16016FL	Washer, M8	8
20	M16P30030FW	Washer; Flat, M16	6
21	1020239	Cotter Pin, 3.5mm	2
22	1020237	Wheel	2
24	M06H10055P05	Bolt; Hex Head, M6 x 1.00 x 55	2

11	1020363	Bearing Bag	1
23	B-5425	Bearing	10

EXTRA PARTS:

Four extra washers are provided, however, may not be needed after Step 2. (#20, Flat Washer; M16 - Qty. 4 Remaining)