

# SPECIFICATIONS

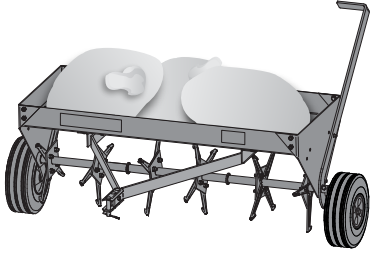

MODELS:  
**PA-403BH & PA-403BH-A**

Maximum Towing Speed ..... 5 MPH  
 Aerator Capacity ..... 150 lbs.  
 Empty Weight ..... 66 lbs.  
 Maximum Towing Weight ..... 216 lbs.  
 Type of Tire ..... Semi Pneumatic



Online Info + Video Links

 **150 lb**  
**WEIGHT**  
**CAPACITY**

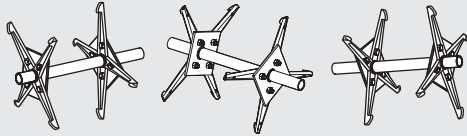

3 Sets of Tube Assemblies

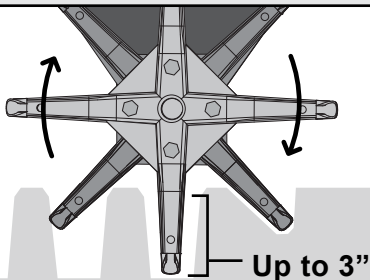

Aeration Depth ..... Up to 3"  
 Working Width ..... 40"

Assembly steps begin on page 7

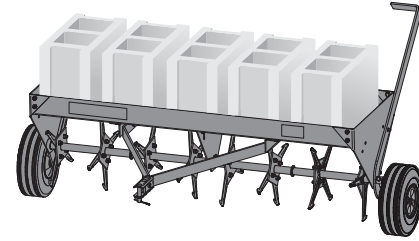

MODELS:  
**PA-482BH & PA-482BH-A**

Maximum Towing Speed ..... 5 MPH  
 Aerator Capacity ..... 200 lbs.  
 Empty Weight ..... 90 lbs.  
 Maximum Towing Weight ..... 290 lbs.  
 Type of Tire ..... Semi Pneumatic



Online Info + Video Links

 **200 lb**  
**WEIGHT**  
**CAPACITY**

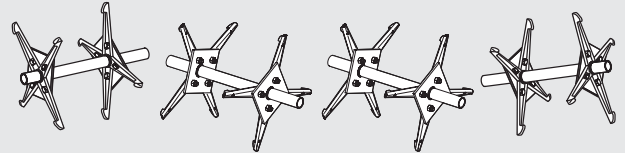

4 Sets of Tube Assemblies

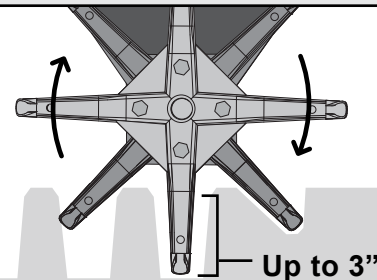

Aeration Depth ..... Up to 3"  
 Working Width ..... 48"  
 + Has a Center Support Plate

Assembly steps begin on page 16

# HARDWARE IDENTIFIER

Illustrations on this page are to scale for faster identification of hardware during assembly.

**DO NOT RETURN PRODUCT IF YOU ARE MISSING PARTS.**

Please Call: 1 (877) 728-8224

23 Washer: Lock  
5/8" .....  
**40M2000P**

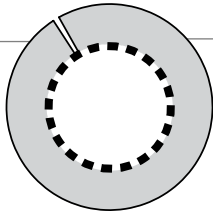

24 Washer: Flat  
5/16" .....  
**45M1111P**

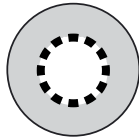

25 Washer:  
Flat  
5/8" .....  
**45M2121P**

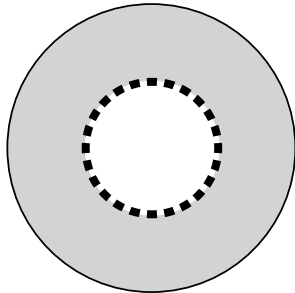

26 Bushing  
3/4" .....  
**B-676P**

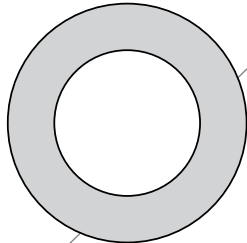

Exterior circumferences of washers can vary. These dimensions are a measurement of the internal diameter of the washer.



28 Nut: Hex Lock: 5/16" .....  
**B-1674P**



30 Nut: Hex Lock: 5/8" .....  
**30M2000P**

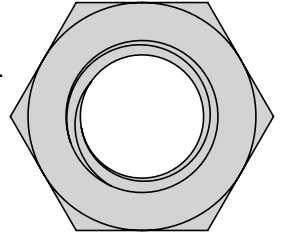

32 Nut: Nylon Lock: 5/16" .....  
**B-4786**



8 Bolt: Hex Head,  
5/16 x 1" .....  
**2M1016P**

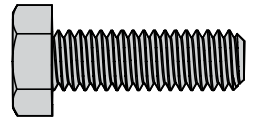

19 Bolt: Hex Head,  
5/16 x 1 1/2" .....  
**2M1024P**

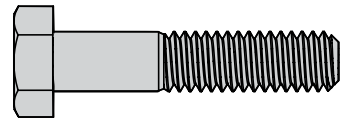

20 Bolt: Hex Head,  
5/16 x 3/4" .....  
**2M1012P**

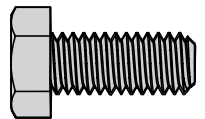

21 Bolt: Hex Head,  
5/16 x 1 1/4" .....  
**2M1020P**

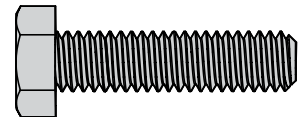

27 Transport Lock Pin .....  
**B-3307-S**

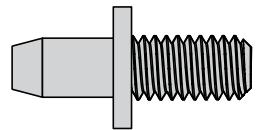

22 Bolt: Hex Head,  
5/8 x 4" .....  
**2M2064P**



29 Carriage Bolt:  
5/16 x 2 1/4" .....  
**11M1036P**

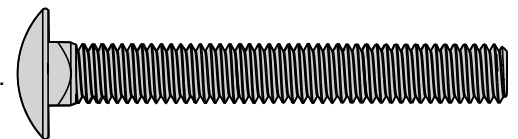

# PART IDENTIFIER

REF	DESCRIPTION
2	Clevis
5	Side Plate
6	Tray With Labels
7	Tow Bar
9	Plugging Spoon
10	Axle Assembly
11	Lift Handle Assembly
12	End Tube Assembly
13	Center Tube Assembly
14	Handle Grip
15	3/4" Nylon Bearing
16	Transport Wheel
31	Mount Bracket
33	Center Plate

PA-403BH PA-403BH-A	
PART NO.	QTY
R-892-10	2
B-4851-10	2
B-6173-BH	1
B-6259-10	2
B-4855-10	24
B-5700-10	1
B-5698-10	1
B-5309-10	2
B-5311-10	1
B-4867	1
B-4866	6
1009097	2
B-6171-10	2
N/A	N/A

PA-482BH PA-482BH-A	
PART NO.	QTY
R-892-10	2
B-4901-10	2
B-6257-BH	1
B-6259-10	2
B-4855-10	32
B-5702-10	1
B-5698-10	1
B-4862-10	2
B-4865-10	2
B-4867	1
B-4866	8
1009097	2
B-6258-10	2
B-4902-10	1

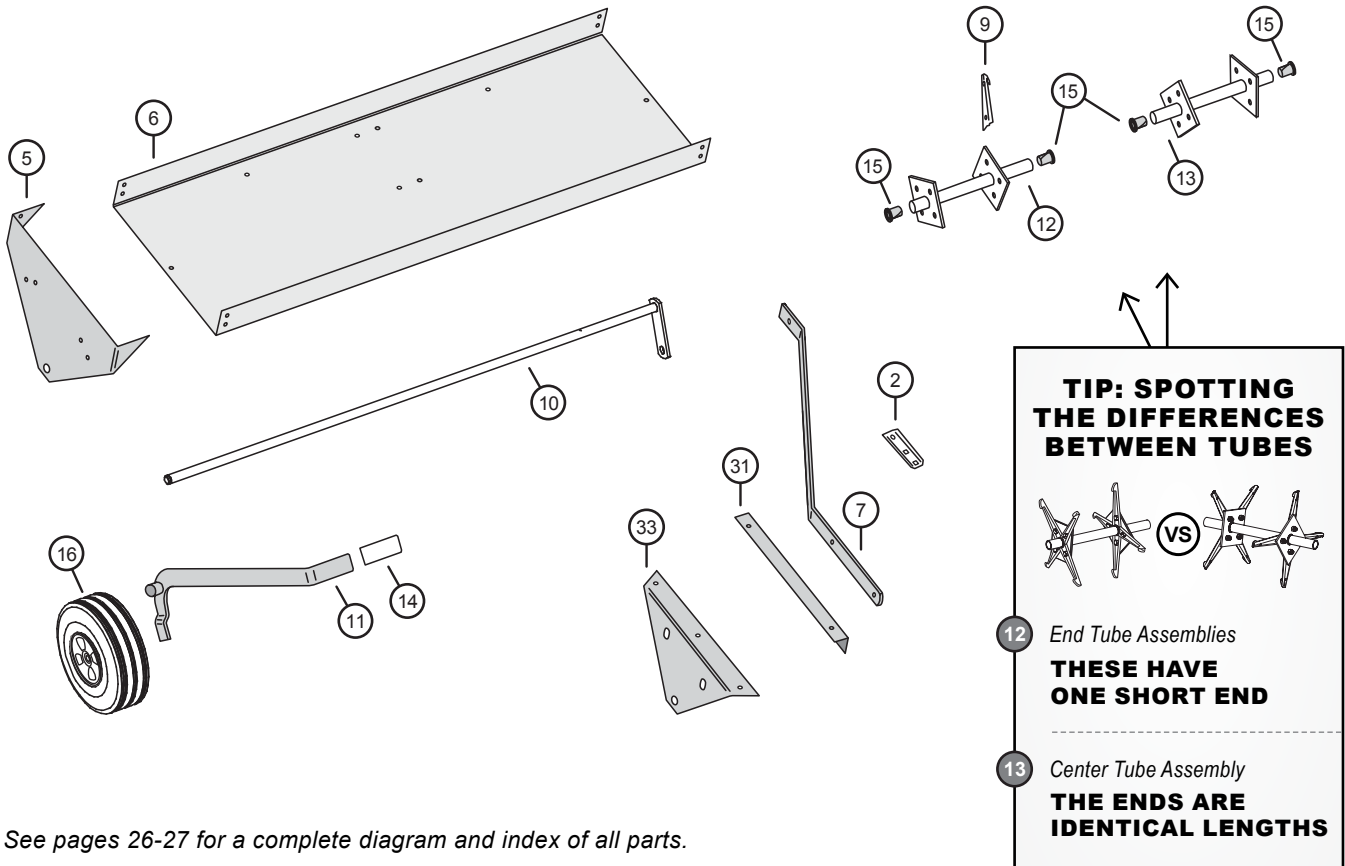

See pages 26-27 for a complete diagram and index of all parts.

# PART EXPLOSION

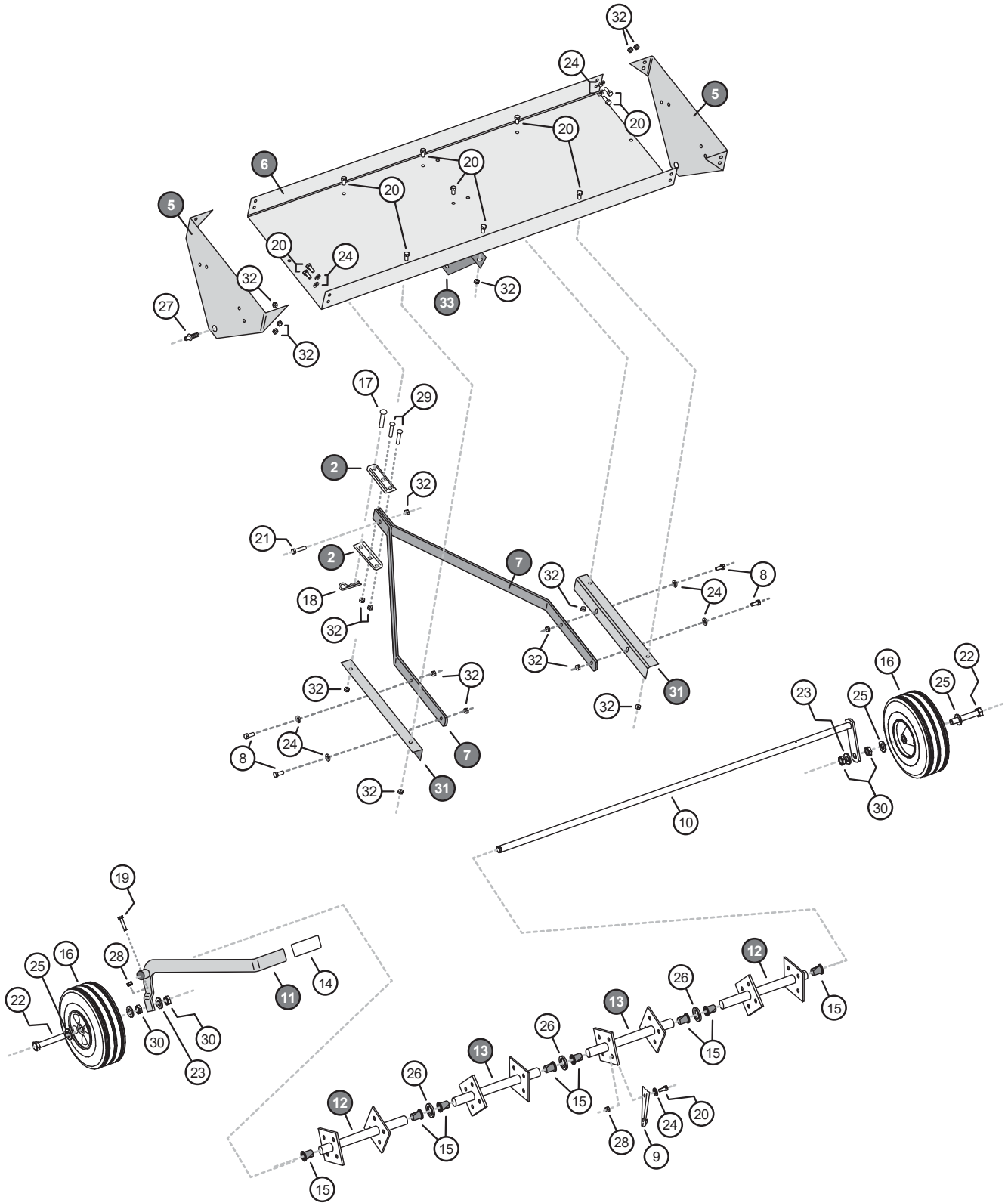

**INSTALLATION QUESTIONS? MISSING PARTS? NEED REPLACEMENT PARTS?**

**DON'T GO BACK TO THE STORE!**

Please call Customer Service Department Toll Free 877-728-8224 **OR** Email: [customerservice@brinly.com](mailto:customerservice@brinly.com)

REF	DESCRIPTION	PA-403BH PA-403BH-A		PA-482BH PA-482BH-A	
		PART NO.	QTY	PART NO.	QTY
16	Wheel	1009097	2	1009097	2
5	Side Plate	B-4851-10	2	B-4901-10	2
12	Tube Assembly, End	B-5309-10	2	B-4862-10	2
13	Tube Assembly, Center	B-5311-10	1	B-4865-10	2
11	Lift Handle Assembly	B-5698-10	1	B-5698-10	1
33	Center Plate	-	-	B-4902-10	1
31	Mount Bracket	B-6171-10	2	B-6258-10	2
6	Tray, with Labels	B-6173-BH	1	B-6257-BH	1
7	Tow Bar	B-6259-10	2	B-6259-10	2
10	Axle Assembly	B-5700-10	1	B-5702-10	1
	<b>Spoon Bag</b>	<b>Z-1530</b>	<b>1</b>	<b>Z-1547</b>	<b>1</b>
9	Plugging Spoons	B-4855-05	24	B-4855-05	32
	<b>&gt; Hardware Bag, Sub #1</b>	<b>Z-1530-A</b>	<b>1</b>	<b>1006813</b>	<b>1</b>
20	<i>Bolt; Hex Head, 5/16" x 3/4"</i>	<i>2M1012P</i>	25	<i>2M1012P</i>	33
28	<i>Nut; Lock, 5/16"-18</i>	<i>B-1674P</i>	25	<i>B-1674P</i>	33
24	<i>Washer; Flat, 5/16"</i>	<i>N/A</i>	<i>N/A</i>	<i>45M1111P</i>	33
	<b>Bearing Bag</b>	<b>Z-1531-A</b>	<b>1</b>	<b>Z-1548-A</b>	<b>1</b>
15	Bearing, Nyliner, 3/4"	B-4866	6	B-4866	8
	<b>Hardware Bag</b>	<b>Z-1712</b>	<b>1</b>	<b>Z-1726</b>	<b>1</b>
29	Bolt; Carrage, 5/16" x 2-1/4"	11M1036P	2	11M1036P	2
20	Bolt; Hex Head, 5/16" x 3/4"	-	-	2M1012P	15
8	Bolt; Hex Head, 5/16" x 1"	2M1016P	4	2M1016P	4
21	Bolt; Hex Head, 5/16" x 1-1/4"	2M1020P	1	2M1020P	1
19	Bolt; Hex Head, 5/16" x 1-1/2"	2M1024P	1	2M1024P	1
22	Bolt; Hex Head, 5/8" x 4"	2M2064P	2	2M2064P	2
30	Nut; Hex, 5/8"-11	30M2000P	4	30M2000P	4
32	Nut, Nylon Lock 5/16-18"	-	-	B-4786	24
23	Washer; Medium Lock, 5/8"	40M2000P	2	40M2000P	2
24	Washer; Flat, 5/16"	45M1111P	12	45M1111P	12
25	Washer; Flat, 5/8"	45M2121P	4	45M2121P	4
27	Pin; Transport Lock	B-3307-S	1	B-3307-S	1
17	Pin; Hitch, 1/2" x 2-1/2"	B-3861	1	-	-
14	Grip	B-4867	1	B-4867	1
26	Bushing, .765 ID x .250	B-676P	6	B-676P	6
18	Hairpin Cotter, 1/8", #211	D-146P	1	-	-
2	Clevis, Painted	R-892-10	2	-	-
	<b>&gt; Hardware Bag, Sub #2</b>	<b>Z-1712-A</b>	<b>1</b>	-	-
20	<i>Bolt, Hex Head, 5/16" x 3/4"</i>	<i>2M1012P</i>	12	-	-
32	<i>Nut, Nylon Lock 5/16-18"</i>	<i>B-4786</i>	21	-	-
	<b>Clevis Bag, for the PA-482BH</b>	-	-	<b>Z-1850</b>	<b>1</b>
2	Clevis, Painted	-	-	R-892-10	2
	<b>&gt; Inner Bag, Pin &amp; Cotter</b>	-	-	<b>Z-1369</b>	<b>1</b>
17	<i>Pin; Hitch, 1/2" x 2-1/2"</i>	-	-	<i>B-3861</i>	<i>1</i>
18	<i>Hairpin Cotter, 1/8", #211</i>	-	-	<i>D-146P</i>	<i>1</i>