

Angled Surface Mount Power and Data Stations

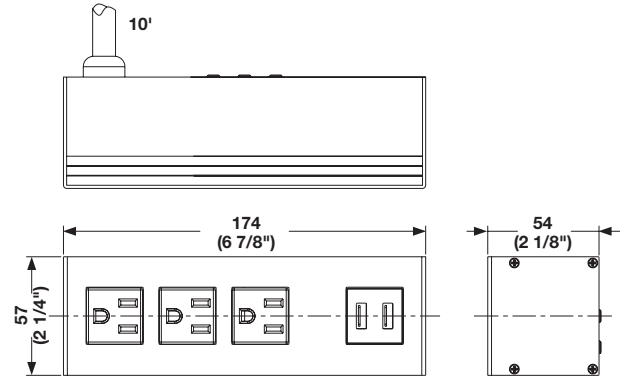
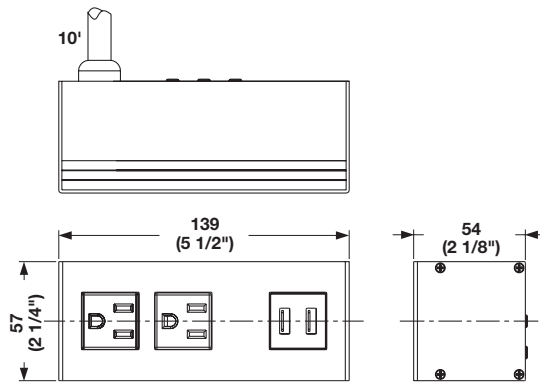
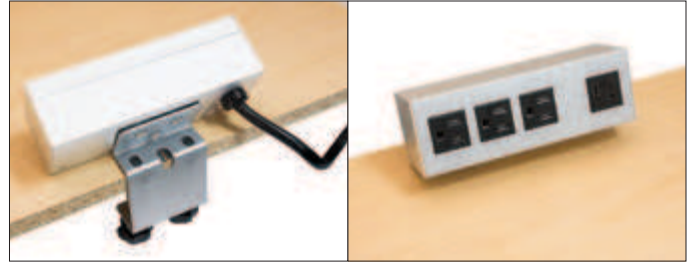

Dock 2110

- 2 tamper resistant grounded AC outlets, 125 V 15 A Max
- 2 USB ports 5 V DC 4.2 A
- Cord length 10'

Material: Housing, Aluminum, epoxy-coated

Finish	Item No.
black	822.09.370
white	822.09.770
silver	822.09.970

Note

Order Surface Mount Brackets separately below.

Dock 3110

- 3 tamper resistant grounded AC outlets, 125 V 15 A Max
- 2 USB ports 5 V DC 4.2 A
- Cord length 10'

Material: Housing, Aluminum, epoxy-coated

Finish	Item No.
black	822.09.371
white	822.09.771
silver	822.09.971

Note

Order Surface Mount Brackets separately below.

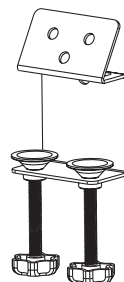
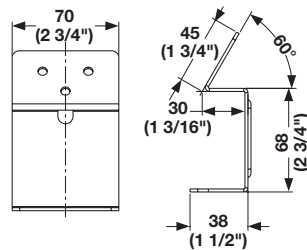

Angled Surface Mount Brackets

- Clamp mounts to desk
- Maximum clamping thickness: 50 mm (2")
- Includes bolts to attach power and data station above

Material: Aluminum

Finish	Item No.
black	822.09.372
white	822.09.772
silver	822.09.972

Dimensional data not binding. We reserve the right to alter specifications without notice.

Dimensions in mm
Inches are approximate