

Free Space 1.11

For standard application doors with handle

- For door heights up to 650 mm (26")
- Adjustments: Height/side/tilting angle and holding power
- Mounting: Screw mounts with pre-mounted Euro screw, door panel mounts without tools and slides onto pre-mounted screws

Material: Housing: Plastic; Mounting Bracket and Support Lever: Steel; Finish: nickel-plated

Model	Light gray	White	Anthracite
B	372.27.500	372.27.700	372.27.350
C	372.27.501	372.27.701	372.27.351
D	372.27.502	372.27.702	372.27.352
E	372.27.503	372.27.703	372.27.353
F	372.27.504	372.27.704	372.27.354

Supplied With 2 Fittings (right/left), 2 Mounting plates for door panel, 1 Set mounting instructions and paper drilling template

Note

- The choice of fitting depends on the cabinet height and door weight to include weight of handle.
- We recommend ordering the stronger fitting model if in doubt.

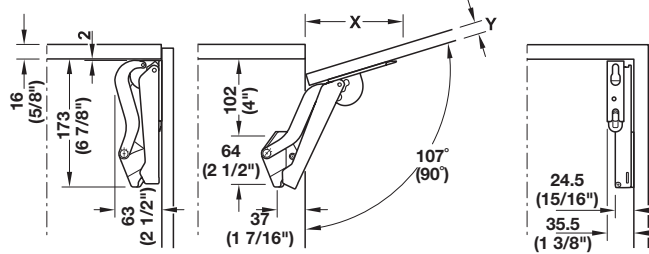

Front panel thickness Y	16 (5/8")	19 (3/4")	22 (7/8")	26 (1")
Distance X (with cabinet top panel thickness 16 mm)	117 (4 5/8")	107 (4 1/4")	96 (3 7/8")	83 (3 1/4")

Note

Dim X helps calculate space required when raised panels or crown moldings are used.

Measurements table for selecting the right model based on cabinet height and door weight including weight of handle.

		Door Weight Ranges in Pounds									
Model	B	C		D		E		F			
Door Height	Min	Max	Min	Max	Min	Max	Min	Max	Min	Max	
9"	5.1	9.5	8.4	15.6	14.1	20.5	20.2	29.5	29.5	42.0	
10"	4.2	8.6	7.5	14.1	12.8	20.0	18.3	27.7	26.6	37.8	
11"	4.2	7.7	6.8	12.8	11.7	18.0	16.5	26.4	24.2	34.3	
12"	3.7	7.0	6.2	11.7	10.6	16.5	15.2	24.2	22.2	31.5	
13"	3.5	6.6	5.7	10.8	9.7	15.4	14.1	22.4	20.5	29.0	
14"	3.3	6.2	5.3	10.1	9.0	14.3	13.0	20.9	18.9	27.1	
15"	2.9	5.7	4.8	9.5	8.4	13.2	12.1	19.4	17.8	25.1	
16"	2.6	5.3	4.6	8.8	7.9	12.3	11.4	18.3	16.7	23.5	
17"	2.4	5.1	4.4	8.4	7.5	11.7	10.8	17.2	15.6	22.2	
18"	2.2	4.6	4.2	7.7	7.0	11.0	10.1	16.1	14.7	20.9	
19"	2.2	4.4	4.0	7.5	6.6	10.3	9.5	15.4	14.1	19.8	
20"	2.0	4.2	3.7	7.0	6.4	9.9	9.0	14.5	13.2	18.9	
21"	2.0	4.0	3.5	6.6	5.9	9.5	8.6	13.9	12.5	18.0	
22"	1.8	3.7	3.3	6.4	5.7	9.0	8.1	13.2	12.1	17.2	
23"	1.8	3.7	3.1	6.2	5.5	8.6	7.9	12.5	11.4	16.3	
24"	1.8	3.5	3.1	5.9	5.3	8.1	7.5	12.1	11.0	15.6	
25"	1.5	3.3	2.9	5.5	5.1	7.9	7.3	11.7	10.6	15.0	
26"	1.5	3.3	2.9	5.3	4.8	7.7	7.0	11.2	10.1	14.5	

Order suitable screw set for aluminum frame doors, to the right.



Free Space Drilling Jig

- For pilot drilling the cabinet side panels and door panel

Material: Plastic; Drilling Sleeves: Steel

Item No.
372.27.602

Note

For drilling patterns, please see Free Space installation instructions.

Application

Side panel

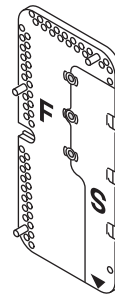

The drilling jig is positioned directly in the left or right cabinet corner (reference mark "S")

Door panel

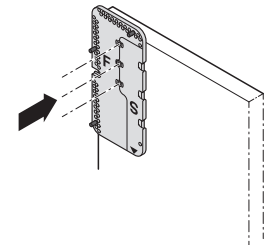

The positioning pins are pre-mounted in accordance with the selected door overlay dimension; then the drilling jig is positioned in both top corners of the door panel (reference mark "F")

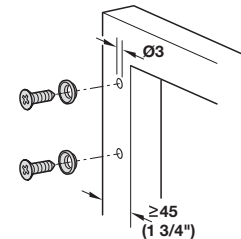

Screws and collars for aluminum framed doors

- For connecting aluminum framed doors
- Minimum frame width = 45 mm (1 3/4")

Material: Steel

Finish	Item No.
nickel-plated	372.27.600

Supplied With

4 screws and collar rings

Dimensional data not binding. We reserve the right to alter specifications without notice.

