

COMPACT BLUMOTION and COMPACT Hinges A complete face frame program

Blum's COMPACT hinges program has proven itself as the high quality solution for face frame cabinets for over 30 years and continue to provide the quality of motion you have come to expect from Blum hardware.

COMPACT BLUMOTION hinges have the soft closing mechanism integrated directly in the hinge cup. They are available for most overlay face frame applications or door styles.

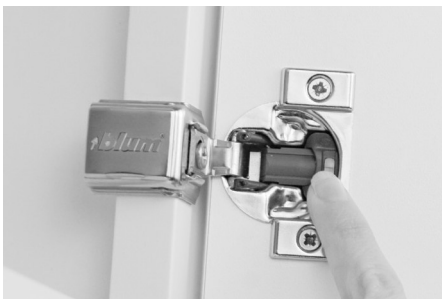

Deactivation option

The BLUMOTION function can be easily deactivated on one of the hinges, allowing small or light doors to close with the same high quality of motion.

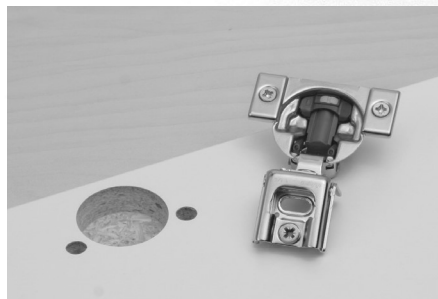

Interchangeability

COMPACT BLUMOTION hinges are interchangeable with current COMPACT hinges so there is no need to change existing setups or workflows.



Overload safety feature

This feature protects the hinge from damage if the door is slammed and maintains the BLUMOTION soft closing for the life of the hinge.

Hinges



COMPACT BLUMOTION and COMPACT Hinges Overview



COMPACT BLUMOTION 38N hinges for partial overlay

Partial overlay hinges with a 105° opening angle and 7/16" cup depth



COMPACT BLUMOTION 39C/38C hinges for full overlay

39C: Full overlay hinges with a 110° opening angle and 1/2" cup depth

38C: Full overlay hinges with a 107° opening angle and 7/16" cup depth



COMPACT BLUMOTION 38B face mount hinges for full overlay

Full overlay face mount hinges with a 107° opening angle and 7/16" cup depth



COMPACT 38N hinges for partial overlay

Partial overlay hinges with a 105° opening angle and 7/16" cup depth



COMPACT 39C/38C hinges for full overlay

39C: Full overlay hinges with a 110° opening angle and 1/2" cup depth

38C: Full overlay hinges with a 107° opening angle and 7/16" cup depth



COMPACT 33 hinges for partial and full overlay

Economical two-piece assembly hinges with a 110° opening angle and 1/2" cup depth



Conditions for Tests

Blum, Inc. does a great deal of testing to ensure that the quality of our hardware is consistent with the usual high standards that our customers have come to expect from Blum. For this reason we have rigorous testing procedures which are carried out from the development stage through production. Blum's internal testing standards are based on practical applications of our products and are more stringent than what is required by ANSI/BHMA.

NOTE: All Blum hinges meet or exceed ANSI/BHMA A156.9 Grade 2 requirements. All concealed hinges are designed for indoor use.

ISO 9001

Blum, Inc. is ISO 9001 certified which means that you are assured of consistent quality in every Blum product.

ANSI/BHMA

All Blum runners meet or exceed ANSI/BHMA A156.9 Grade 1 requirements. Contact your local Blum representative for more details.



Cycle test	
Specifications	<ul style="list-style-type: none"> Door size – 23-5/8" height, 23-5/8" width, 3/4" thickness Door weight –14.3 lb for cycle tests Door weight – 18.5 lb for load and over push tests Boring distance – 3 mm
Distance between hinges	<ul style="list-style-type: none"> 16-15/16"
Hinge and mounting plate attachment	<ul style="list-style-type: none"> Hinges are mounted to test blocks and attached to test door and stand with clamps Test blocks for door: Particle board Test blocks for mounting plate: Particle board

Cycle test

	Without load <ul style="list-style-type: none"> 100,000 opening and closing for all COMPACT 	With load <ul style="list-style-type: none"> 11 lb extra weight is applied for 100,000 opening and closing cycles
	Positive test result	Positive test result

Load test

	Static load <ul style="list-style-type: none"> 67 lb applied ten times for five seconds, each at 45° opening angle 	Dynamic load <ul style="list-style-type: none"> 44 lb extra weight applied for fifty opening and closing cycles
	Positive test result	Positive test result

Over push test

	Without load <ul style="list-style-type: none"> COMPACT hinges – Increasing forces up to 11 lb applied for a total of forty times for five seconds each
	Positive test result



Screw-on

Use #6 wood screws

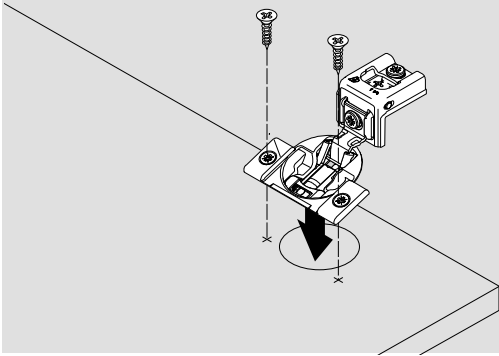

Press-in

Pre-attached Ø8 dowels installed with Blum knock-in tool or MINIPRESS with COMPACT insertion ram

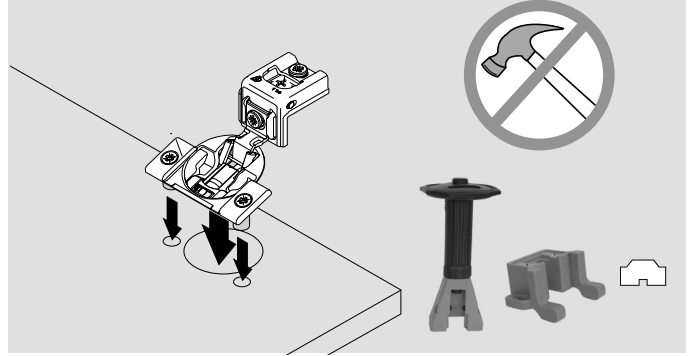

Mounting plate attachment

38N series – wraparound/edge mount

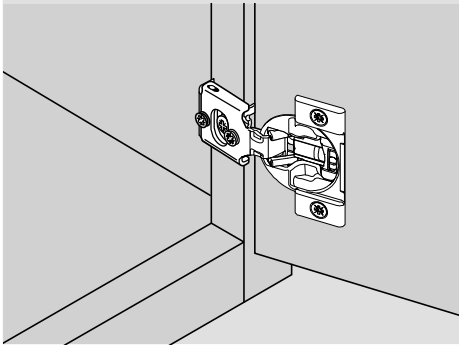

39C/38C series – wraparound

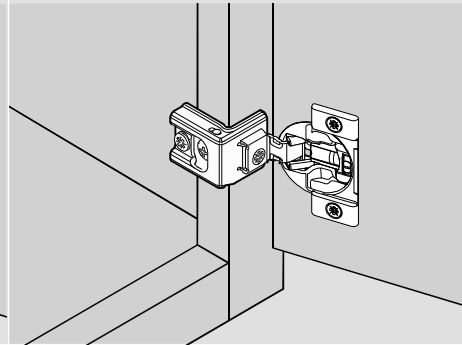

38B series – face mount

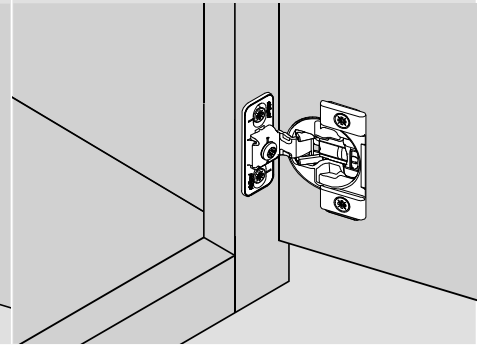

Minimum reveal

A minimum reveal per door is required to keep the door from binding and varies depending on door thickness.

See minimum reveal table for each hinge.

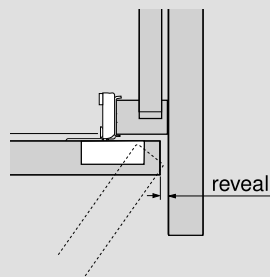

Hinge cup centerpoint

Hinge cup centerpoint and MINIPRESS/MINIDRILL setback position is 20.5 (13/16") for COMPACT BLUMOTION hinges

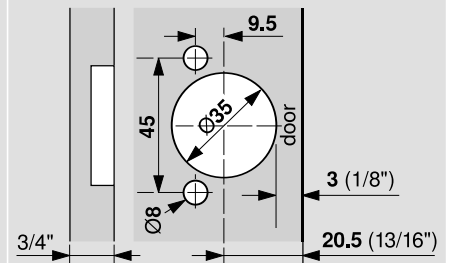

NOTE: Maximum door thickness 3/4"

Hinges per door

This chart can serve as a guide for determining the number of hinges per door. Note that door weight can also determine the number of hinges required.

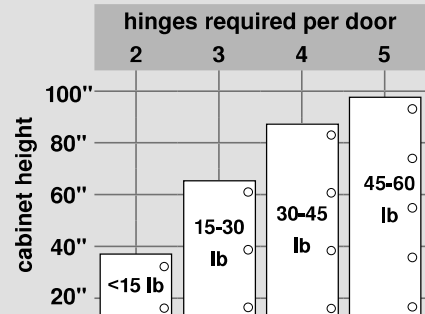

NOTE: The distance between the top and bottom hinges must be greater than the width of the door

Three-dimensional adjustment

Side adjustment

Rotate the front cam screw to increase or decrease door overlay ($\pm 1/16"$)

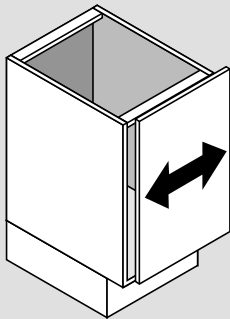
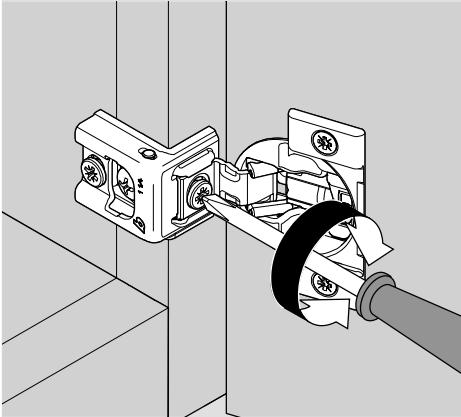

Height adjustment

Loosen installation screws to adjust door position ($\pm 1/8"$), then retighten

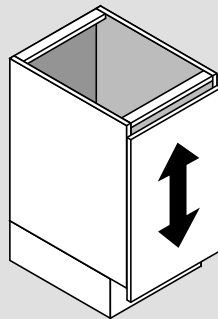
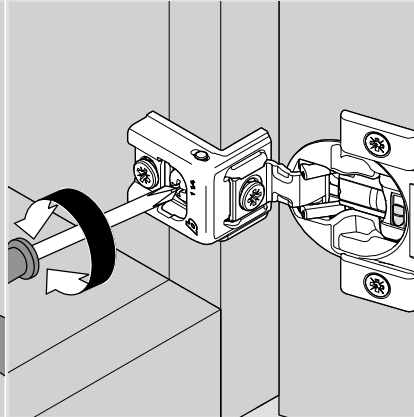

Depth adjustment

Rotate the rear cam screw to adjust door gap ($+ 3/32"$, $- 1/32"$)

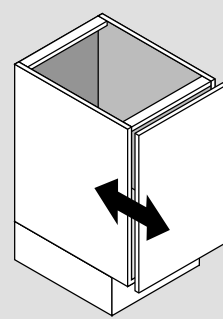
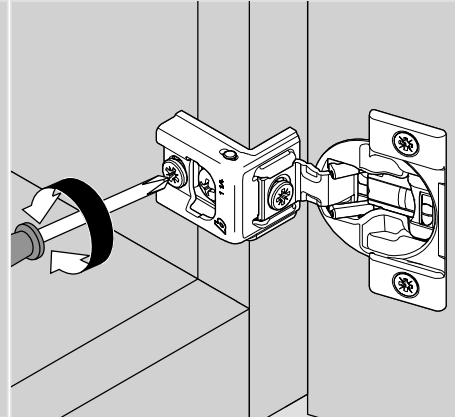

BLUMOTION Deactivation

Deactivation switch on the hinge cup

For small or light doors, the BLUMOTION can be deactivated on one of the hinges. COMPACT BLUMOTION comes in the activated position, marked with a "I". The deactivated position is marked with a "0".

Door must be closed once for the deactivation to be complete. To reactivate, move switch back to the original position "I".

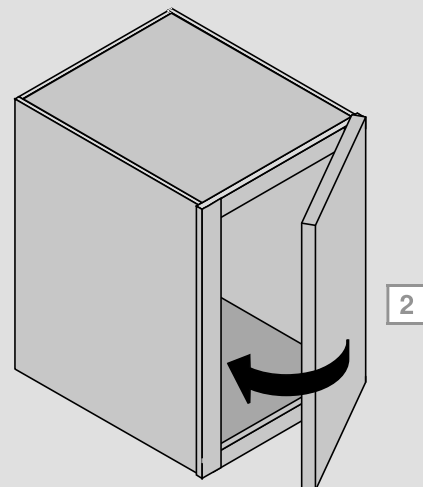
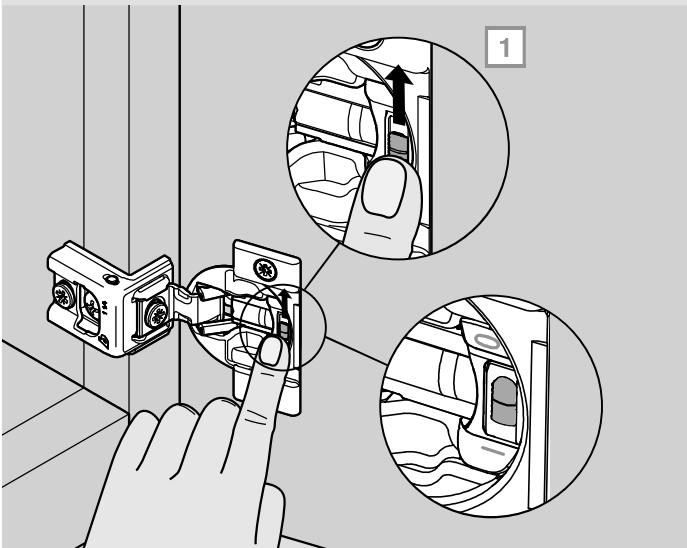

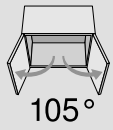

COMPACT BLUMOTION 38N for Partial Overlay

Hinges



Features

- BLUMOTION integrated into the hinge cup
- Deactivation switch for small/light doors
- Overload safety feature
- One-piece wraparound hinge
- 7/16" cup depth
- Edge mount available in 1/2" overlay



Minimum Reveal

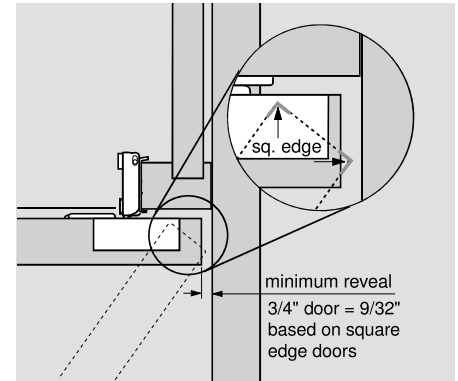

Boring pattern

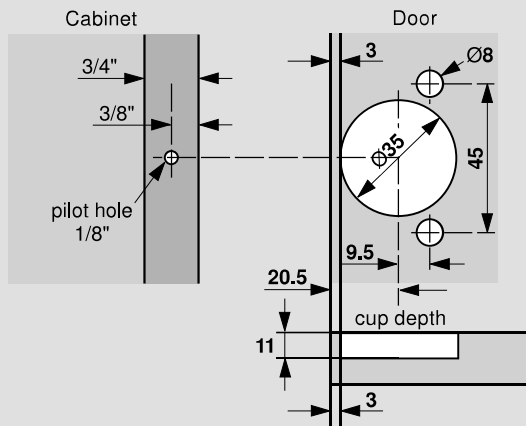

NOTE: Maximum door thickness 3/4"

Dimensions

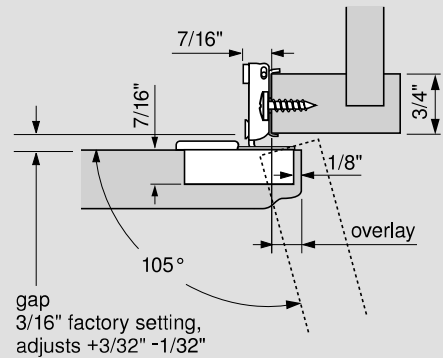

Adjustment

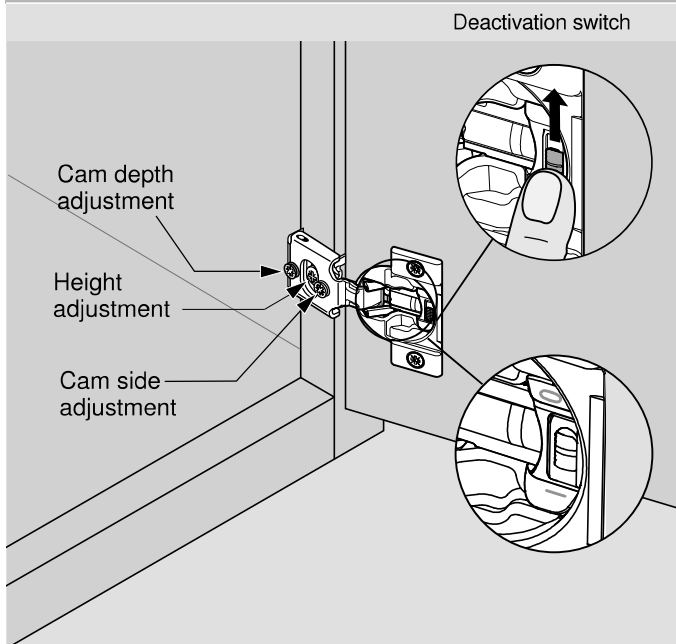

NOTE: COMPACT BLUMOTION comes in the activated position, marked with a "I" – the deactivated position is marked with a "0"

Wraparound and edge mount hinges



Overlay	Door protrusion	Screw-on	⁴⁷ Press-in
5/16"	5/16"		38N358B.05
3/8"	1/4"	38N355B.06	38N358B.06
1/2"	1/8"	38N355B.08	38N358B.08
*1/2"	1/8"	38N355BE08	38N358BE08
5/8"	0	38N355B.10	38N358B.10
3/4"	0	38N355B.12	38N358B.12

*Available as edge mount hinge

Installation screw

Truss head screw	834TH
------------------	-------

Accessories

Angle restriction clip	38C315B3.1
Hinge cup spacer	38C355B9
*Blank cover cap	38N3508B

*See page 85 for additional cover cap options

Hinges



COMPACT BLUMOTION 39C for Full Overlay

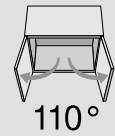

Features

- BLUMOTION integrated into the hinge cup
- Deactivation switch for small/light doors
- Overload safety feature
- One-piece wraparound hinge
- 1/2" cup depth
- Less minimum reveal



Minimum Reveal

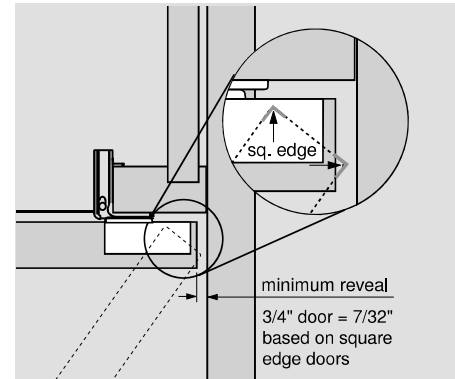

Boring pattern

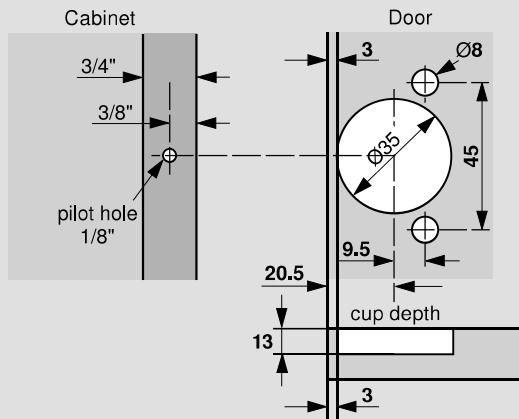

NOTE: Maximum door thickness 3/4"

Dimensions

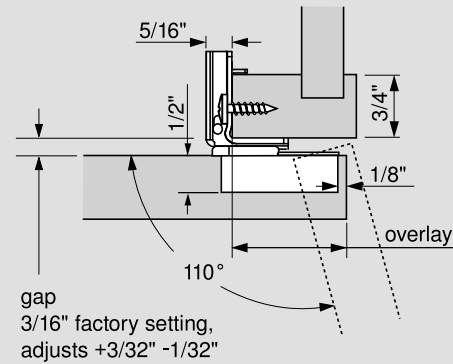

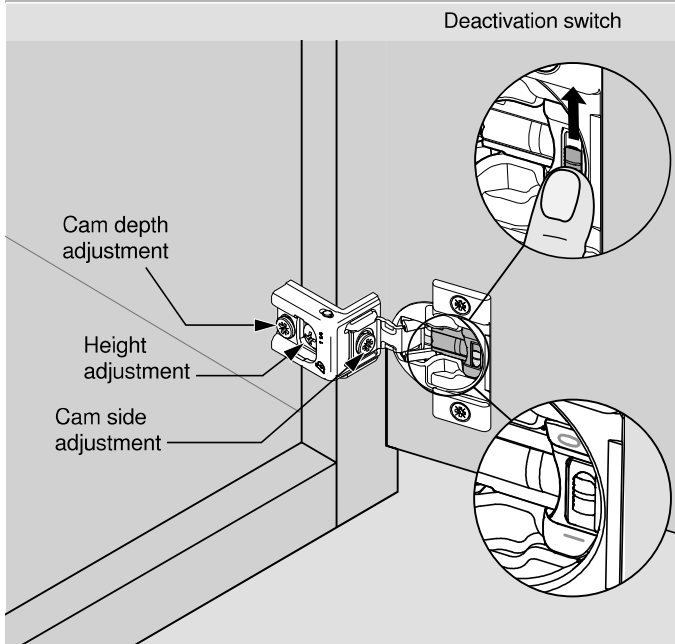

Adjustments

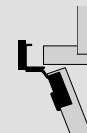

NOTE: COMPACT BLUMOTION comes in the activated position, marked with an "I" – the deactivated position is marked with a "0"

Wraparound hinges



Overlay	Screw-on	 Press-in
1"	39C355B.16	39C358B.16
1-1/4"	39C355B.20	39C358B.20
1-5/16"	39C355B.21	39C358B.21
1-3/8"	39C355B.22	39C358B.22
1-1/2"	39C355B.24	39C358B.24
1-9/16"	39C355B.25	39C358B.25

Installation screw

Truss head screw	834TH
------------------	-------

Accessories

Angle restriction clip	38C315B3.1
Hinge cup spacer	38C355B9
*Blank cover cap	38C3508

*See page 85 for additional cover cap options



107°

COMPACT BLUMOTION 38C for Full Overlay

Hinges



Features

- BLUMOTION integrated into the hinge cup
- Deactivation switch for small/light doors
- Overload safety feature
- One-piece wraparound hinge
- 7/16" cup depth
- Ideal for profiled doors



Minimum Reveal

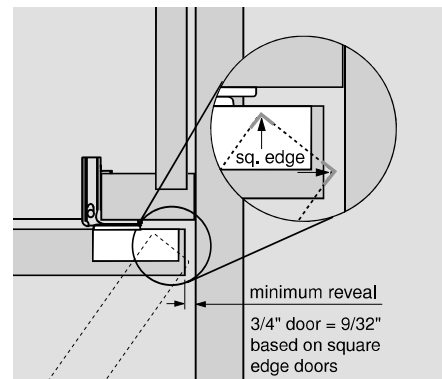

Boring pattern

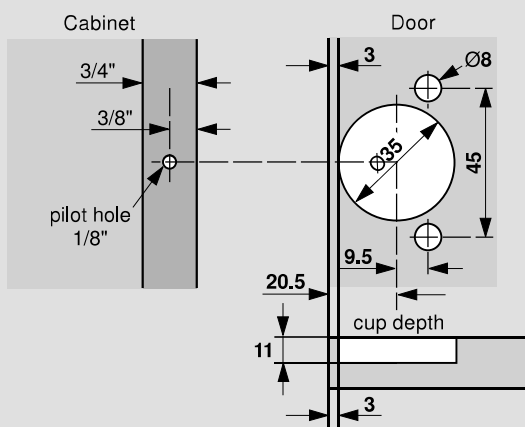

NOTE: Maximum door thickness 3/4"

Dimensions

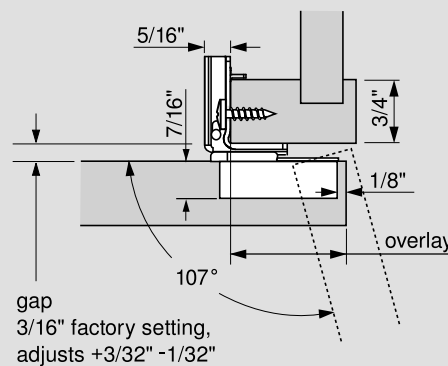

Adjustments

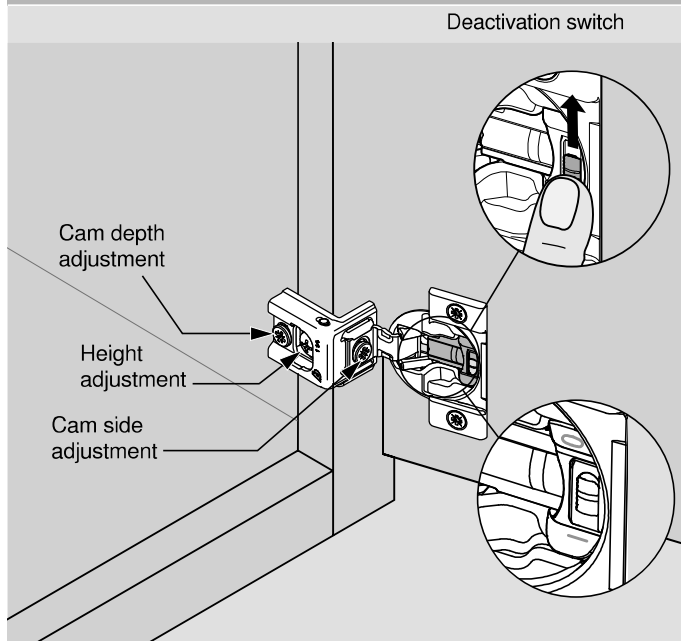

NOTE: COMPACT BLUMOTION comes in the activated position, marked with an "I" – the deactivated position is marked with a "0"

Wraparound hinges

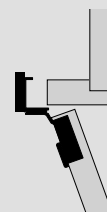

Overlay	Screw-on	47 Press-in
1-1/4"	38C355B.20	38C358B.20

Installation screw	
Truss head screw	834TH

Accessories	
Angle restriction clip	38C315B3.1
Hinge cup spacer	38C355B9
*Blank cover cap	38C3508

*See page 85 for additional cover cap options

Hinges



COMPACT BLUMOTION 38B for Face Mount

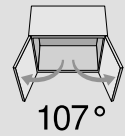

Features

- BLUMOTION integrated into the hinge cup
- Deactivation switch for small/light doors
- Overload safety feature
- One-piece face mount hinge
- 7/16" cup depth
- Ideal for large overlays or refacing of cabinets

Minimum Reveal

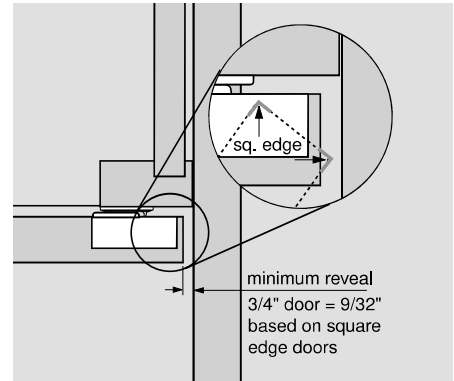

Boring pattern

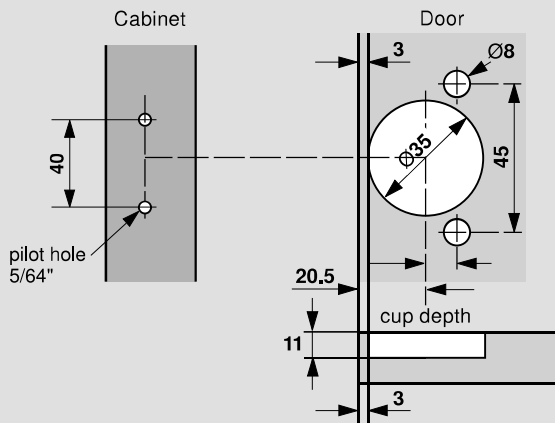

Dimensions

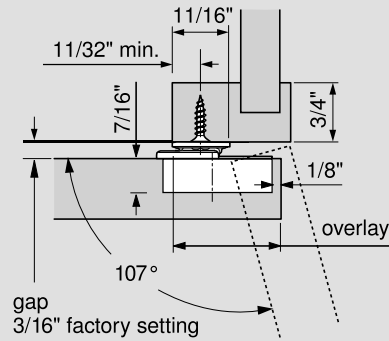

NOTE: Maximum door thickness 3/4"

Adjustments

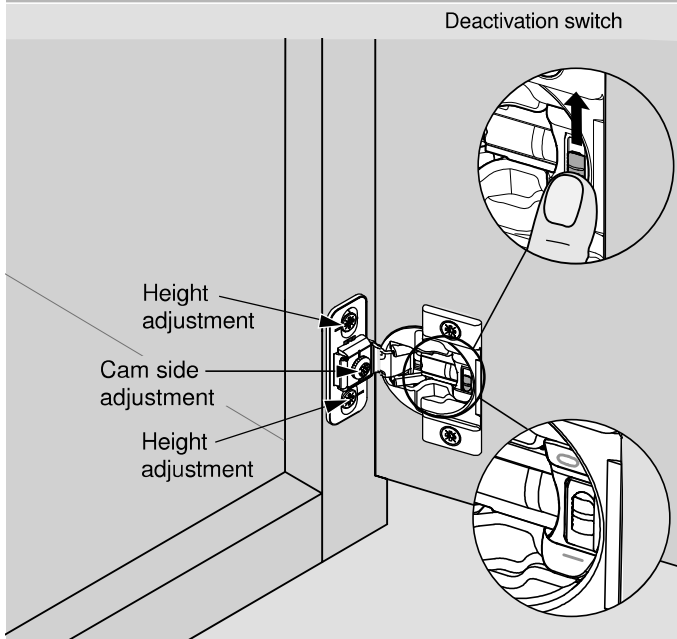

NOTE: COMPACT BLUMOTION comes in the activated position, marked with an "I" – the deactivated position is marked with a "0"

Face mount hinges

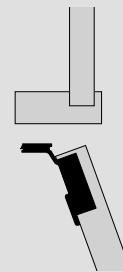

Overlay	Screw-on	47 Press-in
1-3/8" or greater	38B355BF22	38B358BF22

Installation screw	
Flat head wood screw	606N or 606P

Accessories	
Angle restriction clip	38C315B3.1
Hinge cup spacer	38C355B9

Hinge arm cover caps

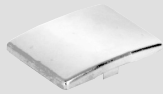

39C/38C blank cover cap



39C/38C Blum logo embossed cover cap

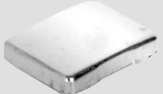

38N blank cover cap



38N Blum logo embossed cover cap

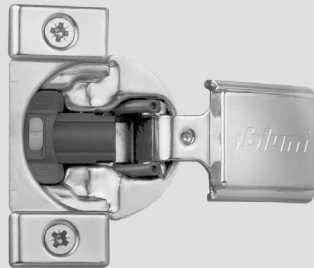

- Steel, nickel-plated cap
- Available blank or embossed (Blum logo)
- Also available with printed custom logo (minimum order quantity applies)

	Part no.
39C/38C blank cover cap	38C3508
39C/38C Blum logo embossed cover cap	38C3508.BP
38N blank cover cap	38N3508B
38N Blum logo embossed cover cap	38N3508BBP

Angle restriction clip

- Restricts opening angle of the COMPACT BLUMOTION to 86°
- Angle restriction clip must be inserted before the hinge has been attached to the face frame
- Gray nylon

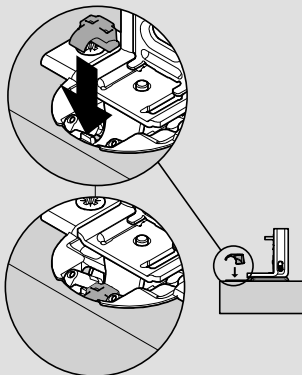

Part no.

Angle restriction clip 38C315B3.1

Hinge cup spacer

- 1/16" spacer for use under the hinge cup for thin or profile doors
- Non-stackable
- Gray nylon

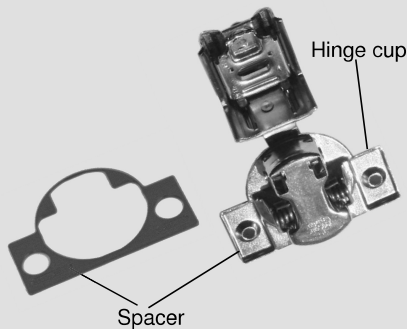
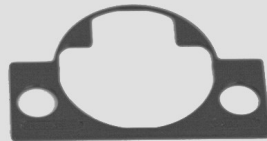

Part no.

Hinge cup spacer 38C355B9

Distance spacer

- Steel spacer decreases door overlay in 1/32" increments
- Can be stacked to achieve desired overlay reduction
- Steel, zinc-coated

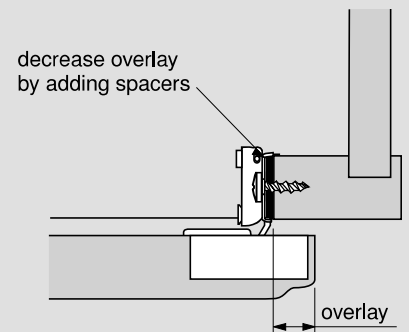
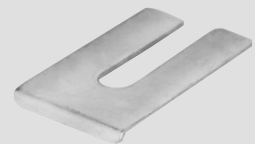

Part no.

Distance spacer 36.3515

Screw-on hinge attachment

Use #6 wood screws

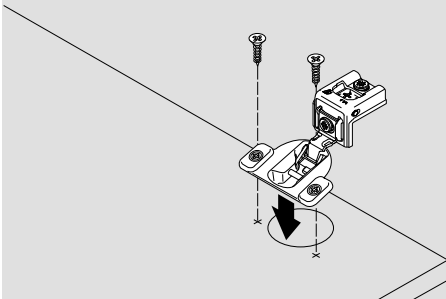

Press-in hinge attachment

Pre-attached Ø8 dowels installed with Blum knock-in tool or MINIPRESS with COMPACT insertion ram.

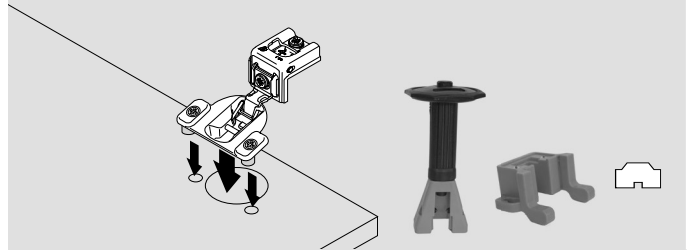

Mounting plate attachment

One-piece assembly

COMPACT 38N
wrap or edge

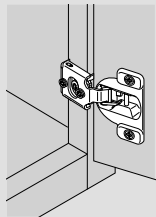

COMPACT 39C/38C
wraparound

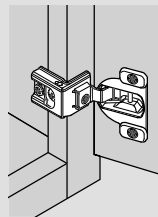

Two-piece assembly

COMPACT 33
edge mount

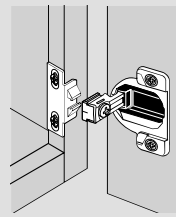

COMPACT 33
face mount

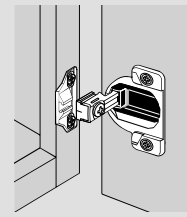

Minimum reveal

A minimum reveal per door is required to keep the door from binding and varies depending on door thickness (see minimum reveal table for each hinge).

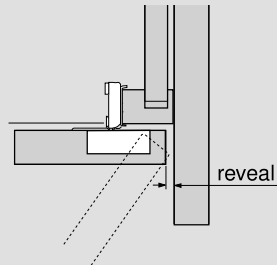

Hinge cup centerpoint

Cup centerpoint and MINIPRESS/MINIDRILL setback position is 20.5 (13/16") for COMPACT hinges.

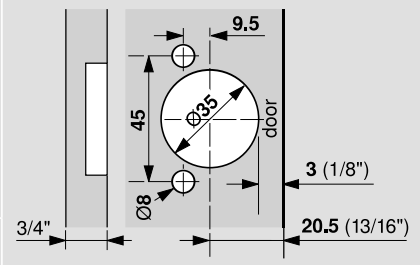

NOTE: Maximum door thickness 3/4"

Three-way independent adjustment

Side adjustment

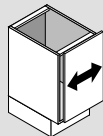
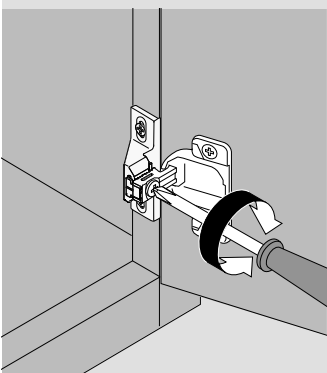

Side adjustment is possible on all COMPACT hinges. COMPACT 38N, 39C and 38C have cam side adjustment.

Depth adjustment

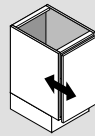
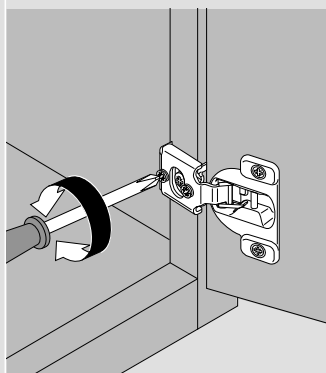

COMPACT 38N, 39C and 38C have cam depth adjustment

Height adjustment

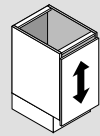
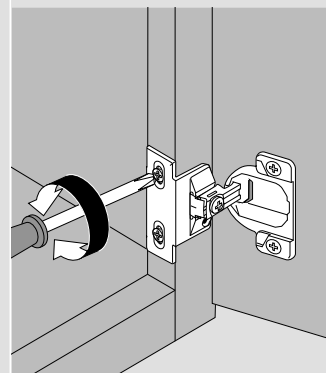

All COMPACT hinges are independently height adjustable

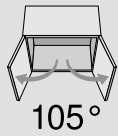

COMPACT 38N for Partial Overlay

Hinges



Features

- 105° opening angle
- One piece assembly
- Wraparound or edge mount
- 7/16" cup depth
- ±1/8" height adjustment
- ±1/16" side adjustment
- +3/32", -1/32" cam depth adjustment
- Steel, nickel-plated
- Can be used with BLUMOTION 971A9700



Minimum Reveal

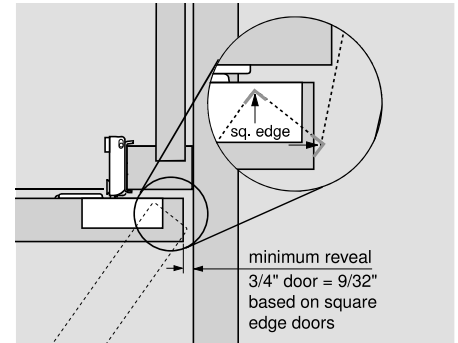

Boring pattern

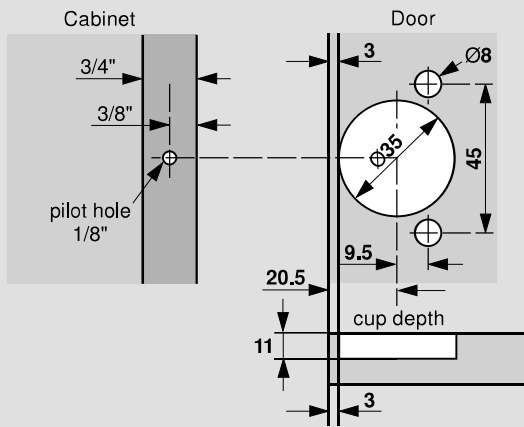

NOTE: Maximum door thickness 3/4"

Dimensions

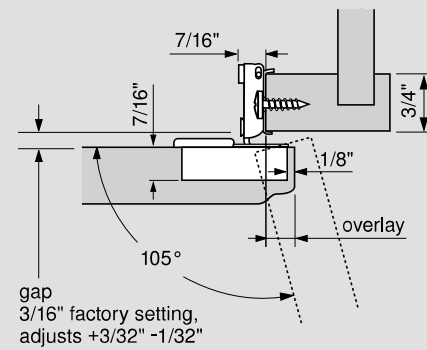

Adjustments

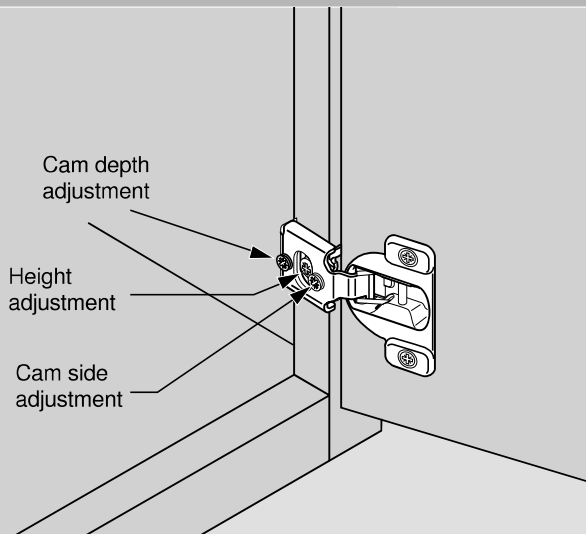

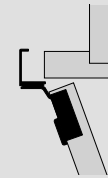

Wraparound hinges

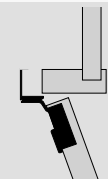

Overlay	Screw-on	 Press-in
3/8"	38N355C.06	38N358C.06
1/2"	38N355C.08	38N358C.08
5/8"	38N355C.10	38N358C.10
3/4"	38N355C.12	38N358C.12

Edge mount hinges



Overlay	Screw-on	 Press-in
1/2"	38N355CE08	38N358CE08

Calculating door protrusion

Door overlay	Door protrusion
3/8"	1/4"
1/2"	1/8"
5/8"	0
3/4"	0

Installation screw

Truss head installation screw	834TH
-------------------------------	-------

Hinges



COMPACT 39C for Full Overlay

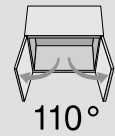

Features

- 110° opening angle
- One piece assembly
- Wraparound mount
- 1/2" cup depth
- ±1/8" height adjustment
- ±1/16" side adjustment
- +3/32", -1/32" cam depth adjustment
- Steel, nickel-plated
- Can be used with BLUMOTION 971A9700

Minimum Reveal

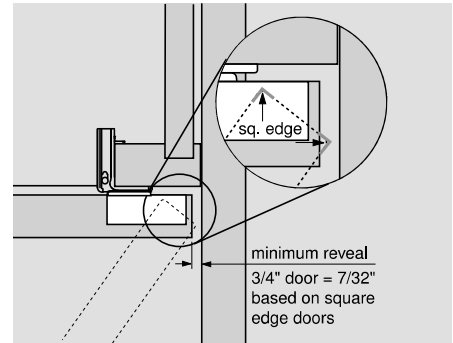

Boring pattern

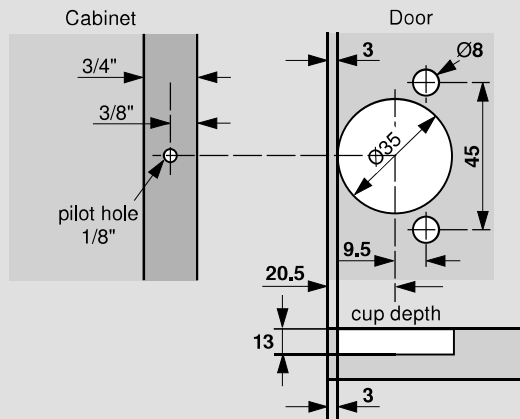

Dimensions

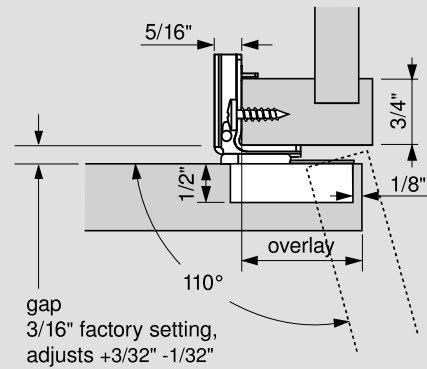

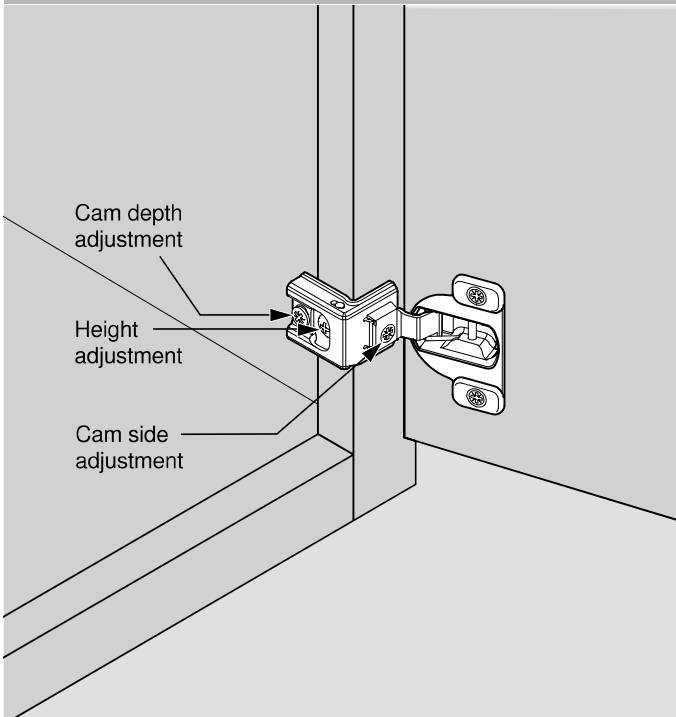

NOTE: Maximum door thickness 3/4"

Adjustments

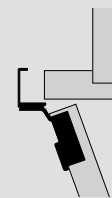

Wraparound hinges



Overlay	Screw-on	 Press-in
1"	39C355C.16	39C358C.16
1-1/4"	39C355C.20	39C358C.20
1-3/8"	39C355C.22	39C358C.22
1-1/2"	39C355C.24	39C358C.24
1-9/16"		39C358C.25

Installation screw

Truss head installation screw	834TH
-------------------------------	-------

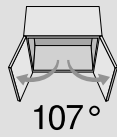

COMPACT 38C for Full Overlay

Hinges



Features

- 107° opening angle
- One piece assembly
- Wraparound mount
- 7/16" cup depth
- ±1/8" height adjustment
- ±1/16" side adjustment
- +3/32", -1/32" cam depth adjustment
- Steel, nickel-plated
- Can be used with BLUMOTION 971A9700

Minimum Reveal

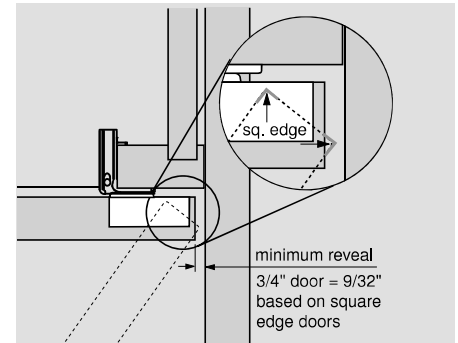

Boring pattern

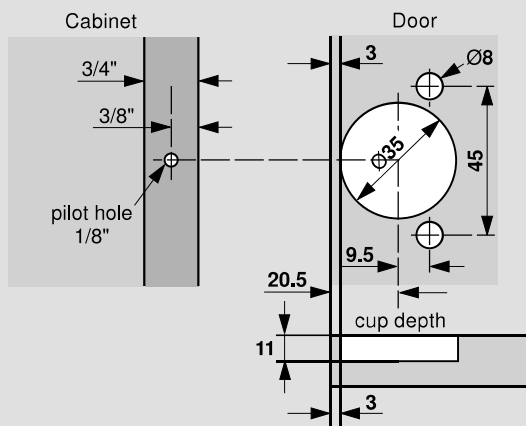

Dimensions

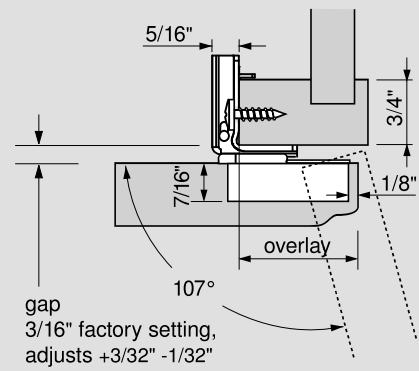

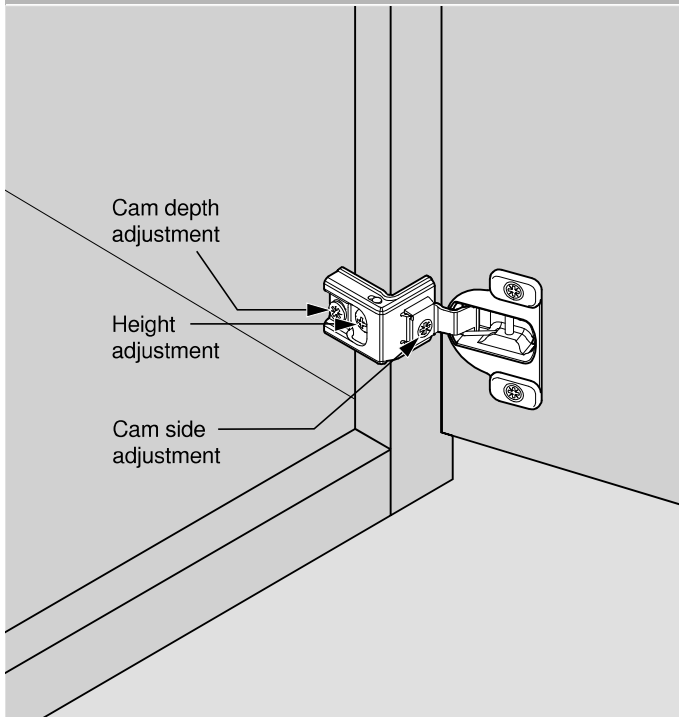

NOTE: Maximum door thickness 3/4"

Adjustments

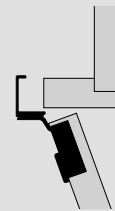

Wraparound hinges



Overlay	Screw-on	 Press-in
1-1/4"	38C355C.20	38C358C.20
1-3/8"		38C358C.22
1-1/2"		38C358C.24

Installation screw

Truss head installation screw	834TH
-------------------------------	-------

Hinges



COMPACT 33

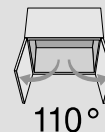

Features

- 110° opening angle
- Two piece assembly
- Edge or face mount
- 1/2" cup depth
- ±9/64" height adjustment
- -1/8" side adjustment only
- Zinc die-cast hinge and mounting plates
- Can be used with BLUMOTION 971A9700



Minimum Reveal

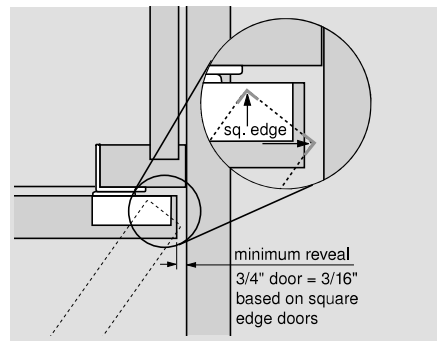

Boring pattern

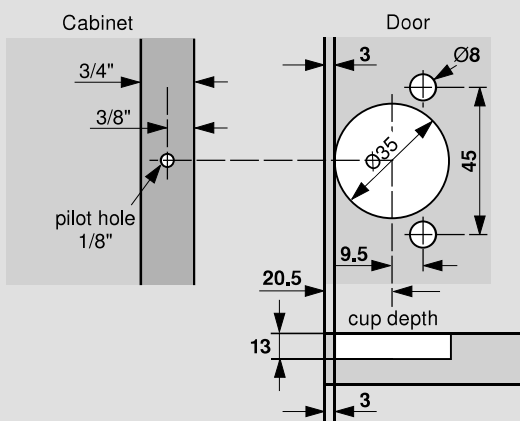

Mounting

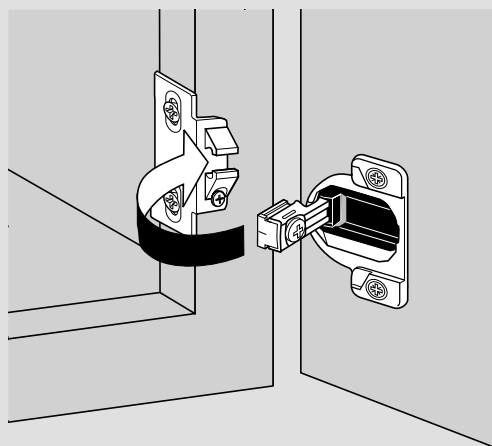

NOTE: Maximum door thickness 3/4"

Attachment options

Edge mount

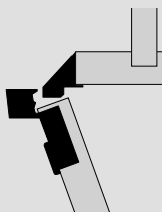

Face mount

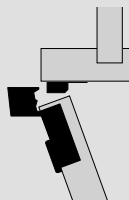

Attachment	Screw-on	Press-in
	33.3600	33.3630

Installation screw

Wood screw	606N or 606P
------------	--------------

Edge mount specifications

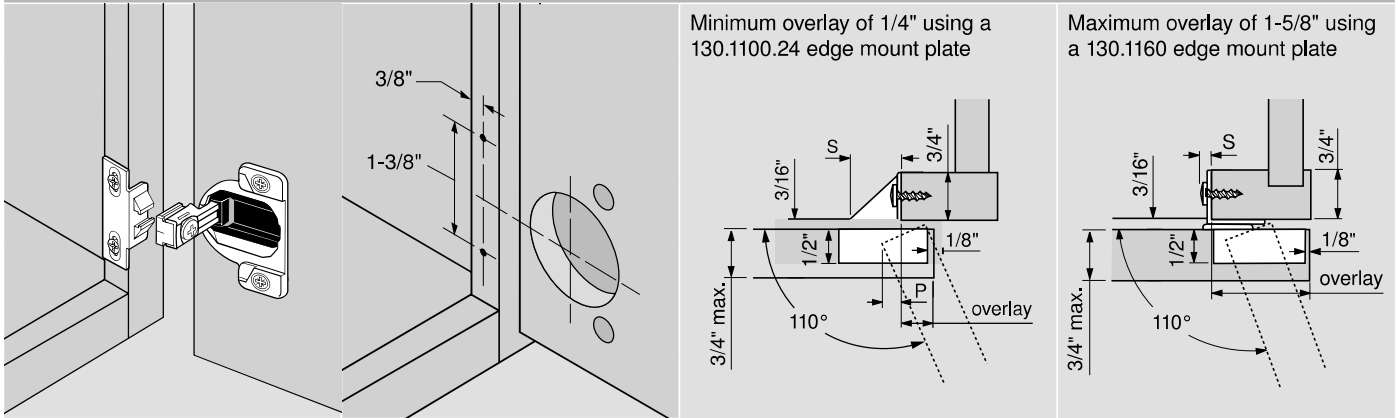

Edge mount mounting plates



- Zinc die-cast, nickel-plated
- Attaches with #6 x 5/8" wood screws (606N or 606P)
- Overlays from 1/4" to 1-5/8"

NOTE: An additional screw is required on mounting plates with 1-3/8" to 1-5/8" overlays to insure stability. Install after height adjustments have been made.

Overlay	Hinge arm protrusion (S)	Door protrusion (P)	Mounting plate
1/4"	1-1/8"	1/2"	130.1100.24
1/2"	7/8"	1/4"	130.1100.23
5/8"	3/4"	1/8"	130.1100.26
3/4"	5/8"	0	130.1100.22
1"	3/8"	0	130.1110.02
1-1/8"	1/4"	0	130.1120.02
1-1/4"	3/16"	0	130.1130.02
*1-3/8"	3/16"	0	130.1140.02
*1-1/2"	3/16"	0	130.1150.02
*1-5/8"	3/16"	0	130.1160

Face mount mounting plate

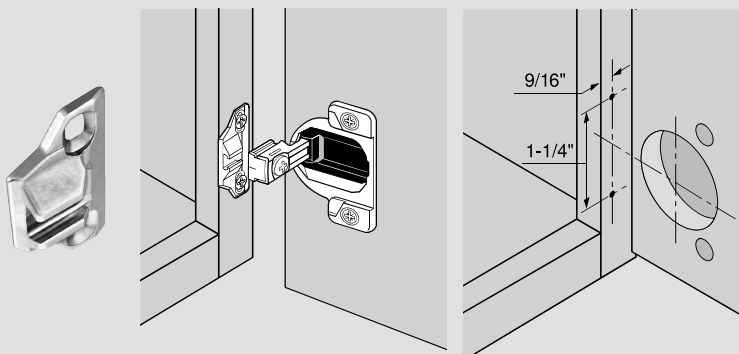

- Zinc die-cast, nickel-plated
- Attaches with #6 x 5/8" wood screws (606N or 606P)
- Overlays 1-3/8" or greater

Mounting plate	Part no.
Face mount	133.0240

Hinges



BLUMOTION 971A for COMPACT Hinges

BLUMOTION 971A poly-bag set

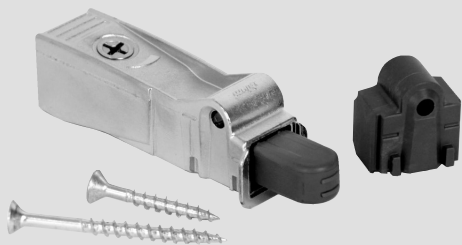

Can be used for all COMPACT hinges

Set includes:

- BLUMOTION mechanism (971A9700)
- Spacer (971A9709)
- #8 x 1-1/4" type 17 wood screw
- #8 x 2" type 17 wood screw

Part no.

Poly-bag set

971A9700.22

Full overlay

- Full overlay – 1" or greater overlay

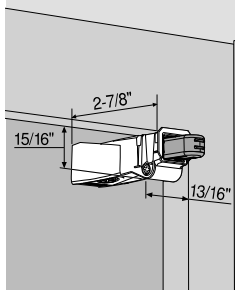

Part no.

BLUMOTION	971A9700
Installation screw (1-1/4")	8114Z

Partial overlay

- Partial overlay – less than 1" overlay

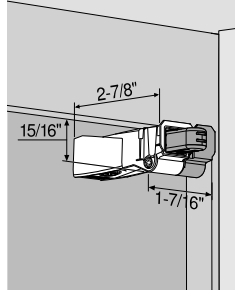

Part no.

BLUMOTION	971A9700
Spacer	971A9709
Installation screw (2")	8200Z

Specifications

Mounting

BLUMOTION for doors mounts anywhere on the hinge-side stile of the cabinet using a 1-1/4" screw or 2" screw when using spacer.

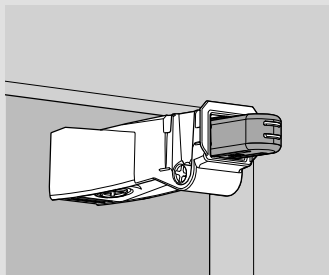

Attachment of partial overlay spacer

The partial overlay spacer snaps onto the side of the BLUMOTION for easier mounting.

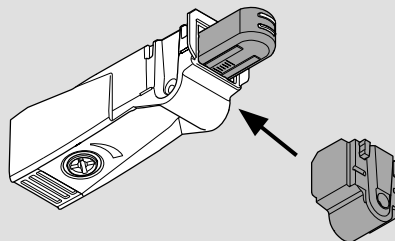

Adjustment

Use a Phillips or POZI screwdriver to adjust the contact point in or out (+5/-5 mm). Adjust out for larger, heavier doors or in for smaller, lighter doors.

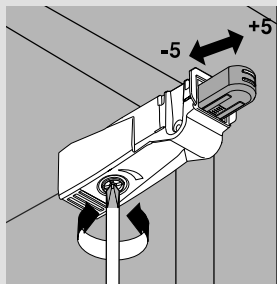

BLUMOTION per door

For optimum BLUMOTION effect, one BLUMOTION 971A should be installed for most applications. Tall or heavy doors may require an additional BLUMOTION 971A. Trial application recommended.

- BLUMOTION 973A
- Hinges

