



# Lamello

# System

2021

*english*



# Joining with the Lamello System

An exceptionally efficient, simple and precise joining system for panels

## How it works



1. Cut grooves



2. Apply glue



3. Insert biscuits



4. Clamp workpiece

The precise work results of the system and the long life of the power tools pay off

## Advantages and properties

**Fast** – Lateral sliding tolerance

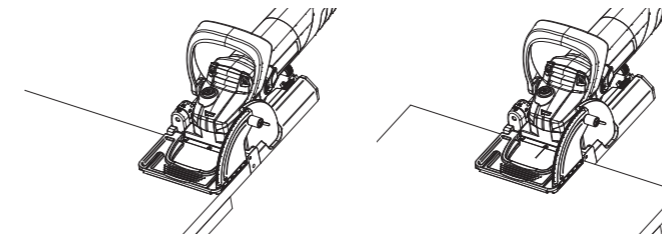

- **Easy positioning** of the machine to the pencil mark
- **No additional side stops or positioning aids necessary**
- **Great flexibility** when assembling, possibility to join panels by sliding together from different angles – not just perpendicular unlike dowels (see large picture left)

**Easy** – Same groove depth for both sides

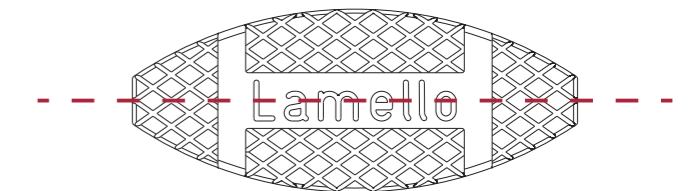

- No changing of the cutting depth means **less room for error**
- **Saves time** with every joint

**Precise** – Established cutting principle with disc cutter

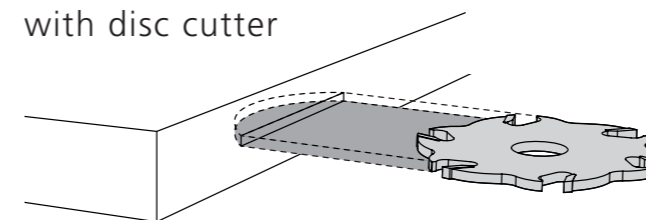

- **Disc-shaped tools cannot bend or flex**
- **Always parallel, precise grooves** – despite wood knots or fast working
- **No tool change** for many different joining elements
- **Low maintenance cost** throughout the long life of the power tool, maintenance comprises **one cutting tool only**

**Versatile** – Thin flat joining element with minimal installation depth

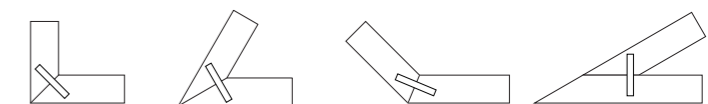

- **Join thin workpieces** 8 or 10 mm in many various angles
- **Minimal material weakening**
- **Non-rotating, cost effective** joining elements



# Versatile applications with a wide range of joining elements



Without tool change			With tool change
20	10	0	H9
E20-L	E20-H	K20	Clamex S-18
C20	C10	Simplex	

## ...and many more additional benefits



**Cut grooves**  
Cut grooves for tongue and groove connections, using standard carbide-tipped groove cutter 4 mm



**Wood repairs**  
Repairing of resin pockets and small defects, carbide tipped cutter for Minispot patches size 2



**Cut expansion gaps**  
Expansion gaps for wood ceilings or floors, sliding shoe and carbide-tipped saw blade

# The original wooden biscuit

The Original  
Swiss production  
Swiss timber  
Lamello quality

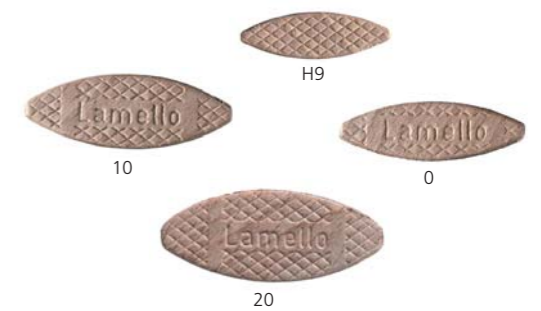

**Advantages and properties**

- 1. Rounded smooth edges**  
– Easy handling and insertion
- 2. Recessed & embossed glue surface**  
– Accurate glue distribution  
– Easy insertion into groove
- 3. Diagonal fiber orientation**  
– Excellent breaking strength

Wood biscuits carton	Size	Quantity	Part no.
Size 20	56 × 23 × 4 mm	1000 pieces	144020
Size 10	53 × 19 × 4 mm	1000 pieces	144010
Size 0	47 × 15 × 4 mm	1000 pieces	144000
Size H9	38 × 12 × 3 mm	1000 pieces	144009
Size 20, 10, 0	assorted	1000 pieces (500, 250, 250)	144030

Installation of wooden biscuits with cutter Ø 100 × 4 × 22 mm (standard cutter)  
Installation of H9 wooden biscuits with cutter Ø 78 × 3 × 22 mm (Part no. 132009)



# Gluing

## Minicol

The all purpose glue applicator

### Advantages and properties

- For 4 mm grooves
- Nozzle facing downwards in the stand for quick use
- Bottle base prevents the glue from drying up in the nozzle
- Volumetric capacity: 300 ml
- Glue application on the sides



**Minicol:** glue applicator with a sturdy bottle base in solid wood  
175500

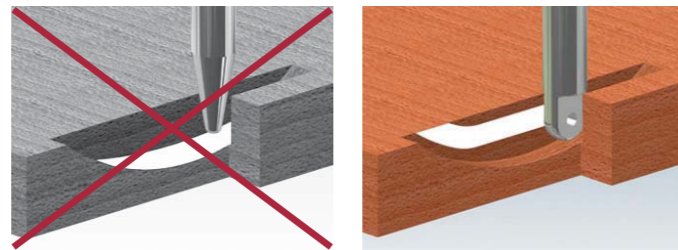

Glue application on the sides

### Glue applicator Minicol

#### Part no.

Minicol Mod. KS .....with plastic nozzle.....	<b>175500</b>
Minicol Mod. M .....with metal nozzle.....	<b>175550</b>



### Nozzles for Minicol

#### Part no.

plastic nozzle .....	<b>335511</b>
metal nozzle .....	<b>285512</b>
pointed nozzle .....	<b>335522</b>
metal nozzle .....for biscuits size H9 .....	<b>285509</b>

Accessories starting page 102

## Clamping Set

### Advantages and properties

- Easy clamping system for gluing case work, drawers, frames, wall and floor panels
- Even pressure distribution guarantees correct angle of workpiece



175020



### Clamping Set

#### Part no.

20 cm .....	1 piece of clamps.....	<b>175021</b>
	8 m belt	
	4 pieces profile sections 20 cm	
60 cm .....	2 pieces of clamps.....	<b>175020</b>
	2 pieces 8 m belt	
	4 pieces profile sections 60 cm	
	2 pieces tension hooks	

Parts	Quantity	Part no.
Clamps.....	2 pieces.....	5 m clamping belt..... <b>175005</b>
		8 m clamping belt..... <b>175008</b>
Buckle for clamps .....	1 piece .....	without belt..... <b>175060</b>
Polyester belt for clamps .....	1 roll .....	of 50 m .....
	Per meter .....	m <sup>1</sup> ..... <b>335000</b>
Tension hooks .....	2 pieces.....	<b>175200</b>
Profile sections .....	4 pieces .....	length 12 cm .....
		length 40 cm .....
		length 60 cm .....
		<b>175401</b>
		<b>175402</b>
		<b>175403</b>

# Clamex S connector

For aesthetic constructions. Detachable, flexible and easy. Installation in an 8 mm groove with screws



Flexible

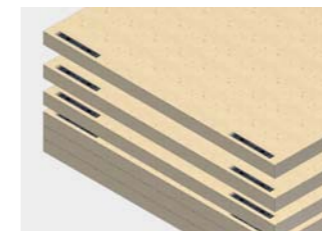

Stackable

### Advantages and properties

- Detachable connections
- Aligns and connects, 2 functions in one
- Aesthetic joint due to the small hole for opening and closing
- Safe from twisting due to the aligning studs
- Flexible miters in all angles
- Stackable, since no parts protrude from the surface, so ideal for flat packing
- Easy installation with any Lamello biscuit joiner



Aesthetic



Detachable

### Applications of Clamex S

- Detachable furniture joints
- Surface, corner and dividing wall connections
- All angles
- Frame connections
- Dividing walls
- Glue aid



### Technical data

Size.....	66 x 29 x 8 mm
Cutter.....	Ø 100 x 8 x 22
Material of connector.....	fiberglass reinforced plastic
Material of lever.....	zinc die cast
Installation tolerance.....	longitudinal ± 1.0 mm (max. ± 1.25 mm)

### Clamex S-18

#### Part no.

18 pairs .....	<b>145231</b>
80 pairs .....	<b>145236</b>
300 pairs .....	<b>145241</b>
1000 pairs .....	<b>145251</b>

Accessories starting page 98

### How it works

Clamex S-18 installation with cutter Ø 100 x 8 x 22 mm (Part no.132108)

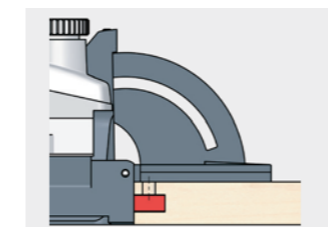

1. Cut groove, 8 mm



2. Drill hole 6 mm



3. Screw in the Clamex S

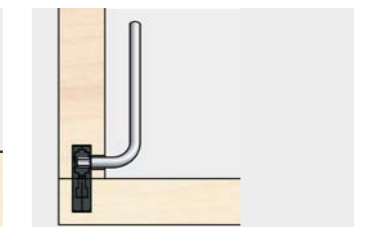

4. Connect, finished!



# E20

The self-clamping element



Inserting E20-L



### Advantages and properties

- **Connects and clamps** with one strike. The curved ridges clamp the connection together during insertion.
- Cut groove in both workpieces **simultaneously**
- **No clamps** – no waiting time
- Easy joining with a Lamello biscuit joiner

### Applications of E20

- Door frames
- Furniture plinths
- Elongating of panels and profiles
- Ideal on site

### Technical data

Size E20-L	56 x 11.5 x 4 mm
Size E20-H	23 x 28 x 4 mm
Cutter	Ø 100 x 4 x 22
Material	Fiberglass reinforced plastic

E20	Quantity	Part no.
E20-H	80 pieces	145021
	400 pieces	145026
	1200 pieces	145028
E20-L	80 pieces	145022
	400 pieces	145025
	1200 pieces	145027
E20-L / E20-H	40 pieces per type	145020

Inserting E20-H



Inserting E20-L



### How it works

#### E20-H

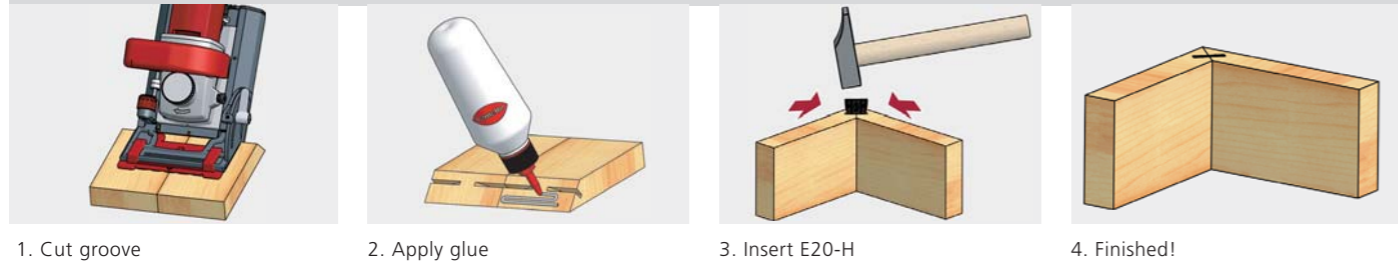

#### E20-L

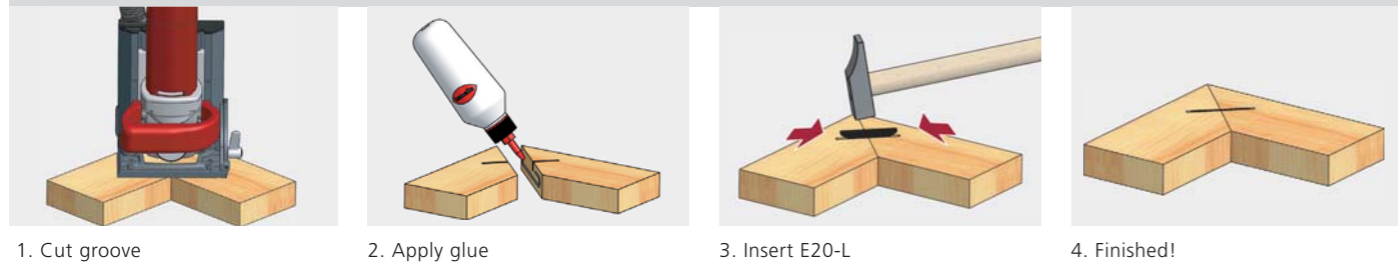

# K20

Clamping element



### Advantages and properties

Clamping aid for workpieces which are difficult to clamp, e.g. bulkheads, crown moulding etc. Use in combination with wooden Lamello biscuits. Made of plastic, barbed cross ribs for grip.

Cutter	Size (mm)	Quantity	Part no.
Ø 100 x 4 x 22	60 x 24 x 4.5	80 pieces	145001
		250 pieces	145000

# C20 / C10

Solid surface element transparency

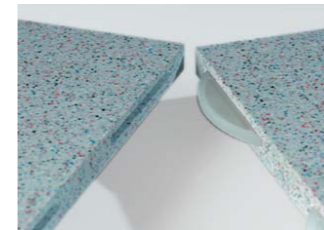
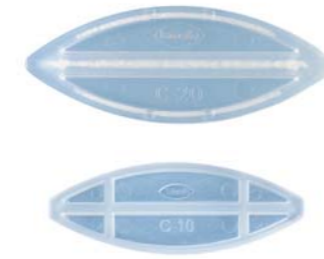

### Advantages and properties

For joining solid surface materials such as Corian®, Varicor® etc. Made of translucent plastic

Cutter	Size (mm)	Quantity	Part no.
C20 ...Ø 100 x 4 x 22	60 x 23 x 4	250 pieces	145010
C10 ...Ø 100 x 4 x 22	53 x 19 x 4	300 pieces	145012

# Simplex

Detachable slide-in connector

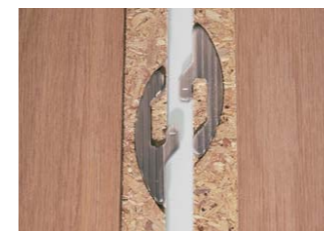

### Advantages and properties

Detachable, two part connector for ceiling panels, screens, shelves and general casegoods. Install with insertion tool and two-part epoxy adhesive. Made of aluminum

Cutter	Size (mm)	Quantity	Part no.
Ø 100 x 4 x 22	54 x 23 x 4.1	50 pairs	166101
		100 pairs	166100
Inserting tool for Simplex (For accurate positioning of Simplex)			166110

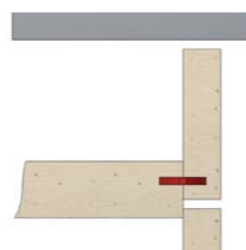



# Original Lamello biscuit joiners

## These properties make the difference

### Multifunctional stop square included in the kit

Both sides flush surfaces on baseplate, swivelling front and stop square for efficient positioning of the biscuit joiner on the work piece's outer edge



**Vertical stability** by attaching to the baseplate to increase the surface



**Perfect precision of miters** by applying on the outer surface for 22.5 and 45° angles



**Variable positioning of the groove** from the application surface 0–50 mm

### Swivelling front with fixed rotational point

Exactly the same distance from both sides to the cutter = 8 mm

Allows alternating the application surface from the swivelling front 1. to the baseplate 2. Especially important when cutting thin dividing panel connections



- **Safe process** guarantees always precise, parallel grooves
- **No inaccuracies or source of mistakes** because the height cannot be adjusted

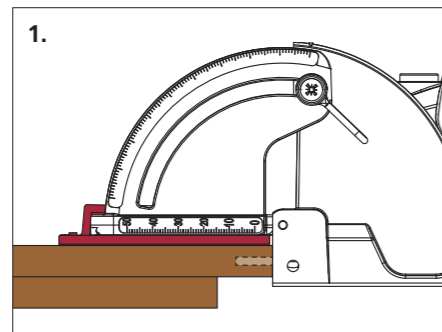

**Application with the swivelling front**  
With the 4mm spacer for 12 mm dividing panel (groove in the center)

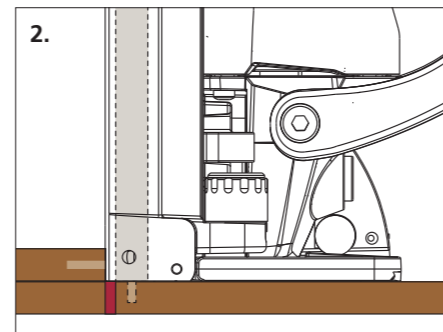

**Application with the baseplate**  
The dividing panel (moved by 4 mm) serves as application surface

### High-precision machined application surfaces



- **CNC machined high-precision application surfaces** for exact application on the workpiece



- **Long-life precision guide** provides exact, parallel grooves for perfect fit of the workpieces

## Classic X

The original biscuit joiner for every workshop. Choose Lamello for precision, reliability, longevity and many other benefits



Swivelling front and base plate are flush on the sides

### Advantages and properties

- Powerful 780 W motor, ergonomic slim shape
- Base plate is flush on both sides for efficient positioning of the machine on the workpiece
- High-precision machined guide and application surfaces for perfect fit of the workpieces
- Multifunctional stop square
- Versatile use, (see p 52)
- Swivelling front stop 0–90° with detents at 22.5°, 45°, 67.5°, 90°
- Rotating depth adjuster with 6 standard depths



Central lock

### Technical data

Power .....	780 W
Voltage .....	230 V oder 120 V
Speed .....	10'000 min <sup>-1</sup>
Cutter .....	Carbide tipped cutter Ø 100 x 4 x 22
Teeth .....	Z6 (3+3) with reversing teeth
Cutting depth max. ....	20 mm
Weight.....	3.1 kg

### Versatile applications



Joint with biscuits



Joint with Clamex S



Wood repairs



Classic X	Part no.
in systainer.....	101600S
in carton .....	101600K

### Kit contains

Classic X with:	– stop square
– carbide tipped cutter	– spacer 4 mm
– suction stub 36 mm	– tool set

Accessories starting page 100



# Top 21

The original biscuit joiner with height adjustable blade from the inventor of biscuit joiners. Choose Lamello for precision, reliability, longevity and many additional applications

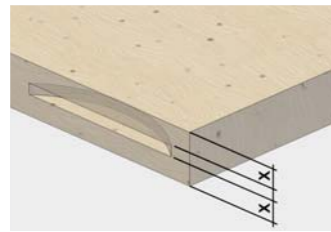

Adjust groove to middle

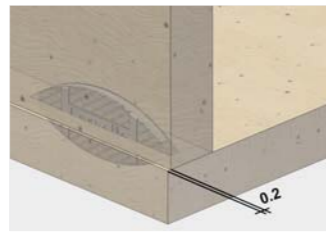

Off-set workpieces

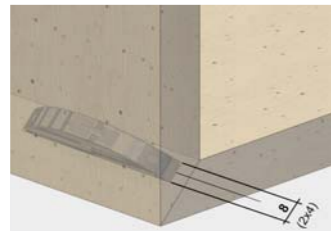

Double cut for Clamex S

## Unique features

### 1. Height adjustable cutter

SMS: Step Memory System

- Scale +/- 2 mm in steps of 0.1 mm (total 4 mm)
- Adjust groove position to exact **center of the workpiece** (material thickness 8 – 24 mm)
- Easy joining of laterally **off-set workpieces**
- Double cut 2 x 4 mm **for Lamello Clamex S**
- **Expansion gaps** (adjustable from 8 to 12 mm) adjustable in steps of 0.1 mm
- Individual positioning of the groove

### 2. Powerful 800 W motor

- Powerful, electronically controlled motor with soft start, constant speed control, overload protection and restart protection
- Service friendly, minimal cost for maintenance and repair

### 3. Precision cutter

with 4 scoring teeth and hub

### 4. Including dust bag

and adapter Ø 36 mm

## Technical data

Power / Voltage.....	1'050 W / 230 V
	800 W / 120 V
Speed .....	9'000 min-1
Cutter.....	Carbide tipped cutter with hub Ø 100 x 4 x 22 mm
Teeth .....	Z2 + V4 with scoring teeth
Cutting depth max.....	20 mm
Weight.....	3.5 kg

<b>Top 21</b>	<b>Part no.</b>
in systainer.....	
in systainer with carbide reversing blade cutter .....	<b>101500S</b>
	<b>101500SW</b>

## Kit contains

- |                         |                      |
|-------------------------|----------------------|
| Top 21 with:            | – spacer 4 mm        |
| – carbide tipped cutter | – suction stub 36 mm |
| – suction stub 23 mm    | – dust bag           |
| – stop square           | – tool set           |

Accessories starting page 100



**Carbide tipped groove cutter Part no.**  
 Ø 100 x 4 x 22 mm  
 for Zeta, Top, Classic  
 for Classic  
**132000**  
**132106**



# Lamello-System

www.lamello.com

<p><b>original wooden biscuit</b></p> <p><b>0</b> 1000 pieces Size 47 x 15 x 4 mm</p> <p><b>Part no.</b> <b>144000</b></p>	<p><b>20</b> 1000 pieces Size 56 x 23 x 4 mm</p> <p><b>Part no.</b> <b>144020</b></p>	<p><b>E20-L</b></p> <p><b>Self-clamping element</b> Size 56 x 11.5 x 4 mm</p> <p><b>Part no.</b> <b>145022</b> <b>145025</b> <b>145027</b></p>	<p><b>K20</b></p> <p><b>Clamping element</b> Size 60 x 24 x 4.5 mm</p> <p><b>Part no.</b> <b>145001</b> <b>145000</b></p>	<p><b>C20</b></p> <p><b>Biscuit for solid surface</b> Size 60 x 23 x 4 mm</p> <p><b>Part no.</b> <b>145010</b></p>	<p><b>Simplex</b></p> <p><b>Detachable slide-in connector</b> Size 54 x 23 x 4 mm</p> <p><b>Part no.</b> <b>166101</b> <b>166100</b></p>
<p><b>10</b> 1000 pieces Size 53 x 19 x 4 mm</p> <p><b>Part no.</b> <b>144010</b></p>	<p><b>H9**</b> 1000 pieces Size 38 x 12 x 3 mm</p> <p><b>Part no.</b> <b>144009</b></p> <p>**Carbide tipped groove cutter Ø 78 x 3 x 22 mm, Part no. 132009</p>	<p><b>E20-H</b></p> <p><b>Self-clamping element</b> Size 23 x 28 x 4 mm</p> <p><b>Part no.</b> <b>145021</b> <b>145026</b> <b>145028</b></p>	<p><b>Clamex S-18*</b></p> <p><b>Connector with screw insertion</b> Size 66 x 29 x 8 mm</p> <p>* Cutter with reversible blades: Ø 100 x 8 x 22 mm, Part no. 132108</p> <p><b>Part no.</b> <b>145231</b> <b>145236</b> <b>145241</b> <b>145251</b></p>	<p><b>C10</b></p> <p><b>Biscuit for solid surface</b> Size 53 x 19 x 4 mm</p> <p><b>Part no.</b> <b>145012</b></p>	

# Accessories / Lamello-System



251044

Stop square for Zeta P2, Top 21, Classic X	Part no.
For stabilising the biscuit joiner in the vertical position, ideal for obtuse miter joints.....	<b>251044</b>



253026

Spacer for biscuit joiner	Part no.
5 mm, aluminium for 18 mm panels.....	<b>for Top 21 / Zeta / Classic..... 253027</b>
2 mm, plastic for 16 mm panels.....	<b>for Top 21 / Zeta / Classic..... 253023</b>
4 mm, plastic for miters.....	<b>for Top 21 / Zeta / Classic..... 253026</b>



331565E

Systainer T-Loc Size II	Part no.
Systainer II T-loc, empty.....	<b>331565</b>
Insert with two partitions for systainer II.....	<b>360016</b>
Insert systainer T-loc II for Zeta P2, Top21, Classic X.....	<b>360014</b>

# Accessories / Lamello-System



132000

Carbide tipped groove cutter, Ø 100 x 4 x 22 mm	Part no.
Z2 + V4 scoring teeth, 4 screw holes, hub.....	<b>for Zeta, Top 20, Top 21, Classic.. 132000</b>
Z6 alternating teeth, without hub, with spacer.....	<b>for Classic..... 132106</b>
Countersunk bolts, M4 x 8, Torx.....	<b>352408T</b>



132106

Carbide tipped groove cutter, Ø 78 x 3 x 22 mm	Part no.
Z4, 4 Screw holes, with hub for biscuit H9.....	<b>for Zeta, Top 20, Top 21, Classic.. 132009</b>



132001

Carbide tipped groove cutter with reversible blades, Ø 100 x 4 x 22 mm	Part no.
Z2 + V2, 4 screw holes with hub.....	<b>for Zeta, Top 20, Top 21, Classic.. 132001</b>
Z4 + V4, 4 screw holes without hub, with spacer.....	<b>for Zeta, Top 20, Top 21, Classic.. 132130</b>
Set of 4 pieces.....	<b>for Part no. 132001..... 132111</b>
Countersunk screws.....	<b>for Part no. 132001..... 352408T</b>
Allen key, 4 mm long.....	<b>for Part no. 132001..... 271959L</b>
Set of 10 pieces main teeth.....	<b>for Part no. 132130..... 132134</b>
Set of 10 pieces scoring teeth.....	<b>for Part no. 132130..... 132135</b>
Replcement-Set, 4 scoring teeth + 4 main teeth.....	<b>for Part no. 132130..... 132133</b>
Screws.....	<b>for Part no. 132130..... 352130</b>
Torx key.....	<b>for Part no. 132130..... 352133</b>



132130

Carbide tipped groove cutter with reversible blades, Ø 100 x 8 x 22 mm (Clamex S connector)	Part no.
Z4 + V4, 4 screw holes.....	<b>for Top 20, Top 21, Classic..... 132108</b>
Set of 10 pieces scoring teeth.....	<b>for Part no. 132108..... 132137</b>
Set of 10 pieces main teeth.....	<b>for Part no. 132108..... 132136</b>
Replacement-Set, 4 scoring teeth + 4 main teeth.....	<b>for Part no. 132108..... 132114</b>

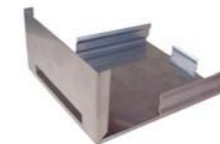

251057

Slide shoe, to protect the wall and the machine	Part no.
From year of manufacture 1999.....	<b>for Experta, Classic C2, C3..... 251057</b>
	<b>Top 20, S, S2, S3, S4, Top 21, Zeta</b>



132350

Carbide tipped saw blades for expansion gaps, Ø 100 x 2.4 x 22 mm	Part no.
Z20, 4 screw holes, 2 spacers.....	<b>for Zeta, Top 20, Top 21, Classic.. 132350</b>

Accessories for saw blades	Part no.
Spacer, 40 x 20 x 1mm with screw holes.....	<b>for Zeta, Top 20, Top 21, Classic.. 322510</b>
Flange M8.....	<b>for Zeta, Classic..... 252502</b>



125250

Clamex S drill jig 30°-150°	Part no.
Drill jig (60 mm) incl. drill for Clamex S.....	<b>125240</b>

Clamex S installation set	Part no.
Drill jig for 30°-150° incl. drill and carbide tipped groove cutter.....	<b>125250</b>
with reversible blades 8 mm (132108).....	<b>for Lamello biscuit joiner</b>

## Setup of the machine for cutting expansion gap

Classic C2, C3, 3S Pa	8 mm	9 mm	10mm	11mm	12mm
Top 20, S2, S3, S4, Top 21	-2	-1	±0	+1	+2





Manufacturer:  
**Lamello AG**  
**Joining technology**  
Hauptstrasse 149  
CH-4416 Bubendorf  
Tel. +41 61 935 36 36  
Fax +41 61 935 36 06  
info@lamello.com  
www.lamello.com