

# EVpack-fuse MEV70

700 VDC Max., L/R ≤ 1ms, 35 - 600A

## BATTERY FUSES

## BATTERY PACK FUSES



John G Peck Ltd

Unit B1 Wymeswold Industrial Park,  
Burton on the Wolds  
Loughborough  
Leics, LE12 5TY, UK

UK Stockists for MERSEN DC fuses;

[www.igpl.com](http://www.igpl.com)

Email: [enquiries@igpl.com](mailto:enquiries@igpl.com)

Tel: 01509 881010



## FEATURES & BENEFITS

- Design for DC applications
- Low watt losses
- High cycling performance
- Full coverage of battery module voltage and current
- Ultra compact size
- Current Ratings (In): 35 to 600A
- Interrupting Rating (IR): 20kA @ 700VDC, L/R ≤ 1ms
- High inrush current capability

## APPLICATIONS

- EV/HEV
- Electrical Energy Storage
- Battery pack protection
- Battery Disconnect Unit (BDU)
- Battery Junction Box for auxiliaries
- Battery charger
- Supercapacitor pack protection
- Backup protection for DC relay / disconnecter / switch
- Maintenance Safety Disconnect (MSD)

## STANDARDS

- Power Cycling & Vibration: JASO D622



EV pack-fuse

EVpack-fuse line-up belongs to the new DC Over-Current protection (O.C.P.) range developed by MERSEN to address specific needs in EV/HEV and Battery Electrical Storage System

EVpack-fuse provides the ultimate protection of the battery pack offering reliable clearing of DC fault currents.

It has been specifically engineered and tested to provide DC applications best-in-class protection performance: Up to 700VDC, Current rating (In)= 35 to 600A, Interrupting Rating (IR) = 20kA, L/R ≤ 1ms, Minimum Breaking Capacity (MBC) < 3kA for a perfect matching with DC contactor in addition to withstanding high inrush current auxiliary applications (e.g. air conditioning...) with MEV70V.

## Typical usage of EVpack-fuse in Mersen DC protection family

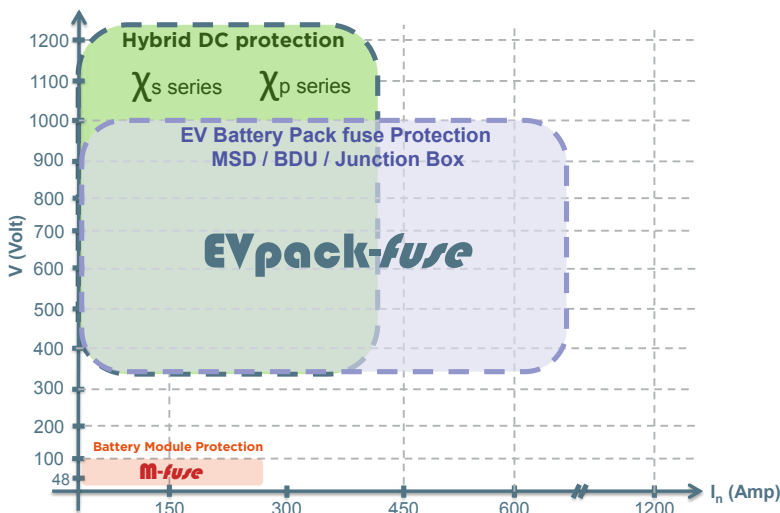

## PRODUCT RANGE



MEV70V100-S

### MEV70V -S Surface Mount Fuse

| Catalog number | Rated DC voltage | Rated current I <sub>n</sub> | Power dissipation at 0.5 I <sub>n</sub> | Min. breaking capacity (MBC) | Max. time to clear MBC | Weight |
|----------------|------------------|------------------------------|---|------------------------------|------------------------|--------|
| MEV70V35-S     | 700 V            | 35 A                         | 0.86 W                                  | 125 A                        | 5 s                    | 9.9 g  |
| MEV70V40-S     | 700 V            | 40 A                         | 0.82 W                                  | 150 A                        | 5 s                    | 9.9 g  |
| MEV70V50-S     | 700 V            | 50 A                         | 1.2 W                                   | 175 A                        | 5 s                    | 9.9 g  |
| MEV70V60-S     | 700 V            | 60 A                         | 1.47 W                                  | 200 A                        | 5 s                    | 9.9 g  |
| MEV70V70-S     | 700 V            | 70 A                         | 1.89 W                                  | 200 A                        | 30 s                   | 59 g   |
| MEV70V80-S     | 700 V            | 80 A                         | 1.75 W                                  | 270 A                        | 30 s                   | 59 g   |
| MEV70V100-S    | 700 V            | 100 A                        | 2 W                                     | 330 A                        | 30 s                   | 59 g   |
| MEV70V125-S    | 700 V            | 125 A                        | 2.74 W                                  | 1500 A                       | 150 ms                 | 59 g   |
| MEV70V150-S    | 700 V            | 150 A                        | 3.54 W                                  | 1500 A                       | 200 ms                 | 59 g   |
| MEV70V160-S    | 700 V            | 160 A                        | 3.75 W                                  | 1500 A                       | 300 ms                 | 59 g   |
| MEV70V175-S    | 700 V            | 175 A                        | 4.63 W                                  | 1500 A                       | 420 ms                 | 59 g   |



MEV70A600-4

### MEV70A Round Body Fuse

| Catalog number | Rated DC voltage | Rated current I <sub>n</sub> | Power dissipation at 0.5 I <sub>n</sub> | Min. breaking capacity (MBC) | Max. time to clear MBC | Weight |
|----------------|------------------|------------------------------|---|------------------------------|------------------------|--------|
| MEV70A50-4     | 700 V            | 50 A                         | 1.4 W                                   | 380 A                        | 50 ms                  | 99 g   |
| MEV70A60-4     | 700 V            | 60 A                         | 1.8 W                                   | 460 A                        | 50 ms                  | 99 g   |
| MEV70A70-4     | 700 V            | 70 A                         | 2.2 W                                   | 540 A                        | 50 ms                  | 99 g   |
| MEV70A80-4     | 700 V            | 80 A                         | 2.5 W                                   | 610 A                        | 50 ms                  | 99 g   |
| MEV70A90-4     | 700 V            | 90 A                         | 2.7 W                                   | 690 A                        | 50 ms                  | 99 g   |
| MEV70A100-4    | 700 V            | 100 A                        | 3.1 W                                   | 760 A                        | 50 ms                  | 99 g   |
| MEV70A125-4    | 700 V            | 125 A                        | 3.8 W                                   | 870 A                        | 60 ms                  | 165 g  |
| MEV70A150-4    | 700 V            | 150 A                        | 4.5 W                                   | 1040 A                       | 60 ms                  | 165 g  |
| MEV70A175-4    | 700 V            | 175 A                        | 5.2 W                                   | 1210 A                       | 60 ms                  | 165 g  |
| MEV70A200-4    | 700 V            | 200 A                        | 5.9 W                                   | 1380 A                       | 60 ms                  | 165 g  |
| MEV70A225-4    | 700 V            | 225 A                        | 6.7 W                                   | 1190 A                       | 140 ms                 | 260 g  |
| MEV70A250-4    | 700 V            | 250 A                        | 7.4 W                                   | 1320 A                       | 140 ms                 | 260 g  |
| MEV70A300-4    | 700 V            | 300 A                        | 8.8 W                                   | 1580 A                       | 140 ms                 | 260 g  |
| MEV70A350-4    | 700 V            | 350 A                        | 10.2 W                                  | 1840 A                       | 140 ms                 | 260 g  |
| MEV70A400-4    | 700 V            | 400 A                        | 11.7 W                                  | 2100 A                       | 140 ms                 | 260 g  |
| MEV70A450-4    | 700 V            | 450 A                        | 12.4 W                                  | 2200 A                       | 360 ms                 | 517 g  |
| MEV70A500-4    | 700 V            | 500 A                        | 13.9 W                                  | 2460 A                       | 360 ms                 | 517 g  |
| MEV70A600-4    | 700 V            | 600 A                        | 16.6 W                                  | 2950 A                       | 360 ms                 | 517 g  |

## TIME CURRENT CHARACTERISTIC CURVES

### MEV70V-S

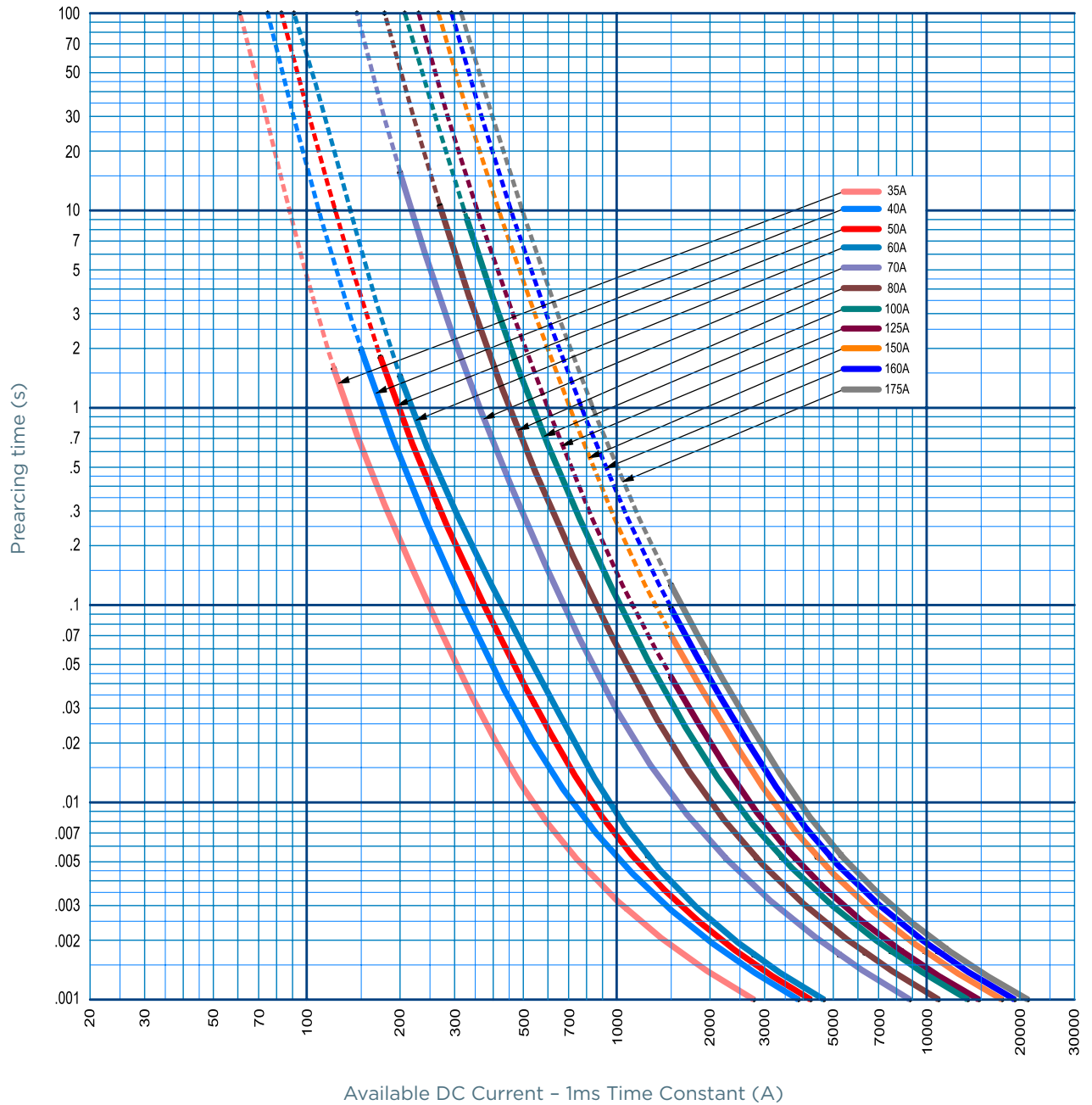

MERSEN reserves the right to change, update or correct, without notice, any information contained in this datasheet.

TIME CURRENT CHARACTERISTIC CURVES

MEV70A

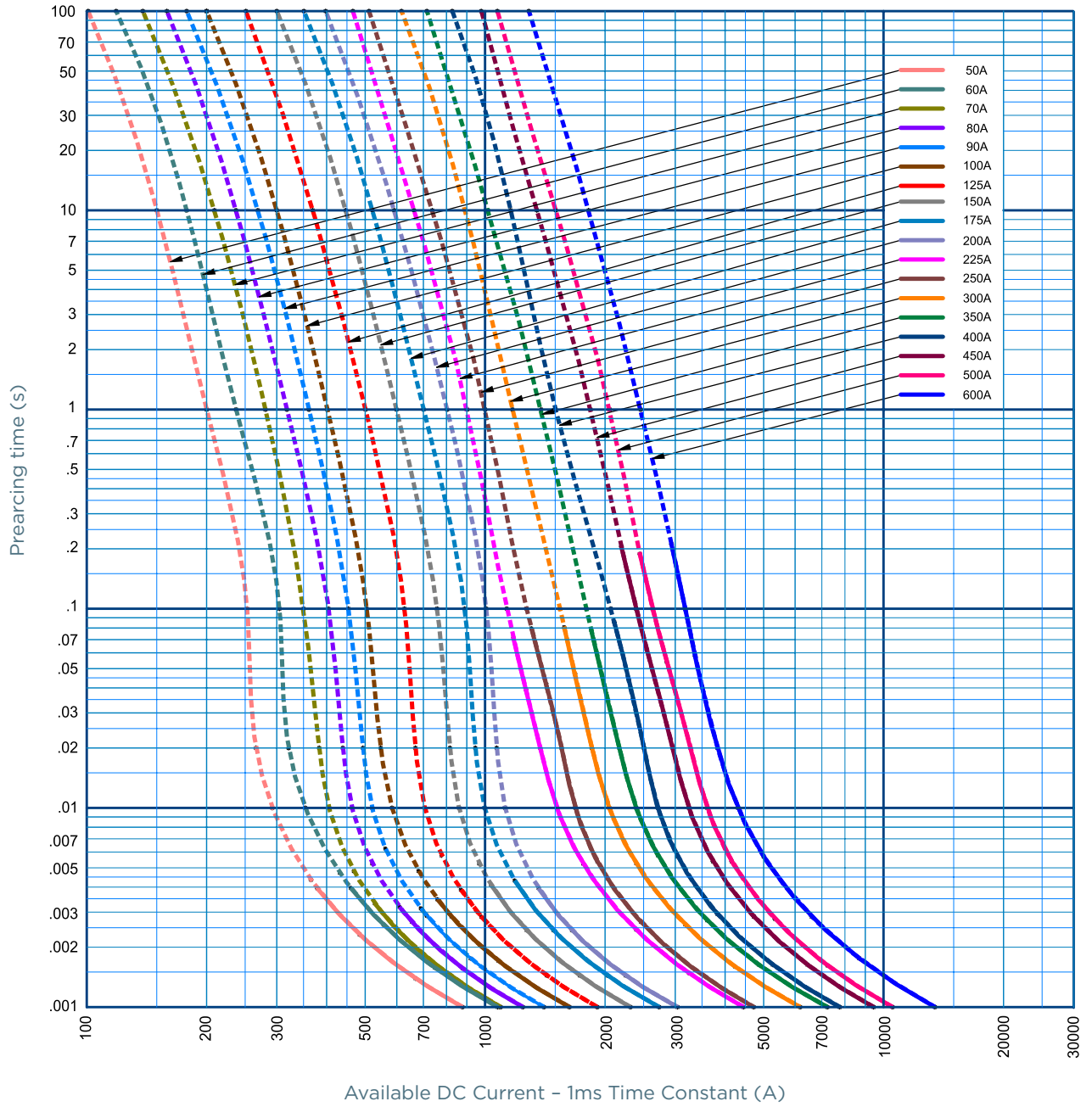

MERSEN reserves the right to change, update or correct, without notice, any information contained in this datasheet.

## POWER DISSIPATION

### MEV70V-S

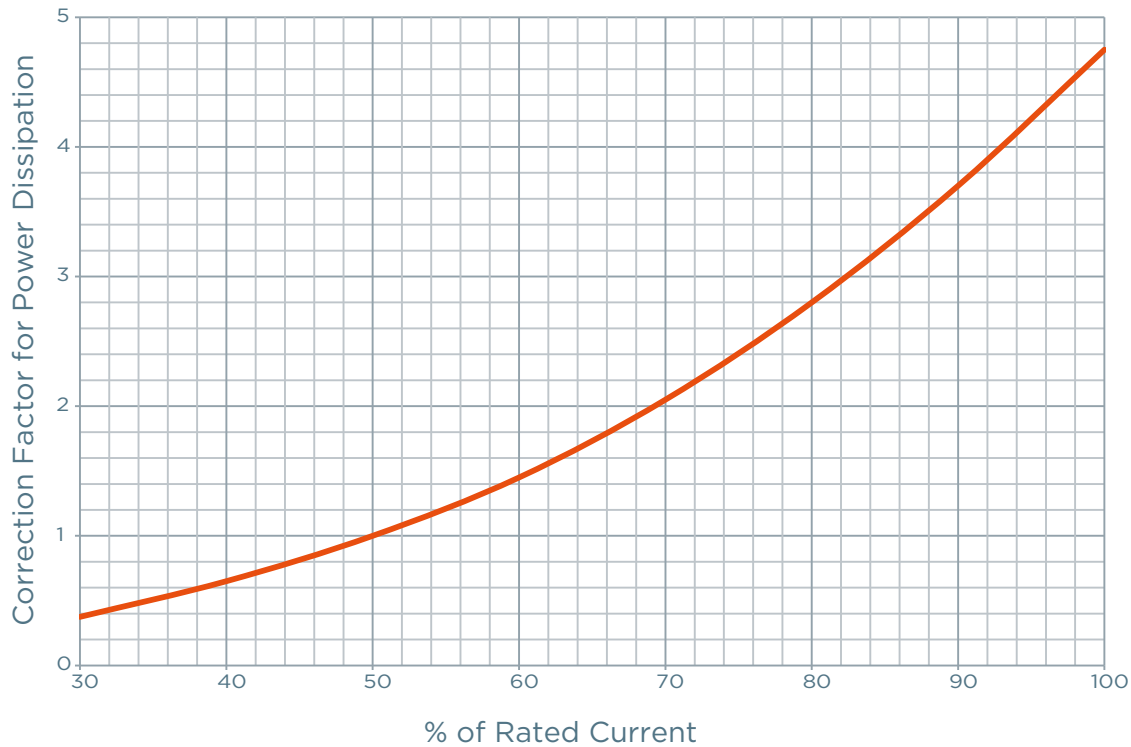

### MEV70A

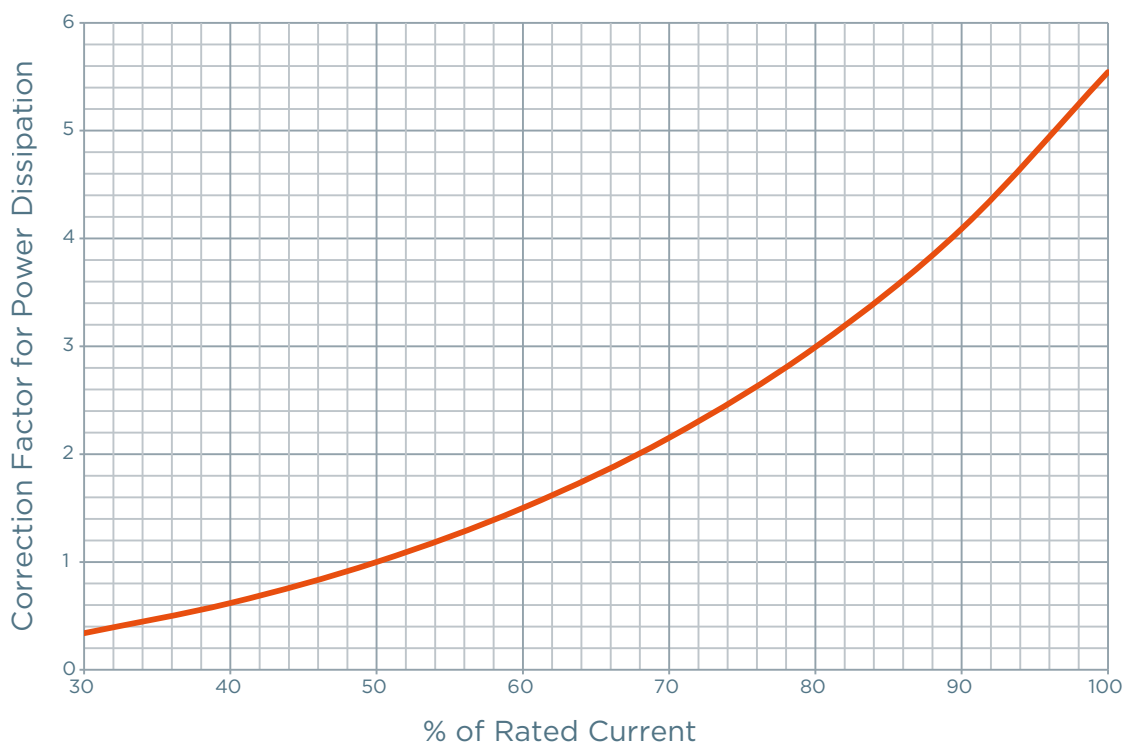

MERSEN reserves the right to change, update or correct, without notice, any information contained in this datasheet.

## TEMPERATURE DERATING

### MEV70V-S & MEV70A

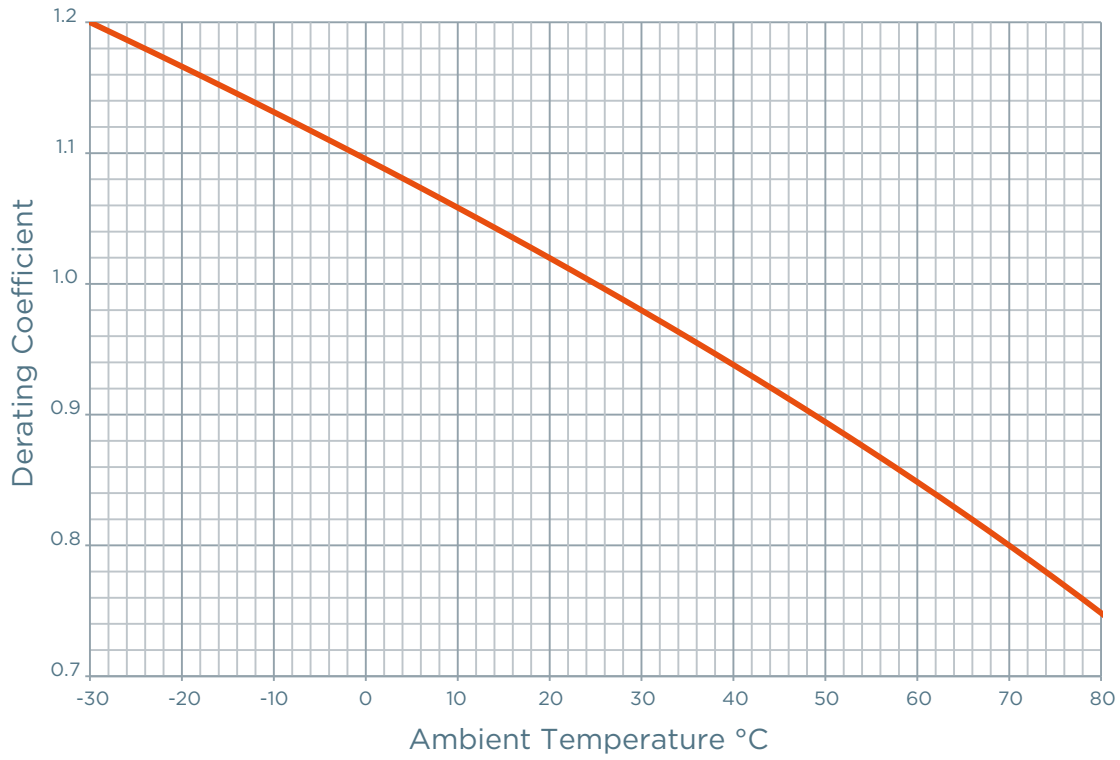

## DIMENSIONS

### MEV70V -S (35-60A)

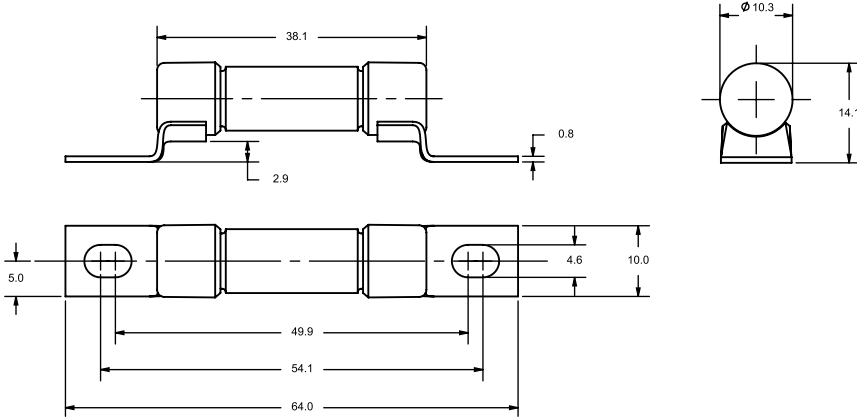

Dimensions in mm

### MEV70V -S (70-175A)

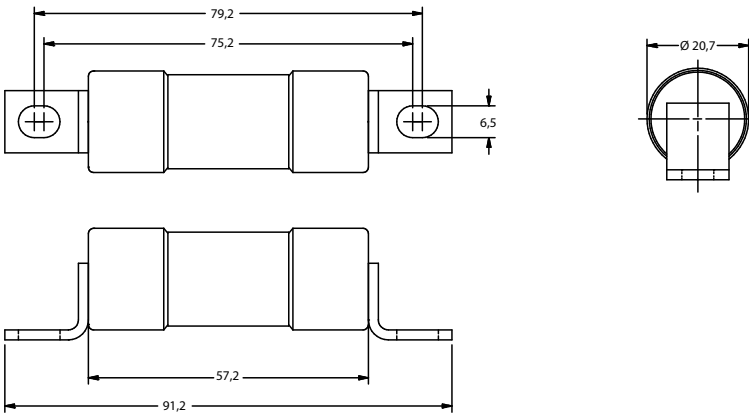

Dimensions in mm

### MEV70A -4 (50-600A)

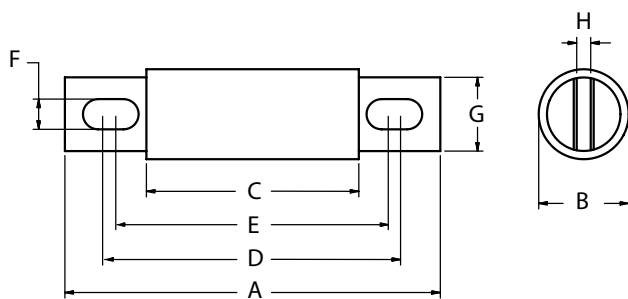

| Article Number                   | A            | B           | C            | D            | E             | F            | G           | H           |
|----------------------------------|--------------|-------------|--------------|--------------|---------------|--------------|-------------|-------------|
| MEV70A50 to 100<br>(inch. / mm)  | 3,63<br>92,2 | 1<br>25,4   | 2,13<br>54,1 | 2,94<br>74,7 | 2,75<br>69,85 | 0,31<br>7,9  | 0,5<br>19   | 0,13<br>3,2 |
| MEV70A125 to 200<br>(inch. / mm) | 3,63<br>92,2 | 1,22<br>31  | 2,13<br>54,1 | 2,94<br>74,7 | 2,81<br>71,4  | 0,31<br>7,9  | 1<br>25,4   | 0,19<br>4,8 |
| MEV70A225 to 400<br>(inch. / mm) | 4,34<br>110  | 1,5<br>38,1 | 2,09<br>53,1 | 3,41<br>86,6 | 2,78<br>70,6  | 0,41<br>10,4 | 1<br>25,4   | 0,25<br>6,4 |
| MEV70A450 to 600<br>(inch. / mm) | 4,47<br>114  | 2<br>50,8   | 2,22<br>56,4 | 3,53<br>89,7 | 2,91<br>73,9  | 0,41<br>10,4 | 1,5<br>38,1 | 0,25<br>6,4 |