

Drone-Clone Xperts Ultimate INSTRUCTIONS GUIDE for your New Drone X Pro XTREME

(If Instructions are too small to read, press Ctrl + on Keyboard to ZOOM in)

Table of Contents

Quick Start Instructions	2
Calibrating Drone-Clone Xperts Drone X Pro XTREME: Step by step guide	3
<i>Calibrating the Drone X Pro XTREME by remote controller</i>	4
<i>Calibrating the Drone X Pro XTREME by phone APP</i>	5
*Fine-Tuning (“Trimming”) your DXP XTREME	6
Connecting Drone X Pro XTREME to WiFi	8

NOTE:

[*NECESSARY INSTRUCTIONS for OPTIMAL CONTROL Fine-Tuning \(“Trimming”\) your DXP XTREME \(PAGE 6\)](#)

Quick Start Instructions

✈️ QUICK START INSTRUCTION ✈️

▶ PREPARING FOR FLIGHT



1. Pull out all four arms carefully. Turn on the drone and place it on a flat level surface.



2. Power switch on of the controller.

▶ ONE-KEY TAKE OFF/LANDING



1. Push the left throttle up and pull it back for code matching. Push both sticks 45 degrees towards outside for calibration.

TIP: For a more stable flight, it is best to calibrate before taking off.



2. Press the **ONE-KEY TAKE OFF** button, the drone will take off and automatically hovers at a certain altitude.
3. Press the **ONE-KEY LANDING** button, the drone will fly down slowly landing gently on the ground.

Calibrating Drone-Clone Xperts Drone X Pro **XTREME**:

Step by step guide



Sometimes after minor crashes, drones start to fly abnormally even if there are no physical damages (like faulty propellers). Performing gyro-calibration can solve sideward flying or other flight disorders.

You can reset the Drone X Pro **XTREME**'s gyro settings in two different ways, either using the remote control or through the JY UFO phone APP (available for DL on virtually all smartphones with WiFi access).

Calibrating the Drone X Pro **XTREME** by remote controller



- **Step 1:** Turn on the remote controller;
 - **Step 2:** Long press the power switch (located on top of drone) to turn ON your Drone X Pro **XTREME**;
 - **Step 3:** Place the drone on a horizontal surface.
 - **Step 4:** Bind the transmitter with the drone by pushing the throttle (left joystick) up to the highest position, and then pulling it straight down to the lowest position **↑↓**. Solid light will indicate successful bind.
 - **Final Step:** Move both sticks to lowest right corner (like in the image above) for about 2-3 seconds. LED lights will start to flash rapidly. Wait a few seconds till the lights are solid again and you are done.
-

Calibrating the Drone X Pro XTREME by phone APP

Calibrating the Drone X Pro XTREME through APP is even easier. After you connected to drone with your phone. You need to enter the settings menu (like in the image bellow) and select the "Gyro calibrate" icon. First, the LEDs will start to flash rapidly, then turn solid. Finish! That was all, you are done and ready for your next flight!

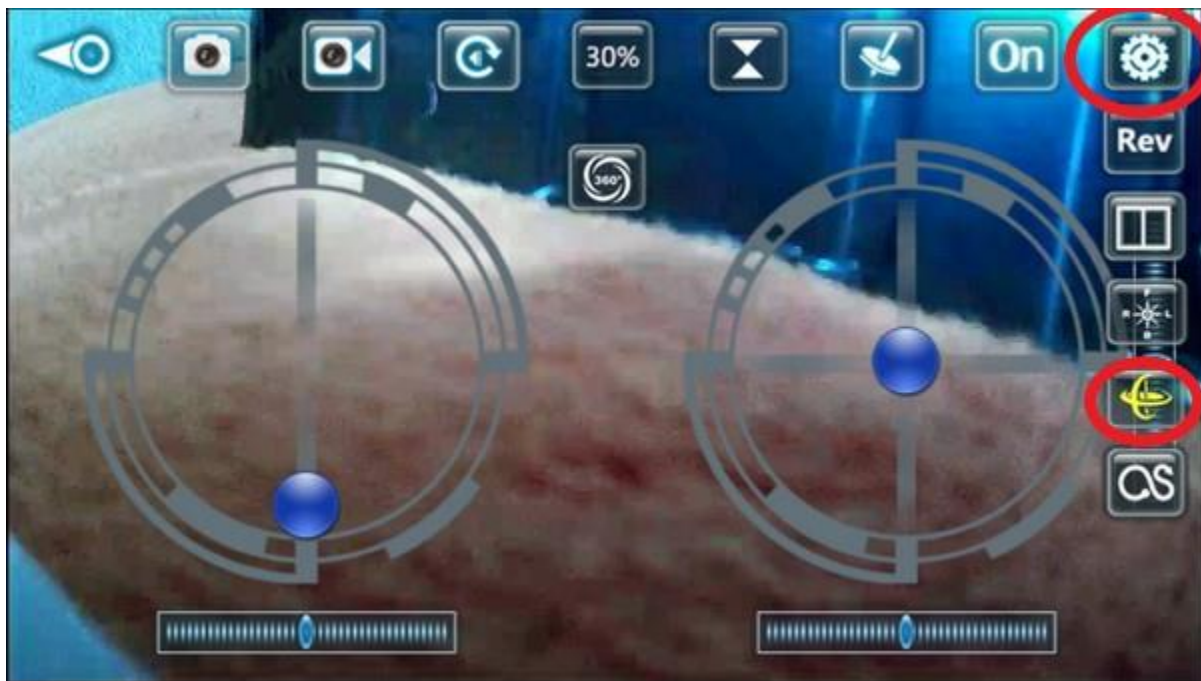

****Fine-Tuning (“Trimming”) your DXP XTREME****

Video Link to Download Trimming [Drone X Pro XTREME-Trim Instructions.MOV](#)

This section is starred because the absolute **BEST Tip** for Beginner Drone Pilots is learning how to fine-tune their drone by using the “TRIM” buttons. These buttons will give you optimal control of your Drone X Pro XTREME. When used correctly, your drone will steadily hover in one location without drifting.

If your drone starts drifting in a certain direction directly after take-off **DON'T PANIC!** Everything is **COMPLETELY NORMAL**. All you have to do is **TRIM** this drone in the opposite direction.

Trimming Examples

Q) After take-off, my drone **DRIFTS TO THE RIGHT**

A) Trim Drone to **LEFT** using **LEFT** Trim button

Q) After take-off, my drone **DRIFTS FORWARDS**

A) Trim Drone **BACKWARDS** using **DOWN** Trim button

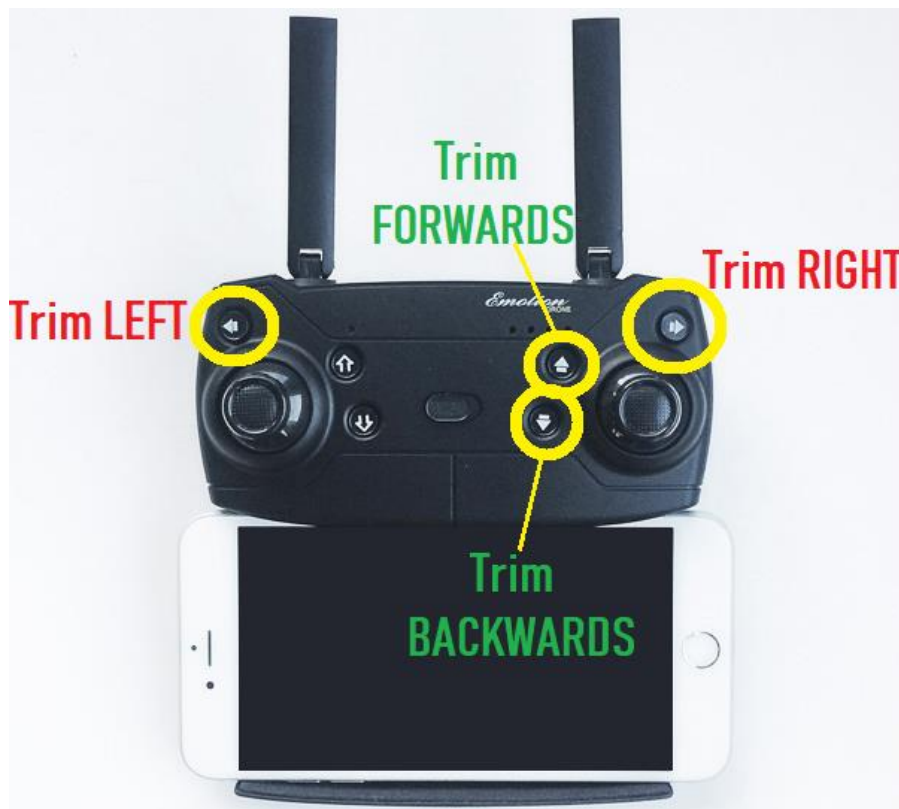

4、Flight control

A.Throttle (left lever)

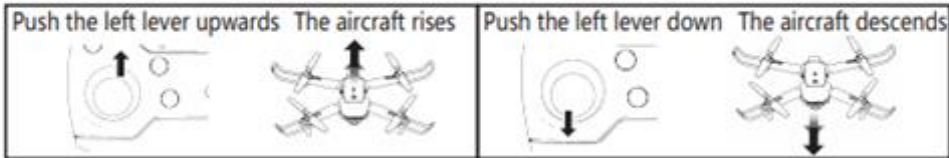

B.Forward and backward (right lever) (with camera front side)

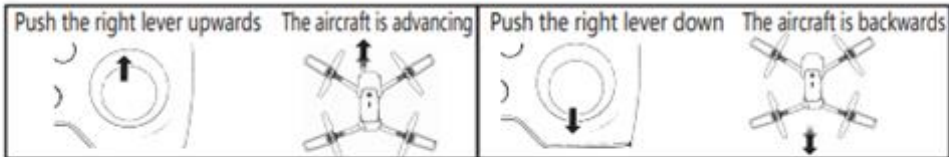

C.Left and right side fly

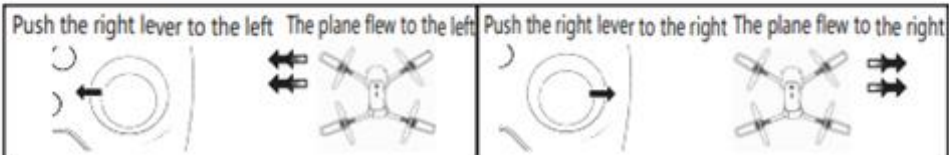

D.Turn left and right (with camera front side)

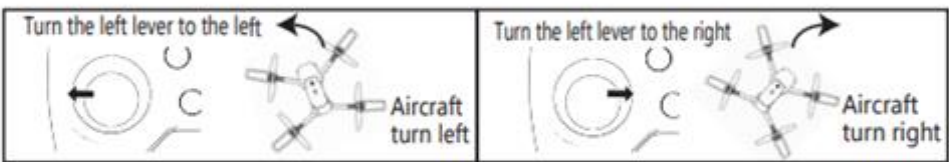

5、Fine-tuning control (with camera front side)

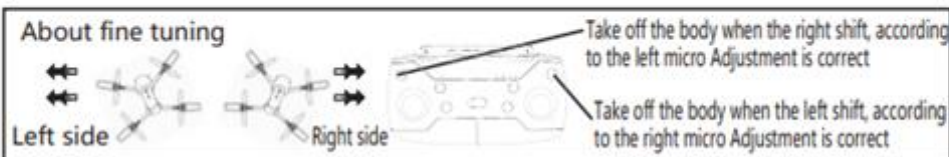
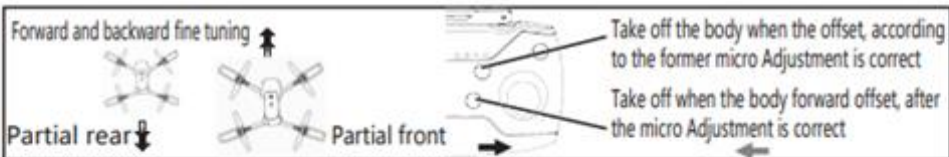

Important safety information

- (1) The product is not a toy, but the mechanical, electronic, aerodynamics, high-frequency transmission and other professional knowledge into one of the fine Dense equipment, the need for proper assembly and commissioning to avoid accidents. The product holder must use a safe way. Operation control: improper operation, may cause serious personal injury or property damage. We are not responsible for this. Because we can not control the assembly, use, operation process.
- (2) This product is suitable for people with operating model experience, the age of not less than 14 years of age.
- (3) The flight site must be a local legal remote control model flight site.
- (4) Once the product is sold, we will not be responsible for any safety and safety arising from operation and use, control, etc.
- (5) If any using, operating and measuring problems, please contact with local distributors, for we have assigned those distributors to provide technical support and after sales service.

2. Safety Precautions:

- Remote control model aircraft is a high-risk goods, must be away from the crowd when flying. Artificial assembly or body damage, electronic control, improper equipment, and operation are not familiar with, are likely to cause damage to the aircraft or personal injury and other unpredictable accidents. Please Pilots must pay attention to safety, and need to understand due to their own negligence caused by accidental responsibility.
- (1) Away from obstacles and crowds
 - (2) The flight of the remote control flight has an uncertain flight speed and state, there is a potential risk. Fly away from the flight. People, high-rise buildings, high-voltage wires, etc., while avoiding wind and rain, thunderstorms and other bad weather flight to ensure that pilots. The surrounding population and the safety of the property.
 - (3) Safe operation
 - (4) Keep away from high-speed rotating parts
 - (5) Keep away from heat
- Please operate the remote control aircraft according to your own status and flight skills. Fatigue, poor spirit or improper operation will increase. Probability of accidental risk.
- When the propeller in the high-speed flight, the pilot, the surrounding crowd and objects away from the rotating parts, so as to avoid danger and damage.
- Remote control aircraft is composed of metal, fiber, plastic, electronic components and other materials, so as far as possible away from heat, to prevent day. Drying, to avoid deformation caused by high temperature or even damage.

The plant is made of lithium polymer battery (LiPo)

Lithium batteries are different from the general battery, which consists of a thin layer of thin paper wrapped with its chemical endoplasm. This can be great. To reduce its weight, but it makes it more vulnerable in the face of rough or inappropriate operations. Like the same. There is a battery, as inappropriate operation will cause a fire explosion.

- Do not put the battery in the model for charging, which may cause the battery to fire and damage you of the aircraft.
- If you plan to use this product for one week or more, keep the battery 50% Increase the battery life. Keep the battery 50% of the battery, just use the battery when fully charged Half of the time to charge.
- Please use the original professional charger to charge the battery.
- Do not charge the carpet to prevent fire.
- Lithium battery in the storage for more than three months after the need to charge to maintain the voltage to ensure that it should have of life.

Remote control and aircraft battery installation and charging instructions

Remote control battery installation:

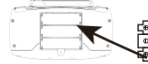

As shown in the figure according to the electrode box electrode instructions (+ / -) Place the battery correctly (as shown).

The aircraft battery is charged

1. Connect the USB cable to the computer to charge: USB charging end connected to the aircraft battery plug, the other end can be connected to the computer USB port to charge the battery, charging lights, full when the lights off.
2. Connecting the aircraft power supply: Put the charged battery into the battery holder of the aircraft, and then place the battery plug at the power supply on the vehicle into the socket for power connection, connected to open the aircraft power, then the aircraft lights.

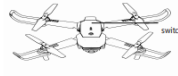
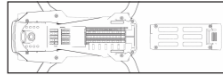

Aircraft installation

1. Folding function display

When folding, please fold the back Show arms, and then folded in front of the arm, Expand the opposite!



2. Aircraft fan installation

Please follow the correct direction to install the propeller, propeller on the sign. Installed to the upper left corner of the aircraft and the lower right corner of the arm, with the phase. With the propeller on the sign B mounted to the upper right corner of the aircraft and the lower left corner of the arm, the installation of the fan folder when the alignment of the cone assembly Square accessories, installed in place after the locking screw!

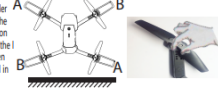

3. Aircraft protection rack installation

The protective frame at the aircraft arm position (pictured) Install fastening.

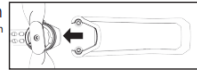

Remote control function name

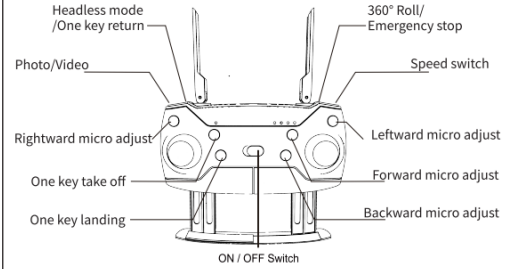

Remote control

1. Mobile phone rack

Pull out the remote control lower bracket, clamp the phone.

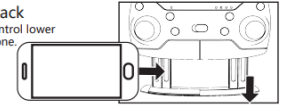

2. 2.4G frequency

Open the aircraft power switch, the aircraft indicator light flashes, open the remote control power. Source switch, the throttle joystick pushed to the highest after the pull to the lowest. Buzzer prompt "tick" sound! The aircraft indicator light is on, right Frequency to complete, then you can take off!

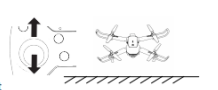

3. A key to start and a key landing

Tip: This product is determined by the barometer. In a variety of environmental temperature and other factors. The aircraft will automatically start when flying or low voltage. Appear high and low changes are normal!

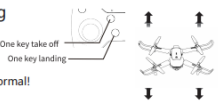

control function name

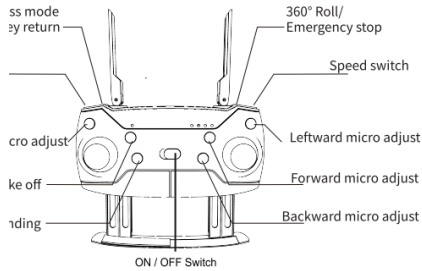

control

Mobile phone rack

Pull out the remote control lower bracket, clamp the phone.

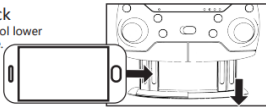

frequency

Open the aircraft power switch, the aircraft indicator light flashes, open the remote control power. Source switch, the throttle joystick pushed to the highest after the pull to the lowest. Buzzer prompt "tick" sound! The aircraft indicator light is on, right Frequency to complete, then you can take off!

A key to start and a key landing

This product is determined by the barometer. In a variety of environmental temperature and other factors. The aircraft will automatically start when flying or low voltage. Appear high and low changes are normal!



4. Flight control

A. Throttle (left lever)

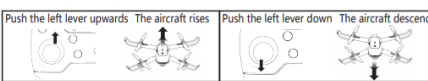

B. Forward and backward (right lever) (with camera front side)

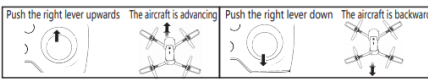

C. Left and right side fly

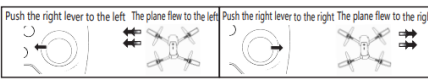

D. Turn left and right (with camera front side)

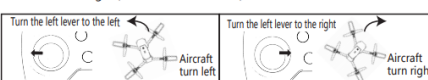

5. Fine-tuning control (with camera front side)

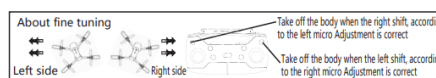

Directional definition and mode selection of headless mode

When converting to headless mode, the aircraft will give up its front and rear azimuths, and reposition the front and rear with the remote control as a reference point. Such as when the right lever to push forward, the aircraft will fly away from the remote control; when the right lever to pull back, the aircraft will fly to the remote control. (With camera front side)

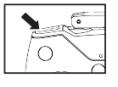

1. The direction of the aircraft before departure: the direction of the aircraft forward in front of you. (With the camera side for the front) remote control to the end of the direct flight and then press a key. Take off, that is, to complete the flight head mode direction definition.
2. When flying by the headless mode of the remote control issued a "flute, flute" twice, the aircraft lights Light flashing into the headless mode. And then press the remote control issued a "flute" sound Exit the headless mode.

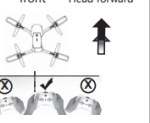

A key return

Press a key return, the aircraft will give up their own front and rear left and right direction, automatically defined by the headless mode of backward direction of flight, when the control of the right lever when the stop this function

Speed selection

Speed file is to advance, back and left and right side of the flight is divided into third gear speed, the remote control is turned on by default when the slow power, press the remote control button issued a "flute" "flute" twice as midfielder, "flute" "flute" "flute" press three times for the fast file, "flute" "soon return to slow file. (Recommended beginners with slow operation)

The remote control controls the recording

Video, camera keys (and mobile phone APP on the video, take pictures of a key, when using the remote control to control the aircraft through the remote control on the video, like the camera can also start WIFI film video or camera)

1. WIFI aerial version of the phone after 20 seconds after the phone can find WIFI connection and remote control to start the video or take pictures

2. When there is no connection to the APP must be guaranteed WIFI flight card on the SD card storage space remote control camera on the camera button has a role.

Connecting to WiFi & Downloading JY UFO APP

Aircraft settings reset

1. The reset setting is a horizontal reset of the six-axis gyroscope on the aircraft, and the micro adjustment of the remote control.
2. The operation before the aircraft in the horizontal position, Push the stick as the picture, 2 seconds after the remote control issued (flute) sound, the aircraft quickly flashing lights a few times that the reset set successfully.
3. This function is generally not used, only for aircraft maintenance adjustment or aircraft when a serious offset

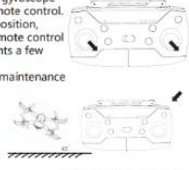

* Emergency landing

1. During the flying time if need urgent stop , press the button (as picture shown) , the drone will stop working. (Please do not attempt this operation while the drone regular flying in high altitude)
2. When the drone lean over 45 degrees , it will stop for protect the engine.
3. When use the App control the drone , slide the throttle down , and press the one key take off button , it will emergency landing.



Problem guide

Ask questions	The original for	Approach
Connect the flying saucer batteries and fly the indicator light on the doll carousels. Please operation to response.	Remote control and UFO is not successful	Please re-perform the remote control and the flying saucer
Connect the flying saucer battery there is rotating wrong with the rotor cloud.	1. Check if the remote control and the flying saucer are powered on. 2. Check whether the remote control and the UFO battery are in a low power state. 3. Is the battery positive and negative.	1. Turn on the remote control and insert the UFO battery. 2. Use full charge Full battery 3. Reinsert the battery and confirm that the battery and battery are positive or negative Pole piece of contact is normal.
Push the throttle lever. The motor does not turn and fly. The indicator light on the disc starts flashing.	UFO lithium battery power shortage	Charge the battery or replace another fully charged battery
The flying saucer main rotor continues to rotate at a high speed.	1. The main rotor deformation 2. UFO battery power shortage	1. Replace the main rotor 2. Charge or replace the battery with another battery
The flying saucer vibrates badly.	Main rotor deformation	1. Replace the main rotor
The flying saucer will all go into auto-rotate moving.	The gyroscope is not at all right	The remote control can be automatically corrected mode or restart the re-frequency
The flying saucer fell behind and lost far on the fly.	The gyroscope is not at all right	The remote control can be automatically corrected mode, or restart the re-frequency

Download APP connection

Download real-time aerial photography software "JY UFO", so that the aircraft during the flight FPV real-time transmission.



Before use, please open the aircraft power switch, the aircraft on the flat ground, open the phone WiFi link interface, Connect WiFi name to (WiFiUFO - ##) as shown in Figure 1.



3. WiFi connected later, open the APP, enter the main interface, as shown in Figure 2, Click "Play" to enter the user interface, as shown in Figure 3, click "" to enter ordinary control interface, click "" "Altitude hold" key to become "Black," enter the "Altitude hold" interface.

4. When the video connection is successful, you can see the WiFi camera through the phone screen Transfer the image.

2. Key function description



1. Accelerator
 - 2/3. Left / right rotation
 - 4/5. Left and right side fly
 - 6/7. Forward, backward
 - 8/9. Forward / backward trim
 - 10/11. Left / right spin flow tuning
 - 12/13. Left / right side fine tuning
 14. Take pictures
 15. Video recording
 16. Media Library
 17. Speed: 30% / 60% / 100%
 18. Set high
 19. Gravity sensing mode
 20. Show / hide virtual joystick
 21. Show / hide settings
 22. The lens is reversed
 23. 3D display
 24. Headless mode
 25. GYRO calibration
 26. Custom route
 27. 360° roll
 28. A key stop
 29. A key take off
 30. A key drop
 31. A key to unlock
 32. Voice command control
- Control of aircraft commands:
Move Forward, back, fly on the right, fly on the left.

1. The gravity sensor mode: click on the icon to enter the gravity sensor mode, after the success of the icon shows the yellow, so that you can shake the phone to control the aircraft forward, back, left fly, the right side of the fly. Click the icon again to return to the "bar mode!"



2. take pictures: the aircraft flying to the air, control the direction to the need to take pictures of the location, click the camera icon each shot a picture! After shooting to control the direction of the remote bar to change the camera target! Each time taking pictures for 0.5-1 seconds.



Note: Before operating this function, you must skillfully operate the four-axis aircraft.

3. Unlock the four-axis aircraft

Open the four-axis aircraft power switch, click on the high icon in Figure 1, and then click on the button in Figure 2 to unlock the icon, this time the aircraft propeller low-speed rotation.



Note: The camera lens of the four-axis aircraft indicates the front of the aircraft

Push the left joystick (throttle), the main motor speed increases, the four-axis aircraft rise. Push down the left joystick (throttle), the main motor speed down, four-axis aircraft down.



Left: push the left joystick (throttle), turn left the four-axis aircraft, push the left joystick to the right (throttle), turn right at the four-axis aircraft.

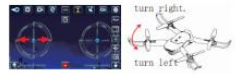

Push the left joystick up (rudder), the four-axis aircraft forward; push down the right joystick, the four-axis aircraft to the back.

Push the left joystick to the right (rudder), the right four-axis aircraft, and the right lever to the left, the left side of the four-axis aircraft.

Left joystick (throttle) to take off. When the motor starts to rotate, use the fine adjustment key to adjust the throttle.

Four-axis aircraft take the clockwise rotation, right-hand fine-tune key until it returns normal.

Four-axis aircraft take off directly counter rotation, then adjust the left rotation key.

Four-axis aircraft drifts directly to the left off, press the right side to fine-tune until it returns to normal.

Four-axis aircraft drifts directly to the right off, press the left side to fine-tune until it returns to normal.

Four-axis aircraft is moved backwards forward, forward trim key until it returns to normal.

Four-axis aircraft moves forward directly press the back-tune key until it returns normal.

Note: the four-axis aircraft is less than 30 cm high, it will be affected by the eddy currents in the ground, and will become unstable, "ground effect". The more the four-axis propeller the ground effect force.

Product main accessories name

- 01: Remote control
- 02: Main body cover
- 03: Main body under cover
- 04: Leaves
- 05: Front left axis
- 06: Front right axis
- 07: Behind left axis
- 08: Behind right axis
- 09: Battery
- 10: USB charger
- 11: Camera board
- 12: Camera board
- 13: Camera board

Number	Name	Quantity	Number	Name	Quantity
01	Main body cover	1	08	PCB board	1
02	Main body under cover	1	09	Motor	4
03	Leaves	4	10	Gear	4
04	Front left axis	1	11	Battery	1
05	Front right axis	1	12	USB charger	1
06	Behind left axis	1	13	Camera board	1
07	Behind right axis	1			

Connecting Drone X Pro XTREME to WiFi

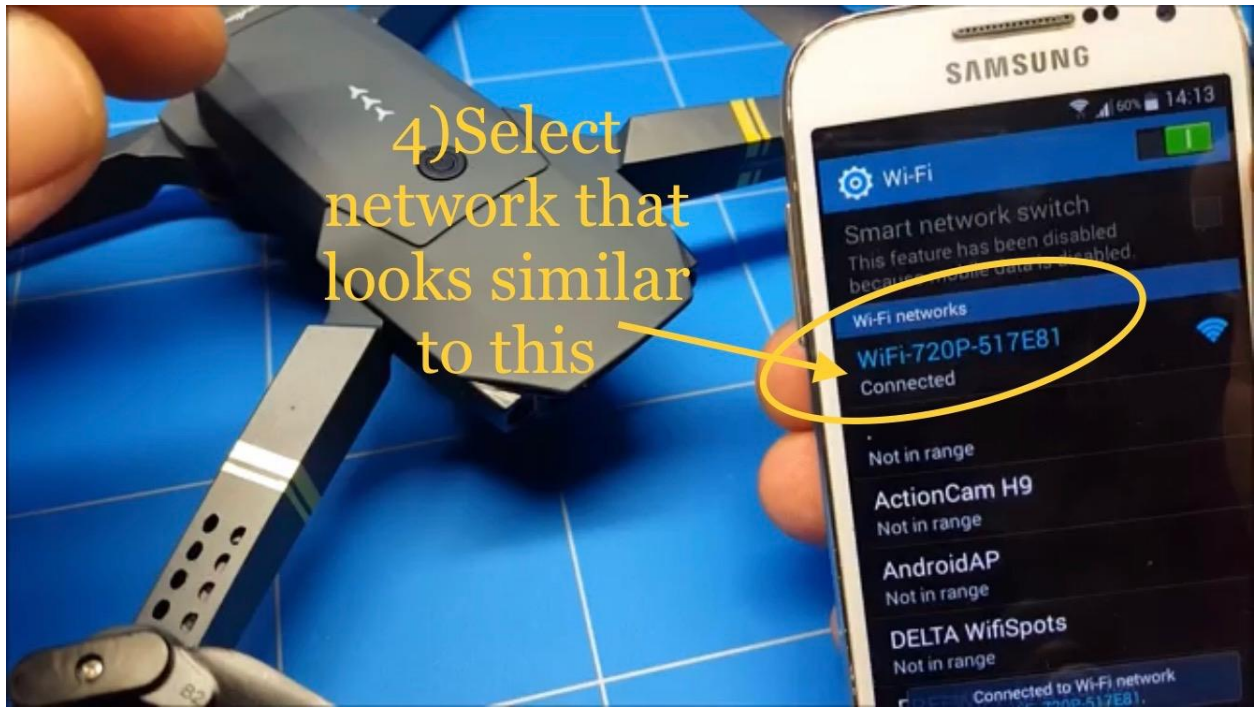

microSD Card Slot Location

