

AGE 14+

DRONE-CLONE



PERTS

# 4K EXTREME DRONE

## USER MANUAL

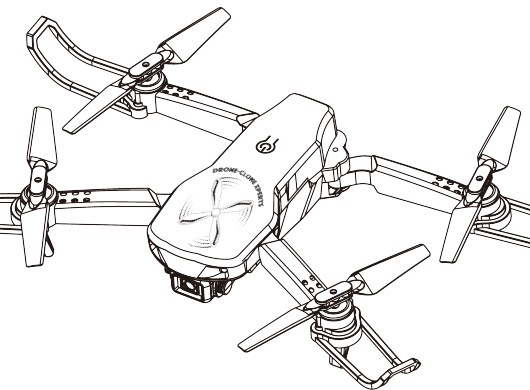

More detailed set-up instructions videos,  
pdfs, and other helpful resources at

**[www.DroneCloneXperts.com](http://www.DroneCloneXperts.com)**

**\*Please read this manual carefully before operation, and  
keep it for future reference\***

# App Download

**IPHONE users:** download app named  
“4K EXTREME”

**ANDROID users:** download app named  
“HFUFO”

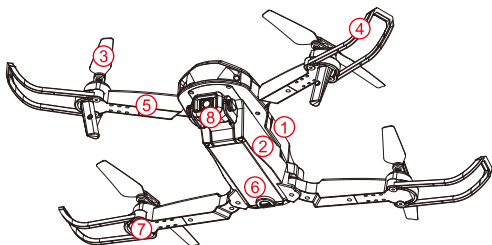

① Upper Casing

⑤ Arm

② Lower Casing

⑥ Battery

③ Propeller

⑦ Motor

④ Protective Guard

⑧ Camera

# ACCESSORIES

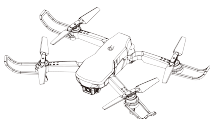

DRONE x1  
(Battery Included)



Remote Control x1



Backup Propellers x2

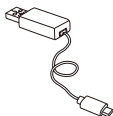

USB Charger x1



Screwdriver x1



User Manual x1

---

## Notes

---

If you need any **replacement parts** or **additional accessories**, you can purchase them from our website [www.DroneCloneXperts.com](http://www.DroneCloneXperts.com) or email us at [Admin@DroneCloneXperts.com](mailto:Admin@DroneCloneXperts.com)

---

# OPTIONAL ACCESSORIES LIST

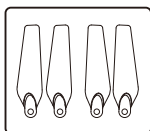

Propellers

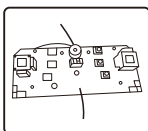

Launch Board

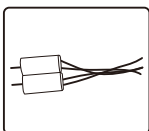

Motor

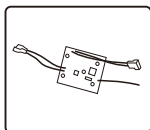

Receiving board

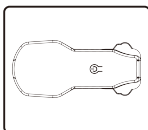

Upper Casing

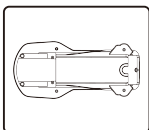

Lower Casing

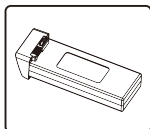

Battery

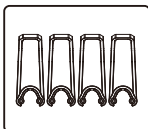

Propeller Guards

---

## Notes

---

If any of the above accessories are damaged during operation, you can contact us to purchase replacement parts. Simply visit our website **DroneCloneXperts.com**. If you're in need of any parts not listed there, just email us at [Admin@DroneCloneXperts.com](mailto:Admin@DroneCloneXperts.com). We have ALL replacement parts in stock.

---

# PRE-FLIGHT PREPARATION

## 1.FLIGHT ENVIRONMENT



Indoor: Spacious spaces away from barriers, crowds or pets are preferred.



Outdoor: Sunny, windless and breezy weathers are preferred.



Please keep the drone in sight during the flight and keep it away from barriers, high-tension cables, trees and people.



Do not fly in extreme environments, such as severely hot or cold days or in strong winds or heavy rain.

## 2.OPEN THE WINGS

### OPENING STEPS

□ Open the front arm(close to camera)

② Open the back arm

Fold the back arm first and then the front arm when folding.

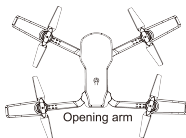
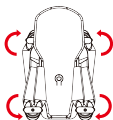

## 3.ASSEMBLING PROTECTIVE PROP GUARDS

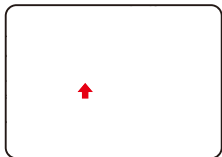
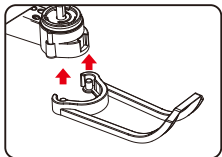

① Align the protective guard underneath the two holes found below the drone arm.

② Press firmly to slide the guard up from the bottom.

## 4.ASSEMBLING PROPELLERS

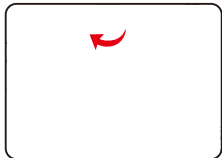
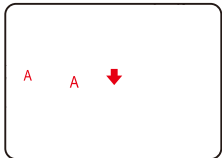

① Correspond the Propellers with the hex nuts of the crankshaft.

② Tighten the screws clockwise.

(It's VITAL that the letter shown on the propellers matches the letter shown on the drone arm or leg. Letter 'A' propellers go on letter 'A' arms & legs, and letter 'B' propellers go on letter 'B' arms & legs). Otherwise the drone won't fly properly.

## 5.BATTERY CHARGING FOR DRONE

This photo's perspective is from the drone's belly, aka the bottom of drone, as if you turned it over to rest it on its back.

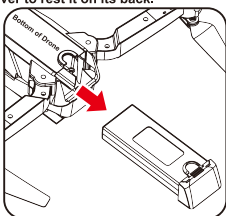
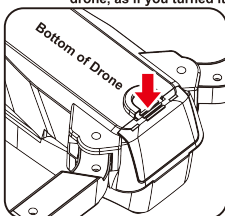

A. Remove the lithium battery from the bottom of the drone.

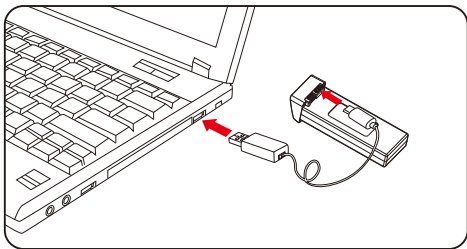

B. Connect USB charging cable with the charging interface of the lithium battery. Use the USB wire that's included, and use it with your phone's wall plug adapter to charge the batteries.

You can also plug the USB wire directly into any USB port such as in your computer, but charging using your computer's usb port will be much slower than using your phone's wall plug.

---

### Notes

The LED light is **ON when charging**.

LED light is **OFF when** charging is **complete**.

Charging time is about 160-180 minutes.

---

# BATTERY INSTRUCTIONS

- There is a certain risk when using lithium battery. It may cause fire, body injury or property loss. Users must be aware of the risks and take full responsibility of using battery improperly. Users must also be sure never to leave the house when a battery is charging.
- If battery leakage occurs, please avoid contacting your eyes or skin with electrolyte. Once it happens, please wash your eyes with clean water and seek medical care immediately.
- Please remove the plug immediately if you sense any smell, noise, or smoke coming from the battery or charger.

## **Battery Charging**

- Please use the charger from original factory to ensure your safe usage.
- Do not charge swollen, hot, or worn-out battery.
- Do not over charge battery. Please unplug the charger once fully charged.
- Do not charge the battery next to flammables, such as carpet, timber floor or wood furniture or on the surface of electro-conductive objects.  
Please always keep an eye on the battery when charging.
- Do not charge battery directly after use in the drone. Wait for it to cool down first (at least 5-10min cool-down period).
- The charging temperature should be between 0°C to 40°C.

## **Battery Recycling**

- Do not dispose the battery as daily trash. Please familiarize yourself with the local garbage disposal / Recycling method and dispose of it according to the special requirement.

# KNOW YOUR REMOTE CONTROL

## 1.Remote Control Button Functions

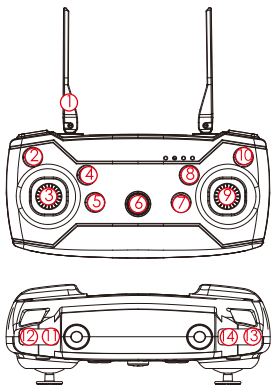

- |  |   |
|--|---|
| ① Antenna  | ⑧ Forward fine-tuning<br>( <b>Trimming</b> )    |
| ② Left side fine-tuning<br>(aka " <b>Trimming</b> ") | ⑨ Right joystick                                |
| ③ Left joystick                                      | ⑩ Right side fine-tuning<br>( <b>Trimming</b> ) |
| ④ One-key Ascend                                     | ⑪ Headless Mode                                 |
| ⑤ One-key Landing                                    | ⑫ High / Low Speed                              |
| ⑥ Power switch                                       | ⑬ One-key Flips & Rolls<br>360°                 |
| ⑦ Backward fine-tuning<br>( <b>Trimming</b> )        | ⑭ One-key calibration                           |

# LITHIUM BATTERY INSTRUCTION

## ① Open the remote control battery cover

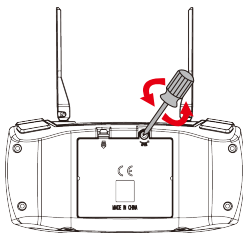

## ② Remote control battery installation

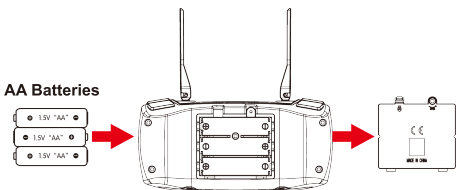

Open the battery cover and insert the 3 AA batteries correctly according to the electrode instructions.(Batteries not included)

---

## Notes

- 1.Make sure the battery are loaded correctly according to the polarity indications on the battery compartment.
  - 2.Please do not mix old and new batteries together.
  - 3.Please do not mix different types of batteries together.
-

## SIGNAL CONNECTION OF TRANSMITTER AND RECEIVER

- ① Turn the drone ON and place it on a level surface. The indicator light on the transmitter (remote control) and the LED lights on the drone will be flashing.
- ② Push the right joystick (the throttle) all the way UP and then all the way DOWN. You'll hear a beep and notice the lights of the drone are no longer flashing, the lights are now solid. This indicates you successfully synced the remote to the drone.

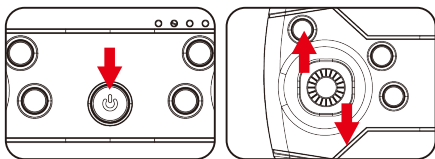

## TRANSMITTER CALIBRATION

Apply transmitter calibration when the drone fails to take off vertically. Press the "One button calibration" button on the TOP RIGHT side of the remote control. When the lights of drone begin flashing quickly this indicates calibration is in progress. When the lights turn solid again, this calibration is complete. Keep in mind the drone must be placed on a horizontal surface and must be kept completely still during the calibration process.

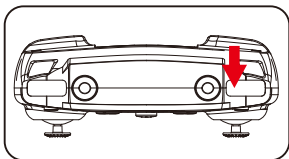

# START YOUR FLIGHT

## 1. One-Key Take Off

Press the "One-Key Take Off" button, the drone blades rotate and automatically fly to a height of 1.5 meters.

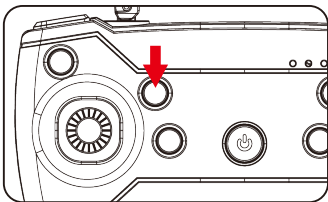

## 2. Basic Flight

Use the left joystick to control the flight altitude and to turn left/right. Use the right joystick to control the forward, backward, left and right side flight directions.

### Left joystick

Ascent

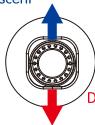

Descent

Turn Left

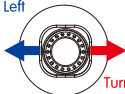

Turn Right

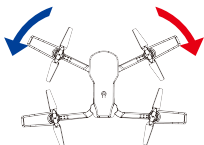
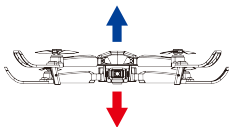

## Right joystick

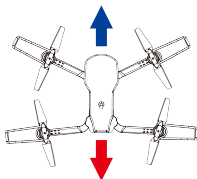
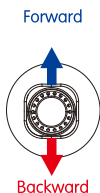

## Left Side Flight

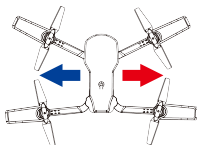
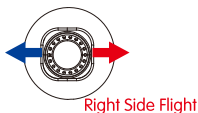

## Flips & Rolls

When the drone has reached over 7ft of height, click the “360° flips & roll” button and move the right joystick to the right or left and watch the drone rotate in that direction.

## Right joystick

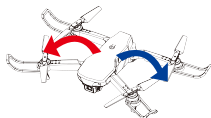
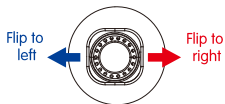

## Headless Mode

The flight direction of the drone will correspond to the pilots own directions.

1. When you press the headless function key on the remote control, the remote control beeps once and enters headless mode. When you press the headless function key again, listen for a long beep sound to indicate the drone is no longer in headless mode.

2. In the headless state, operator doesn't need to identify the direction of the drone nose. Right will always fly to the operators right side regardless of which way the drone is facing. Same goes for the left, forward, and backward.

**i.e.**—The drone is facing the user, and the user commands the drone to fly forward. Since the drone's nose is facing the user, the drone would normally fly towards the user in this situation; **HOWEVER**, in headless mode the drone will fly away from the user since it's corresponding to the users own directional orientation, not the drones.

## Hover

When you release the left joystick (throttle) after the ascent/descent action, the drone will hover at a certain height

## Left joystick

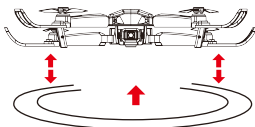
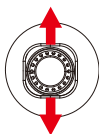

# FINE-TUNING / TRIMMING FUNCTION

When deviating from course, click "Fine-tuning" for calibration until the drone is back to normal.

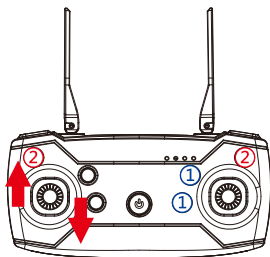

① Forward/Backward  
Fine-tuning

② Left/Right Side  
Fly Fine-tuning

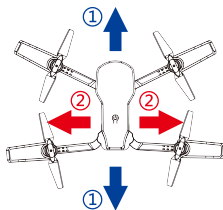

---

## Notes

When the drone is within 30cm from the ground, it will be affected by the blade vortex made by itself and become unstable. This is "ground effect". The lower the drone is, the greater the effect will be.

---

# FAQ / TROUBLESHOOTING

(Or email us at [Admin@DroneCloneXperts.com](mailto:Admin@DroneCloneXperts.com))

PROBLEMS	CAUSES	SOLUTIONS
Remote won't connect to drone	Battery not inserted correctly (most common mistake is up-side-down)	One side of battery has writing on it. Be sure to insert battery with writing side facing the sky.
Having difficulty controlling the drone.	Trim button on remote not being used enough	Learn how to trim your 4K EXTREME drone by referring to our website's Drone Instructions Page
	Wind is too strong.	Don't fly on windy days. The performance and control of the drone will be affected.
Fail to ascend	The rotation speed of main blades is too slow.	Push up the throttle joystick.
	The battery of the quadcopter is not fully charged.	Please fully charge drone batteries
Drone lands on ground too aggressively	The throttle stick is pulled down too fast.	Pull down the throttle stick slowly to perform a smooth landing.
Complete loss of control	Drone has flown beyond its capable distance range.	Ensure operation within the controllable distance: remote control of 100 meters and WIFI control of 40–50 meters.

