

PA-13 Data Sheet



Contents

Specifications	2
Dimensions	3
Speed/Current vs Load	4
Connectors & Feedback	5

Specifications



Load (LBS)		No Load Current (A)				Full Load Current (A)				Speed (inch/sec)	
Dynamic	Static	12VDC	24VDC	36VDC	48VDC	12VDC	24VDC	36VDC	48VDC	No Load	Full Load
3000	3500	4.0	2.4	1.8	1.2	20.0	10.5	7.5	5.3	0.25	0.17

Stroke	0.79" to 40"
Limit Switch	Internal - Non-Adjustable
Limit Switch Feedback	Customizable
Screw Type	ACME Screw
Motor Type	Brushed DC Motor
Connector Type	See Page 5
Wire Length	40" (customizable)
Housing Material	6062 Aluminum Alloy
Rod Material	Stainless Steel
Gear Material	Powder Metallurgy Steel Alloy
Color (Shaft)	Silver
Color (Motor End)	Graphite
Noise	<90dB
Duty Cycle	20% (4 minutes on, 16 minutes off)
Overload Protection	Built-in Electric Shutoff
Operational Temperature	-40°C to 60°C (-40°F to 140°F)
Protection Class	IP66
Feedback Options	Hall Effect or Potentiometer
Certifications	CE/RoHS
Mounting Brackets	BRK-17
Mounting Ends	Customizable



Dimensions

(Dimensions in inches)

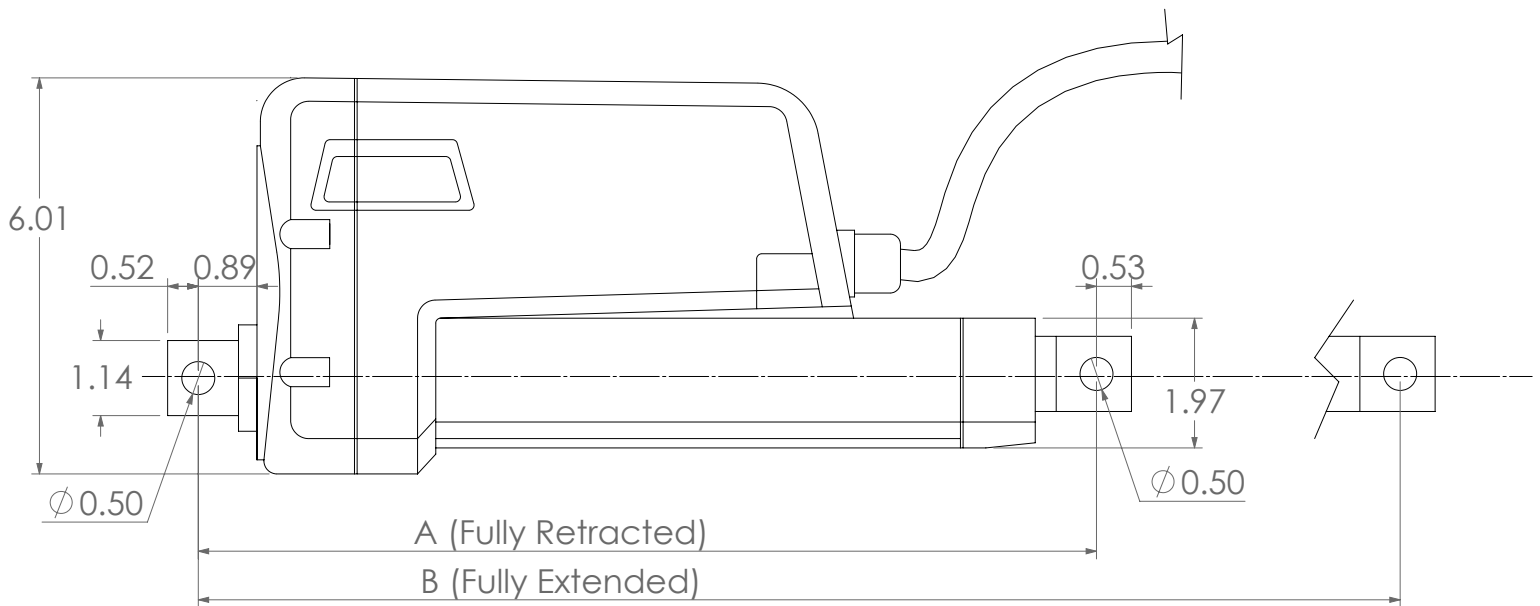
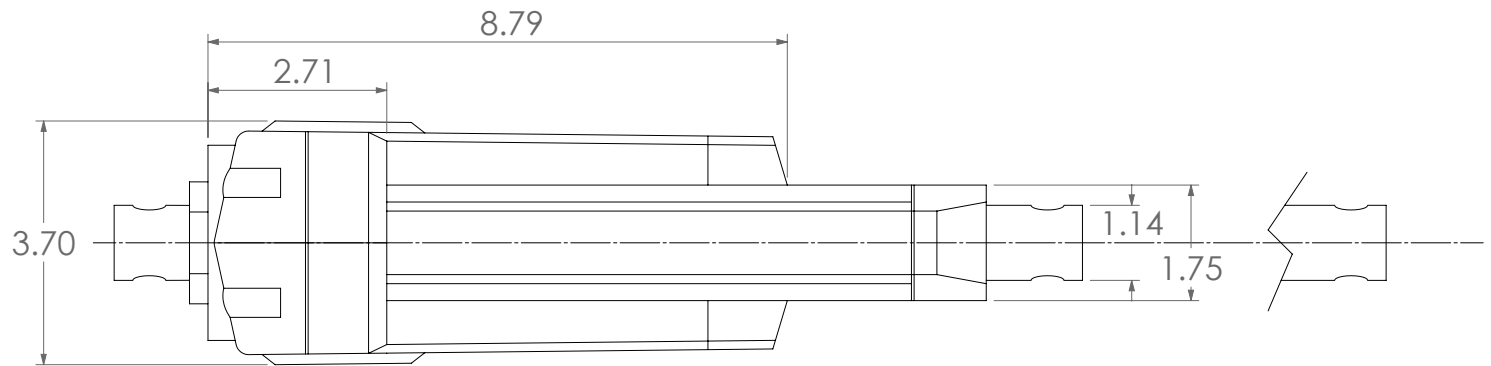

Hole to Hole

PA-13	Stroke	4	6	8	10	12	14	16	18	24	30	40
	A	11.89	13.86	15.87	17.87	21.85	23.86	25.83	27.83	33.86	41.81	51.81
B	15.91	19.84	23.86	27.87	33.86	37.87	41.81	45.83	57.87	71.81	91.81	

For Stroke Length Less Than 4"

$$A = 11.89"$$

$$B = \text{Stroke Length} + 11.89"$$

For Stroke Length 12" and Greater

$$A = \text{Stroke Length} + 9.84"$$

$$B = \text{Stroke Length} \times 2 + 9.84"$$

For Stroke Length 4" and Greater

$$A = \text{Stroke Length} + 7.87"$$

$$B = \text{Stroke Length} \times 2 + 7.87"$$

For Stroke Length Greater Than 24"

$$A = \text{Stroke Length} + 11.81"$$

$$B = \text{Stroke Length} \times 2 + 11.81"$$



Speed vs Load

Speed vs. Load: PA-13 Linear Actuator

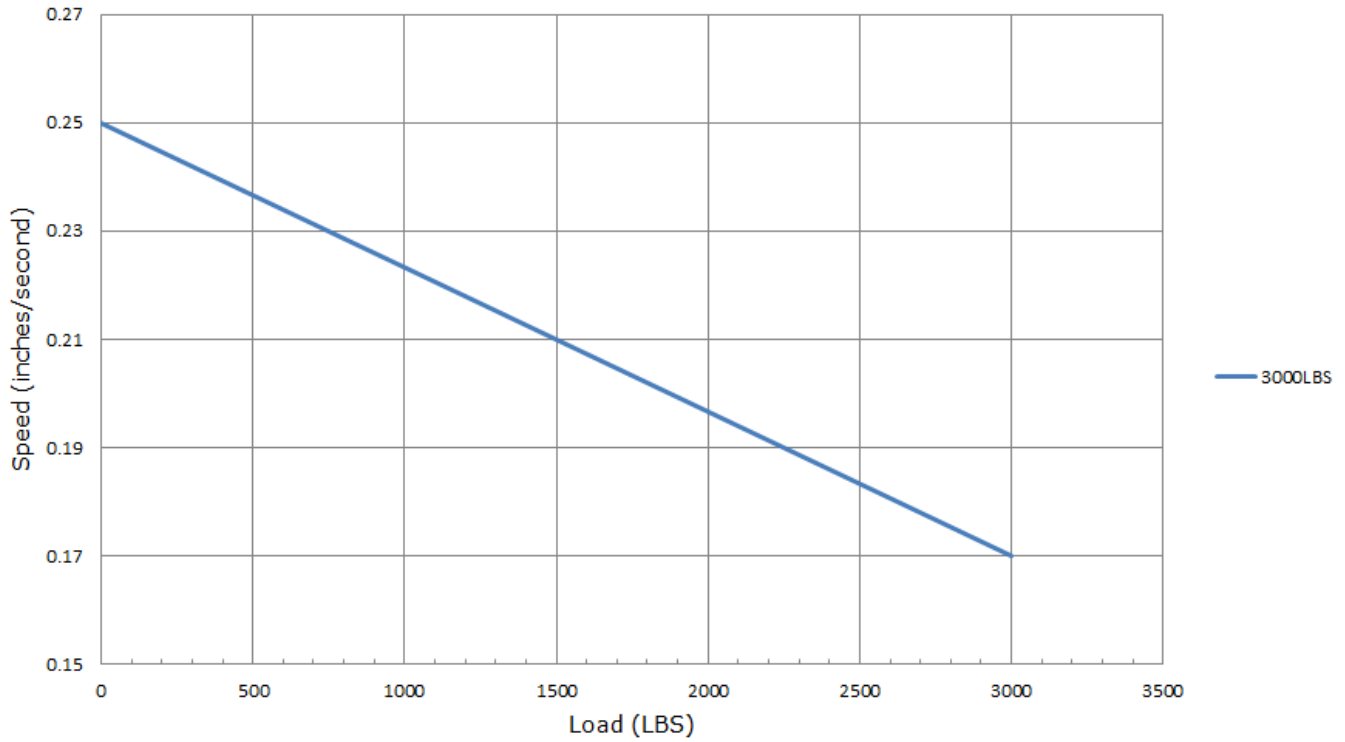

Current vs Load

Current vs. Load: PA-13 Linear Actuator

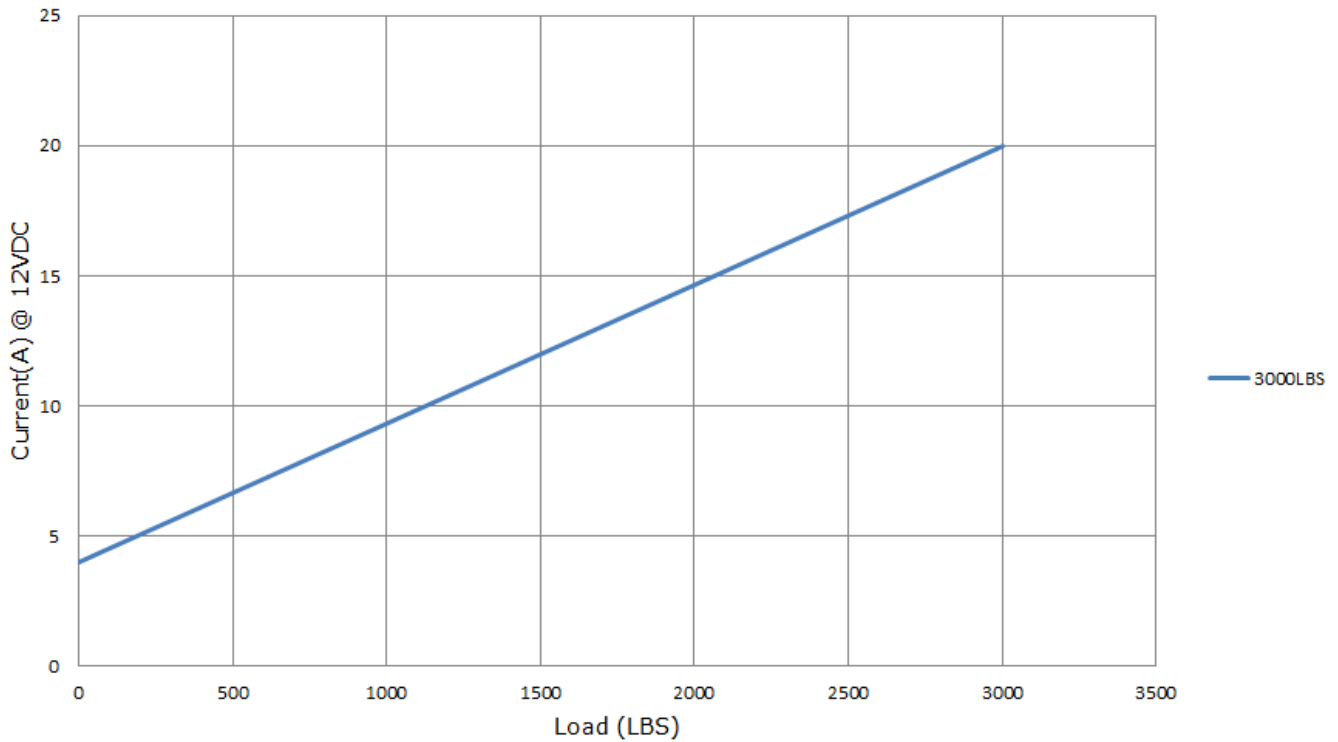



2-Pin Connector (Standard)

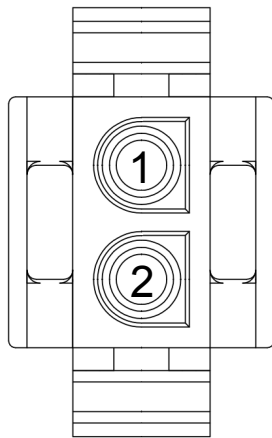

Motor	
1	2
M-	M+

Component	Part Name	Part Number	Mating Part Number
Housing	Tyco Electronics AMP Universal Mate-N-Lok PLUG	1-480698-0	1-480699-0