

No.	PART No.	零件名称	PART NAME	QTY	NOTE	DATE	20210331	PAGE	10F2
51	60600386AA	过滤器托架	Portafilter holder	1					
50	60600387AA	杯托	cup tray	1					
49	60600389	支架架内扣	accessory inner-holder	2					
48	60600443	支架架转接器	accessory holder adaptor	4					
47	60600388	支架架外扣	accessory outer-holder	2					
46	60600456	内六角螺钉	screws	2	M4×6, 或				
45	60600243	内六角螺钉	screws	4	M4×10				
44	60600385	过滤器支架	Portafilter support	1					
97	60002180	螺钉	screws	1	M4×10				
96	60600258	防电锁扣	wire lock	1	UC-15				
95	60002340	电源线扣	wire bushing	1					
94	60600329	带垫螺钉	screw with washer	5	PWB4×10				
93	60002200	机脚	legs	5					
92	606M0015	底座外焊接组件	base welding set	1	Weld				
91	59800031	螺钉	screws	8	ST4.2×13				
90	60600330	底座	base	1					
89	60600478	托盘	tray	1					
88	60600326AA	保险丝座	fuse housing	1					
87	60600321AA	保险丝座连接线	fuse socket cable	1					
86	60600388AA	保险丝	fuse	1	optional				
85	60600377AA	保险丝	fuse	1					
84	60600477	硅胶塞	cover	1					
83	60002281	螺钉	screws	1	ST3×8				
82	60600208	电池保护盖	battery cover	1					
81	60600320AA	精度电池主板	accuracy battery PCBA	1					
80	60002281	螺母	nut	2	ST3×8				
79	60600459	主板支架	PCAs holder	1					
78	60001450	定子压板	winding stopper	2	ST4.2×13				
77	59800031	自攻螺钉	self-tapping screw	2					
76	60600460	电源主板绝缘板	PCB isolate plate	1					
75	60600328	尼龙螺钉	screws	1	M3×6, 黑色				
74	60600322A	电源主板	power board PCB	1	230V/110V				
73	60600472	尼龙螺钉	screws	2	M4×8, 黑色				
72	606M0039	微动开关焊接组件	micro switch welding set	1					
71	60600455	螺钉	screws	2	M2×10				
70	60600451AA	微动开关微动轴	micro switch demand	1					
69	60600453	六角薄螺母	nut	1	M8				
68	60600478BB	微动开关支架	micro switch holder	1					
67	60600450AA	点动帽连接轴套	demand pipe	1					
66	60600454AA	压簧	spring	1					
65	60600448AA	点动帽	demand head	1					
64	60600449	点动缓冲帽	espresso cushion	1					
63	60600468	电源控制开关	powder switch	1					
62	60600476	机身右侧板	extrusion side right panel	1	颜色加后缀				
61	60600317AA	精度显示主板	accuracy display PCBA	1					
60	60600268	显示屏海绵垫	LCD frame sponge	1					
59	60600306	显示屏保护框	LCD frame	1					
58	60600306	研磨核心	core grinder	1					
57	60600068	螺钉	screws	2	M2.5×6				
56	60600239AA	保护开关	micro switch	1					
55	60002276	螺钉	screws	2	M3×8				
54	59000020	弹性垫圈	spring washer	4	φ3				
53	60600533	固定螺钉	screws	4	M3×3				
52	60600532	六角连接柱	hexagon pipe	2					
51	60600534	电话屏连接套	connector	1					
50	60600332AA	精度电位器主板	accuracy potentiometer PCBA	1					
49	60600385	弹性垫圈	spring washer	2	φ5				
48	60600469	过滤器支架	accessories holder	2					
47	60600446	机身上盖	single front panel	1					
46	60600424	螺钉	screws	2	ST3.9×9.5				
45	60600402	机身上盖支架	single top front panel	1					
44	59800032	螺母	nut	4	M5				
43	64800040	螺钉	screws	2	M4×12				
42	60600393	出粉管	chute pipe	1					
41	60600068	螺钉	screws	2	M2.5×6				
40	60600391	螺钉	tapping screws	1	PT M4×6				
39	60600392	出粉口	outlet chute slope	1					
38	60600491AA	内挡粉片	inner leaf	1	镀锌				
37	60600492	外挡粉片	outer leaf	1	硅胶				
36	60600528-30	出粉室盖	nozzle body	1					
35	60600243	螺钉	screws	2	M4×10				
34	60600420	机身左侧板	extrusion with printer	1	颜色加后缀				
33	60600470	防尘护线圈	wire rubber	1					
32	60800124	螺母	nut	4	M4				
31	60600066	平垫	washer	4	φ4				
30	60600114	螺钉	screws	4	M4×16				
29	59800031	螺钉	screws	8	ST4.2×13				
28	60600233AA	LED主板	LED PCB	1					
27	60600234	LED弹簧	LED spring	1					
26	60600529	灯罩支架	LED cover holder	1					
25	60600342	灯罩	LED cover	1					
24	60600475	理线扣-带背胶	wirer lock with sticker	2					
23	60600243	螺钉	screws	4	M4×10				
22	60600527-30	机身上盖	top spyder	1					
21	60002281	螺钉	screws	4	ST3×8				
20	60600441	调节旋钮缓冲环	dial knob ring	1					
19	60600442	调节旋钮轴	dial knob worm	1					
18	60600514	调节旋钮	dial knob	1					
17	60600444	圆柱销	dial pin	1	φ2×24				
16	60600445	旋钮轴固定架	dial worm holder	1					
15	60600439	调节旋钮轴套	knob support	1					
14	60002276	螺钉	screws	1	M3×8				
13	60600367	装饰环	Top ring	1					
12	60600238	磁铁	magnet	3					
11	60600302	漏斗门	hopper door	1					
10	60600484	漏斗	hopper	1					
9	60600255	漏斗芯	hopper ring	1					
8	60600307	漏斗盖	hopper lid	1					
7	No. PART No.	零件名称	PART NAME	QTY	NOTE				
6	MODEL No.	H1	PART No.	60600479					
5	UNIT	mm	SCALE	1:5					
4	SHEET	A3	PART NAME	Exploded View of H1					
3	VER.	1	注意	凯 (常州) 电器设备有限公司					
2	No. PART No.	零件名称	PART NAME	QTY	NOTE	DATE	20210331	PAGE	10F2
1									

A

B

C

D

E

F

A

B

C

D

E

F

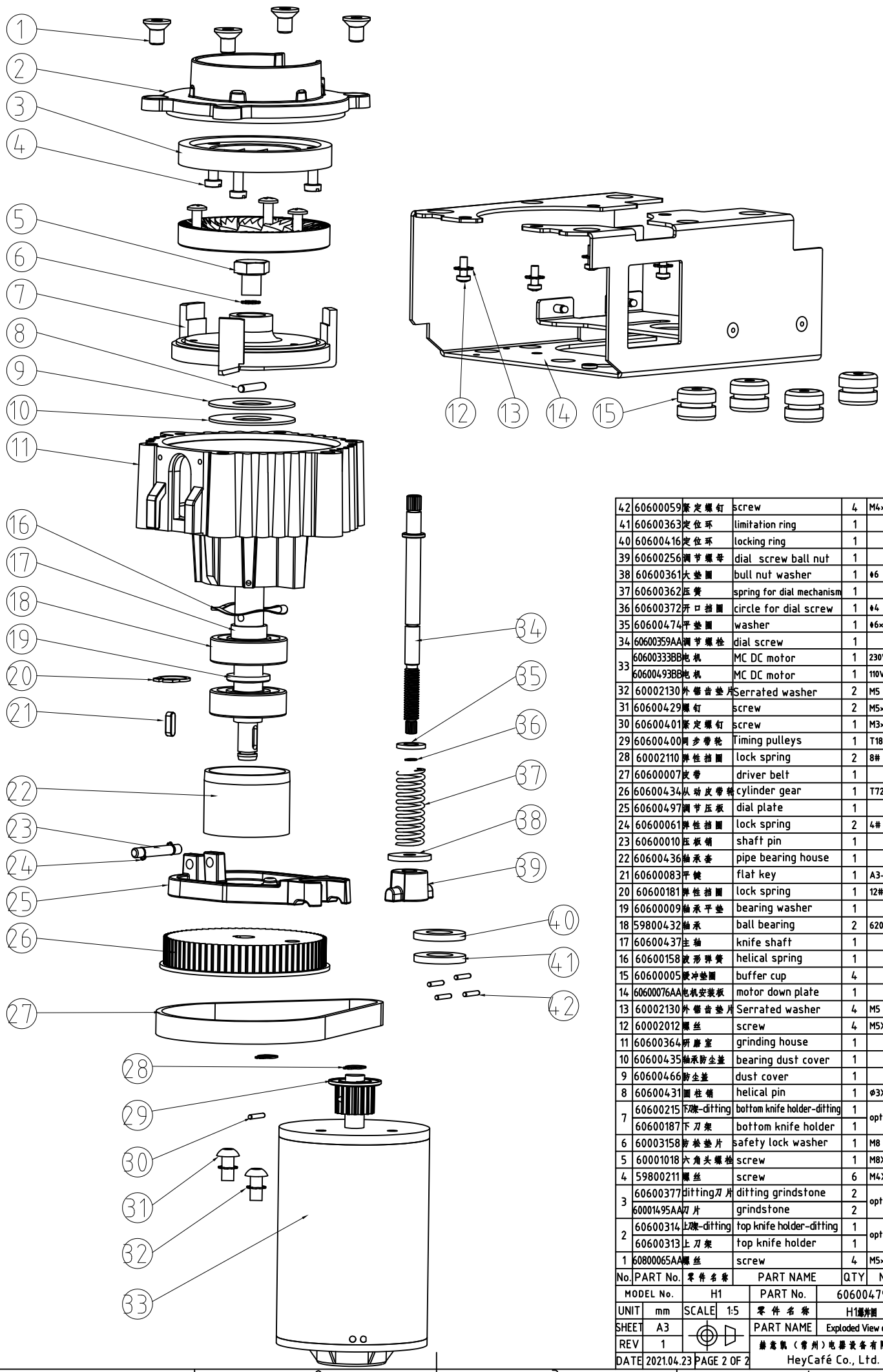

42	60600059	限定螺钉	screw	4	M4×3.5	
41	60600363	定位环	limitation ring	1		
40	60600416	定位环	locking ring	1		
39	60600256	调节螺母	dial screw ball nut	1		
38	60600361	大垫圈	bull nut washer	1	φ6	
37	60600362	压簧	spring for dial mechanism	1		
36	60600372	开口挡圈	circle for dial screw	1	φ4	
35	60600474	平垫圈	washer	1	φ6×φ12×1.5	
34	60600359AA	调节螺栓	dial screw	1		
33	60600333BB	电机	MC DC motor	1	230V	optional
	60600493BB	电机	MC DC motor	1	110V	optional
32	60002130	外锯齿垫片	Serrated washer	2	M5	
31	60600429	螺钉	screw	2	M5×12	
30	60600401	限定螺钉	screw	1	M3×4	
29	60600400	同步带轮	Timing pulleys	1	T18	
28	60002110	弹性挡圈	lock spring	2	8#	
27	60600007	皮带	driver belt	1		
26	60600434	从动皮带轮	cyllinder gear	1	T72	
25	60600497	调节压板	dial plate	1		
24	60600061	弹性挡圈	lock spring	2	4#	
23	60600010	压板销	shaft pin	1		
22	60600436	轴承套	pipe bearing house	1		
21	60600083	平键	flat key	1	A3-3-10	
20	60600181	弹性挡圈	lock spring	1	12#	
19	60600009	轴承平垫	bearing washer	1		
18	59800432	轴承	ball bearing	2	6201-22	
17	60600437	主轴	knife shaft	1		
16	60600158	波形弹簧	helical spring	1		
15	60600005	缓冲垫圈	buffer cup	4		
14	60600076AA	电机安装板	motor down plate	1		
13	60002130	外锯齿垫片	Serrated washer	4	M5	
12	60002012	螺丝	screw	4	M5X12	
11	60600364	研磨室	grinding house	1		
10	60600435	轴承防尘盖	bearing dust cover	1		
9	60600466	防尘盖	dust cover	1		
8	60600431	圆柱销	helical pin	1	φ3X16	
7	60600215	下碟-ditting	bottom knife holder-ditting	1		optional
	60600187	下刀架	bottom knife holder	1		
6	60003158	防松垫片	safety lock washer	1	M8	
5	60001018	六角头螺栓	screw	1	M8X10	
4	59800211	螺丝	screw	6	M4X10	
3	60600377	ditting刀片	ditting grindstone	2		optional
	60001495AA	刀片	grindstone	2		
2	60600314	上碟-ditting	top knife holder-ditting	1		optional
	60600313	上刀架	top knife holder	1		
1	60800065AA	螺丝	screw	4	M5×12	
No.	PART No.	零件名称	PART NAME	QTY	NOTE	
MODEL No.	H1		PART No.	60600479		
UNIT	mm	SCALE	1:5	零件名称	H1爆炸图	
SHEET	A3	PART NAME		Exploded View of H1		
REV	1	赫志凯(常州)电器设备有限公司				
DATE	2021.04.23	PAGE	2 OF 2	HeyCafé Co., Ltd.		