



ReproCut™ Model No. 16139 Operation Manual



ReproCut™ is specifically designed only for use with Flexbar Reprorubber casting materials.

This versatile system will aid in specimen preparation and general sizing of cast forms. Properly trimmed specimens are suitable for video machine or optical comparator measurement. ReproCut works on cured Reprorubber Thin Pour (Green), Medium Viscosity (Orange) and Quick Setting Putty (Blue) specimens.

UNPACKING AND PREPARATION FOR USE*:

***CAUTION:** ReproCut contains sharp steel cutting blades. Use extreme care during unpacking and in general use.

Remove bubble cushions from each side. Grasp black handle with one hand, unroll protective wrap with other.

MAKE SURE WHITE PROTECTIVE COVER STAYS ON BLADES.

Position device upright as per image to the right.

Using the left finger, hold cover down firmly, grasp handle in right hand and remove with an upward lift.

Using both hands, place cutter vertically on cutting surface.
NOTE: BLADES WILL CUT INTO SURFACE WHEN USED.
It is recommended to use a Flexbar HDPE cutting board.



SAFETY RULES

1. Wear safety goggles.
2. Use finger method above to remove cover.
3. Always have both hands on their respective handles when applying pressure to cut Reprorubber sample.
4. IF REPRORUBBER GETS STUCK IN ANY BLADE SET, USE TOOL COVER AS SHOWN TO PUSH MATERIAL FROM TOP DOWN.
5. IF LEXAN WINDOW HAS CRACKS REPLACE IMMEDIATELY AS IT IS A STRUCTURAL COMPONENT.
6. Lay cover on table and insert tool with **both hands** on handles to reinstall cover.

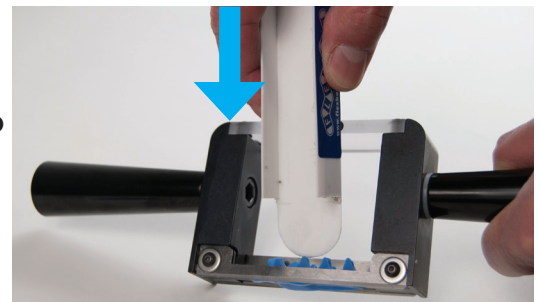

FLEXBAR MACHINE CORPORATION

250 GIBBS ROAD
ISLANDIA, NY 11749

631-582-8440

800-879-7575

www.flexbar.com

Email: sales@flexbar.com

© 2016 Flexbar Machine Corp. Islandia, NY USA



ReproCut™ Cutting Tips

- Looking down straight through the cutting window allows for optimum performance.
- Best results are achieved when the cutter blade set being used is closest to the operator.
- Use single blade to trim flash or for larger specimen slices.
- Even, slow pressure results in the best cuts.
- The double blade set can be used on all Reprorubber material up to a certain thickness.
- When using the double blade on Thin Pour notice how the material rebounds. Apply equal cutting pressure at that rate.

Frequently Asked Questions

How do I clean the blades?

Use a tooth brush and WD-40, let air dry.

Can I change the double blade set spacing?

Yes, the provided washers will allow hardware swaps from .016" -.100". This is based on provided washer tolerances. Follow blade changing instructions below.

Can I use only one blade set on one side of my choosing?

Yes, but at your own risk. ReproCut was designed with three spar captivation. While lexan is relatively strong it is important that all screws are tight. Lexan must be inspected for cracks after every use.

Can I mix and match blade sizes?

Yes, but only with Flexbar replacement parts.

How do I order spare parts?

See detailed parts drawing on following page.

Blade Change Instructions

- Don leather or lambskin protective gloves. Wear safety goggles.
- Lay ReproCut on bench with blade screws facing upwards.
- Use a 5/64 hex allen key to remove 6-32 button head screws (2) and washers.
- Use a needle-nose plier to remove blade(s) from block nest.
- Install a new blade by grasping with plier and inserting into block nest.
- Add spacer washers if double blade set.
- Add captivating washer after last blade, reinstall screws.
- Torque screws tightly. The top most blade should give a high tone when struck with allen key.
- Place ReproCut back into protective case using both hands on handles.

16139 Parts List			
Item	Part #	Description	Quantity
1	16139-LENS	Block Body	1
2	16139-SB	Thin Short Blade	2
3	16139-LB	Tall Large Blade	2
4	16139-COVER	Blade Cover	1

① LEXAN WINDOW
PART # 16139-LENS

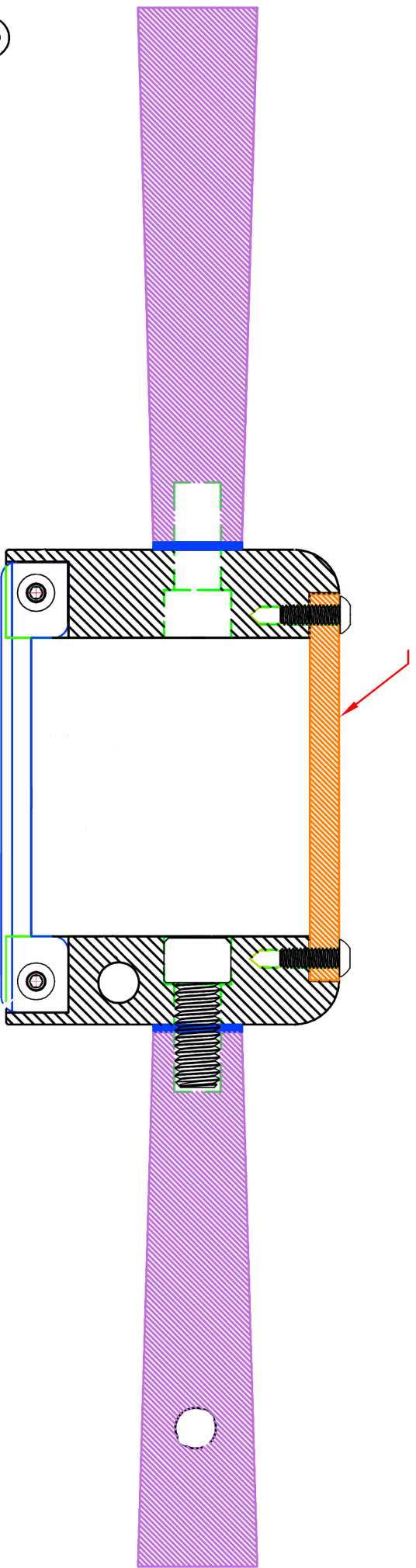

②



CUTTER BLADE THIN
PART # 16139-SB X 2

③

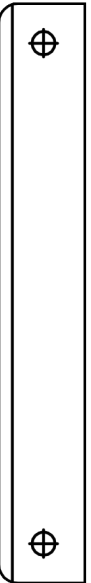

CUTTER BLADE THICK
PART # 16139-LB

④

BLADE COVER

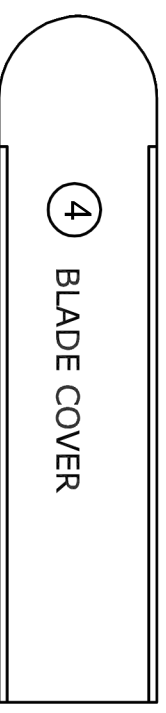

PART # 16139-COVER