

HOUSING Metal/Aluminum
IMPELLER Aluminum, Ø40mm
BEARING Ball or Sleeve
INSULATION Class A
OPERATING TEMPERATURE 0°C to + 45°C
OPERATING VOLTAGE RANGE 85 VAC to 125 VAC for 115V Type
 185 VAC to 245 VAC for 230V Type
DIELECTRIC STRENGTH 1,500 VAC for 1 second
INSULATION RESISTANCE 10M Ω min. @500 VDC
SAFETY Impedance Protected
MOTOR TYPE Shaded Pole Motor
ROHS COMPLIANCE Yes
IP LEVEL IP21 (Special IP Rating On Request)

* FAN IS FOR HORIZONTAL USE ONLY *

40mm

40 mm

DIMENSION

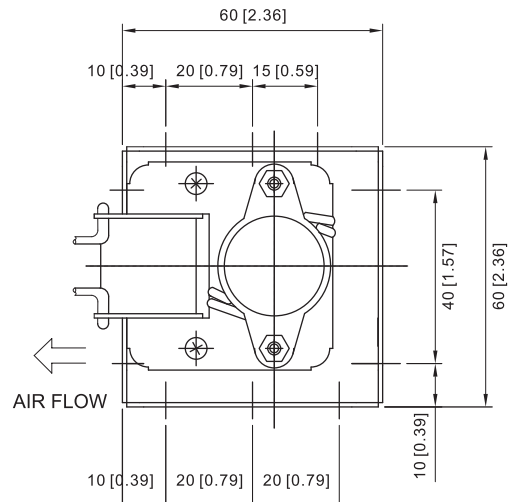
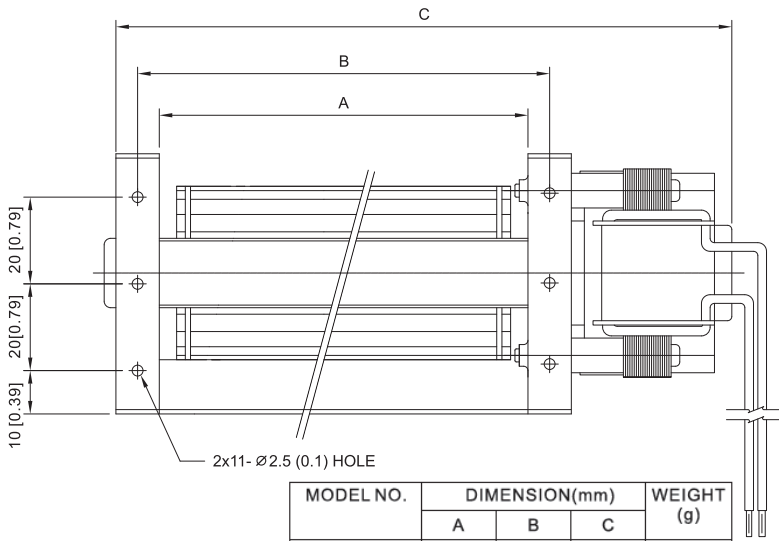

MODEL NO.	DIMENSION(mm)			WEIGHT (g)
	A	B	C	
sAFS40098	98	108	160	520
sAFS40160	160	170	222	560
sAFS40198	198	208	260	600
sAFS40300	300	310	366	730

UNIT:mm[inch]

SPECIFICATION

MODEL NO.	RATED VOLTAGE(V)	FREQUENCY (Hz)	RATED CURRENT(A)	INPUT POWER (W)	SPEED (RPM)	MAX. AIR PRESSURE		MAX. AIR FLOW		NOISE dB(A)@ 1M
						inchH ₂ O	mmH ₂ O	CFM	m ³ /min	
sAFS40098V1H	120	60	0.12	9	3000	0.09	2.3	24	0.7	33
sAFS40098V2H	230	50	0.09	11	2700	0.07	1.7	21	0.6	29
sAFS40160V1H	120	60	0.13	10	2800	0.09	2.4	39	1.1	34
sAFS40160V2H	230	50	0.09	11	2600	0.07	1.9	35	1.0	30
sAFS40198V1H	120	60	0.13	9	2400	0.10	2.6	46	1.3	31
sAFS40198V2H	230	50	0.09	12	2500	0.08	2.0	49	1.4	33
sAFS40300V1H	120	60	0.21	16	2200	0.10	2.6	70	2.0	35
sAFS40300V2H	230	50	0.10	13	2400	0.08	2.1	74	2.1	37

AIR PERFORMANCE

