

Installation Instructions

EWCV3 Window Kit for Unity dMEV models (CV2.1 / CV3 / CV3SV)

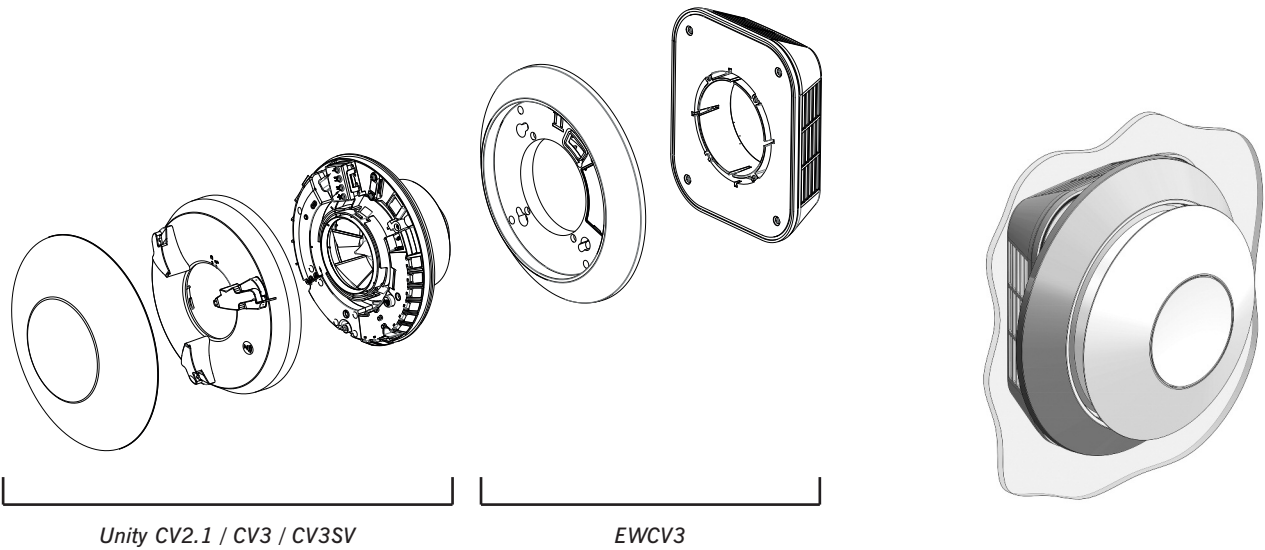

General Information

- For window mounting do not install fans in opening windows.
- Use the correct thickness of glass for the size of window (at least 4mm thick) – if in doubt, contact a glazier.
- The components supplied are suitable for installation of fans in windows from 4mm single glaze to 28mm double-glazing.

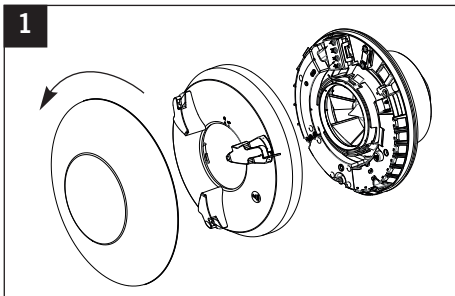

Rotate 'outer cover' anticlockwise until retaining clips are released and place the cover to one side. Loosen retaining screw in main body cover and rotate anticlockwise to remove.

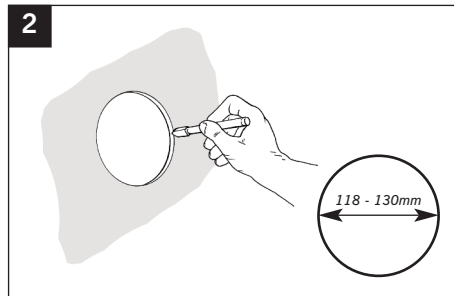

Cut circular hole within window pane.

- minimum 118mm
- maximum 130mm

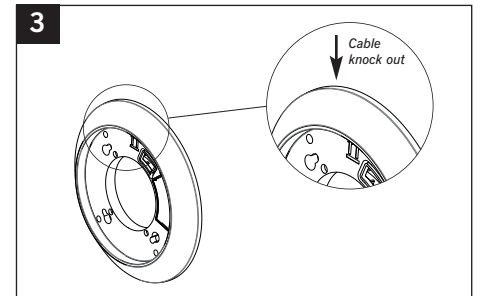

Remove cable knock out for the mains cable, ensuring sharp edges are removed to prevent damage to the cable insulation.

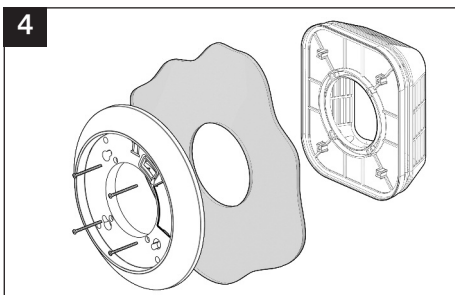

Secure window kit into position using the 4 screws provided within the loose item set. Screw lengths that can be used are:

- 25mm – Single Glazing
- 38mm – 20mm & 24mm Double Glazing
- 50mm – 28mm Double Glazing (supplied)

Note: The long screws provided can be used in all window thicknesses as they will locate into the outside back part of the window kit.

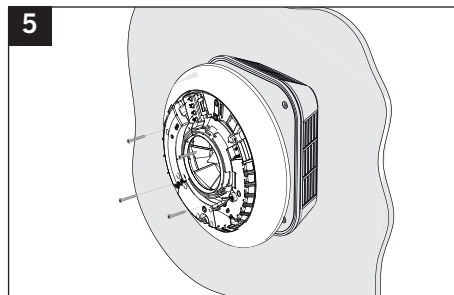

Secure back plate of the Unity CV2.1 / CV3 / CV3SV fan to the window kit using the shorter screws provided and wire as per the wiring section within the respective Unity Installation Instructions.

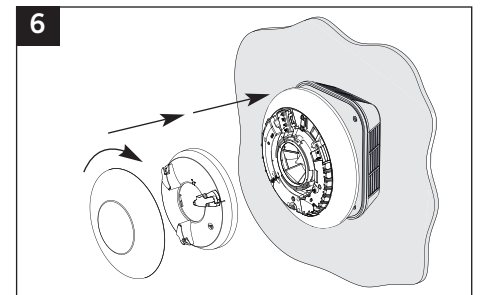

Follow installation and commissioning steps within the respective Unity Installation Instructions.