



HYPERDRIVE  
DESIGN

TIERRA A IC

Instruction Manual

●Name of each department and operation method

We sincerely thank you for purchasing TIERRA A IC series. This product employs the design concept "HYPERDRIVE DESIGN" in which gears are strong and smooth rotation is sustained. For proper use of this reel, please read this instruction manual thoroughly before use. In addition, we request that you keep this manual carefully, as well as Reil.

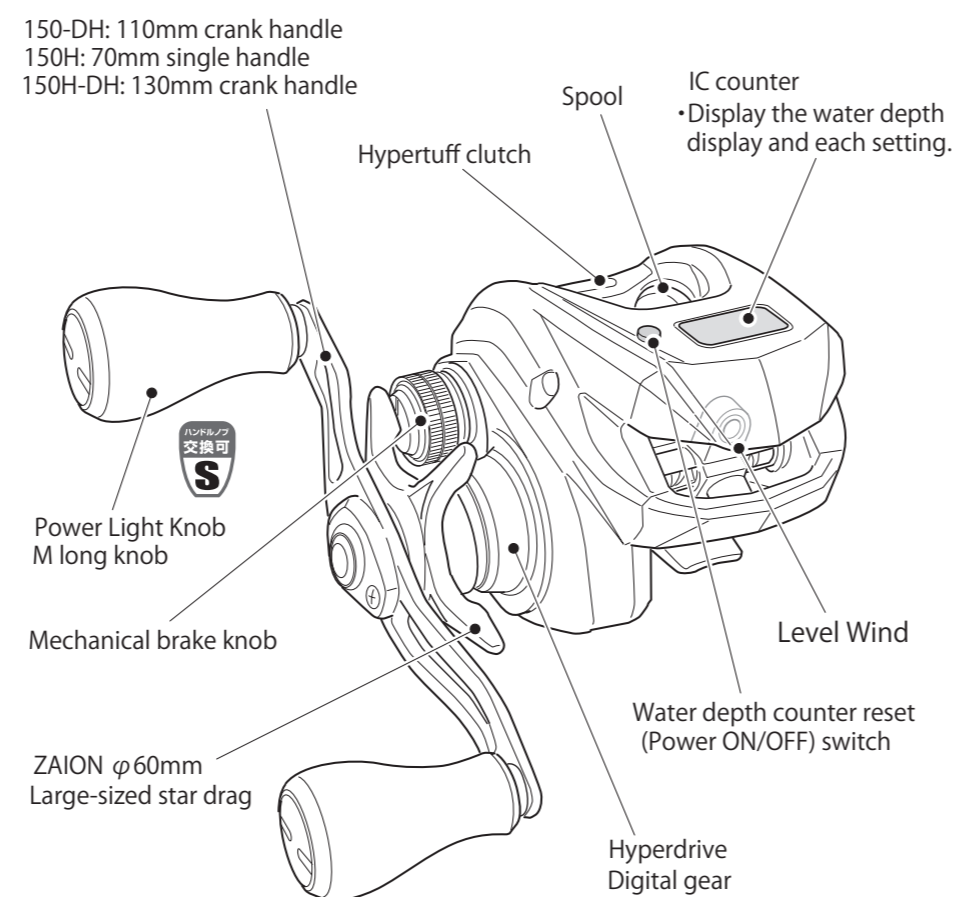

●How to Operate the Mechanical Brake Knob

The mechanical brake is a function to apply the brake to the spool rotation when dropping the luer (jig) with the clutch OFF. The mechanical brake knob is tightened clockwise and loosened counterclockwise. When the luer (jig) is loaded into the water with the clutch turned OFF, adjust it to the extent that the thread will not be shaken out. Also, adjust similarly when replacing the impact of tidal trends (two tiers) or lure (jig). Also, when lightly casting with underhand casting, adjust the mechanical brake to the extent that the spool does not rattle.

⚠ Note

Be careful not to overtighten or loosen the mechanical brake. Using the product with the mechanical brake knob tightened too much may cause the spool shaft to seize, resulting in abnormal noise. In addition, if the brake force is too strong, resistance will occur in the rotation of the handle due to the structure. If the product is used with the mechanical brake knob loosened too much, the spool may rattle or run out more. This may cause the line to enter the gap between the spool and the frame, resulting in a drop speed reduction or noise. In addition, there is a risk of interference with the star drag or the mechanical brake knob falling off or parts being lost. Please note.

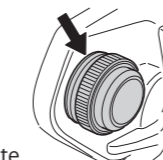

●Hypertuff clutch

A state-of-the-art clutch system that can withstand the turning on and off of clutches that can be operated many times and continues to operate. Simply press down lightly with your thumb to disengage the clutch and leave the spool free. You can lock in the clutch and the pool at the same time with your thumb, so you can operate quickly.

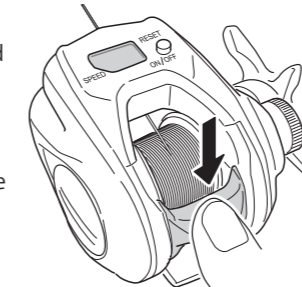

※Cut it reliably until the sound is "chicken."

●Drag adjustment method

Turn clockwise to increase the drag setting, or counterclockwise to decrease the drag setting. Please make adjustments according to the use line and type.

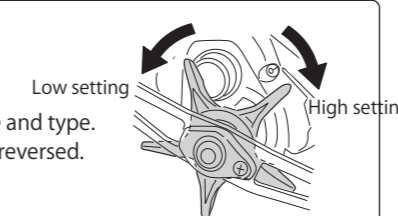

※The rotation direction of the left handle model is reversed.

●Manner of care

In order to prevent problems caused by rust and the solidification of salt, it is important to ensure that maintenance is carried out after fishing in the following manner. However, ball bearings, gears, etc. are consumables, and their initial performance may deteriorate due to long-term use. We recommend that you place this reel in an overhaul once a year in order to use it for a long time. (Fee)

<Sequence>

- Water washing is recommended after use.
- Tighten the drag and wash with fresh water such as a shower for 1 to 2 minutes. Especially, water should be used to wash out the salt in the spring and clutch areas. Please stop washing grease by submerging the reels and using hot water because it may wash the reels.
- After washing, thoroughly drain the water while moving the handle, clutch, spool, and other moving parts. Wipe off the water with a towel, loosen the drag, and dry it shaded away from direct sunlight.
- It takes about five days for the internal water to be fully dried. Move the operating parts, such as the handle, clutch, or spring, from time to time while they are shaded. We recommend operating the system once a day or so if possible.
- After washing, use injection oil in the following procedures.
- Loosen the drag for storage.

■Oil injection regulations

⚠ ※Lubrication other than specified lubrication causes problems with the reel body. And may do so.

Recommended oil:  
Daiwa Riel Guard Oil (Product Code: 04980019)  
Daiwa Riel Guard Gris (Product Code: 04980020)  
(Please order at a fishing goods store.)

※Do not use commercially available anti-rust lubricants, etc. as this may damage the durability of ball bearings, internal mechanical parts, etc.

<Notes>

- After using the reels, clean and wipe out the garbage.
- Do not use solvents (thinners, etc.).
- Do not attempt to disassemble the gear and other parts of the reel for maintenance because the internal structure is complicated. In addition, too much grease oil may, conversely, impair the original performance. Please note.
- Do not lubricate the area around the IC counter. This may result in failure of the electrical components.

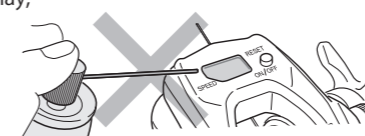

●Precautions for winding

⚠ Note Because we use a lightweight Spool, if we wrap the yarn with a higher line tenor than necessary, the Spool may be modified. Be careful not to place too much line retention. When winding a PE line, winding with a line tension of about 500g is recommended. When using a nylon line for lower winding, use a thickness of No. 6 or more. When winding the lower nylon line, it is recommended to wind the yarn with a line tension of 300g so as not to apply the line tension too much.

⚠ Note

- Do not turn the handle while the clutch lever is pushed in. ※Turning the handle with the clutch pushed in may damage the clutch and stopper.
- Do not casting over the overhead. ※Otherwise, the clutch may return and the thread may break.
- Do not attach or detach a pool because the internal structure is complicated.
- When using fine thread of PE line No.1 or less, note that thread may enter the clearance between spool and frame due to bias of bobbin winder or backlash.
- It is recommended that the end diameter of the bobbin winder be up to the lower end of the chamfer on the outer periphery of the spool, even if it is as shown in the figure on the right. If the volume of yarns is too large, there may be line trouble and errors at the time of yarn input.

●Ties when starting to wrap a PE line into a Spool

When using the PE line, tie the yarns to the Spool three to five times to prevent the yarns from turning away from the Spool and then connect them firmly. Also, after linking, make sure that the yarn does not skew away from the Spool even if it is pulled strongly, and then start wrapping the yarn.

●Safety Notes

- ⚠ Note
- Do not fish by bringing your finger close to the level wind that leads the line. Fingers may be caught and injured.
  - When the yarn is on a vigorous footing, be careful not to place your thumb above the Spool. Otherwise, you may get injured by getting caught in your fingers or getting caught in your fingers.
  - Do not place it in the hands of an infant. There is a risk of unexpected accidents and injury.
  - Please do not forget to cut the clutch during casting. There is a risk of injury because the entry does not go out.
  - Be careful not to pinch your fingers between the handle and the body. Otherwise, your fingers may get caught and injured.

●Operational Notes

- ⚠ Note
- When you get stuck to the roots, take the thread by hand and cut it without forcing the rod. Turning over the rod may cause the rod to break. (Protect your hand with gloves and towels.)
  - Do not inject oil into the one-way clutch section of the reel. Handles can be reversed, causing injury in the hands.
  - Continuous use of the rig for a long time may make the drag storage unit hot, leading to the danger of making it fatal.
  - If the drag slides when throwing far with a reel with a drag, it may injure your fingers with the thread. Be sure to tighten the drag thoroughly before throwing.
  - When storing a reel for a long period of time, completely cut the water and store it in a place that is as easy as possible.
  - Loosen the drag on the reel with drag after fishing. If you store the drag while tightening it, the drag washer may collapse and the drag performance may deteriorate.
  - There may be differences in the amount of labeled wrapping and the status of wrapping depending on the large and small size of the used yarn, changes in fishing force during wrapping, operating clearance, etc.
  - Please be aware that strong shocks, such as declines, may cause damage to the product.
  - This product is developed as a fishing tool. Do not use it for any purpose other than fishing.
  - Although this product has been designed and manufactured to a sufficient strength standard, it may be damaged if it is subjected to an extreme load exceeding that expected during actual fishing.
  - The rotating parts of the reels are covered with grease and oil. Be careful not to soil your clothes.
  - Do not turn the handle while the clutch is pushed in. (If the handle is turned while the clutch is pushed in, the clutch, stopper, gear, etc. will be damaged.)
  - Stop hooking the lure or worm to the reel. The reel may be damaged or the painting may be removed.
  - When the yarn is stored in a wet state with seawater containing salt, there is a risk of spool erosion. Apply tap water only to the spool to flush sea water thoroughly before storing.
  - Do not use organic solvents such as thinner, benzene, alcohol, insect repellent, sunscreen, or chemicals such as pesticides, as these may alter the surface of this unit or cause paint to peel off. Please also stop handling this machine while the above is in hand.
  - We cannot guarantee any failure caused by the installation of any parts other than our genuine parts. In addition, in some cases, we may refuse to repair any parts other than our genuine parts if they remain installed.
  - Some specifications and designs may be changed without notice to improve the product. Please note in advance.

●Notes on Handling Batteries

- ⚠ Note
- Turn off the power before replacing the batteries.
  - Replace the battery indoors at a low humidity and be careful not to allow water droplets, etc., to enter the battery case.
  - Do not leave the battery case open for a long time. (Battery replacement must be completed within 5 minutes.)
  - Do not touch the metal parts that appear when the battery is removed with your hands or metal objects.
  - Place batteries outside the reach of infants and consult a physician immediately if a battery is swallowed.
  - Batteries may overheat, leak or explode. Be careful of the following:
    - Do not mistake the positive and negative terminals of the battery.
    - Remove the batteries from the main unit when the unit will not be used for an extended period of time.
    - Do not charge the battery.
    - Dispose of used batteries according to the disposal method of each local government.
  - When replacing the battery, if the battery cap, packing or other parts are damaged or foreign matter enters, the waterproof performance or function may be impaired.

●Notes on Using IC Counter

- Don't use the product under excessive water, for example.
- For water resistance, the battery cap is tightly closed when shipped. Do not open or close the battery cap except for battery replacement. ※Use the reset switch to turn the counter power ON and OFF.
- Due to performance, the display may become difficult to see in winter (counter surface temperature -10°C or less) or in midsummer (counter surface temperature 60°C or more).
- When using polarized glass, the display may be difficult to see due to performance.
- When the power is turned on, the liquid crystal display may light for a moment due to the effects of static electricity, etc. This is not a malfunction. Please use it with peace of mind.

⚠ Note Even when the IC-counter is normal, the yarn may be stretched when the counter error occurs as you use it. In that case, I'm sorry to trouble you, but please try to input the thread again.

【Pinion gear injection oil (grease)】

- Remove the mechanical brake knob and the pinion shaft inside, turn OFF the clutch, and lubricate the outside surface of the pinion. (In the case of very small quantity and spray grease, it is acceptable to blow a little.)

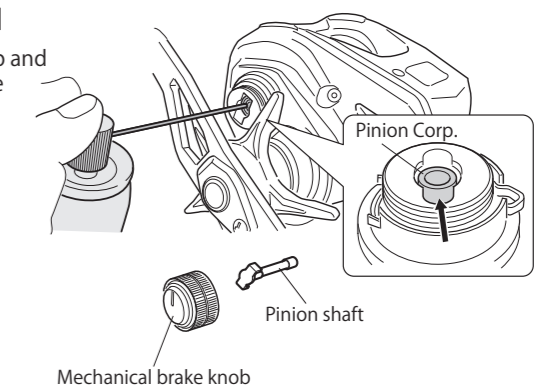

【Injection oil (grease) to warm shaft part】

- Lubricate the worm shaft as shown in the figure. ※Be careful not to spill grease into the IC counter.
- If the product has been used for a long time and is heavily contaminated, spray oil once to remove any contamination, then wipe it off with a waste cloth and then grease it.

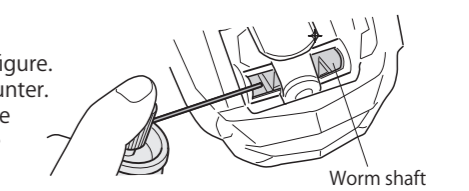

【Injection oil (grease) to handle knob】

- We will inject oil into the handle knob as shown in the illustration. The above injection oil does not necessarily need to be done on a fishing-by-fishing basis. (Approximately once per fishing is sufficient) Too much grease oil could, conversely, impair the original performance. Please note.

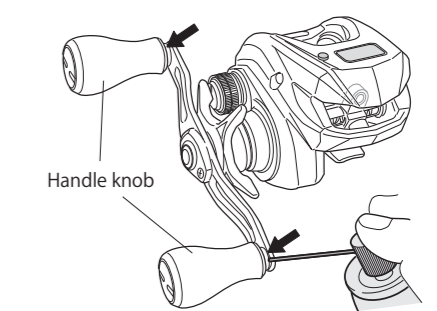

※Do not disassemble and clean the reels of gears, etc., because the internal structure is complicated.

※Do not lubricate the drain hole. ※When you do not use the reel for a long period of time (several months or more), we recommend moving the reel operating unit from time to time.