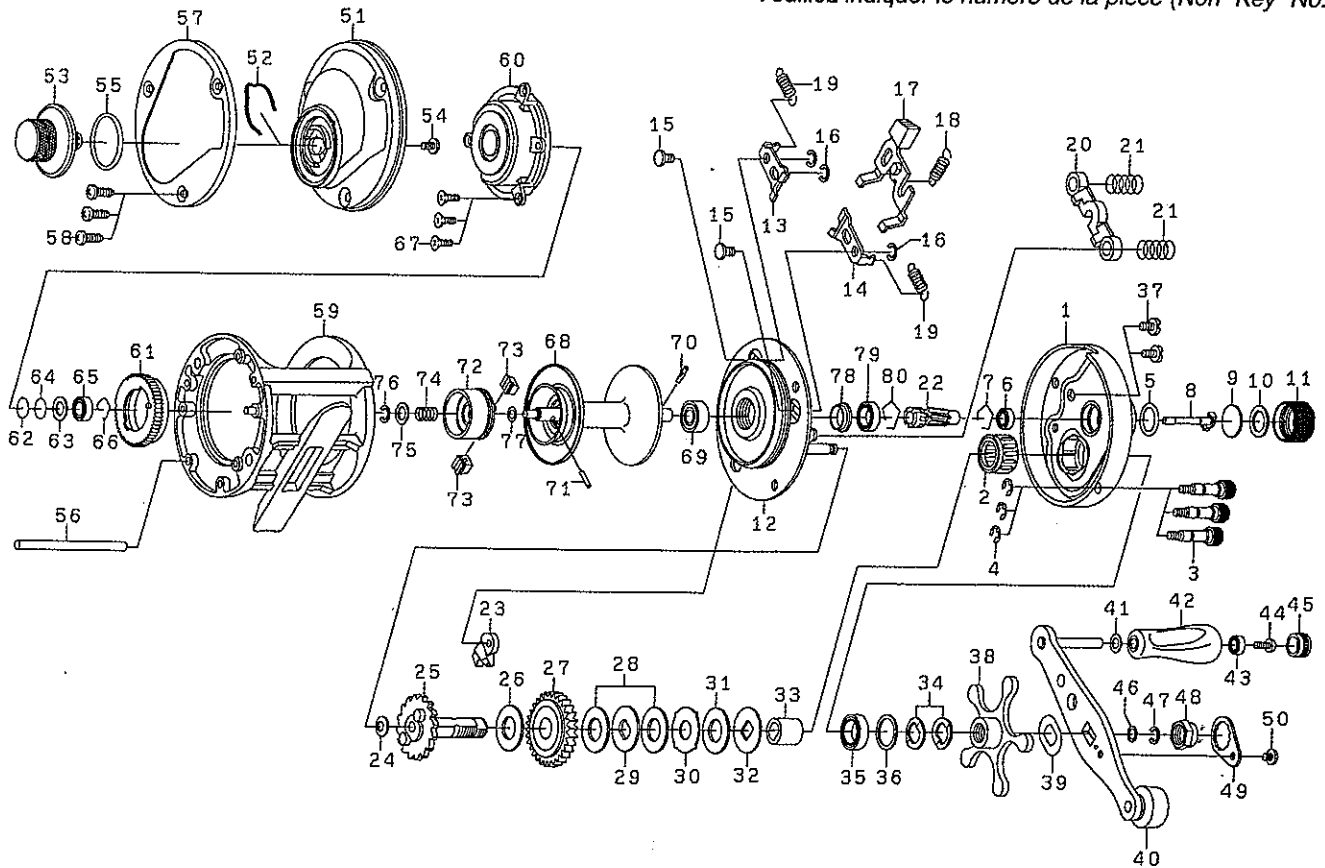

MILLIONAIRE TOURNAMENT 7HT MAG**M-T 7HT MAG**

Please order by parts number, not key number
 Veuillez indiquer le numéro de la pièce (Non "Key" No.)

**MILLIONAIRE TOURNAMENT 7HT MAG**

Key No.	Parts No.	Parts Name	Key No.	Parts No.	Parts Name
1	6H069601	Right side plate	37	63531702	Right side plate screw (A)
2	6F999803	Roller clutch	38	6H070501	Star drag
3	6E465402	Right side plate screw	39	61509001	Friction washer
4	63205901	Right side plate screw retainer	40	6H134501	Handle assembly
5	6B055201	"O" ring (A)	41	6F306400	Handle knob washer
6	6G430901	Ball bearing (A)	42	6G455402	Handle knob
7	6E219701	Bearing retainer (A)	43	6G469001	Ball bearing (C)
8	6F744101	Pinion shaft	44	6B679308	Handle knob screw
9	63757501	Spacer (A)	45	6G456206	Handle knob cap
10	63712822	Spacer (B)	46	6B554301	Handle nut washer
11	6G760202	Cast control cap	47	6B339801	Handle nut retainer
12	6G760302	Set plate AS	48	6H070901	Handle nut
13	60404701	Clutch trip plate (A)	49	60403201	Handle nut plate
14	60404801	Clutch trip plate (B)	50	63538302	Handle nut plate screw
15	61216801	Set plate screw	51	6H071001	Left side plate
16	63208202	Clutch trip plate retainer	52	6H086201	Brake click spring
17	6B337302	Yoke plate	53	6H074801	Brake adjusting knob
18	6H179601	Yoke plate spring	54	63517709	Brake adjusting screw
19	6H179701	Clutch trip plate spring	55	6G488801	"O" ring (B)
20	6B337501	Yoke	56	6E316001	Stabilizer bar
21	6B337601	Yoke spring	57	6H071501	Left side outer ring
22	6H070101	Pinion gear	58	6E317401	Left side plate screw
23	67700301	Anti-reverse pawl	59	6H071601	Frame
24	63737611	Drive shaft washer (A)	60	6H071701	Set plate
25	6H070201	Drive shaft	61	6H071901	Magnet holder
26	63749302	Drive shaft washer (B)	62	63757404	Spacer (C)
27	6H070401	Drive gear	63	6G185101	Spacer (D)
28	6G428501	Drag washer	64	63757411	Spacer (E)
29	6F796301	Key washer	65	6G511502	Ball bearing (E)
30	6F796101	Eared washer	66	6F032201	Bearing retainer (B)
31	6G455801	Drag washer	67	6G212901	Set plate screw
32	6B360303	Key washer	68-76	6Z018583	Spool assembly
33	6G825201	Gear shaft collar	77	6F574303	Spacer (F)
34	61508901	Drag spring washer	78	6G760501	Collar
35	6E154001	Ball bearing (B)	79	6G431001	Ball bearing (F)
36	6B553801	Bearing washer	80	6G227401	Bearing retainer (C)