

17/5/13

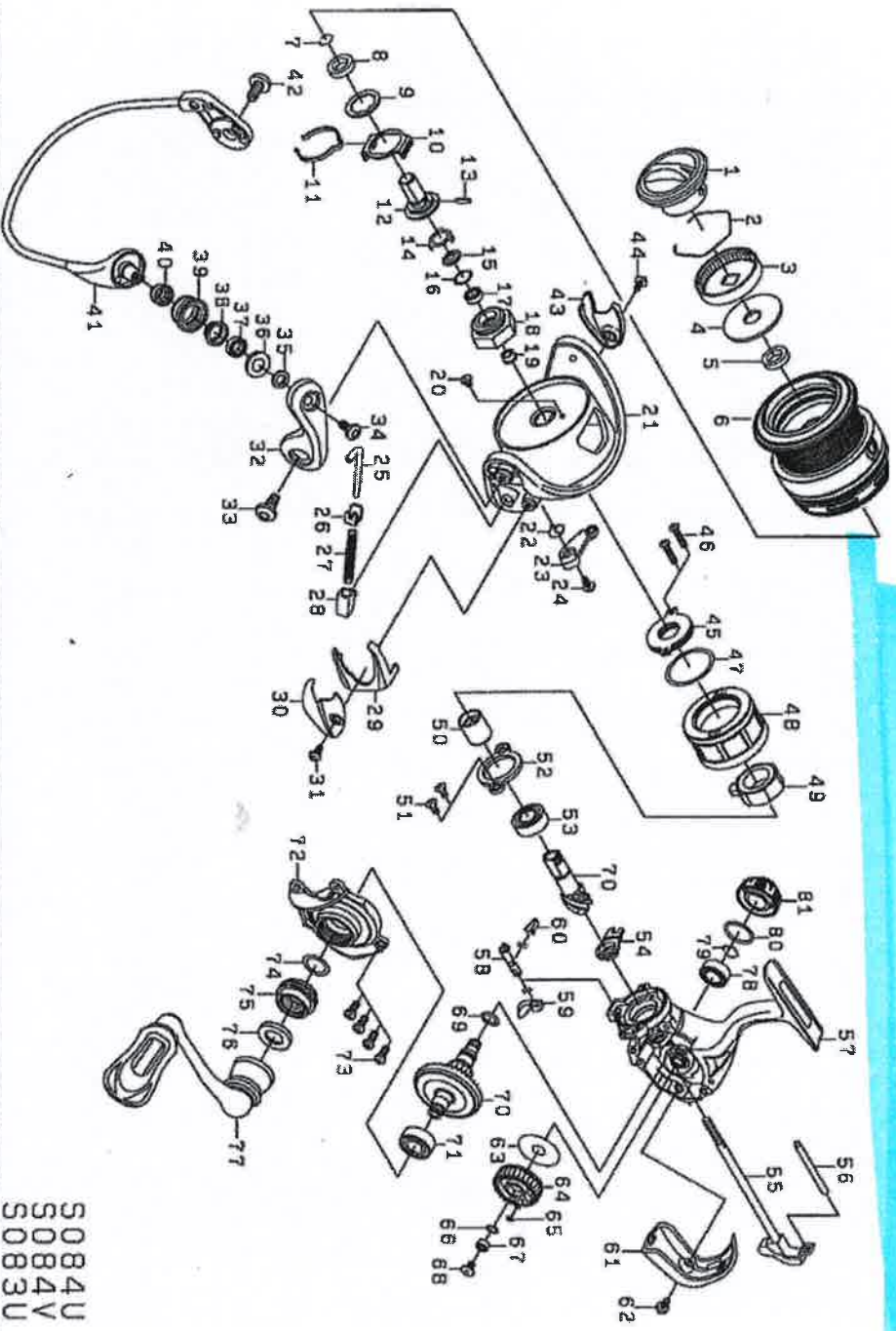

5084U
5084V
5083U

KEY	PART NO.	PART NAME	KEY	PART NO.	PART NAME
	1	6H902270 1	42	6H431201	SCREW
	2	6F710001	43	6H415101	COVER (B)
	3	6F895301	44	6H431301	SCREW (A)
	4	6H806601	45	6H532602	MAGNET AS.
	5	6H416301	46	6H596501	SCREW
2-6	7	6H902501	47	6H413001	O-RING
	8	6G472401	48	6H519305	CAP
	9	6H624801	49	6H412601	ONE WAY CLUTCH
	9	6F625500	50	6H615501	CLUTCH RING
	10	6H416001	51	6G997301	SCREW
	11	6H883701	52	6H442201	PLATE
	12	6H719101	53	6G467302	BALL BEARING
	13	6G375001	54	6H596401	COLLAR
	14	6H415801	55	6H596001	O/S SLIDER ASSY.
	15	6H415701	56	6H596301	PILLAR
	16	6G466103	57	6H902001	BODY
	17	6G466202	58	6H595501	CAM
	18	6H705201	59	6H595401	LEVER
	19	6H806001	60	6H697801	LEAF SPRING
	20	6H022270 1	61	6H598102	CAP
	21	6H802003	62	6H598201	SCREW
	22	6H413601	63	6H595701	WASHER
	23	6H413701	64	6H595801	O/S GEAR
	24	6H417701	65	6H770601	O-RING
	25	6H414101	66	6H129200	WASHER
	26	6H576101	67	6G469002	BALL BEARING
	27	6H545701	68	6G997001	SCREW
	28	6H414301	69	6G670501	O-RING
	29	6H414007	70	6Z020618	GEAR UNIT
	30	6H414601	71	6G467302	BALL BEARING
	31	6H431301	72	6H902201	SIDE COVER
	32	6H414406	73	6H597701	SCREW
	33	6H431201	74	6G613400	WASHER
	34	6H697701	75	6H597802	SCREW
	35	6H415401	76	6H705101	PACKING
	36	6H038301	77	6H902301	HANDLE ASSY.
	37	6G686902	78	6G522703	BALL BEARING
	38	6H415301	79	6G472401	RING
	39	6G686703	80	6G162401	O-RING
	40	6H801801	81	6H705702	SCREW
	41	6H414701			

