

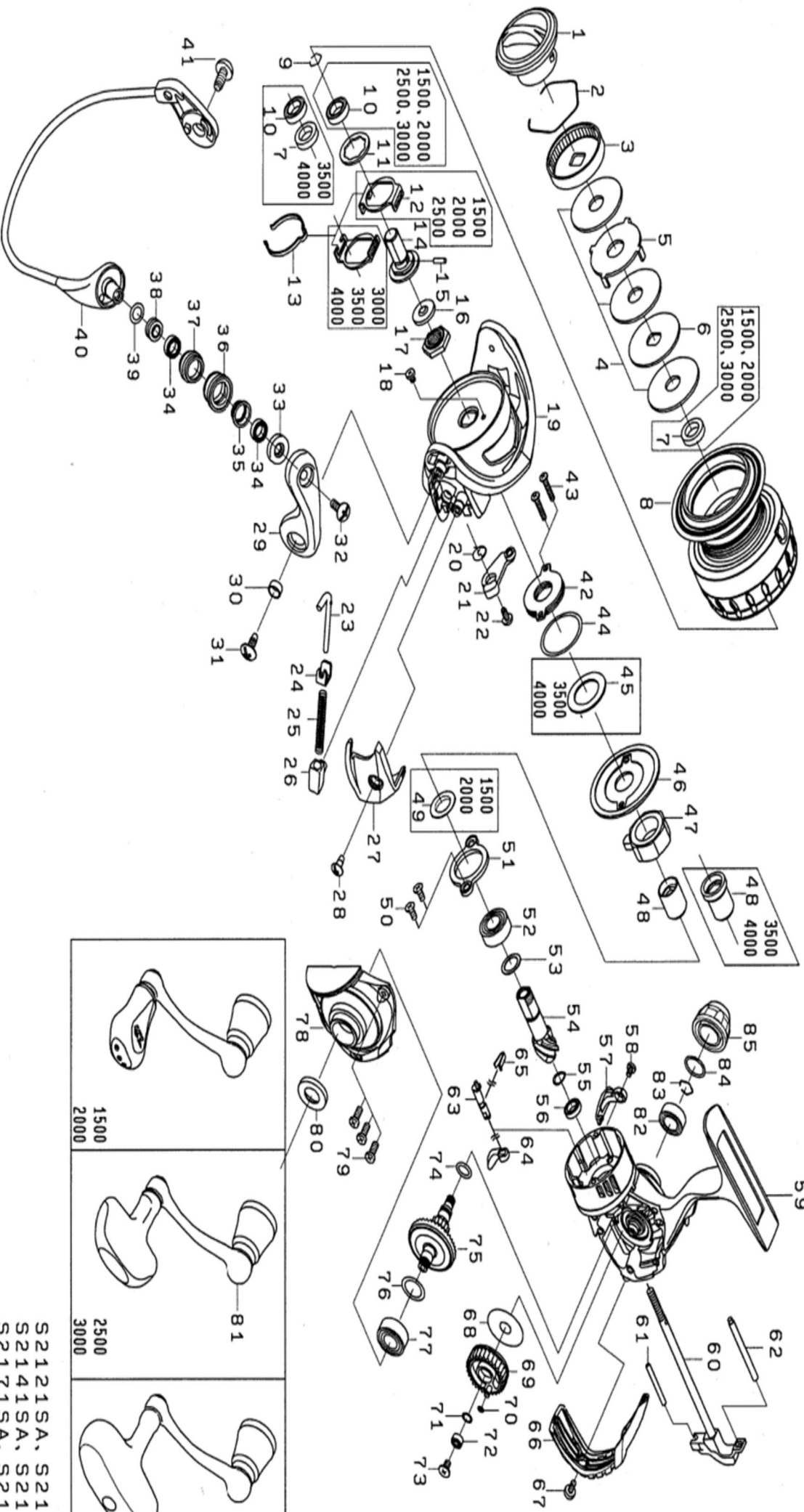

Please quote by part number, not key number when ordering  
 spares@daiwaaustralia.com.au PH: 02 8644 8644

# 2016 SALTIST 4000



S2121SA, S2131SA  
 S2141SA, S2161SA  
 S2171SA, S2181SA  
**DAIWA FISHING.COM.AU**



Please quote by part number, not key number when ordering  
 spares@daiwaaustralia.com.au PH: 02 8644 8644

## 2016 SALTIST 4000

Key No.	Part Number	Description	Key No.	Part Number	Description
1	6J067402	DRAG KNOB	43	6J001601	MAGSEALED SCREW
2	6F710001	DRAG RING	44	6J212901	MAGSEALED ORING
3	6F895302	DRAG RATCHET	46	6J238801	MAGSEALED WASHER
4	6J230103	DRAG WASHER	47	6J100501	MAGSEALED CAP
5	6F627301	DRAG LIP WASHER	48	6J309101	ONEWAY CLUTCH
6	6H714001	DRAG DISC WASHER	49	6J397301	CLUTCH RING
7	6G747401	DRAG COLLAR	50	6J000901	PINION BALL BEARIN PLATE SCREW
2-8	6J420501	SPOOL ASSEMBLY	51	6J020801	PINION BALL BEARING PLATE
9	6G525101	SPOOL METAL RING	52	6G522803	PINION BALL BEARING(A)
10	6G431006	SPOOL METAL BALL BEARING	53	63712800	PINION BALL BEARING WASHER(A)
11	6G903901	SPOOL WASHER	54+75	6Z023097	PINION + DRIVE GEAR UNIT
12	6G694001	CLICK HOLDER	55	6G572501	PINION BALL BEARING WASHER(B)
13	6F709002	CLICK LEAF SPRING	56	6G467104	PINION BALL BEARING(B)
14	6H641501	SPOOL METAL	57	6J021001	BAIL KICK COLLAR
15	6G224101	SPOOL METAL PIN	58	6G940402	BAIL KICK COLLAR SCREW
16	6H995201	ROTOR NUT PACKING	59	6J419801	BODY
17	6H995101	ROTOR NUT	60	6J140901	MAIN SHAFT
18	6H022701	ROTOR SCREW	61	6J084803	OSCILLATING POST(A)
19	6H994325	ROTOR	62	6H614301	OSCILLATING POST(B)
20	6H413601	KICK LEVER SPRING	63	6J020501	STOPPER CAM
21	6H994401	KICK LEVER	64	6H595401	STOPPER CAM LEVER
22	6H417701	KICK LEVER SCREW	65	6H697801	STOPPER CAM LEAF SPRING
23	6H640601	ARM LEVER	66	6J362104	REAR CAP
24	6H576101	ARM LEVER PLATE	67	6J001801	REAR CAP SCREW
25	6H640701	ARM LEVER SPRING	68	6G644201	OSCILLATING WASHER(A)
26	6J089401	ARM LEVER SPRING HOLDER	69	6G644302	OSCILLATING GEAR
27	6H994601	ARM LEVER SPRING COVER	70	6B853101	OSCILLATING GEAR ORING
28	6G270801	COVER SCREW	71	6G522100	OSCILLATING GEAR WASHER(B)
29	6H960117	ARM LEVER	72	6G467104	OSCILLATING GEAR BALL BEARING
30	6H962401	ARM LEVER COLLAR	73	6H272202	OSCILLATING GEAR SCREW
31	6G205001	ARM LEVER SCREW	74	6G645301	DRIVE GEAR ORING
32	6H697701	ROLLAR SCREW	54+75	6Z023097	PINION + DRIVE GEAR UNIT
33	6H744001	ROLLAR MAG COLLAR(A)	76	63737800	DRIVE GEAR WASHER
34	6G686903	ROLLAR BALL BEARING	77	6G523406	DRIVE GEAR BALL BEARING(A)
35	6H743901	ROLLAR COLLAR(A)	78	6J420001	BODY COVER
36	6H743801	LINE ROLLAR	79	6G332904	BODY COVER SCREW
37	6H743701	ROLLAR COLLAR(B)	80	6J397201	HANDLE PACKING
38	6H743401	ROLLAR MAG COLLAR(B)	81	6J420301	HANDLE ASSEMBLY
39	6B411700	ROLLAR MAG WASHER	82	6G431006	DRIVE BALL BEARING(B)
40	6J420101	BAIL	83	6G525101	DRIVE BALL BEARING RING
41	6G205001	ARM LEVER SCREW	84	6G672401	HANDLE CAP ORING
42	6J289301	MAGSEALED	85	6J397803	HANDLE CAP