

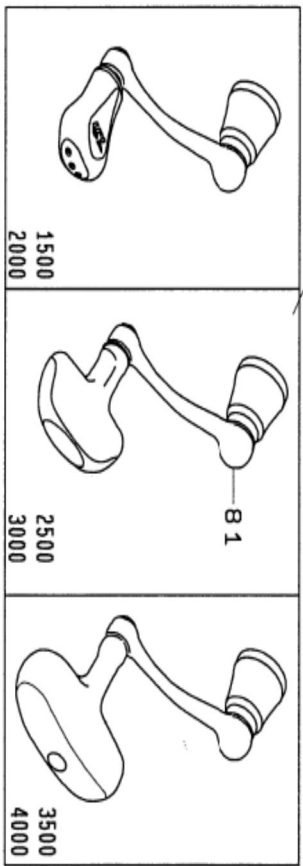

Please quote by part number, not key number when ordering  
 spares@daiwaaustralia.com.au PH: 02 8644 8644

# 2016 SALTIST 3000

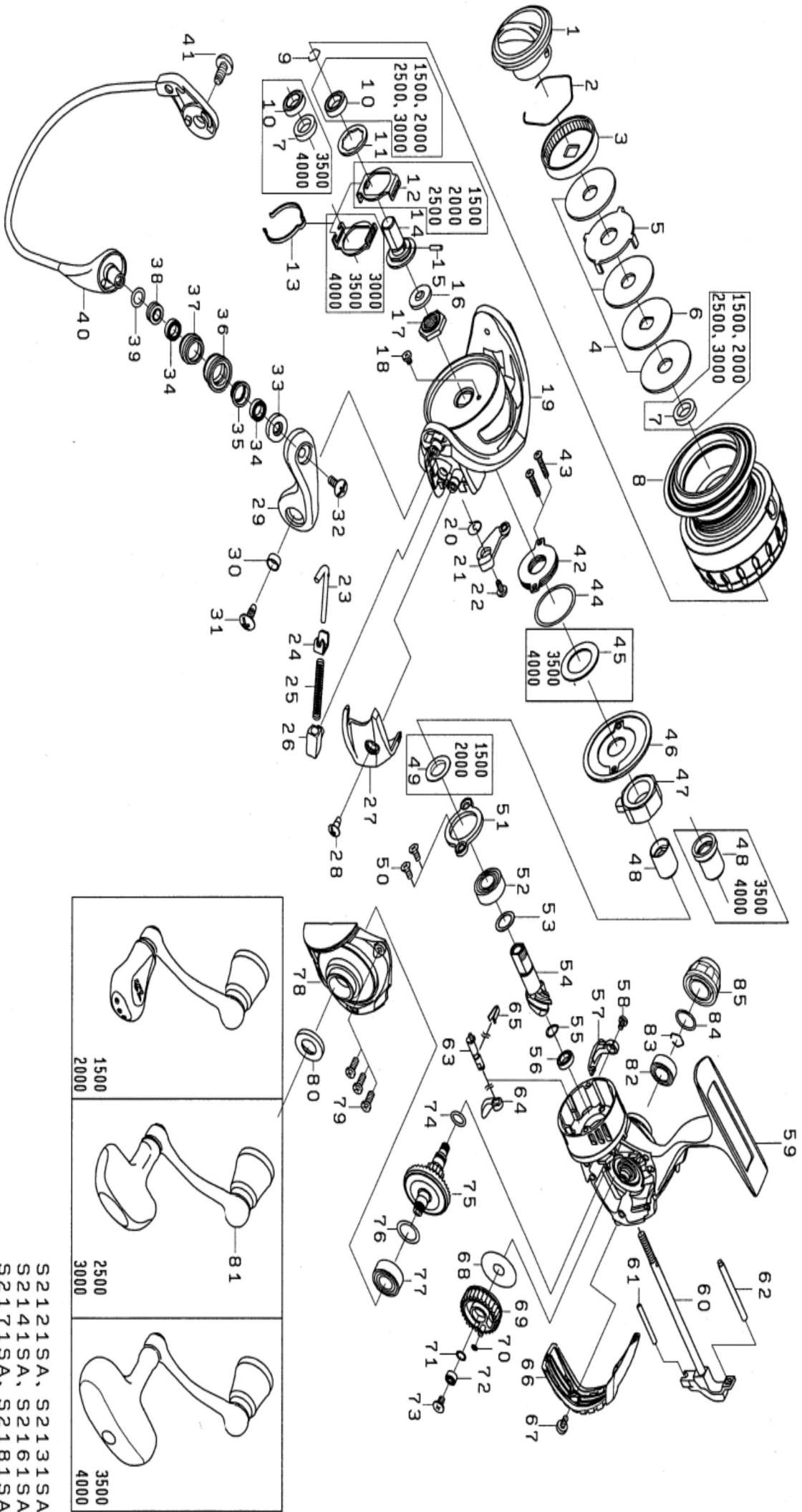

S2121SA, S2131SA  
 S2141SA, S2161SA  
 S2171SA, S2181SA  
**DAIWA FISHING.COM.AU**



Please quote by part number, not key number when ordering  
 spares@daiwaaustralia.com.au PH: 02 8644 8644

## 2016 SALTIST 3000

Key No.	Part Number	Description	Key No.	Part Number	Description
1	6J290601	DRAG KNOB	43	6J001601	MAGSEALED SCREW
2	6F710001	DRAG RING	44	6J212501	MAGSEALED ORING
3	6F895301	DRAG RATCHET	46	6J100301	MAGSEALED CAP
4	6H806703	DRAG WASHER	47	6H412601	ONEWAY CLUTCH
5	6F627301	DRAG LIP WASHER	48	6J001402	CLUTCH RING
6	6F627201	DRAG DISC WASHER	49	6J000901	PINION BALL BEARIN PLATE SCREW
7	6H624801	DRAG COLLAR	50	6H411501	PINION BALL BEARING PLATE
2-8	6J419601	SPOOL ASSEMBLY	51	6G535105	PINION BALL BEARING(A)
9	6G472401	SPOOL METAL RING	52	63758502	PINION BALL BEARING WASHER(A)
10	6G818902	SPOOL METAL BALL BEARING	53	6Z023105	PINION + DRIVGE GEAR UNIT
11	6H806301	SPOOL WASHER	54+75	6H931701	PINION BALL BEARING WASHER(B)
12	6H416001	CLICK HOLDER	55	6G466205	PINION BALL BEARING(B)
13	6H883701	CLICK LEAF SPRING	56	6J001101	BAIL KICK COLLAR
14	6H615003	SPOOL METAL	57	6G940402	BAIL KICK COLLAR SCREW
15	6G375001	SPOOL METAL PIN	58	6J419001	BODY
16	6H986901	ROTOR NUT PACKING	59	6J140801	MAIN SHAFT
17	6H961101	ROTOR NUT	60	6J084802	OSCILLATING POST(A)
18	6H022701	ROTOR SCREW	61	6H614301	OSCILLATING POST(B)
19	6H986322	ROTOR	62	6H595501	STOPPER CAM
20	6H413601	KICK LEVER SPRING	63	6H595401	STOPPER CAM LEVER
21	6J072301	KICK LEVER	64	6H697801	STOPPER CAM LEAF SPRING
22	6H417701	KICK LEVER SCREW	65	6J363705	REAR CAP
23	6H572001	ARM LEVER	66	6J001801	REAR CAP SCREW
24	6H576101	ARM LEVER PLATE	67	6H595701	OSCILLATING WASHER(A)
25	6J089301	ARM LEVER SPRING	68	6H613901	OSCILLATING GEAR
26	6J089401	ARM LEVER SPRING HOLDER	69	6G466001	OSCILLATING GEAR ORING
27	6H986401	ARM LEVER SPRING COVER	70	6H129201	OSCILLATING WASHER(B)(0.05MM)
28	6G270801	COVER SCREW	71	6G469007	OSCILLATING GEAR BALL BEARING
29	6H960117	ARM LEVER	72	6G940402	OSCILLATING GEAR SCREW
30	6H962401	ARM LEVER COLLAR	73	6G670501	DRIVE GEAR ORING
31	6G205001	ARM LEVER SCREW	74	6Z023105	PINION + DRIVGE GEAR UNIT
32	6H697701	ROLLAR SCREW	54+75	63758502	PINION BALL BEARING WASHER(A)
33	6H744001	ROLLAR MAG COLLAR(A)	76	6G467305	PINION BALL BEARING(A)
34	6G686903	ROLLAR BALL BEARING	77	6J419301	BODY COVER
35	6H743901	ROLLAR COLLAR(A)	78	6G332904	BODY COVER SCREW
36	6H743801	LINE ROLLAR	79	6J130201	HANDLE PACKING
37	6H743701	LINE ROLLAR COLLAR(B)	80	6J418601	HANDLE ASSEMBLY
38	6H743401	ROLLAR MAG COLLAR(B)	81	6G522705	DRIVE BALL BEARING(B)
39	6B411703	ROLLAR MAG WASHER	82	6G472401	DRIVE BALL BEARING RING
40	6J419401	BAIL	83	6G162401	HANDLE CAP ORING
41	6G205001	ARM LEVER SCREW	84	6J418101	HANDLE CAP
42	6H532602	MAGSEALED ASSEMBLY	85	6J418101	HANDLE CAP