

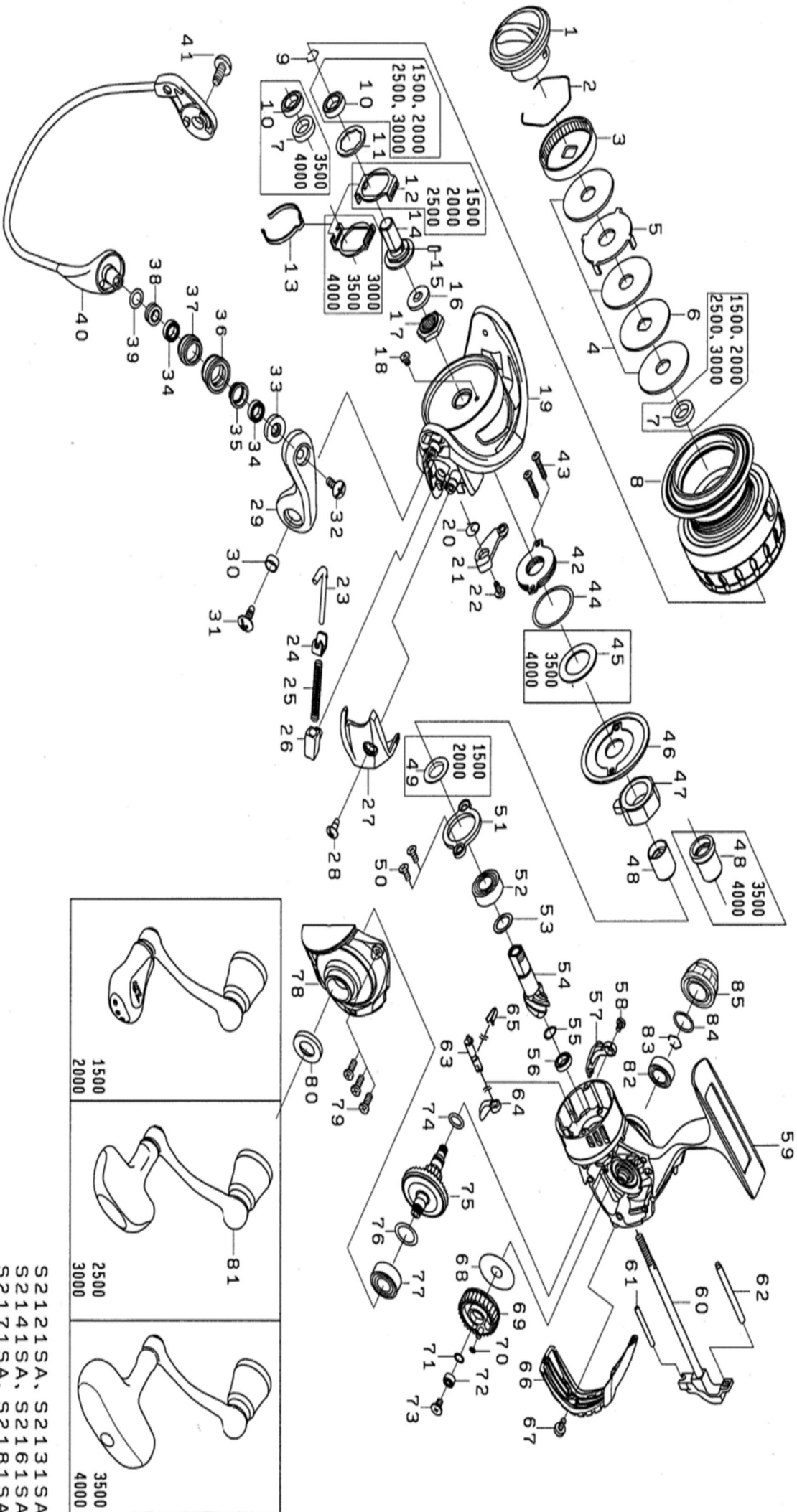





Please quote by part number, not key number when ordering
 spares@daiwaaustralia.com.au PH: 02 8644 8644

2016 SALTIST 2000



		
1500 2000	2500 3000	3500 4000

S2121SA, S2131SA
 S2141SA, S2161SA
 S2171SA, S2181SA
DAIWA FISHING.COM.AU



Please quote by part number, not key number when ordering
 spares@daiwaustralia.com.au PH: 02 8644 8644

2016 SALTIST 2000

Key No.	Part Number	Description	Key No.	Part Number	Description
1	6J290101	DRAG KNOB	43	6J001601	MAGSEALED SCREW
2	6F742501	DRAG RING	44	6J212501	MAGSEALED ORING
3	6F908701	DRAG RATCHET	46	6J100301	MAGSEALED CAP
4	6H806503	DRAG WASHER	47	6H412601	ONEWAY CLUTCH
5	6F635201	DRAG LIP WASHER	48	6J001402	CLUTCH RING
6	6H627701	DRAG DISC WASHER	49	63758501	PINION BALL BEARING WASHER(A)
7	6H624801	DRAG COLLAR	50	6J000901	PINION BALL BEARIN PLATE SCREW
2-8	6J418201	SPOOL ASSEMBLY	51	6H442201	PINION BALL BEARING PLATE
9	6G472401	SPOOL METAL RING	52	6G467305	PINION BALL BEARING(A)
10	6G818902	SPOOL METAL BALL BEARING	53	63758502	PINION BALL BEARING WASHER(A)
11	6H806301	SPOOL WASHER	54+75	6Z023102	PINION + DRIVE GEAR UNIT
12	6H416001	CLICK HOLDER	55	6H931701	PINION BALL BEARING WASHER(B)
13	6H883701	CLICK LEAF SPRING	56	6H959602	PINION BALL BEARING(B)
14	6H717701	SPOOL METAL	57	6J022601	BAIL KICK COLLAR
15	6G375001	SPOOL METAL PIN	58	6G940402	BAIL KICK COLLAR SCREW
16	6H986901	ROTOR NUT PACKING	59	6J417201	BODY
17	6H961101	ROTOR NUT	60	6J140601	MAIN SHAFT
18	6H022701	ROTOR SCREW	61	6J084801	OSCILLATING POST(A)
19	6H974317	ROTOR	62	6H614301	OSCILLATING POST(B)
20	6H443301	KICK LEVER SPRING	63	6H595501	STOPPER CAM
21	6H443401	KICK LEVER	64	6H595401	STOPPER CAM LEVER
22	6H417701	KICK LEVER SCREW	65	6H697801	STOPPER CAM LEAF SPRING
23	6H443601	ARM LEVER	66	6J355702	REAR CAP
24	6H576101	ARM LEVER PLATE	67	6J001801	REAR CAP SCREW
25	6H442401	ARM LEVER SPRING	68	6H595701	OSCILLATING WASHER(A)
26	6H414301	ARM LEVER SPRING HOLDER	69	6H629101	OSCILLATING GEAR
27	6H974401	ARM LEVER SPRING COVER	70	6H770601	OSCILLATING GEAR ORING
28	6G270801	COVER SCREW	71	6H129201	OSCILLATING WASHER(B)(0.5MM)
29	6H960117	ARM LEVER	72	6G469007	OSCILLATING GEAR BALL BEARING
30	6H962401	ARM LEVER COLLAR	73	6G940402	OSCILLATING GEAR SCREW
31	6G205001	ARM LEVER SCREW	74	6G670501	DRIVE GEAR ORING
32	6H697701	ROLLAR SCREW	54+75	6Z023102	PINION + DRIVE GEAR UNIT
33	6H744001	ROLLAR MAG COLLAR(A)	76	63758502	PINION BALL BEARING WASHER(A)
34	6G686903	ROLLAR BALL BEARING	77	6G467305	PINION BALL BEARING(A)
35	6H743901	ROLLAR COLLAR(A)	78	6J417501	BODY COVER
36	6H743801	LINE ROLLAR	79	6G332904	BODY COVER SCREW
37	6H743701	ROLLAR COLLAR(B)	80	6J130201	HANDLE PACKING
38	6H743401	ROLLAR MAG COLLAR(B)	81	6J417801	HANDLE ASSEMBLY
39	6B411703	ROLLAR MAG WASHER	82	6G522705	DRIVE BALL BEARING(B)
40	6J417601	BAIL ASSEMBLY	83	6G472401	DRIVE BALL BEARING RING
41	6G205001	ARM LEVER SCREW	84	6G162401	HANDLE CAP ORING
42	6H532602	MAGSEALED	85	6J418101	HANDLE CAP